

© 2019 JOHN SANFORD ARCHITECTS. ALL NAME, SPECIFICATION, COMPUTER FILE AND OTHER DOCUMENTATION PREPARED BY JOHN SANFORD ARCHITECTS ARE CONSIDERED INSTRUMENTS OF SERVICE AND SHALL REMAIN THE PROPERTY OF JOHN SANFORD ARCHITECTS. JOHN SANFORD ARCHITECTS SHALL REMAIN THE PROPERTY OF JOHN SANFORD ARCHITECTS. JOHN SANFORD ARCHITECTS SHALL REMAIN THE PROPERTY OF JOHN SANFORD ARCHITECTS. ALL RIGHTS, REPRODUCTION, REGISTRATION AND OTHER RIGHTS ARE RESERVED. NO PART OF THESE DRAWINGS ARE TO BE REPRODUCED, COPIED, OR TRANSMITTED IN ANY FORM OR BY ANY MEANS, ELECTRONIC OR MECHANICAL, INCLUDING PHOTOCOPYING, RECORDING, OR BY ANY INFORMATION STORAGE AND RETRIEVAL SYSTEM, WITHOUT THE WRITTEN PERMISSION OF JOHN SANFORD ARCHITECTS. ALL DIMENSIONS ARE TO FACE UNLESS OTHERWISE NOTED. ALL DIMENSIONS ARE TO FACE UNLESS OTHERWISE NOTED. ALL DIMENSIONS ARE TO FACE UNLESS OTHERWISE NOTED.

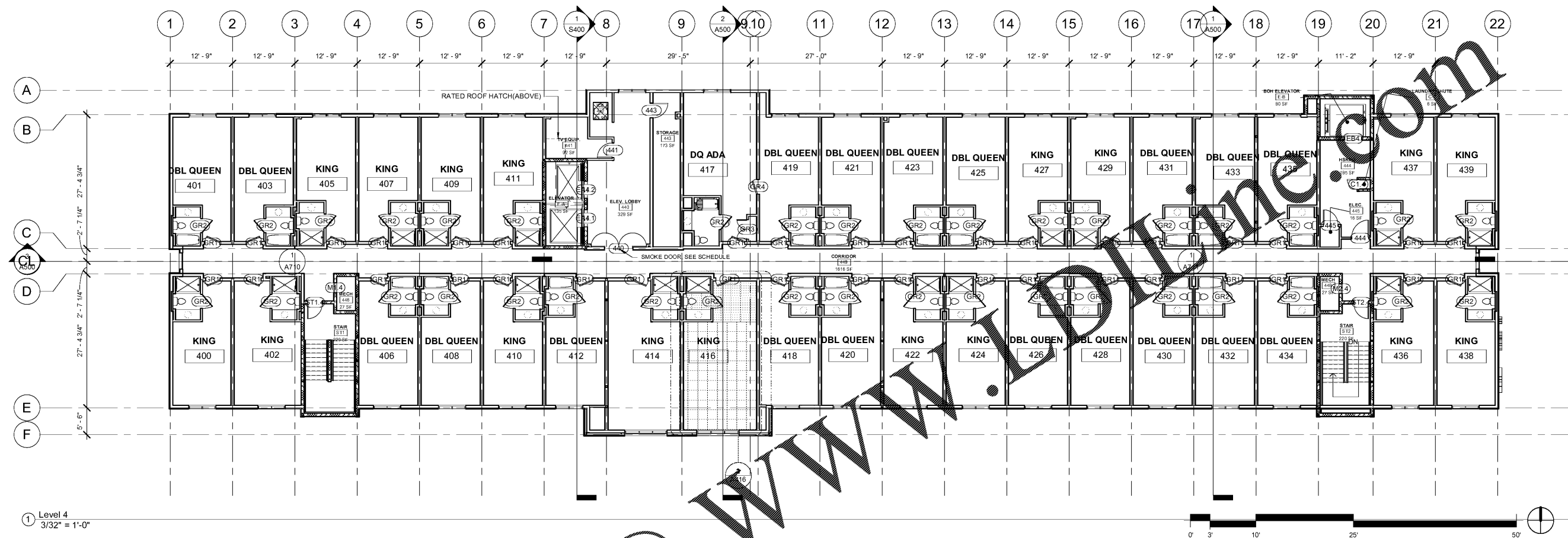

AREA SCHEDULE - GUESTROOM			
Name	SF/Room	Count	Comments
Level 1			
KING		1	
KING ADA ROLL-IN		2	
		3	
Level 2			
DBL QUEEN		19	
DQ ADA		1	
KING		15	
		35	
Level 3			
DBL QUEEN		17	
DQ ADA		1	
KING		17	
KING ADA		2	
		37	
Level 4			
DBL QUEEN		19	
DQ ADA		1	
KING		17	
		37	
Grand total		112	

ACCESSIBLE GUESTROOMS	
Name	Number
Level 1	
KING ADA	108
KING ADA ROLL-IN	
KING ADA ROLL-IN	110
Level 2	
DQ ADA	217
Level 3	
KING ADA	314
KING ADA	316
DQ ADA	317
Level 4	
DQ ADA	417
Grand total:	7

ACCESSIBLE HEARING GUESTROOMS	
Name	Number
Level 1	
KING	106
Level 2	
KING	200
KING	202
DBL QUEEN	203
DBL QUEEN	206
DBL QUEEN	208
KING	212
Level 3	
DBL QUEEN	301
KING	303
Grand total:	9

GROSS BUILDING AREA	
Level	Area
Level 1	18860 SF
Level 2	16943 SF
Level 3	16960 SF
Level 4	16960 SF
	69724 SF

GENERAL NOTES:
 ALL BACK OF HOUSE (BOH) DOORS TO BE KEY CARD ACCESS ONLY
 ADA ROOMS ON FIRST FLOOR W/ ROLL-IN SHOWERS (108, 110)

THESE DRAWINGS ARE PRELIMINARY IN NATURE AND INTENDED FOR REVIEW AND PERMITTING. DRAWINGS ARE NOT TO BE USED FOR CONSTRUCTION WITHOUT ARCHITECT'S AND ENGINEER'S SIGNATURE AND THEIR DATE OF ISSUE FOR CONSTRUCTION.

RECORD

JSA ARCHITECTS
 9726 E. 42nd St. SUITE 153
 TULSA, OK 74146
 918.640.6800
 JHNSANFORD@AOL.COM

Copyright 2019 John Sanford
 JOHN SANFORD,
 AIA, NCARB
 TN LICENSE #106056

4/4/2019
 1:58:52 PM

John Sanford

NOT VALID FOR CONSTRUCTION UNLESS SIGNED IN THIS BLOCK

PROPOSED HOLIDAY INN LI 9383
 215 CRACKER BARREL DR., CLARKSVILLE
 MONTGOMERY COUNTY, TENNESSEE

PERMIT NO:

4/4/2019
 1:58:52 PM

No.	Description	Date

IBC 2012
 BUILDING IS FULLY SPRINKLERED
 CLASSIFICATION: R-1
 CONSTRUCTION TYPE: 5A
 (WOOD FRAME)

SHEET

A104
 4th FLOOR PLAN