

DATE	ISSUE	DATE
	Job Number	
	Drawn	PAT
	Checked	PAT
	Approved	PAT
	TITLE	

SYMBOL SCHEDULE	
	LIGHTING FIXTURE - LED
	LIGHTING FIXTURE - LED STRIP OR INDUSTRIAL STRIP
	LIGHTING FIXTURE - LED RECESSED OR SURFACE
	LIGHTING FIXTURE - LED WALL OR BRACKET MOUNTED
	LIGHTING FIXTURE CONNECTED TO EMERG. POWER SOURCE
	EXIT LIGHT - CEILING MOUNTED, ARROWS AS INDICATED
	EXIT LIGHT - WALL MOUNTED, ARROWS AS INDICATED
	EXIT LIGHT - WALL MOUNTED, ARROWS AS INDICATED
	EXIT LIGHT - WALL MOUNTED, ARROWS AS INDICATED
	POLE MOUNTED LIGHTING FIXTURE WITH NO. OF LUMINAIRES AS INDICATED
	SELF CONTAINED EMERGENCY BATTERY/LIGHTING UNIT
	15A, 125V, 2 POLE, 3 WIRE, GROUNDING, NEMA 5-15R DUPLEX RECEPT.
	15A, 125V, 2 POLE, 3 WIRE, GROUNDING, NEMA 5-15R DOUBLE DUPLEX RECEPT.
	30A, 125/250V, 3 POLE, 3 WIRE, NEMA 10-30R SINGLE REC. (DRY) OUTLET
	FLOOR OUTLET WITH AN ISOLATED GROUND DUPLEX RECEPTACLE
	DUPLEX RECEPTACLE WITH GROUND FAULT CURRENT INTERRUPTER
	DUPLEX RECEPTACLE WITH ISOLATED GROUND WIRE
	MASTER CLOCK SYSTEM
	SPECIAL OUTLET - AS INDICATED
	TOGGLE SWITCH, SINGLE POLE
	TOGGLE SWITCH, THREE-WAY
	TOGGLE SWITCH, FLOOR MOUNTED
	TOGGLE SWITCH WITH INSTANT LIGHT
	TOGGLE SWITCH WITH KEY OPERATOR
	TOGGLE SWITCH MOTOR HEATED WITH THERMAL OVERLOAD ELEMENT
	SWITCH, 1500V (MINIMUM) OR SIZE AS INDICATED
	TELEPHONE OUTLET WITH 1" C AND CABLE TO SYSTEM BACKBOARD
	DATA FLOOR OUTLET WITH 1" EC HOMERUN TO IDF RACK
	120/208 OR 120/240 PANELBOARD AS SCHEDULED
	277/480 PANELBOARD OR SWITCHBOARD AS SCHEDULED
	TELEPHONE BACKBOARD
	DRY TYPE TRANSFORMER
	JUNCTION BOX
	PULL BOX
	PHOTOELECTRIC CONTROL
	REMOTE BALLAST
	TIME SWITCH
	MASTER CLOCK, D - DENOTES DOUBLE FACE
	MAGNETIC STARTER
	DISCONNECT OR SAFETY SWITCH
	C=CHIME, B=BELL, Z=BUZZER, G=GONG
	MOTOR, # = HORSEPOWER, F = FRACTIONAL
	CONDUIT RUN UP OR DOWN
	CONDUIT, HOMERUN (CROSS MARKS = # OF CONDUCTORS WHERE MORE THEN TWO)
	CONDUIT CONCEALED OVERHEAD IN FURRED CEILING, IN SLAB, OR IN WALLS
	DASHED SYMBOL INDICATES EXISTING DEVICE TO REMAIN.
	EWIC OUTLET FOR ELECTRIC WATER COOLER MOUNTED CONCEALED BEHIND UNIT
	G GROUND
	EC EMPTY CONDUIT
	WP WEATHERPROOF
	RT RAIN TIGHT (NEMA 3R)
	NL NIGHT LIGHT (CONNECTED TO UNSWITCHED CIRCUIT)
	FA FIRE ALARM MANUAL STATION
	AA FIRE ALARM AUDIO/SPEAKER ALARM
	VA FIRE ALARM VISUAL STROBE
	FS FIRE ALARM FLOW SWITCH
	TA FIRE ALARM TAMPER SWITCH
	SD FIRE ALARM SMOKE DETECTOR
	DA FIRE ALARM DUCT MOUNTED SMOKE DETECTOR
	HD FIRE ALARM HEAT DETECTOR
	IS INTERCOM SPEAKER, 24"x24" RECESS MOUNTED
	CS INTERCOM SPEAKER FLUSH MOUNTED IN GYP BOARD CEILING
	CA CAFETERIA SOUND SYSTEM SPEAKER
	FP FLUSH WALL MOUNTED SPEAKER. VP = VANDAL PROOF, WP = WEATHER PROOF
	MO MICROPHONE OUTLET
	BCM INTERCOM SYSTEM CLASSROOM BREAKOUT MODULE MOUNTED ABOVE CEILING
	IB INTERCOM CALL BUTTON
	IC INTERCOM SYSTEM VOLUME CONTROL
	AD ADMINISTRATIVE INTERCOM PHONE WITH READ-OUT
	IS INTERCOM SYSTEM HIGH SECURITY STATION
	TV TELEVISION OUTLET
	CROSSHATCHED SYMBOL INDICATES EXISTING DEVICE TO BE REMOVED
	EXISTING ELECTRICAL CIRCUIT
	ISOLATED GROUND DUPLEX RECEPT.
	120 VOLT, 1HP MOTOR RATED DISCONNECT SWITCH.
	DATA OUTLET WITH 1" C TO ABOVE THE CORRIDOR CEILING. DATA OUTLET SHALL BE A DOUBLE GANG BOX WITH REDUCER TO A SINGLE GANG COVERPLATE. FURNISH AND INSTALL A PANDUIT MINIBASH WALL BOX ADAPTER AT EACH DATA/TELEPHONE OUTLET BOX. COLOR TO BE SELECTED BY OWNER/ARCHITECT. RUN (2) DATA CABLES FROM EACH OUTLET TO THE DESIGNATED DATA ROOM.
	(1) HOT (1) NEUTRAL (1) EQUIPMENT GROUND
	CLOCK OUTLET - CENTER ABOVE THE MARKER BOARD AND CEILING.

PANEL FEEDERS HAVE BEEN SIZED FOR VOLTAGE DROP. CONTRACTOR SHALL FURNISH AND INSTALL THE CORRECT SIZED TERMINATION LUIGS INTO EACH PANEL AND BREAKER. REFER TO THE ELECTRICAL RISER DIAGRAM AND PANEL SCHEDULES FOR THE EXACT QUANTITY AND SIZE OF FEEDERS.

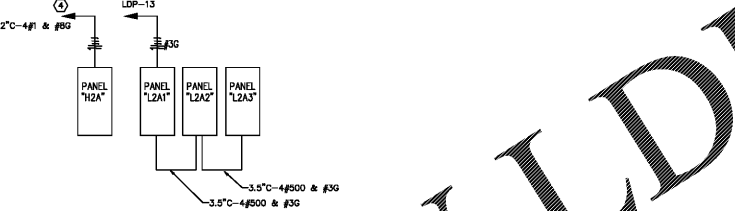

ELEC. RM. PART A
SECOND FLOOR

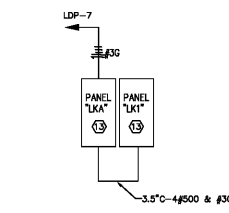

KITCHEN PART B
FIRST FLOOR



ELEC. RM. PART C
GYM

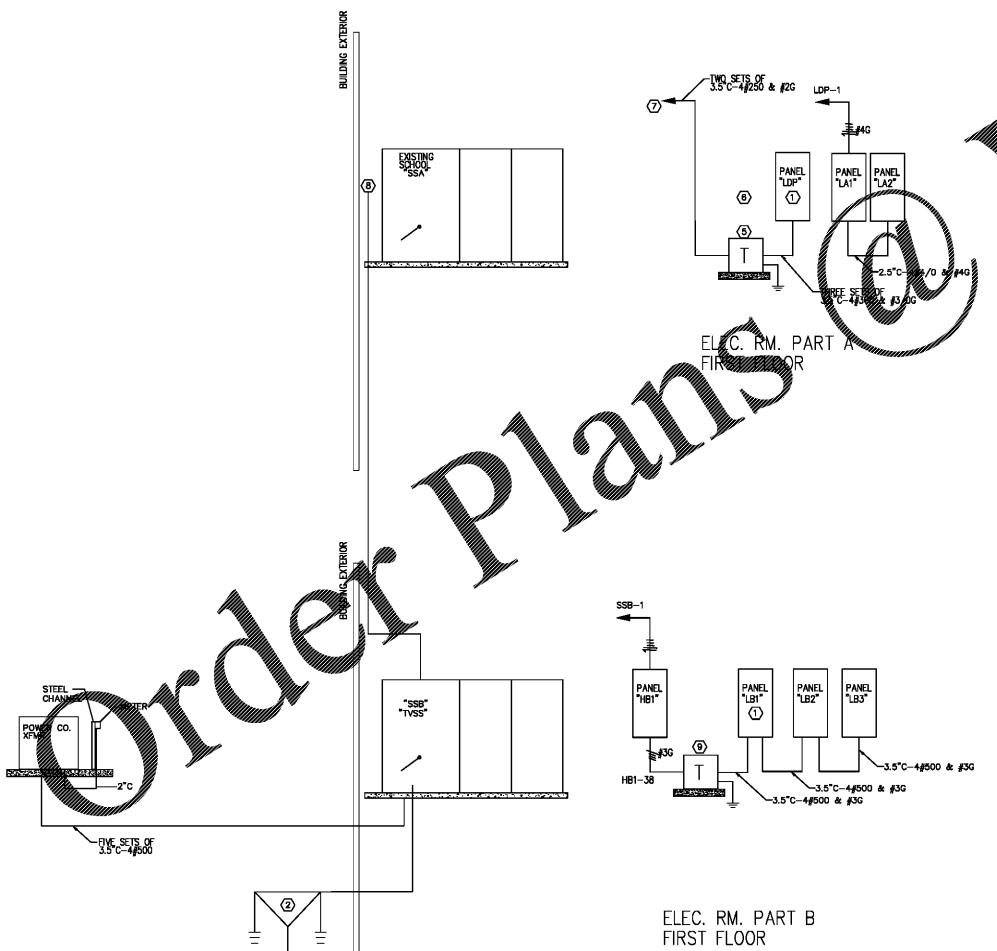

ELECTRICAL RISER DIAGRAM
NOT TO SCALE

GENERAL NOTES:

THE CONTRACTOR SHALL REMOVE ALL OF THE EXISTING ELECTRICAL CIRCUITS TO THE HVAC EQUIPMENT THAT IS BEING DEMOLISHED AS PART OF THE PROJECT (UNLESS EXPLICITLY NOTED OTHERWISE.) COORDINATE THE REMOVAL OF THESE CIRCUITS WITH THE HVAC AND GENERAL CONTRACTORS PRIOR TO DEMOLITION.

THE ELECTRICAL CONTRACTOR, UNLESS NOTED OTHERWISE, SHALL REMOVE ALL OF THE EXISTING INTERIOR LIGHT FIXTURES WHERE NEW LIGHT FIXTURES ARE SPECIFIED TO BE INSTALLED (EXCEPT AS NOTED ON THE DRAWINGS), SWITCHING, FIXTURE CIRCUITING IN AREAS WHERE NEW LIGHT FIXTURES ARE SPECIFIED AND CIRCUITED.

WHEN REMOVING THE EXISTING LIGHTING AND/OR POWER CIRCUITS REMOVE CIRCUIT ALL THE WAY BACK TO THE PREVIOUS UPSTREAM DEVICE. IF NO UPSTREAM DEVICE(S) EXISTS, REMOVE WIRING ALL THE WAY BACK TO THE PANELBOARD AND SWITCH THE CIRCUIT BREAKER TO THE "OFF" POSITION. UPDATE THE PANELBOARD SCHEDULE, LABELING THE BREAKER "SPARE". FURNISH AND INSTALL NEW TYPED PANEL DIRECTORIES IN ALL EXISTING PANELS.

WHEN REMOVING EXISTING ELECTRICAL CIRCUITS AND EQUIPMENT TO REMAIN IS CONNECTED DOWNSTREAM, REROUTE THE EXISTING CIRCUIT TO MAINTAIN THE CONTINUITY TO THE DOWNSTREAM EQUIPMENT. RECORD ALL REWIRING ON THE AS-BUILT DRAWINGS (SEE SPECIFICATIONS). THE CONTRACTOR SHOULD BE CAUTIONED THAT THIS DOES NOT ALLOW HIM TO REUSE ANY OF THE EXISTING CONDUITS OR WIRING TO CONNECT ANY NEW DEVICES OR NEW LIGHT FIXTURES, ONLY MAINTAIN EXISTING DEVICES AND/OR POWER CIRCUITS THROUGH AREAS OF RENOVATION.

ALL EXISTING ELECTRICAL CABLES AND DEVICES FOR SECURITY, TV, TELEPHONE, DATA, WIRELESS ACCESS, DOOR CONTROLS AND CCTV, ETC. SHALL BE MAINTAINED THROUGHOUT THE SCHOOL DURING THE RENOVATION UNLESS NOTED OTHERWISE. TAKE PRECAUTION NOT TO DAMAGE THESE SYSTEMS IN ANY WAY. CONTRACTOR IS CAUTIONED THAT ALL OF THE EXISTING SYSTEMS CABLEING IS NOT RUN IN CONDUIT.

ONCE THE NEW CEILING IS INSTALLED, THE CONTRACTOR SHALL REINSTALL ALL EXISTING CEILING MOUNTED EQUIPMENT/DEVICES FOR SECURITY, TV, TELEPHONE, DATA, WIRELESS ACCESS, DOOR CONTROLS AND CCTV, ETC. INTO THE NEW CEILING. IF THE EQUIPMENT IS DAMAGED OR BECOMES INOPERABLE DURING THE RENOVATION, THE CONTRACTOR SHALL REPLACE IT AT NO ADDITIONAL COST TO THE OWNER (AND TO THE OWNER'S SATISFACTION). THE CONTRACTOR SHALL DOCUMENT IN WRITING TO THE OWNER ANY INOPERATIVE EQUIPMENT PRIOR TO COMMENCING WORK. FAILURE TO DOCUMENT INOPERATIVE EQUIPMENT SHALL NOT RELIEVE THE CONTRACTOR FROM THIS REQUIREMENT. CONTRACTOR IS CAUTIONED THAT ALL EXISTING SYSTEMS CABLEING IS NOT RUN IN CONDUIT. AS PART OF THIS BID, THE ELECTRICAL CONTRACTOR SHALL USE THE WRAPS AND J-HOOKS TO SUPPORT CABLES INDEPENDENTLY FROM THE CEILING ASSEMBLY. THIS SHOULD BE ACCOMPLISHED PRIOR TO THE DEMOLITION OF ANY CEILING.

THE ELECTRICAL CONTRACTOR SHALL REFER TO THE ARCHITECT'S SEQUENCING AND MILESTONES FOR ALL PHASING OF THE WORK.

CONTRACTOR SHALL INCLUDE IN HIS BASE BID ANY AND ALL COST TO REPLACE DAMAGED CEILING TILES DUE TO THE INSTALLATION OF THE NEW ELECTRICAL FEEDERS, CIRCUITS AND SYSTEMS/DATA WORK.

GENERAL NOTES:

ALL NEW WALL MOUNTED DEVICES (POWER, OUTLETS, FIRE ALARM, T-STATS, FAN SWITCHES, SYSTEMS, ETC.) SHALL BE FLUSH IN THE WALL. ALL CONDUIT SHALL BE RUN CONCEALED IN THE EXISTING WALLS TO THE WALL MOUNTED DEVICES. THE CONTRACTOR SHALL INCLUDE IN HIS BASE PRICE ANY AND ALL COST TO CUT THE EXISTING WALL AND INSTALL ALL CONDUIT AND BOXES FLUSH AND PATCH THE EXISTING WALL BACK TO THE ORIGINAL CONDITION. REFER TO THE ARCHITECT'S SPECIFICATIONS FOR ADDITIONAL INFORMATION ON PATCHING EXISTING WALLS.

KEY NOTES:

- FURNISH AND INSTALL A "TVSS" UNIT FOR THIS PANEL.
- RUN #3/0 GROUND CONDUCTOR TO THREE 5/8" X 10' COPPERCLAD GROUND RODS SPACED TEN FEET APART ON THE EXTERIOR OF THE BUILDING, TO THE MAIN STEEL DOMESTIC WATER LINE, AND TO BUILDING STEEL.
- THE EXISTING GYM SERVICE PANEL IS LOCATED UNDERNEATH THE BLEACHES IN THE ELECTRICAL DISTRIBUTION SPACE. THE MAN FOR THE BUILDING IS LOCATED ON THE FRONT OF THE BUILDING. THE CONTRACTOR SHALL REMOVE THIS SERVICE FROM THE BUILDING EXTERIOR AND FEED THE EXISTING SERVICE PANEL LOCATED UNDERNEATH THE BLEACHES FROM THE NEW ADDITION.
- FURNISH AND INSTALL A NEW 100A/3P BREAKER IN THE EXISTING SWITCHBOARD "SSA". THE NEW BREAKER SHALL BE U.L. LISTED FOR USE IN THE EXISTING PANEL AND SHALL MATCH ALL EXISTING RATINGS.
- 300 KVA 480/208/3 VOLT TRANSFORMER WITH #3/0 TO BUILDING STEEL.
- FURNISH AND INSTALL THE DISTRIBUTION PANEL AND TRANSFORMER AT THE LOCATION INDICATED. THE SPACE IS VERY TIGHT. MAINTAIN ALL NEC REQUIRED WORKING CLEARANCES. SUBMIT 1/4" SCALED SHOP DRAWINGS FOR THE EQUIPMENT WITH THE PANEL SUBMITTALS.
- FURNISH AND INSTALL A 450A/3P BREAKER IN THE SWITCHBOARD AND CONNECT TO THE NEW FEEDER. THE NEW BREAKER SHALL BE U.L. LISTED FOR USE IN THE EXISTING PANEL AND SHALL MATCH ALL EXISTING RATINGS.
- FURNISH AND INSTALL A REMOTE SHUNT TRIP SWITCH FROM THE NEW SWITCHBOARD "SSB" INSTALLED ADJACENT TO THE EXISTING SWITCHBOARD "SSA". LABEL SWITCH AS "MAIN 1 OF 2". LABEL THE EXISTING MAIN OF SWITCHBOARD "SSA" AS "MAIN 2 OF 2".
- 112.5 KVA 480/208/3 VOLT TRANSFORMER WITH #1/0 TO BUILDING STEEL.
- 30 KVA 480/208/3 VOLT K RATED TRANSFORMER WITH #6 TO BUILDING STEEL.
- FURNISH AND INSTALL A 45A/3P BREAKER IN THE PANEL AND CONNECT TO THE NEW FEEDER. THE NEW BREAKER SHALL BE U.L. LISTED FOR USE IN THE EXISTING PANEL AND SHALL MATCH ALL EXISTING RATINGS.
- CONTRACTOR TO REMOVE THE EXISTING GYM SERVICE AND REFEED FROM THE NEW ADDITION ELECTRICAL SERVICE.
- FURNISH AND INSTALL EIGHT SPARE 3/4" CONDUITS WITH PULL ROPES FROM THE PANEL TO ABOVE THE CEILING.

All branch circuit wiring shall be run in the walls and above the ceiling unless explicitly noted on the floor plans.

All FEEDER wiring MAY BE RUN BELOW THE SLAB or run in the walls and above the ceiling.

ALL SWITCHBOARDS AND PANELS SHALL BE INSTALLED WITH ARC FLASH LABELING PER THE NEC.