

DATE	ISSUE	DATE

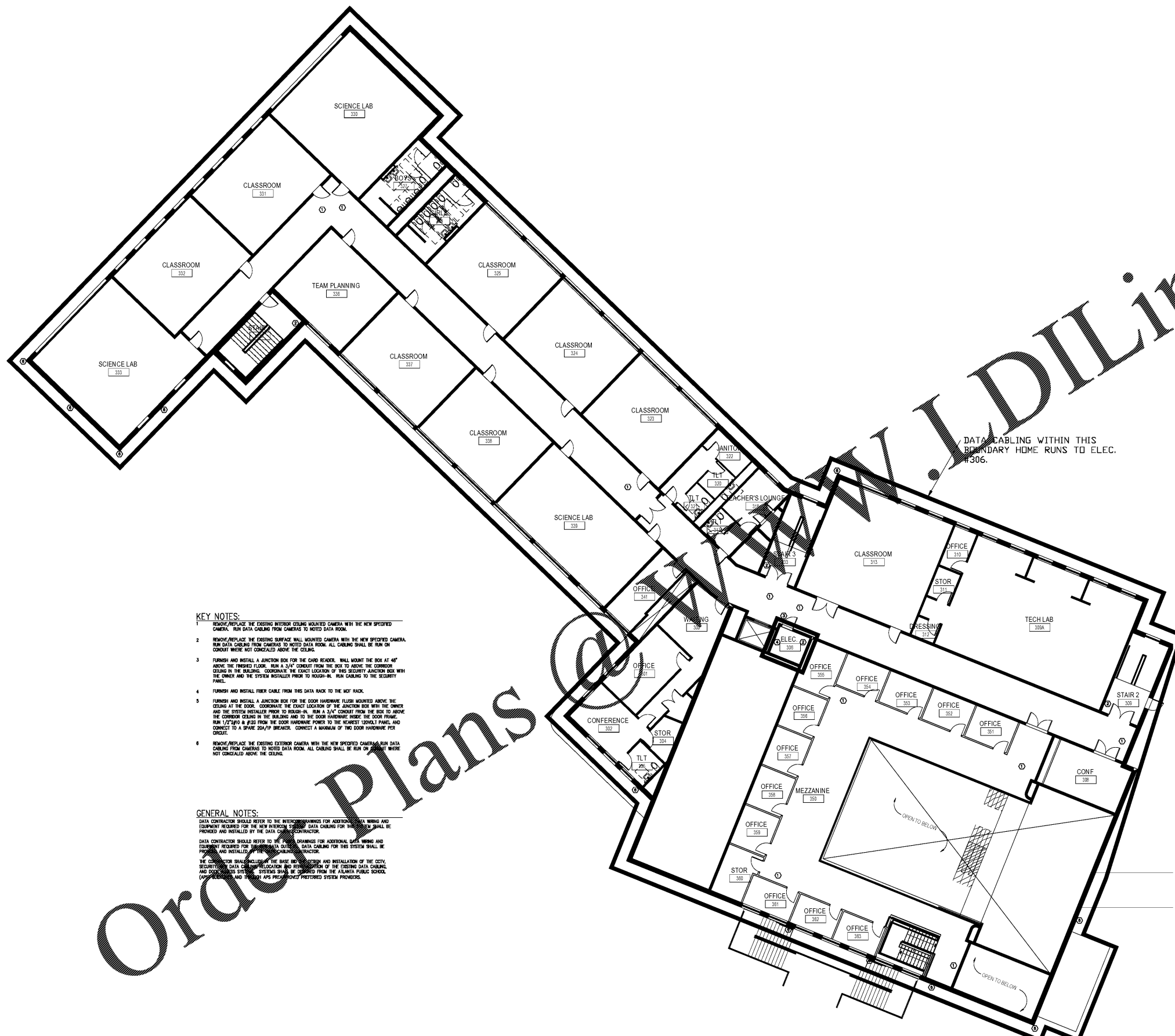

- KEY NOTES:**
- REMOVE/REPLACE THE EXISTING INTERIOR CEILING MOUNTED CAMERA WITH THE NEW SPECIFIED CAMERA. RUN DATA CABLING FROM CAMERAS TO NOTED DATA ROOM.
 - REMOVE/REPLACE THE EXISTING SURFACE WALL MOUNTED CAMERA WITH THE NEW SPECIFIED CAMERA. RUN DATA CABLING FROM CAMERAS TO NOTED DATA ROOM. ALL CABLING SHALL BE RUN ON CONDUIT WHERE NOT CONCEALED ABOVE THE CEILING.
 - FURNISH AND INSTALL A JUNCTION BOX FOR THE CORD READER. WALL MOUNT THE BOX AT 48" ABOVE THE FINISHED FLOOR. RUN A 3/4" CONDUIT FROM THE BOX TO ABOVE THE CORRIDOR CEILING IN THE BUILDING. COORDINATE THE EXACT LOCATION OF THIS SECURITY JUNCTION BOX WITH THE OWNER AND THE SYSTEM INSTALLER PRIOR TO ROUGH-IN. RUN CABLING TO THE SECURITY PANEL.
 - FURNISH AND INSTALL FIBER CABLE FROM THIS DATA BACK TO THE MFP RACK.
 - FURNISH AND INSTALL A JUNCTION BOX FOR THE DOOR HARDWARE FIBER MOUNTED ABOVE THE CEILING AT THE DOOR. COORDINATE THE EXACT LOCATION OF THE JUNCTION BOX WITH THE OWNER AND THE SYSTEM INSTALLER PRIOR TO ROUGH-IN. RUN A 3/4" CONDUIT FROM THE BOX TO ABOVE THE CORRIDOR CEILING IN THE BUILDING AND TO THE DOOR HARDWARE INSIDE THE DOOR FRAME. RUN 1/2" EMT & #12 FROM THE DOOR HARDWARE POWER TO THE NEAREST 120VOLT PANEL AND CONNECT TO A SPARE 20A/15 BREAKER. CONNECT A MINIMUM OF TWO DOOR HARDWARE PER CIRCUIT.
 - REMOVE/REPLACE THE EXISTING EXTERIOR CAMERA WITH THE NEW SPECIFIED CAMERA. RUN DATA CABLING FROM CAMERAS TO NOTED DATA ROOM. ALL CABLING SHALL BE RUN ON CONDUIT WHERE NOT CONCEALED ABOVE THE CEILING.

GENERAL NOTES:

DATA CONTRACTOR SHOULD REFER TO THE INTERIOR DRAWINGS FOR ADDITIONAL DATA WIRING AND EQUIPMENT REQUIRED FOR THE NEW NETWORK SYSTEM. DATA CABLING FOR THIS SYSTEM SHALL BE PROVIDED AND INSTALLED BY THE DATA CONTRACTOR.

DATA CONTRACTOR SHOULD REFER TO THE INTERIOR DRAWINGS FOR ADDITIONAL DATA WIRING AND EQUIPMENT REQUIRED FOR THE EXTERIOR SYSTEM. DATA CABLING FOR THIS SYSTEM SHALL BE PROVIDED AND INSTALLED BY THE DATA CONTRACTOR.

THE CONTRACTOR SHALL VERIFY THE BASE RISE SYSTEM AND INSTALLATION OF THE CCTV SECURITY SYSTEM DATA CABLING/CONNECTION AND ITS INTEGRATION OF THE EXISTING DATA CABLING AND DATA ACCESS SYSTEMS. SYSTEMS SHALL BE DERIVED FROM THE ATLANTA PUBLIC SCHOOL (APSD) NETWORK AND THEIR APPROPRIATELY PRIORITIZED SYSTEM PROVIDERS.

DATA CABLING WITHIN THIS BOUNDARY HOME RUNS TO ELEC. #306.

Plans @ PERKINS+WILL