

**KIPP ATLANTA
COLLEGIATE - Addition
and Renovations**
98 Anderson Ave NW
Atlanta GA 30314

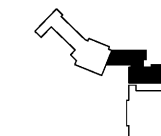

NO.	ISSUE	DATE
Job Number		
Drawn	PAT	
Checked	PAT	
Approved	PAT	

**FLOOR PLAN -
SECOND FLOOR -
PART B - SYSTEMS**

E4.2B

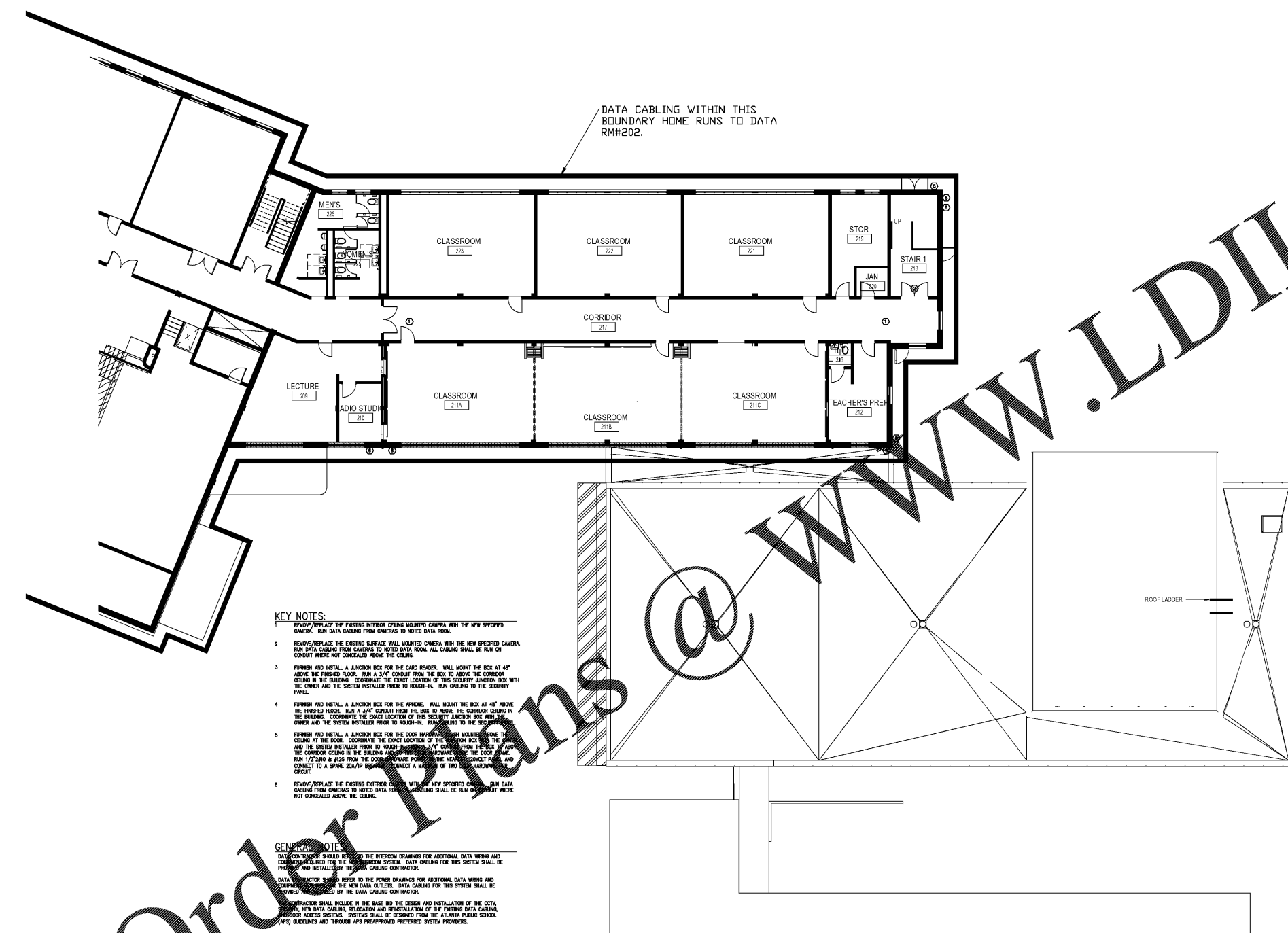

- KEY NOTES:**
- REMOVE/REPLACE THE EXISTING INTERIOR CEILING MOUNTED CAMERA WITH THE NEW SPECIFIED CAMERA. RUN DATA CABLING FROM CAMERAS TO NOTED DATA ROOM.
 - REMOVE/REPLACE THE EXISTING SURFACE WALL MOUNTED CAMERA WITH THE NEW SPECIFIED CAMERA. RUN DATA CABLING FROM CAMERAS TO NOTED DATA ROOM. ALL CABLING SHALL BE RUN ON CONDUIT WHERE NOT CONCEALED ABOVE THE CEILING.
 - FURNISH AND INSTALL A JUNCTION BOX FOR THE CARD READER. WALL MOUNT THE BOX AT 48" ABOVE THE FINISHED FLOOR. RUN A 3/4" CONDUIT FROM THE BOX TO ABOVE THE CORRIDOR CEILING IN THE BUILDING. COORDINATE THE EXACT LOCATION OF THIS SECURITY JUNCTION BOX WITH THE OWNER AND THE SYSTEM INSTALLER PRIOR TO ROUGH-IN. RUN CABLING TO THE SECURITY PANEL.
 - FURNISH AND INSTALL A JUNCTION BOX FOR THE PHONE. WALL MOUNT THE BOX AT 48" ABOVE THE FINISHED FLOOR. RUN A 3/4" CONDUIT FROM THE BOX TO ABOVE THE CORRIDOR CEILING IN THE BUILDING. COORDINATE THE EXACT LOCATION OF THIS SECURITY JUNCTION BOX WITH THE OWNER AND THE SYSTEM INSTALLER PRIOR TO ROUGH-IN. RUN CABLING TO THE SECURITY PANEL.
 - FURNISH AND INSTALL A JUNCTION BOX FOR THE DOOR HANDICAPED PUSH MOUNTED ABOVE THE CEILING AT THE DOOR. COORDINATE THE EXACT LOCATION OF THE JUNCTION BOX WITH THE OWNER AND THE SYSTEM INSTALLER PRIOR TO ROUGH-IN. RUN A 3/4" CONDUIT FROM THE BOX TO ABOVE THE CORRIDOR CEILING IN THE BUILDING AND COORDINATE THE EXACT LOCATION OF THIS SECURITY JUNCTION BOX WITH THE OWNER AND THE SYSTEM INSTALLER PRIOR TO ROUGH-IN. RUN CABLING TO THE SECURITY PANEL. RUN 1/2" CONDUIT FROM THE COORDINATE POINT TO THE NEAREST CONDUIT PANEL AND CONNECT TO A SPARE 20A/2P BRK. CONNECT A MINIMUM OF TWO SEPARATE CIRCUITS.
 - REMOVE/REPLACE THE EXISTING EXTERIOR CAMERA WITH THE NEW SPECIFIED CAMERA. RUN DATA CABLING FROM CAMERAS TO NOTED DATA ROOM. ALL CABLING SHALL BE RUN ON CONDUIT WHERE NOT CONCEALED ABOVE THE CEILING.

GENERAL NOTES:

DATA CONTRACTOR SHOULD REFER TO THE INTERCOM DRAWINGS FOR ADDITIONAL DATA WIRING AND TO BE INSTALLED FOR THE INTERCOM SYSTEM. DATA CABLING FOR THIS SYSTEM SHALL BE PROVIDED AND INSTALLED BY THE DATA CABLING CONTRACTOR.

DATA CONTRACTOR SHOULD REFER TO THE POWER DRAWINGS FOR ADDITIONAL DATA WIRING AND TO BE INSTALLED FOR THE POWER SYSTEM. DATA CABLING FOR THIS SYSTEM SHALL BE PROVIDED AND INSTALLED BY THE DATA CABLING CONTRACTOR.

CONTRACTOR SHALL INCLUDE IN THE BASE BID THE DESIGN AND INSTALLATION OF THE CCTV, DATA CABLING, TELEPHONE AND INSTALLATION OF THE EXISTING DATA CABLING, NETWORK ACCESS SYSTEMS. SYSTEMS SHALL BE DESIGNED FROM THE ATLANTA PUBLIC SCHOOL (APS) JURISDICTION AND THROUGH APS PRE-APPROVED PREFERRED SYSTEM PROVIDERS.

① 02 - SECOND FLOOR - PART B - SYSTEMS
3/32" = 1'-0"

Order Perkins

WWW.LDILine.com