

CONSULTANTS

- CIVIL**
Braedlove Land Planning
15 Simpson St. NW, Atlanta, GA 30308
- STRUCTURAL**
Uzun+Case
1230 Peachtree St. NE, Suite 2500, Atlanta, GA 30309
- MEP**
Matheson Ball & Associates
11285 Elkins Rd., Suite F3, Roswell, GA 30078
- LANDSCAPING**
Perkins+Will
1315 Peachtree St. NE, Atlanta, GA 30309
- Camacho**
3103 Medlock Bridge Road, Norcross, GA 30071

OWNER
KIPP Metro Atlanta Schools
504 Fair St. SW Suite 300

FACILITY

CONTRACTOR

PROJECT

RELEASED FOR CONSTRUCTION 06/07/2019

**KIPP ATLANTA
COLLEGIATE - Addition
and Renovations**
98 Anderson Ave NW
Atlanta GA 30314



KEYPLAN

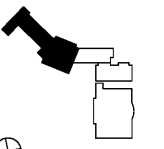

ISSUE CHART

NO.	ISSUE	DATE
Job Number		
Drawn	PAT	
Checked	PAT	
Approved	PAT	
TITLE		

**FLOOR PLAN -
SECOND FLOOR -
PART A - SYSTEMS**

SHEET NUMBER

E4.2A

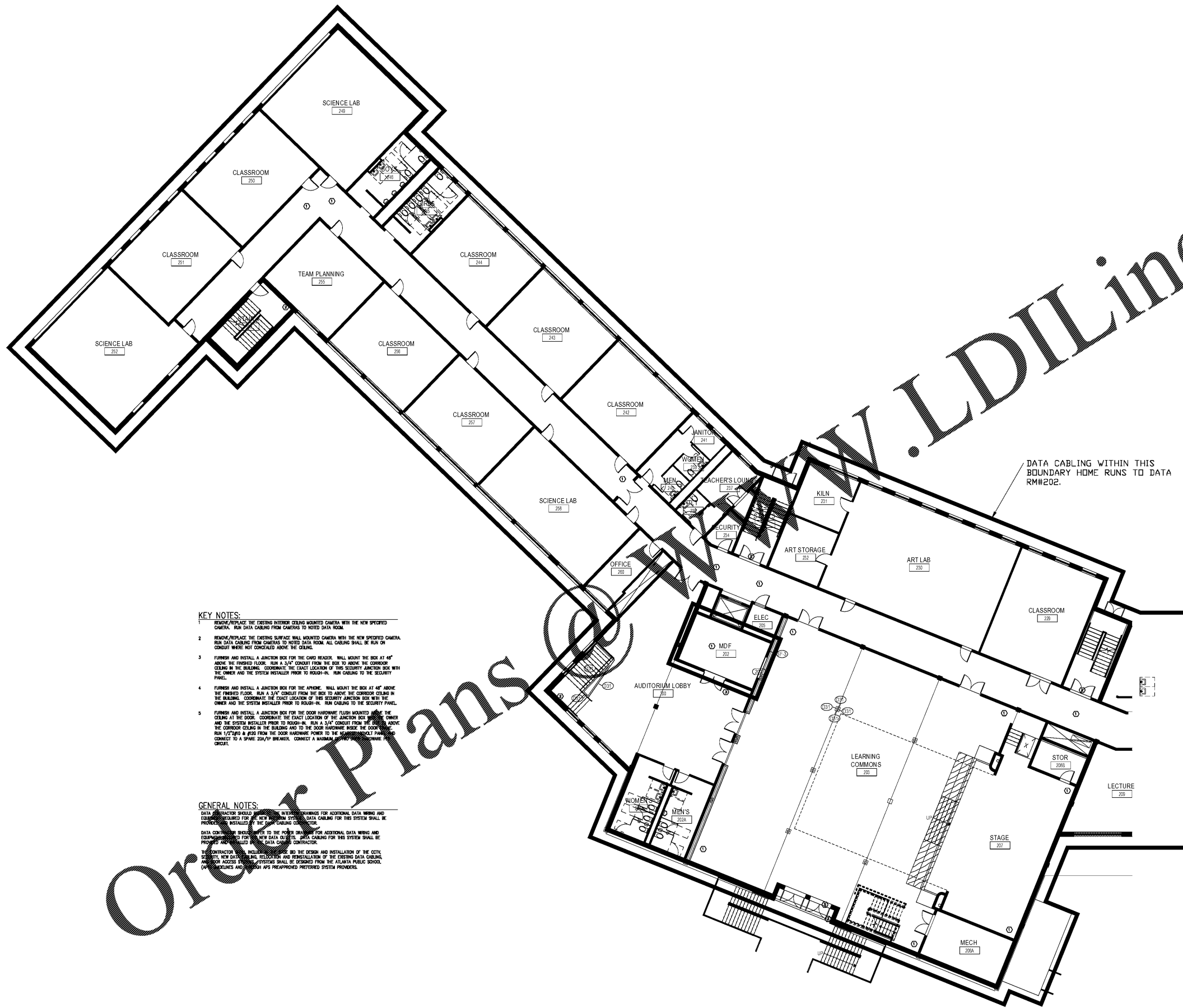

DATA CABLING WITHIN THIS
BOUNDARY HOME RUNS TO DATA
RM#202.

- KEY NOTES:**
- REMOVE/REPLACE THE EXISTING INTERIOR CEILING MOUNTED CAMERA WITH THE NEW SPECIFIED CAMERA. RUN DATA CABLING FROM CAMERAS TO NOTED DATA ROOM.
 - REMOVE/REPLACE THE EXISTING SURFACE WALL MOUNTED CAMERA WITH THE NEW SPECIFIED CAMERA. RUN DATA CABLING FROM CAMERAS TO NOTED DATA ROOM. ALL CABLING SHALL BE RUN ON CONDUIT WHERE NOT CONCEALED ABOVE THE CEILING.
 - FURNISH AND INSTALL A JUNCTION BOX FOR THE CARD READER. WALL MOUNT THE BOX AT 48" ABOVE THE FINISHED FLOOR. RUN A 3/4" CONDUIT FROM THE BOX TO ABOVE THE CORRIDOR CEILING IN THE BUILDING. COORDINATE THE EXACT LOCATION OF THIS SECURITY JUNCTION BOX WITH THE OWNER AND THE SYSTEM INSTALLER PRIOR TO ROUGH-IN. RUN CABLING TO THE SECURITY PANEL.
 - FURNISH AND INSTALL A JUNCTION BOX FOR THE PHONE. WALL MOUNT THE BOX AT 48" ABOVE THE FINISHED FLOOR. RUN A 3/4" CONDUIT FROM THE BOX TO ABOVE THE CORRIDOR CEILING IN THE BUILDING. COORDINATE THE EXACT LOCATION OF THIS SECURITY JUNCTION BOX WITH THE OWNER AND THE SYSTEM INSTALLER PRIOR TO ROUGH-IN. RUN CABLING TO THE SECURITY PANEL.
 - FURNISH AND INSTALL A JUNCTION BOX FOR THE DOOR HARDWARE FLUSH MOUNTED ABOVE THE CEILING AT THE DOOR. COORDINATE THE EXACT LOCATION OF THE JUNCTION BOX WITH THE OWNER AND THE SYSTEM INSTALLER PRIOR TO ROUGH-IN. RUN A 3/4" CONDUIT FROM THE BOX TO ABOVE THE CORRIDOR CEILING IN THE BUILDING AND TO THE DOOR HARDWARE FROM THE DOOR. RUN 1/2" EMT AND #12S FROM THE DOOR HARDWARE POWER TO THE NEAREST SPLIT PANEL AND CONNECT TO A SPARE 20A/75P BREAKER. CONNECT A MAINTAINABLE FUSE TO THE DOOR HARDWARE POWER CIRCUIT.

GENERAL NOTES:

DATA CONTRACTOR SHALL PROVIDE ALL INTERIM DRAWINGS FOR ADDITIONAL DATA WIRING AND EQUIPMENT REQUIRED FOR ALL NEW DATA SYSTEMS. DATA CABLING FOR THIS SYSTEM SHALL BE PROVIDED AND INSTALLED BY THE DATA CABLING CONTRACTOR.

DATA CONTRACTOR SHALL VERIFY TO THE POWER DRAWING FOR ADDITIONAL DATA WIRING AND EQUIPMENT REQUIRED FOR ALL NEW DATA SYSTEMS. DATA CABLING FOR THIS SYSTEM SHALL BE PROVIDED AND INSTALLED BY THE DATA CABLING CONTRACTOR.

THE CONTRACTOR SHALL VERIFY TO THE DESIGN AND INSTALLATION OF THE CITY OF ATLANTA NEW DATA WIRING, INCLUDING THE REVISIONS AND INSTALLATION OF THE EXISTING DATA CABLING. NETWORK ACCESS SYSTEMS SHALL BE DESIGNED FROM THE ATLANTA PUBLIC SCHOOL. (MATHESON BALL & ASSOCIATES PRE-APPROVED PRETEXTED SYSTEM PROVIDERS)

02 - SECOND FLOOR - PART A - SYSTEMS
3/32" = 1'-0"