

**CONSULTANTS**

**CIVIL**  
Breadlove Land Planning  
15 Simpson St. NW, Atlanta, GA 30308

**STRUCTURAL**  
Uzun+Case  
1230 Peachtree St. NE, Suite 2500, Atlanta, GA 30309

**MEP**  
Matheson Ball & Associates  
11285 Elkins Rd., Suite F3, Roswell, GA 30078

**LANDSCAPING**  
Perkins+Will  
1315 Peachtree St. NE, Atlanta, GA 30309

**Camacho**  
3103 Medcock Bridge Road, Norcross, GA 30071

**OWNER**  
KIPP Metro Atlanta Schools  
504 Fair St. SW Suite 300

**FACILITY**

**CONTRACTOR**

**PROJECT**

**KIPP ATLANTA  
COLLEGIATE - Addition  
and Renovations**  
98 Anderson Ave NW  
Atlanta GA 30314



**KEYPLAN**

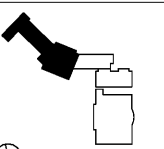

**ISSUE CHART**

DATE	ISSUE	DATE

**FLOOR PLAN - FIRST  
FLOOR - PART A - SYSTEMS**

**SHEET NUMBER**

**E4.1A**

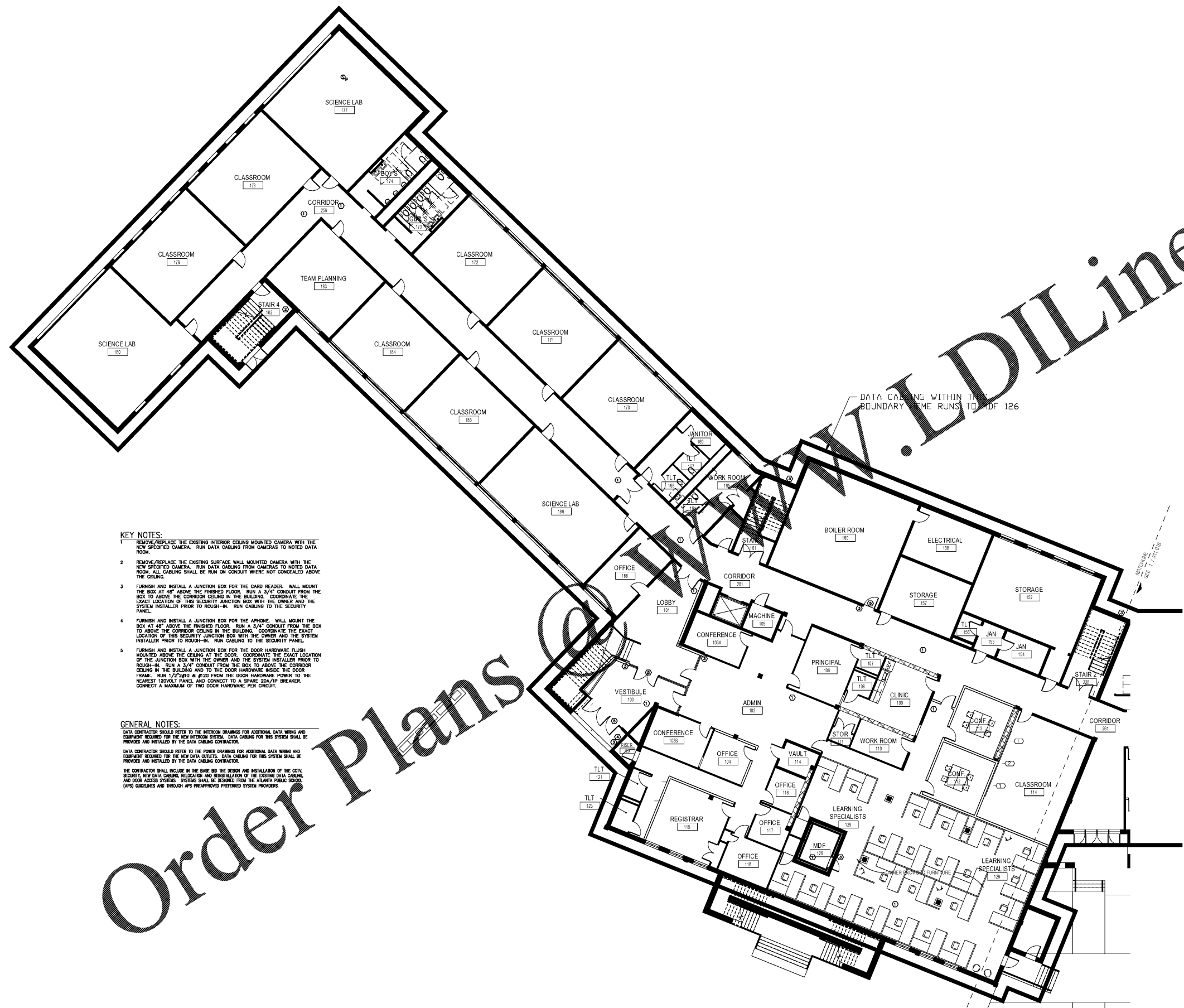

- KEY NOTES:**
- REMOVE/REPLACE THE EXISTING INTERIOR CEILING MOUNTED CAMERA WITH THE NEW SPECIFIED CAMERA. RUN DATA CABLING FROM CAMERAS TO NOTED DATA ROOM.
  - REMOVE/REPLACE THE EXISTING SURFACE WALL MOUNTED CAMERA WITH THE NEW SPECIFIED CAMERA. RUN DATA CABLING FROM CAMERAS TO NOTED DATA ROOM. ALL CABLING SHALL BE RUN ON CONDUIT WHERE NOT CONCEALED ABOVE THE CEILING.
  - FURNISH AND INSTALL A JUNCTION BOX FOR THE CARD READER. WALL MOUNT THE BOX AT 48" ABOVE THE FINISHED FLOOR. RUN A 3/4" CONDUIT FROM THE BOX TO ABOVE THE CORRIDOR CEILING IN THE BUILDING. COORDINATE THE EXACT LOCATION OF THIS SECURITY JUNCTION BOX WITH THE OWNER AND THE SYSTEM INSTALLER PRIOR TO ROUGH-IN. RUN CABLING TO THE SECURITY PANEL.
  - FURNISH AND INSTALL A JUNCTION BOX FOR THE APHONE. WALL MOUNT THE BOX AT 48" ABOVE THE FINISHED FLOOR. RUN A 3/4" CONDUIT FROM THE BOX TO ABOVE THE CORRIDOR CEILING IN THE BUILDING. COORDINATE THE EXACT LOCATION OF THIS SECURITY JUNCTION BOX WITH THE OWNER AND THE SYSTEM INSTALLER PRIOR TO ROUGH-IN. RUN CABLING TO THE SECURITY PANEL.
  - FURNISH AND INSTALL A JUNCTION BOX FOR THE DOOR HARDWARE FLUSH MOUNTED ABOVE THE CEILING AT THE DOOR. COORDINATE THE EXACT LOCATION OF THE JUNCTION BOX WITH THE OWNER AND THE SYSTEM INSTALLER PRIOR TO ROUGH-IN. RUN A 3/4" CONDUIT FROM THE BOX TO ABOVE THE CORRIDOR CEILING IN THE BUILDING AND TO THE DOOR HARDWARE INSIDE THE DOOR FRAME. RUN 1/2" 240V #12 FROM THE DOOR HARDWARE POWER TO THE NEAREST 120VOLT PANEL AND CONNECT TO A SPARE 20A/1P BREAKER. CONNECT A MAXIMUM OF TWO DOOR HARDWARE PER CIRCUIT.

**GENERAL NOTES:**

DATA CONTRACTOR SHOULD REFER TO THE INTERCOM DRAWINGS FOR ADDITIONAL DATA WIRING AND EQUIPMENT REQUIRED FOR THE NEW INTERCOM SYSTEM. DATA CABLING FOR THIS SYSTEM SHALL BE PROVIDED AND INSTALLED BY THE DATA CABLING CONTRACTOR.

DATA CONTRACTOR SHOULD REFER TO THE POWER DRAWINGS FOR ADDITIONAL DATA WIRING AND EQUIPMENT REQUIRED FOR THE NEW DATA OUTLETS. DATA CABLING FOR THIS SYSTEM SHALL BE PROVIDED AND INSTALLED BY THE DATA CABLING CONTRACTOR.

THE CONTRACTOR SHALL INCLUDE IN THE BASE BID THE DESIGN AND INSTALLATION OF THE CCTV SECURITY, NEW DATA CABLING, RELOCATION AND REINSTALLATION OF THE EXISTING DATA CABLING AND DOOR ACCESS SYSTEMS. SYSTEMS SHALL BE DESIGNED FROM THE ATLANTA PUBLIC SCHOOLS (APS) GUIDELINES AND THROUGH APS PREAPPROVED PREFERRED SYSTEM PROVIDERS.

**1 01 - FIRST FLOOR - PART - A - SYSTEMS**  
3/32" = 1'-0"