

CONSULTANTS

CIVIL
Breadlove Land Planning
15 Simpson St. NW, Atlanta, GA 30308

STRUCTURAL
Uzun+Case
1230 Peachtree St. NE, Suite 2500, Atlanta, GA 30309

MEP
Matheson Ball & Associates
11295 Elkins Rd., Suite F3, Roswell, GA 30078

LANDSCAPING
Perkins+Will
1315 Peachtree St. NE, Atlanta, GA 30309

Camacho
3103 Medlock Bridge Road, Norcross, GA 30071

OWNER
KIPP Metro Atlanta Schools
504 Fair St. SW Suite 300

FACILITY

CONTRACTOR

PROJECT

**KIPP ATLANTA
COLLEGIATE - Addition
and Renovations**
98 Anderson Ave NW
Atlanta GA 30314



KEYPLAN

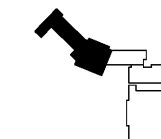

ISSUE CHART

RELEASED FOR CONSTRUCTION 06/07/2019

DATE	ISSUE	DATE

Job Number _____
 Drawn _____ PAT
 Checked _____ PAT
 Approved _____ PAT

**FLOOR PLAN - THIRD
FLOOR - PART A - INTERCOM**

SHEET NUMBER

E3.3A

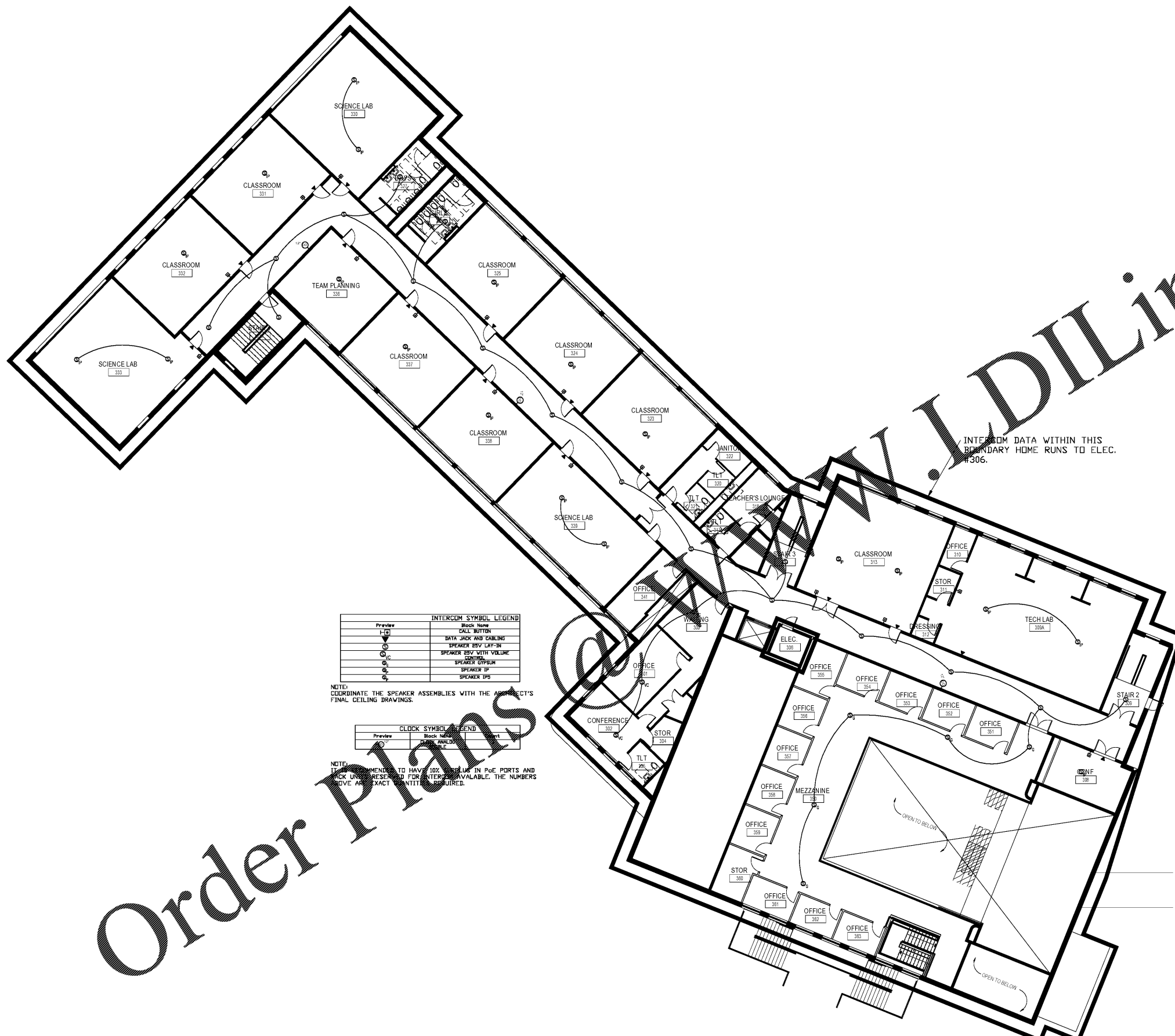

INTERCOM SYMBOL LEGEND

Preview	Block Name
TLT	TALK BUTTON
○	BATA JACK AND CABLING
○	SPEAKER BY W/ VOLUME
○	SPEAKER BY W/ VOLUME
○	SPEAKER BY W/ VOLUME
○	SPEAKER BY W/ VOLUME
○	SPEAKER BY W/ VOLUME

NOTE: COORDINATE THE SPEAKER ASSEMBLIES WITH THE ARCHITECT'S FINAL CEILING DRAWINGS.

CLOCK SYMBOL LEGEND

Preview	Block Name
○	ANALOG

NOTE: IT IS RECOMMENDED TO HAVE 10% MORE IN P&E PORTS AND CLOCK UNITS RESERVED FOR INTERCOM AVAILABLE. THE NUMBERS ABOVE ARE EXACT QUANTITIES REQUIRED.

INTERCOM DATA WITHIN THIS
BOUNDARY HOME RUNS TO ELEC.
#306.