

CONSULTANTS

CIVIL
Breadlove Land Planning
15 Simpson St NW, Atlanta, GA 30308

STRUCTURAL
Uzun+Case
1200 Peachtree St NE, Suite 2500, Atlanta, GA 30309

MEP
Matheson Ball & Associates
11285 Elkins Rd., Suite F3, Roswell, GA 30076

LANDSCAPING
Perkins+Will
1315 Peachtree St NE, Atlanta, GA 30309

Camacho
3103 Medlock Bridge Road, Norcross, GA 30071

OWNER
KIPP Metro Atlanta Schools
504 Fair St SW Suite 300

FACILITY

CONTRACTOR

PROJECT

**KIPP ATLANTA
COLLEGIATE - Addition
and Renovations**
98 Anderson Ave NW
Atlanta GA 30314



KEYPLAN

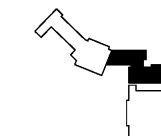

ISSUE CHART

| DATE | ISSUE | DATE |
|------|-------|------|
| | | |
| | | |
| | | |
| | | |

Job Number _____
 Drawn _____ PAT
 Checked _____ PAT
 Approved _____ PAT

TITLE

**FLOOR PLAN -
SECOND FLOOR -
PART B - INTERCOM**

SHEET NUMBER

E3.2B

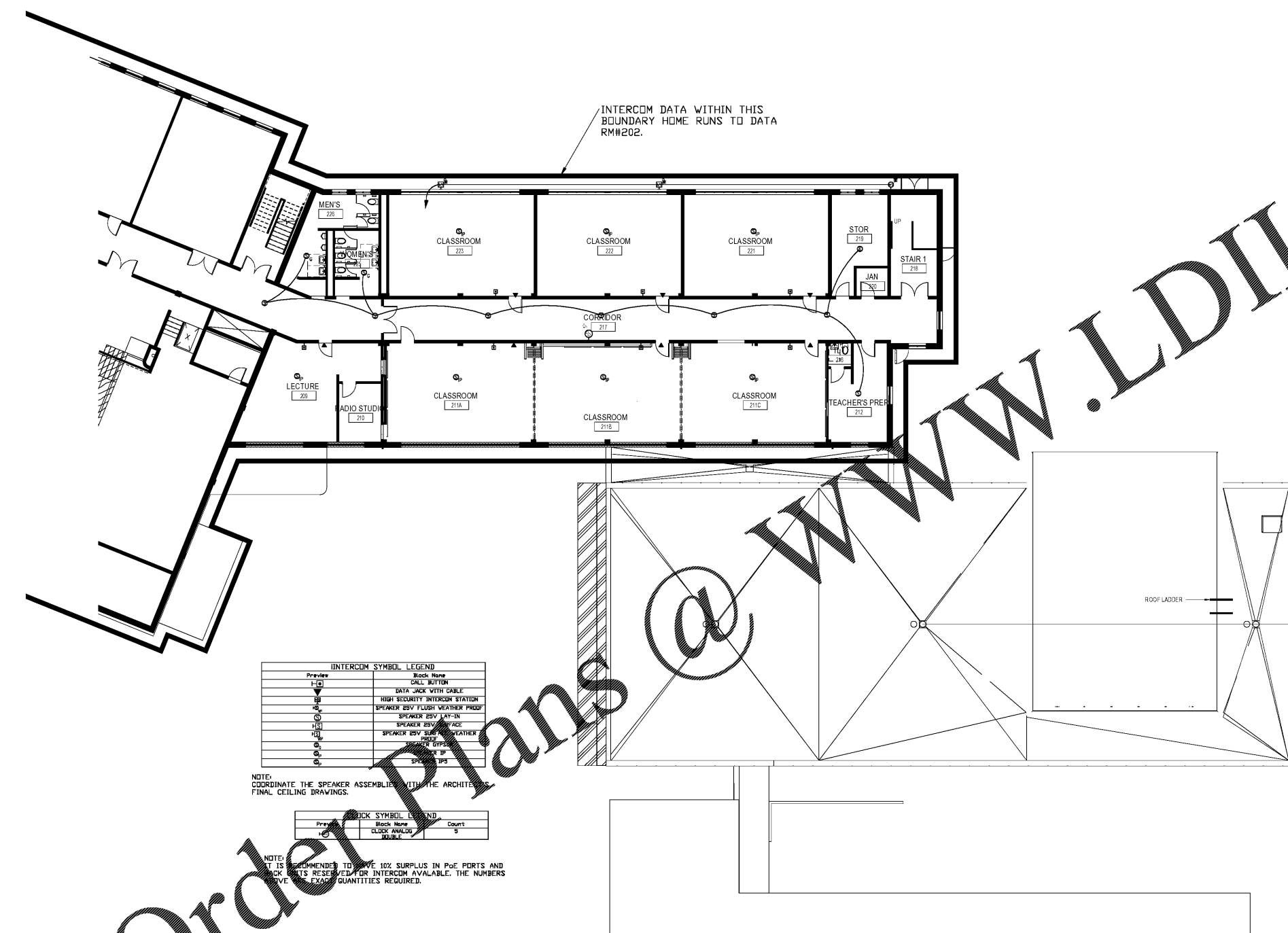

INTERCOM SYMBOL LEGEND

| Preview | Block Name |
|----------|---------------------------------|
| [Symbol] | CALL BOX/PM |
| [Symbol] | DATA JACK WITH CABLE |
| [Symbol] | HIGH SECURITY INTERCOM STATION |
| [Symbol] | SPEAKER ISV FLUSH WEATHER PROOF |
| [Symbol] | SPEAKER ISV FAY-IN |
| [Symbol] | SPEAKER ISV SURFACE |
| [Symbol] | SPEAKER ISV SURF WEATHER PROOF |
| [Symbol] | INTERCOM STATION |
| [Symbol] | STATION |
| [Symbol] | STATION |

NOTE:
COORDINATE THE SPEAKER ASSEMBLY WITH THE ARCHITECT'S FINAL CEILING DRAWINGS.

BLOCK SYMBOL LEGEND

| Preview | Block Name | Count |
|----------|---------------|-------|
| [Symbol] | CLOCK RINGING | 5 |

NOTE:
IT IS RECOMMENDED TO HAVE 10% SURPLUS IN PoE PORTS AND BLOCKS RESERVED FOR INTERCOM AVAILABLE. THE NUMBERS ABOVE EXACT QUANTITIES REQUIRED.

① 02 - SECOND FLOOR - PART B - INTERCOM
3/32" = 1'-0"

Order Plans @ WWW.LDILine.com

WWW.LDILine.com

RELEASED FOR CONSTRUCTION 06/07/2019