

**CONSULTANTS**

**CIVIL**  
Braedlove Land Planning  
15 Simpson St. NW, Atlanta, GA 30308

**STRUCTURAL**  
Uzun+Case  
1230 Peachtree St. NE, Suite 2500, Atlanta, GA 30309

**MEP**  
Matheson Ball & Associates  
11295 Elkins Rd., Suite F3, Roswell, GA 30078

**LANDSCAPING**  
Perkins+Will  
1315 Peachtree St. NE, Atlanta, GA 30309

**Camacho**  
3103 Medlock Bridge Road, Norcross, GA 30071

**OWNER**  
KIPP Metro Atlanta Schools  
504 Fair St. SW Suite 300

**FACILITY**

**CONTRACTOR**

**PROJECT**

RELEASED FOR CONSTRUCTION 06/07/2019

**KIPP ATLANTA  
COLLEGIATE - Addition  
and Renovations**  
98 Anderson Ave NW  
Atlanta GA 30314



**KEYPLAN**

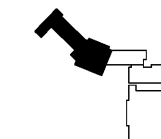

**ISSUE CHART**

DATE	ISSUE	DATE

**FLOOR PLAN - THIRD  
FLOOR - PART A - POWER**

**SHEET NUMBER**

**E2.3A**

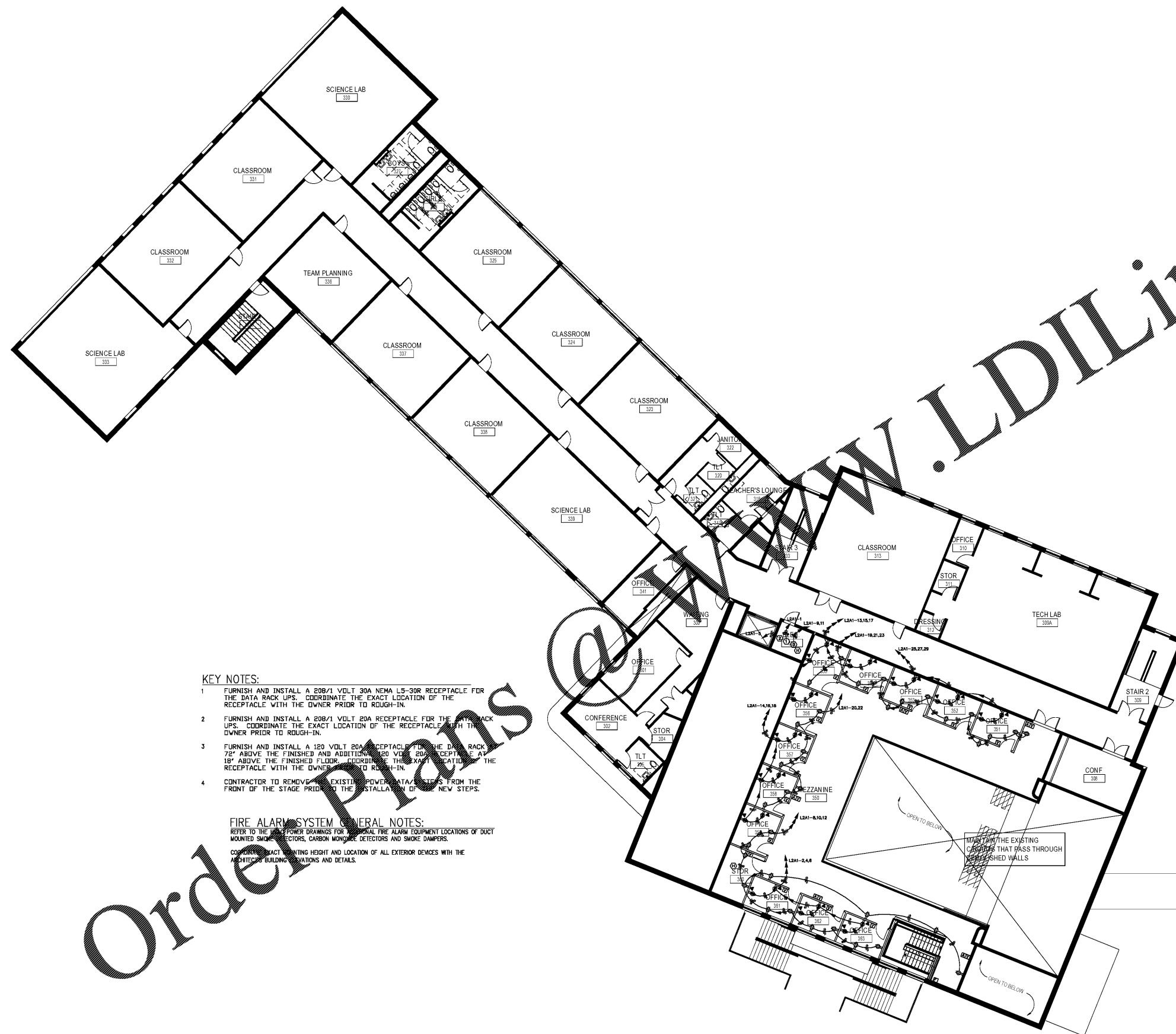

**KEY NOTES:**

- FURNISH AND INSTALL A 208/1 VOLT 30A NEMA L5-30R RECEPTACLE FOR THE DATA RACK UPS. COORDINATE THE EXACT LOCATION OF THE RECEPTACLE WITH THE OWNER PRIOR TO ROUGH-IN.
- FURNISH AND INSTALL A 208/1 VOLT 20A RECEPTACLE FOR THE DATA RACK UPS. COORDINATE THE EXACT LOCATION OF THE RECEPTACLE WITH THE OWNER PRIOR TO ROUGH-IN.
- FURNISH AND INSTALL A 120 VOLT 20A RECEPTACLE FOR THE DATA RACK 72" ABOVE THE FINISHED FLOOR AND ADDITIONAL 120 VOLT 20A RECEPTACLE AT 18" ABOVE THE FINISHED FLOOR. COORDINATE THE EXACT LOCATION OF THE RECEPTACLE WITH THE OWNER PRIOR TO ROUGH-IN.
- CONTRACTOR TO REMOVE ALL EXISTING POWER DATA/STEPS FROM THE FRONT OF THE STAGE PRIOR TO THE INSTALLATION OF THE NEW STEPS.

**FIRE ALARM SYSTEM GENERAL NOTES:**

REFER TO THE MECH POWER DRAWINGS FOR REGIONAL FIRE ALARM EQUIPMENT LOCATIONS OF DUCT MOUNTED SMOKE DETECTORS, CARBON MONOXIDE DETECTORS AND SMOKE DAMPERS.

COORDINATE EXACT MOUNTING HEIGHT AND LOCATION OF ALL EXTERIOR DEVICES WITH THE ARCHITECT'S BUILDING ELEVATIONS AND DETAILS.

Order Plans @ WWW.LDILine.com