

**CONSULTANTS**

**CIVIL**  
Braedlove Land Planning  
15 Simpson St. NW, Atlanta, GA 30308

**STRUCTURAL**  
Uzun+Case  
1230 Peachtree St. NE, Suite 2500, Atlanta, GA 30309

**MEP**  
Matheson Ball & Associates  
11285 Elkins Rd., Suite F3, Roswell, GA 30078

**LANDSCAPING**  
Perkins+Will  
1315 Peachtree St. NE, Atlanta, GA 30309

**Camacho**  
3103 Medlock Bridge Road, Norcross, GA 30071

**OWNER**  
KIPP Metro Atlanta Schools  
504 Fair St. SW Suite 300

**FACILITY**

**CONTRACTOR**

**PROJECT**

**KIPP ATLANTA  
COLLEGIATE - Addition  
and Renovations**  
98 Anderson Ave NW  
Atlanta GA 30314



**KEYPLAN**

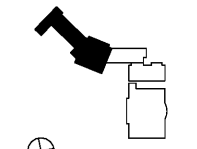

**ISSUE CHART**

NO.	DATE	DESCRIPTION

NO.	DATE	DESCRIPTION

**TITLE**  
FLOOR PLAN -  
SECOND FLOOR -  
PART A - POWER

**SHEET NUMBER**

**E2.2A**

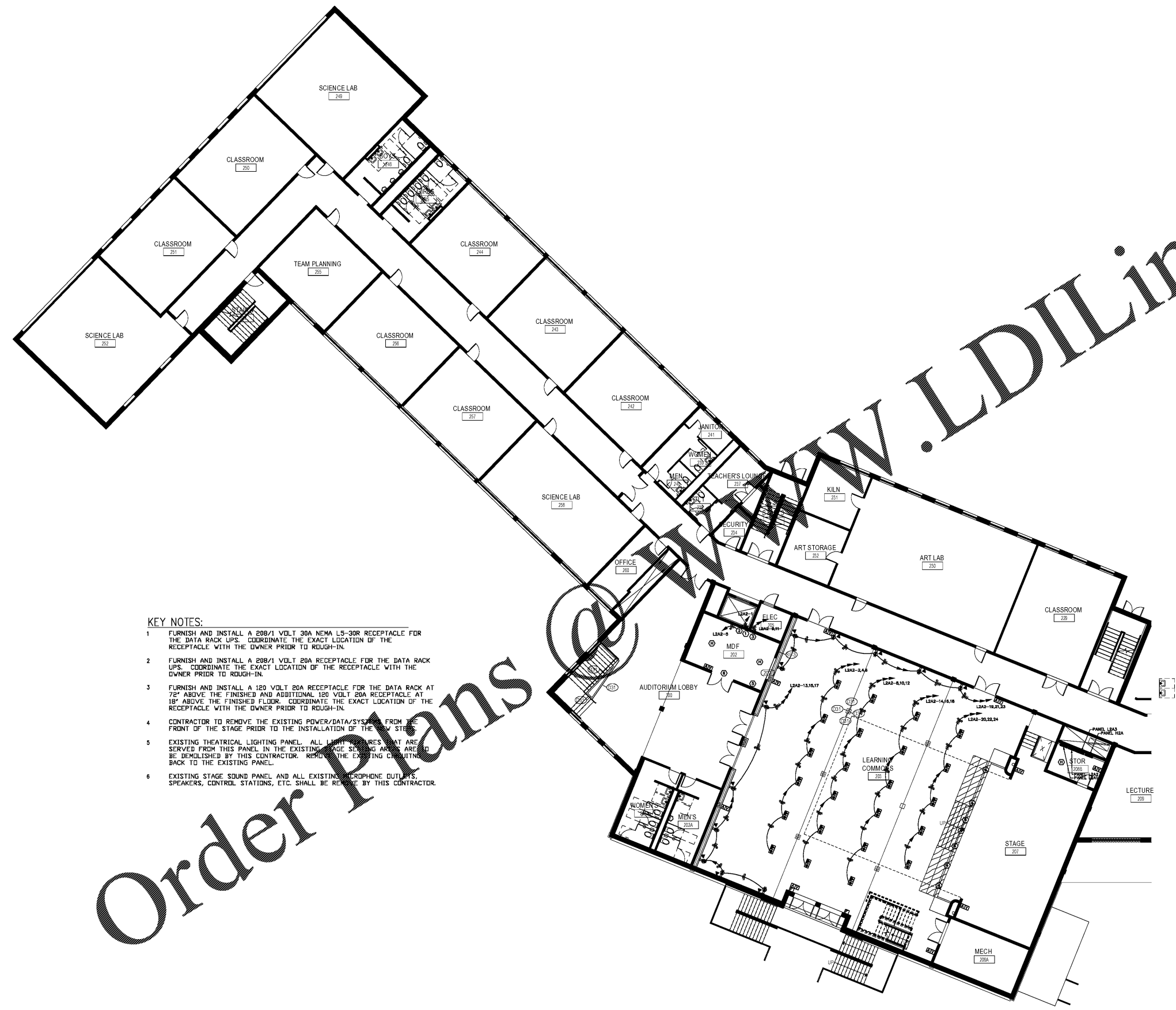

**KEY NOTES:**

- FURNISH AND INSTALL A 208/1 VOLT 30A NEMA L5-30R RECEPTACLE FOR THE DATA RACK UPS. COORDINATE THE EXACT LOCATION OF THE RECEPTACLE WITH THE OWNER PRIOR TO ROUGH-IN.
- FURNISH AND INSTALL A 208/1 VOLT 20A RECEPTACLE FOR THE DATA RACK UPS. COORDINATE THE EXACT LOCATION OF THE RECEPTACLE WITH THE OWNER PRIOR TO ROUGH-IN.
- FURNISH AND INSTALL A 120 VOLT 20A RECEPTACLE FOR THE DATA RACK AT 72" ABOVE THE FINISHED FLOOR AND ADDITIONAL 120 VOLT 20A RECEPTACLE AT 18" ABOVE THE FINISHED FLOOR. COORDINATE THE EXACT LOCATION OF THE RECEPTACLE WITH THE OWNER PRIOR TO ROUGH-IN.
- CONTRACTOR TO REMOVE THE EXISTING POWER/DATA/SYSTEMS FROM THE FRONT OF THE STAGE PRIOR TO THE INSTALLATION OF THE NEW STAGE.
- EXISTING THEATRICAL LIGHTING PANEL. ALL LIGHT FIXTURES THAT ARE SERVED FROM THIS PANEL IN THE EXISTING STAGE SEATING AREAS ARE TO BE DEMOLISHED BY THIS CONTRACTOR. REMOVE THE EXISTING CIRCUITRY BACK TO THE EXISTING PANEL.
- EXISTING STAGE SOUND PANEL AND ALL EXISTING MICROPHONE OUTLETS, SPEAKERS, CONTROL STATIONS, ETC. SHALL BE REMOVED BY THIS CONTRACTOR.

Order Plans @ PERKINS+WILL.LDILine.com