

KEY NOTES:

- FURNISH AND INSTALL A 208/1 VOLT 30A NEMA L5-30R RECEPTACLE FOR THE DATA RACK UPS. COORDINATE THE EXACT LOCATION OF THE RECEPTACLE WITH THE OWNER PRIOR TO ROUGH-IN.
- FURNISH AND INSTALL A 208/1 VOLT 20A RECEPTACLE FOR THE DATA RACK UPS. COORDINATE THE EXACT LOCATION OF THE RECEPTACLE WITH THE OWNER PRIOR TO ROUGH-IN.
- FURNISH AND INSTALL A 120 VOLT 20A RECEPTACLE FOR THE DATA RACK AT 72" ABOVE THE FINISHED AND ADDITIONAL 120 VOLT 20A RECEPTACLE AT 18" ABOVE THE FINISHED FLOOR. COORDINATE THE EXACT LOCATION OF THE RECEPTACLE WITH THE OWNER PRIOR TO ROUGH-IN.
- FURNISH AND INSTALL A 4' X 8' X 3/4" PLYWOOD TELEPHONE BACKBOARD WITH A #6 GROUND FROM THE FLOOR TO CEILING ON ALL OF THE DATA ROOM WALLS. FURNISH AND INSTALL A GROUND BUS ON THE BACKBOARD AT EACH WALL AND CONNECT TO THE GROUND CONDUCTOR. PAINT BACKBOARD WITH A GREY FIRE RETARDANT PAINT.
- INSTALL THE RECEPTACLE UNDER THE ELECTRICAL WATER COOLER AND NOT CONCEALED BEHIND THE EQUIPMENT. COORDINATE THE EXACT LOCATION WITH THE PLUMBING CONTRACTOR PRIOR TO ROUGH-IN. RUN THE CIRCUIT TO THE BREAKER IN THE DESIGNATED PANEL.
- FURNISH AND INSTALL TWO 120 VOLT 20A DOUBLE DUPLEX RECEPTACLES FOR THE SOUND SYSTEM. COORDINATE THE EXACT LOCATION OF THE RECEPTACLES WITH THE SOUND SYSTEM CONTRACTOR. EACH CIRCUIT SHALL HAVE A DEDICATED NEUTRAL AND GROUND CONDUCTOR.

FIRE ALARM SYSTEM GENERAL NOTES

REFER TO THE HVAC DRAWINGS FOR ADDITIONAL FIRE ALARM EQUIPMENT LOCATIONS OF DUCT MOUNTED SMOKE DETECTOR, CARBON MONOXIDE DETECTORS AND SMOKE DAMPERS.
COORDINATE EXACT MOUNTING HEIGHT AND LOCATION OF ALL EXTERIOR DEVICES WITH THE ARCHITECT'S BUILDING ELEVATIONS AND DETAILS.

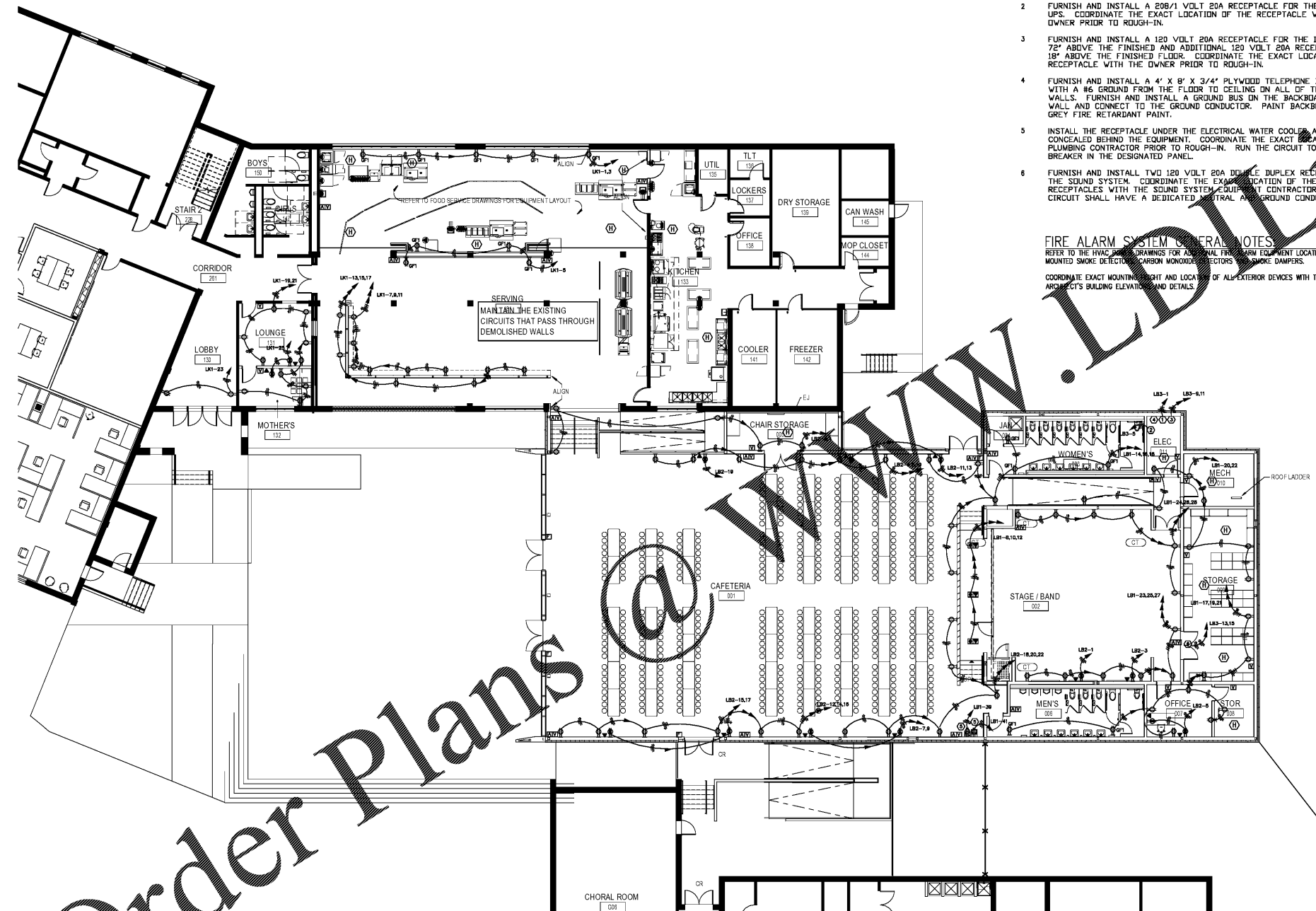

Order Plans @ www.perkinswill.com

① 01 - FIRST FLOOR - PART - B - POWER
3/32" = 1'-0"