

Order Plans @

WWW.LDILine.com

1 OVERALL FLOOR PLAN-LEVEL 03  
1" = 20'-0"

**PERKINS  
+ WILL**

1315 Peachtree St. NE  
Atlanta, GA 30309  
404.873.2300  
404.802.5523  
www.perkinswill.com

**CONSULTANTS**

**ARCHITECT**  
Beehive Land Planning  
15 Simpson St NW, Atlanta, GA 30309

**STRUCTURAL**  
Uzun+Case  
1220 Peachtree St. NE, Suite 2500, Atlanta, GA 30309

**MEP**  
Matheson Ball & Associates  
11285 Elkins Rd., Suite F3, Roswell, GA 30076

**LANDSCAPE**  
Perkins+Will  
1315 Peachtree St. NE, Atlanta, GA 30309

**KITCHEN**  
Camacho  
3103 Medlock Bridge Road, Norcross, GA 30071

KIPP Metro Atlanta Schools - 1405  
Maynard Road, NW Atlanta, GA 30331

**FACILITY**

**CONTRACTOR**



PROJECT

KIPP ATLANTA  
COLLEGIATE - Addition  
and Renovations

RELEASED FOR CONSTRUCTION 06/07/2019

**KEYPLAN**

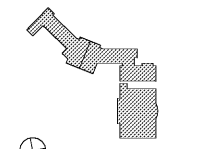

**ISSUE CHART**

DATE	ISSUE	DATE
Job Number		
Drawn	MSK	
Checked	GC	
Approved	GC	
TITLE		

**OVERALL FLOOR PLAN  
- THIRD FLOOR**

**SHEET NUMBER**

**M10-03**

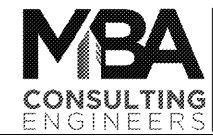

MBA # 19002

MATHEWSON BALL & ASSOCIATES, INC.  
11285 ELKINS RD., SUITE F-3  
ROSWELL, GEORGIA 30076  
PHONE: (770) 761-1073  
WWW.MATHEWSONBALL.COM

Copyright © 2019 Perkins+Will