

Order Plans @

REFER TO ARCHITECTURAL PLANS FOR CEILING DEMOLITION, WHERE CEILINGS ARE DEMOLISHED, DEMOLISH EXISTING AIR DISTRIBUTION AND ASSOCIATED FLEX DUCT TYPICAL.

ALL HVAC EQUIPMENT NOT SPECIFICALLY ADDRESSED IN THE CONSTRUCTION DOCUMENTS IS TO REMAIN AS-IS. IN SERVICE. ADEQUATELY PROTECT ALL REMAINING EQUIPMENT DURING CONSTRUCTION TO PREVENT DAMAGE.

CONTRACTOR'S DEMOLITION NOTE:
 THE INFORMATION CONTAINED IN THESE DEMOLITION DOCUMENTS IS NOT TO BE CONSIDERED AS COMPLETE AND FULLY ACCURATE AS PERTAINS TO THE EXACT QUANTITY AND LOCATION OF ALL SYSTEM COMPONENTS. THE INFORMATION CONTAINED HEREIN WAS OBTAINED FROM ORIGINAL DESIGN DOCUMENTS AND LIMITED SITE VISITS. IT SHALL BE THE CONTRACTOR'S RESPONSIBILITY TO FIELD VERIFY THE EXACT LOCATION, SERVICE, AND QUANTITY OF ALL EXISTING SYSTEM COMPONENTS PRIOR TO BEGINNING DEMOLITION WORK. THE INFORMATION CONTAINED HEREIN IS TO BE USED SOLELY AS AN AID TO THE CONTRACTOR IN COMPLETING THE CONTRACT. ADDITIONAL INFORMATION CONCERNING EXISTING ITEMS TO BE REUSED CAN BE FOUND ON DOCUMENTS CONTAINING NEW WORK.

- KEYNOTES (APPLIES TO THIS SHEET ONLY):**
- EXISTING DISHWASHER SHALL BE DEMOLISHED AND DISCARDED OFF-SITE. ASSOCIATED DUCTWORK AND CONTROLS SHALL BE DEMOLISHED AND DISCARDED OFF-SITE TO THE EXISTING SHOWER.
 - EXISTING EXHAUST FAN AND ASSOCIATED CONTROLS SHALL BE DEMOLISHED AND DISCARDED OFF-SITE. EXISTING DUCTWORK EITHER SIDE OF EXHAUST FAN SHALL BE DEMOLISHED AND DISCARDED OFF-SITE AS REQUIRED FOR INSTALLATION OF NEW EXHAUST FAN AT SAME LOCATION.
 - EXISTING SUPPLY AIR DISTRIBUTION DEVICE AND ASSOCIATED FLEX DUCT SHALL BE DEMOLISHED AND DISCARDED OFF-SITE (TYPICAL).
 - EXISTING RETURN AIR DISTRIBUTION DEVICE AND ASSOCIATED SOUND BOOT SHALL BE DEMOLISHED AND DISCARDED OFF-SITE (TYPICAL).
 - EXISTING CHILTRON ASSOCIATED PIPING AND CONTROLS SHALL REMAIN FOR RELOCATION AND REUSE. ASSOCIATED CONCRETE PAD AND FENCING SHALL BE DEMOLISHED AND DISCARDED OFF-SITE.
 - EXISTING SIDE WALL SUPPLY AIR DISTRIBUTION DEVICE SHALL BE DEMOLISHED AND DISCARDED OFF-SITE. ASSOCIATED EXISTING BRANCH DUCT SHALL BE DEMOLISHED AND DISCARDED OFF-SITE. WALL SHALL BE PATCHED TO MATCH EXISTING WALL APPEARANCE AND RATING.
 - EXISTING MAIN HEATERS AND ASSOCIATED CONTROLS SHALL BE DEMOLISHED AND DISCARDED OFF-SITE.
 - EXISTING BRANCH DUCT BACK TO DUCT MAN SHALL BE DEMOLISHED AND DISCARDED OFF-SITE. EXISTING MAIN DUCT SHALL BE PATCHED, INSULATED, AND SEALED.
 - EXISTING CONTROLS ROUTED ON TOP OF EXISTING CANOPY SHALL BE MAINTAINED DURING CONSTRUCTION. CONTRACTOR SHALL ENSURE CONTINUED CONTROL FUNCTION TO GYM THROUGHOUT CONSTRUCTION.
 - EXISTING MECHANICAL CONTROLS SHALL BE RELOCATED IN THIS AREA.



1 OVERALL DEMOLITION PLAN - LEVEL 01
 1" = 20'-0"

PERKINS + WILL

1315 Peachtree St. NE
 Atlanta, GA 30309
 404.873.2300
 404.922.5522
 www.perkinswill.com

CONSULTANTS

15 Simpson St. NW, Atlanta, GA 30309

1220 Peachtree St. NE, Suite 2500, Atlanta, GA 30309

11285 Elkins Rd., Suite F3, Roswell, GA 30076

1315 Peachtree St. NE, Atlanta, GA 30309

3103 Medlock Bridge Road, Norcross, GA 30071

KIPP Metro Atlanta Schools 1448
 Maynard Road, NW Atlanta, GA 30331

KIPP Metro Atlanta Schools 1448
 Maynard Road, NW Atlanta, GA 30331

KIPP Metro Atlanta Schools 1448
 Maynard Road, NW Atlanta, GA 30331

KIPP Metro Atlanta Schools 1448
 Maynard Road, NW Atlanta, GA 30331

KIPP Metro Atlanta Schools 1448
 Maynard Road, NW Atlanta, GA 30331

KIPP Metro Atlanta Schools 1448
 Maynard Road, NW Atlanta, GA 30331

KIPP Metro Atlanta Schools 1448
 Maynard Road, NW Atlanta, GA 30331

KIPP Metro Atlanta Schools 1448
 Maynard Road, NW Atlanta, GA 30331

KIPP Metro Atlanta Schools 1448
 Maynard Road, NW Atlanta, GA 30331

KIPP Metro Atlanta Schools 1448
 Maynard Road, NW Atlanta, GA 30331

KIPP Metro Atlanta Schools 1448
 Maynard Road, NW Atlanta, GA 30331

KIPP Metro Atlanta Schools 1448
 Maynard Road, NW Atlanta, GA 30331

KIPP Metro Atlanta Schools 1448
 Maynard Road, NW Atlanta, GA 30331

KIPP Metro Atlanta Schools 1448
 Maynard Road, NW Atlanta, GA 30331

KIPP Metro Atlanta Schools 1448
 Maynard Road, NW Atlanta, GA 30331

KIPP Metro Atlanta Schools 1448
 Maynard Road, NW Atlanta, GA 30331

KIPP Metro Atlanta Schools 1448
 Maynard Road, NW Atlanta, GA 30331

KIPP Metro Atlanta Schools 1448
 Maynard Road, NW Atlanta, GA 30331

KIPP Metro Atlanta Schools 1448
 Maynard Road, NW Atlanta, GA 30331

KIPP Metro Atlanta Schools 1448
 Maynard Road, NW Atlanta, GA 30331

KIPP Metro Atlanta Schools 1448
 Maynard Road, NW Atlanta, GA 30331

KIPP Metro Atlanta Schools 1448
 Maynard Road, NW Atlanta, GA 30331

KIPP Metro Atlanta Schools 1448
 Maynard Road, NW Atlanta, GA 30331

KIPP Metro Atlanta Schools 1448
 Maynard Road, NW Atlanta, GA 30331

KIPP Metro Atlanta Schools 1448
 Maynard Road, NW Atlanta, GA 30331

KIPP Metro Atlanta Schools 1448
 Maynard Road, NW Atlanta, GA 30331

KIPP Metro Atlanta Schools 1448
 Maynard Road, NW Atlanta, GA 30331

KIPP Metro Atlanta Schools 1448
 Maynard Road, NW Atlanta, GA 30331

KIPP Metro Atlanta Schools 1448
 Maynard Road, NW Atlanta, GA 30331

KIPP Metro Atlanta Schools 1448
 Maynard Road, NW Atlanta, GA 30331

KIPP Metro Atlanta Schools 1448
 Maynard Road, NW Atlanta, GA 30331

KIPP Metro Atlanta Schools 1448
 Maynard Road, NW Atlanta, GA 30331

KIPP Metro Atlanta Schools 1448
 Maynard Road, NW Atlanta, GA 30331

KIPP Metro Atlanta Schools 1448
 Maynard Road, NW Atlanta, GA 30331

KIPP Metro Atlanta Schools 1448
 Maynard Road, NW Atlanta, GA 30331

KIPP Metro Atlanta Schools 1448
 Maynard Road, NW Atlanta, GA 30331

KIPP Metro Atlanta Schools 1448
 Maynard Road, NW Atlanta, GA 30331

KIPP Metro Atlanta Schools 1448
 Maynard Road, NW Atlanta, GA 30331



KIPP ATLANTA COLLEGIATE - Addition and Renovations

KEYPLAN

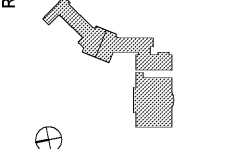

ISSUE CHART

DATE	ISSUE	DATE
Job Number		
Drawn	MSK	
Checked	GC	
Approved	GC	

OVERALL DEMOLITION PLAN - LEVEL 01

SHEET NUMBER

M04-01

MBA
 CONSULTING ENGINEERS

MBA # 19002
 MATHEWSON BALL & ASSOCIATES, INC.
 11285 ELKINS RD., SUITE F3
 ROSWELL, GEORGIA 30076
 PHONE: (770) 761-0713
 WWW.MATHEWSONBALL.COM

Copyright © 2018 Perkins+Will