

**CONSULTANTS**

**civil**  
Braslowe Land Planning  
15 Simpson St. NW, Atlanta, GA 30308

**STRUCTURAL**  
Lujan-Cabe  
1230 Peachtree St. N.E., Suite 2500 Atlanta, GA  
30309

**MEP**  
Matheson Ball & Associates  
11285 Elkins Rd., Suite F3, Roswell, GA 30076

**LANDSCAPING**  
Perkins+Will  
1315 Peachtree St. NE, Atlanta, GA 30309

**Camacho**  
3103 Medlock Bridge Road, Norcross, GA  
30071

**OWNER**  
KIPP Metro Atlanta Schools  
1445 Maynard Road NW, Atlanta, GA 30331

**ARCHIT.**

**CONTRACTOR**

**PROJECT**

**KIPP ATLANTA  
COLLEGIATE - Addition  
and Renovations**  
98 Anderson Ave NW  
Atlanta GA 30314

**KEYPLAN**

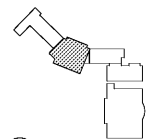

**ISSUE CHART**



DATE	ISSUE	DATE
18220		
SG		
SG		
JH		

**FOUNDATION PLAN -  
PART A**

**SHEET NUMBER**

**S11-01A**

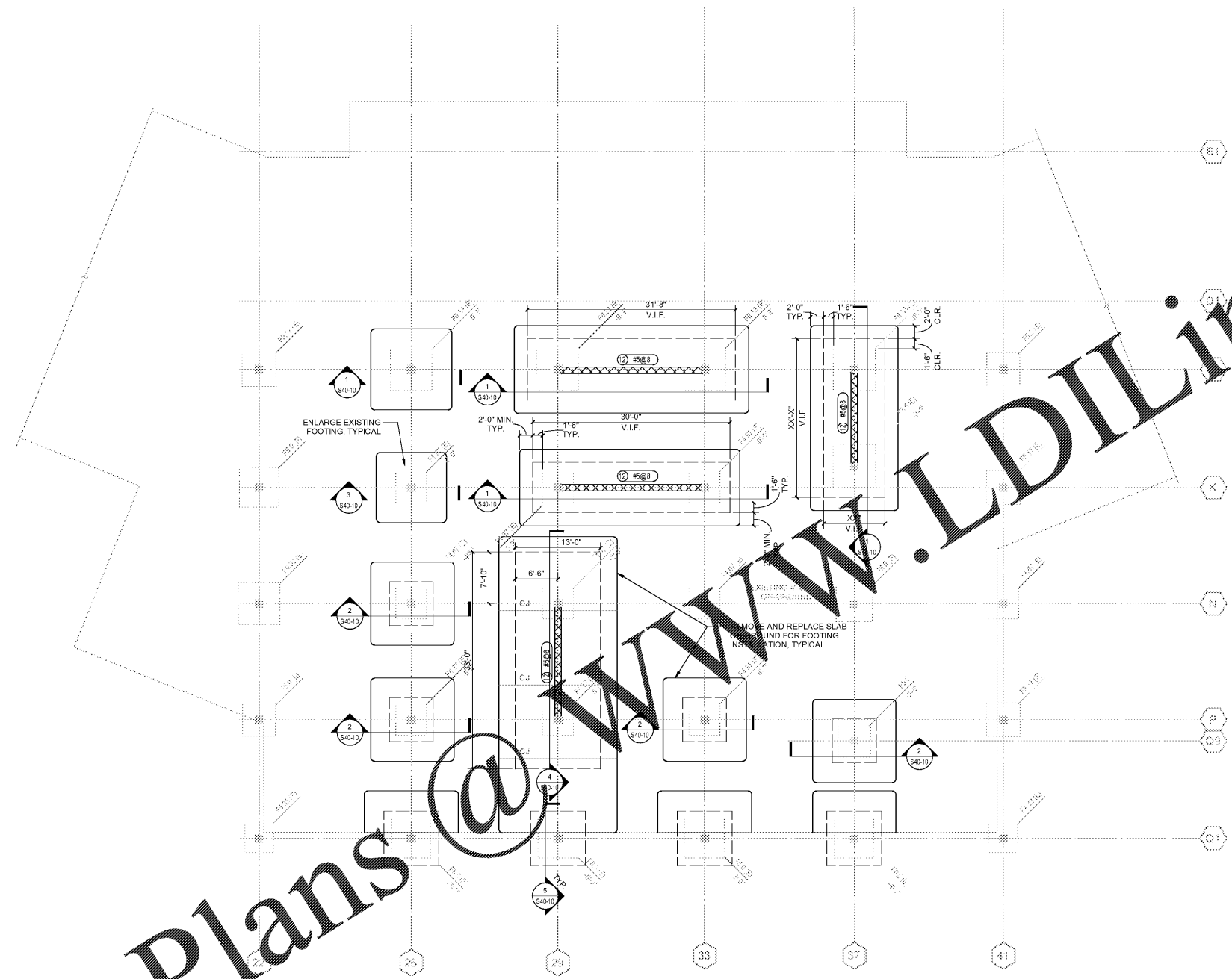

**FOUNDATION PLAN - PART A**  
SCALE: 1/8" = 1'-0"

- FOUNDATION & S.O.G. NOTES:**
1. NEW SLAB-ON-GROUND THICKNESS IS 5" U.N.O. SEE GENERAL NOTES FOR ADDITIONAL INFORMATION.
  2. C.J. INDICATES CONTRACTION JOINT. SEE 7/S01-01. DO NOT CUT IN STRUCTURED SLABS. SEE 9/S01-01 FOR CONSTRUCTION JOINT DETAIL.

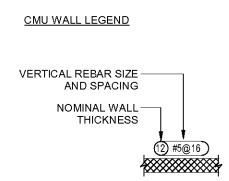

Order Plans @ [www.LDILine.com](http://www.LDILine.com)