

Order Plans @ www.LDILine.com

1 FINISH FLOOR PLAN - FIRST FLOOR - PART C
3/32" = 1'-0"

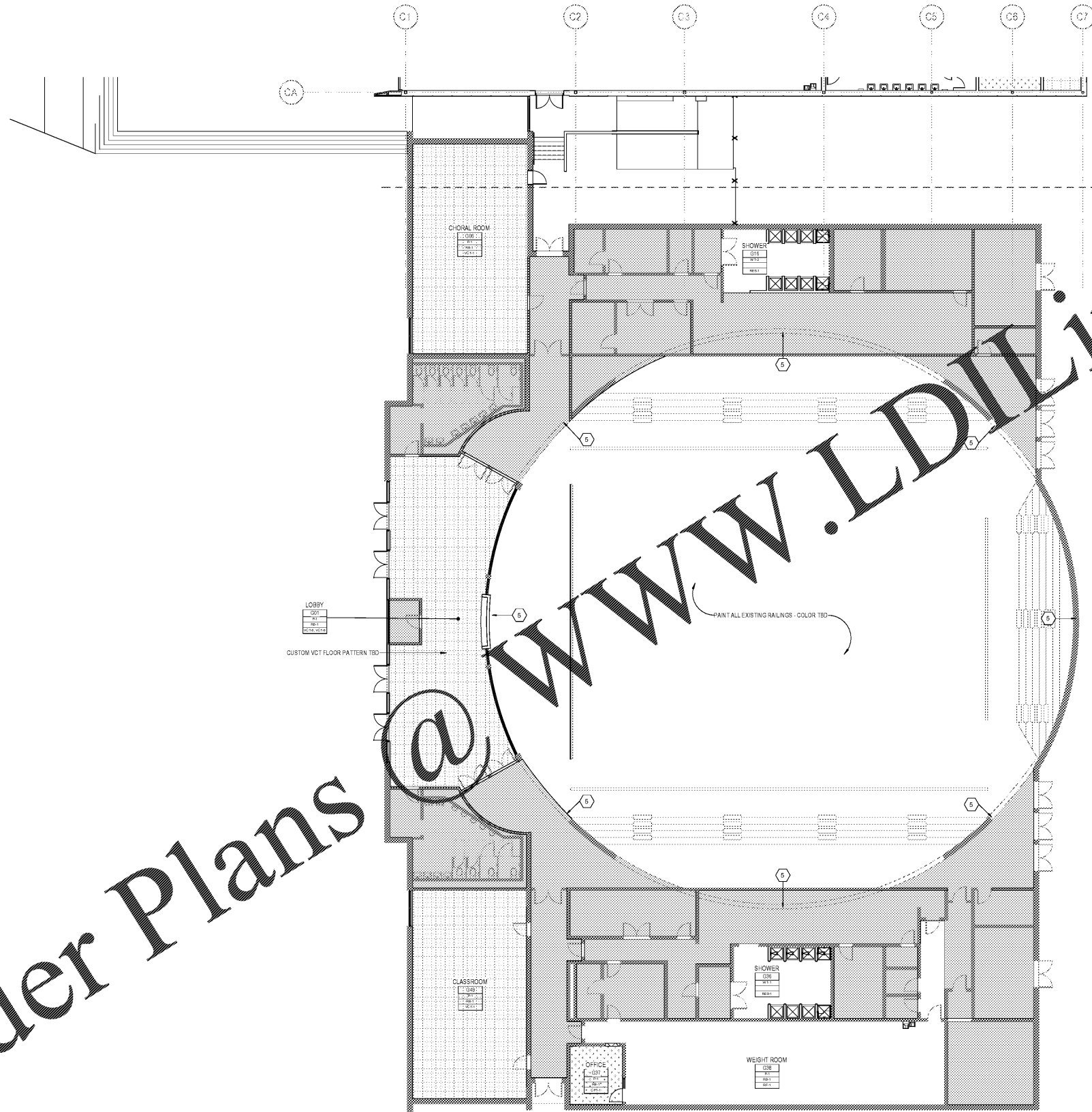

**INTERIOR FINISH PLAN
GENERAL NOTES**

- FIELD PAINT WALLS P-1, EGGSHELL FINISH, UNO
- ALL INTERIOR PAINTED FINISHES TO RECEIVE NEW PAINT
- ALL HM DOOR FRAMES TO BE PAINTED P-10, SEMI-GLOSS, UNO
- DOOR FRAMES OCCURRING IN ACCENT WALLS TO BE THE SAME COLOR AS THE WALL ON WHICH IT OCCURS, SEMI-GLOSS FINISH
- ALL CEILINGS TO BE PAINTED P-1 FLAT FINISH, UNO
- ALL RUBBER BASE TO BE RB-1, UNO, COLOR TO MATCH STOREFRONT
- ALL PARTITIONS TO RECEIVE NEW B-4
- ALL EXPOSED CONCRETE COLUMNS TO RECEIVE RB-1 AT BASE AND P-1
- INSTALL RUBBER CARPET TRANSITION STRIP ON LOCATIONS WHERE THERE IS A CHANGE IN MATERIAL OR FLOOR LEVEL AND THE CARPET EDGE IS EXPOSED, EXCEPT WHERE ANOTHER DEVICE SUCH AS A THRESHOLD IS INDICATED
- EXTEND SPECIFIED FLOORING INTO CLOSETS, UNO
- ALIGN TILE BASE GROUT LINES WITH WALL TILE GROUT LINES AND FLOOR TILE GROUT LINES WITH TILE BASE GROUT LINES
- REFER ALL INTERIOR SIGNAGE TO SIGNAGE PACKAGE
- APPLY P-9 CLEAR COAT TO ALL INTERIOR WALL SURFACES
- ALL EXPOSED COLUMNS TO BE PAINTED P-1
- ALL EXISTING FINISHES TO REMAIN UNLESS SPECIFICALLY NOTED OTHERWISE

- FINISH MARKER**
- FINISH MARKER
 - XXX WALL ACCENT MARKER
 - NOT IN SCOPE

- FLOOR FINISH**
- VCT-1 VCT-2 VCT-3 VCT-4
 - VCT-5 VCT-6 VCT-7 OPT-1 WD-1

FLOOR & WALL FINISH/CONCRETE SEALANT TO BE APPLIED ON ALL PAINTED FLOOR SURFACES

- PNT-1 PNT-2 PNT-3 PNT-4 PNT-5 PNT-6**
- OPT-1 GWC-1 GWC-2 SC-1**

**INTERIOR FINISH
MATERIAL SCHEDULE**

- AWP-1 ACOUSTICAL WALL PANEL, GULLFORD OF MAINE, STUDIO 54 2966, SHIMMER PINK (1010 287), CRYSTAL 7049
- OPT-1 CARPET TILE, INTERFACE - EXPOSED, 888' IRON WORKS
- ALL VCT TO HAVE IMPERIAL TEXTURE WITH DIAMOND 10 COATING TECHNOLOGY
- VCT-1 ARMS TRONG STANDARD EXCELON - TRACERY
- VCT-2 ARMS TRONG STANDARD EXCELON - GRASSIN GREEN
- VCT-3 ARMS TRONG STANDARD EXCELON - SEA GREEN
- VCT-4 ARMS TRONG STANDARD EXCELON - CLASSIC BLACK
- VCT-5 ARMS TRONG STANDARD EXCELON - VICIOUS VIOLET
- VCT-6 ARMS TRONG STANDARD EXCELON - TYRAN PURPLE
- VCT-7 ARMS TRONG STANDARD EXCELON - VIOLET BLOOM
- P-1 PAINT: SHERWIN WILLIAMS (FIELD COLOR) - SW 708 ALABASTER
- P-2 PAINT: SHERWIN WILLIAMS (ACCENT) - SW 621 ELECTRIC BLUE
- P-3 PAINT: SHERWIN WILLIAMS (ACCENT) - SW 624 DIRECT GREEN
- P-4 PAINT: SHERWIN WILLIAMS (ACCENT) - SW 625 ENVY
- P-5 PAINT: SHERWIN WILLIAMS (ACCENT) - SW 618 GREENS
- P-6 PAINT: SHERWIN WILLIAMS (ACCENT) - SW 623 FULLY PURPLE
- P-7 PAINT: SHERWIN WILLIAMS (ACCENT) - SW 624 CLAD YELLOW
- P-8 PAINT: SHERWIN WILLIAMS (BLACK) - SW 626 TRICOON BLACK
- P-9 PAINT: DECA PAINT (CLEAR) - WRITABLE SURFACE
- P-10 PAINT: SHERWIN WILLIAMS (GREY) - TBD
- PL-1 PLASTIC LAMINATE: WILSONART (WHITE) - DESIGNER WHITE
- PL-2 PLASTIC LAMINATE: WILSONART (GREY) - PLATINUM
- PL-3 PLASTIC LAMINATE: WILSONART (WOOD) - HIGHLINE
- RA-1 RUBBER STAIR ACCESSORIES: BASIS OF DESIGN ALLSTATE STAIR TREAD WITH INTEGRATED RISER, RAISED ROUND, LANDINGS TO BE SMOOTH
- RF-1 RUBBER SPORT FLOORING, TARKETT REPLAY SPORT SHEET COLOR TBD
- RB-1 RUBBER BASE: JOHNSONITE - 21 PLATINUM OG
- RB-2 RUBBER BASE: JOHNSONITE - BLACK TBD
- RES-1 EPOXY RESINOUS FLOORING, KEY RESIN, CUSTOM COLOR TBD (GRAY)
- PC-1 POLISHED CONCRETE
- SC-1 SEALED CONCRETE
- SSM-1 SOLID SURFACE: WILSONART (WHITE) - ARTIC DUNE
- SSM-2 SOLID SURFACE: WILSONART (GREY) - ZEN GREY
- WT-1 WALL TILE: DAL TILE, 1X3 LATTICE WEAVE MOSAIC, COLOR TBD
- WT-2 WALL TILE: DAL TILE, 1X3 LATTICE WEAVE MOSAIC, COLOR TBD
- WD-0 EXISTING WOOD TO BE REFINISHED
- WD-1 WOOD: ANTRISTY - ASHLAND OAK S0190
- WD-2 PLYWOOD FLOOR ON SLEEPERS (SEE DETAIL) (PLYWOOD PAINTED BLACK)
- GWC-1 DIGITAL GRAPHIC WALL COVERING (SEE BRANDING PACKAGE)
- GWC-2 DIGITAL GRAPHIC WALL COVERING FOR GLASS DOOR (SEE BRANDING PACKAGE)

FINISH PLAN KEY NOTES

- COORDINATE FINAL FLOOR PATTERN WITH BRANDING PACKAGE
- ALL STAIR TREAD AND RISERS TO BE REPLACED WITH RA-1
- AREA TO BE SEALED CONCRETE
- CUSTOM PAINTED FLOOR GRAPHIC ON CONCRETE SURFACE: REFER TO BRANDING PACKAGE FOR FINAL DESIGN. APPLY CONCRETE SEALER COATING (SEALMASTER CONCRETE CLEAR)
- CUSTOM PAINTED/DIGITAL PRINTED WALL GRAPHIC (REFER TO BRANDING PACKAGE)

**PERKINS
+ WILL**

1315 Peachtree St NE
Atlanta, GA 30309
t 404.873.2600
f 404.873.2923
www.perkinswill.com

CONSULTANTS

CIVIL
Breadlove Land Planning
15 Simpson St NW, Atlanta, GA 30308

STRUCTURAL
Lizaj+Cass
1230 Peachtree St NE, Suite 2500, Atlanta, GA 30309

MEP
Matheson Dal & Associates
11285 Elkins Rd., Suite F3, Roswell, GA 30076

LANDSCAPE
Perkins+WILL
1315 Peachtree St NE, Atlanta, GA 30309

FF&E
Camacho
3103 Medlock Bridge Road, Norcross, GA 30071

OWNER
KIPP Metro Atlanta Schools
1445 Maynard Road NW, Atlanta, GA 30331

FACILITY

CONTRACTOR

PROJECT

**KIPP ATLANTA
COLLEGIATE - Addition
and Renovations**
98 Anderson Ave NW
Atlanta GA 30314



KEYPLAN

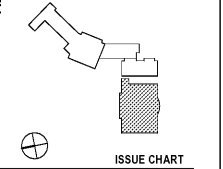

ISSUE CHART

DATE	DESCRIPTION	BY
07/20/19	ISSUE	DATE
Job Number	801660.000	
Drawn	Author	
Checked	Checker	
Approved	Approver	

**FINISH FLOOR PLAN -
FIRST FLOOR - PART C**

SHEET NUMBER

A13-01C