

CONSULTANTS

civil
Breadlove Land Planning
15 Simpson St NW, Atlanta, GA 30308

structural
Lizaj+CBS
1200 Peachtree St. NE, Suite 2500, Atlanta, GA 30309

MEP
Matheson Bai & Associates
11285 Elkins Rd., Suite F3, Roswell, GA 30076

LANDSCAPING
Perkins+Wili
1315 Peachtree St. NE, Atlanta, GA 30309

interior
Camacho
3103 Medlock Bridge Road, Norcross, GA 30071

OWNER
KIPP Metro Atlanta Schools
1445 Maynard Road NW, Atlanta, GA 30331

FACTORY

CONTRACTOR

PROJECT

**KIPP ATLANTA
COLLEGIATE - Addition
and Renovations**
98 Anderson Ave NW
Atlanta GA 30314



KEYPLAN

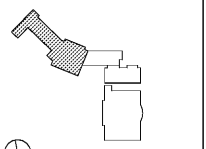

ISSUE CHART

RELEASED FOR CONSTRUCTION 06/07/2019

DATE	BY	DATE
Job Number	801660.000	
Drawn	Author	
Checked	Checker	
Approved	Approver	

**REFLECTED CEILING
PLAN - THIRD FLOOR -
PART A**

SHEET NUMBER

A12-03A

RCP PLAN GENERAL NOTES

- DESIGN INTENT TO MATCH NEW CEILING HEIGHTS WITH EXISTING CEILING HEIGHTS. FOR AREAS WHERE CEILING HEIGHTS DIFFER FROM EXISTING CONDITIONS, ALL DEVICES AND SPRINKLER HEADS SHALL BE ADJUSTED TO MATCH NEW CEILING HEIGHTS.
- SPRINKLER HEAD LOCATIONS ARE NOT SHOWN ON ARCHITECTURAL REFLECTED CEILING PLANS (BUILDING IS TO BE "FULLY SPRINKLERED") PER NFPA 13 AND OWNER'S INSURANCE COMPANY'S REQUIREMENTS.
- SEE ELECTRICAL DRAWINGS FOR THE LOCATIONS OF CEILING MOUNTED SMOKE DETECTORS, SPRINKLERS, EXIT SIGNAGE, FIRE ALARM DEVICES, WALL MOUNTED EXIT LIGHTS, CLOCKS, ETC.
- REFER TO ENLARGED PLANS, SECTIONS, ELEVATIONS, AND DETAILS FOR ADDITIONAL DIMENSIONS.
- COORDINATE GYPSUM BOARD FURR DOWN HEIGHTS WITH FULL HEIGHT CABINETS AND INTERIOR ELEVATIONS.
- 18" MINIMUM VERTICAL CLEARANCE SHALL BE MAINTAINED BETWEEN THE BOTTOM OF EXTENDED SPRINKLER HEADS AND THE TOP OF FILES, SHELVING, LOCKERS, ETC.
- THE CONTRACTOR SHALL VERIFY THAT ACCESS PANELS OF TYPES SPECIFIED ARE INSTALLED IN NON-ACCESSIBLE TYPES OF ACCESS. SERVICE ADJUSTMENT TO MECHANICAL, PLUMBING, ELECTRICAL SYSTEMS MAY REQUIRE ACCESS PANELS SHALL BE OF THE RATED EQUAL TO THE RATING OF THE CEILING IN WHICH THEY OCCUR.
- REFER TO INTERIOR FINISH PLANS AND SPECIES FOR FINISH MATERIAL INFORMATION.
- PANEL ACCESS PANELS PER P-1 UNLESS OTHERWISE NOTED.
- SEE ELECTRICAL FOR THE LOCATION OF THE STOR. AV STOR. LIGHTING.
- SEE EXTERIOR CANOPIES THAT RECEIVE NEW LIGHTS ARE TO BE PAINTED TO MATCH EXISTING COLOR.

RCP LEGEND

- NOT IN SCOPE
- SUSPENDED 2 X 2' ACOUSTICAL CEILING SYSTEM
- SUPPLY AIR GRILLE
REFER TO MECHANICAL DRAWINGS FOR ADDITIONAL INFORMATION
- RETURN AIR GRILLE
REFER TO MECHANICAL DRAWINGS FOR ADDITIONAL INFORMATION
- EXHAUST AIR GRILLE
REFER TO MECHANICAL DRAWINGS FOR ADDITIONAL INFORMATION
- SUPPLY STRIP DIFFUSER RE: MECHANICAL
- C.J. CONTROL JOINT
- CEILING DETAIL / SECTION TAG
- CEILING HEIGHT DESIGNATION PER AREA. WHERE NO HEIGHT IS DESIGNATED, ASSUME MATCH EXISTING HEIGHT
- EXISTING CEILING (E)
- WALL MOUNTED LIGHT FIXTURE
- GYPSUM BOARD CEILING
- EXPOSED CONCRETE STRUCTURE
- B-1 BLINDS TO MATCH EXISTING
- DOVE FIXTURES - SEE ELECTRICAL
- EXIT SIGN - SEE ELECTRICAL
- EXIT SIGN W/ ARROW - SEE ELECTRICAL
- EMERGENCY LIGHT FIXTURE
- SMOKE DETECTOR

RCP KEY NOTES

- NO CUT ACT TILES AT PERIMETER
- COORDINATE CEILING WITH STAGE LIGHTING
- PROVIDE PROJECTOR
- EXPOSED STRUCTURE ABOVE CEILING TO BE PAINTED - COLOR TBD
- PROVIDE PROJECTOR - COORDINATE WITH DATA/ELEC
- COORDINATE CEILING OPENING FOR STAGE LIGHTING WITH ELECTRICAL
- NO THROUGH WALL PENETRATIONS

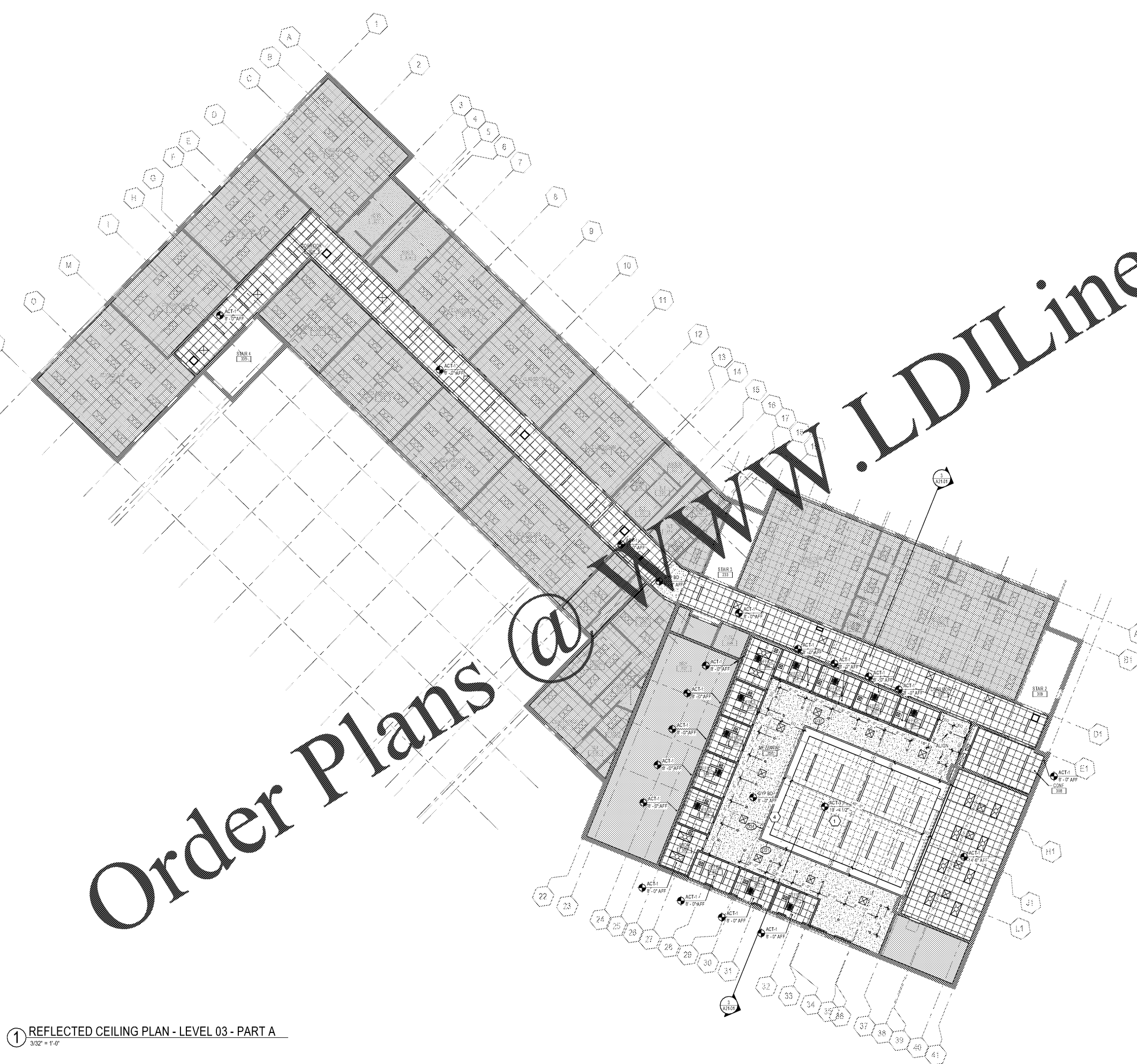

1 REFLECTED CEILING PLAN - LEVEL 03 - PART A
3/32" = 1'-0"