

**CONSULTANTS**

**CIVIL**  
Breadlove Land Planning  
15 Simpson St NW, Atlanta, GA 30308

**STRUCTURAL**  
Lizari-Cabe  
1230 Peachtree St NE, Suite 2500, Atlanta, GA 30309

**MEP**  
Matheson Ball & Associates  
11285 Elkins Rd., Suite F3, Roswell, GA 30076

**LANDSCAPING**  
Perkins+Wili  
1315 Peachtree St NE, Atlanta, GA 30309

**PAVING**  
Camacho  
3103 Medlock Bridge Road, Norcross, GA 30071

**OWNER**  
KIPP Metro Atlanta Schools  
1445 Maynard Road NW, Atlanta, GA 30331

**FACTORY**

**CONTRACTOR**

**PROJECT**

**KIPP ATLANTA  
COLLEGIATE - Addition  
and Renovations**  
98 Anderson Ave NW  
Atlanta GA 30314



**KEYPLAN**

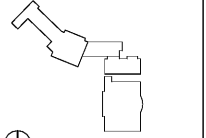

**ISSUE CHART**

DATE	ISSUE	DATE
07/2019	Job Number	801660.000
	Drawn	Author
	Checked	Checker
	Approved	Approver

**ARCHITECTURAL SITE PLAN**

SHEET NUMBER

**A01-01**

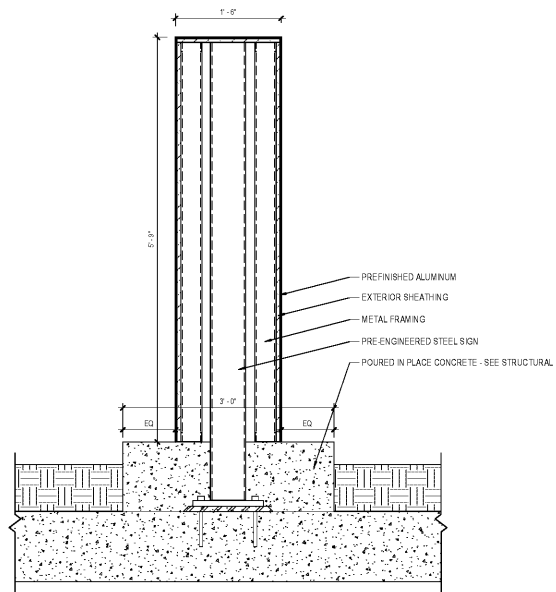

**4 MONUMENT SIGN SECTION**  
1" = 1'-0"

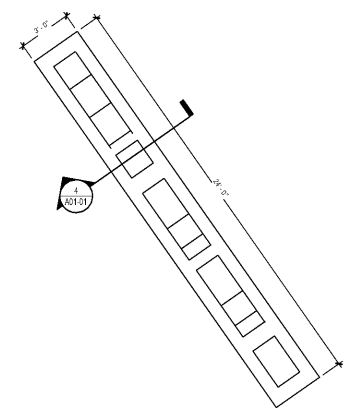

**3 MONUMENT SIGN ENLARGED PLAN**  
1/4" = 1'-0"

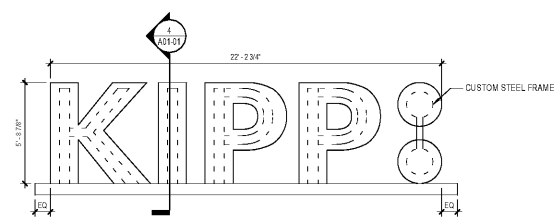

**2 MONUMENT SIGN ELEVATION**  
1/4" = 1'-0"

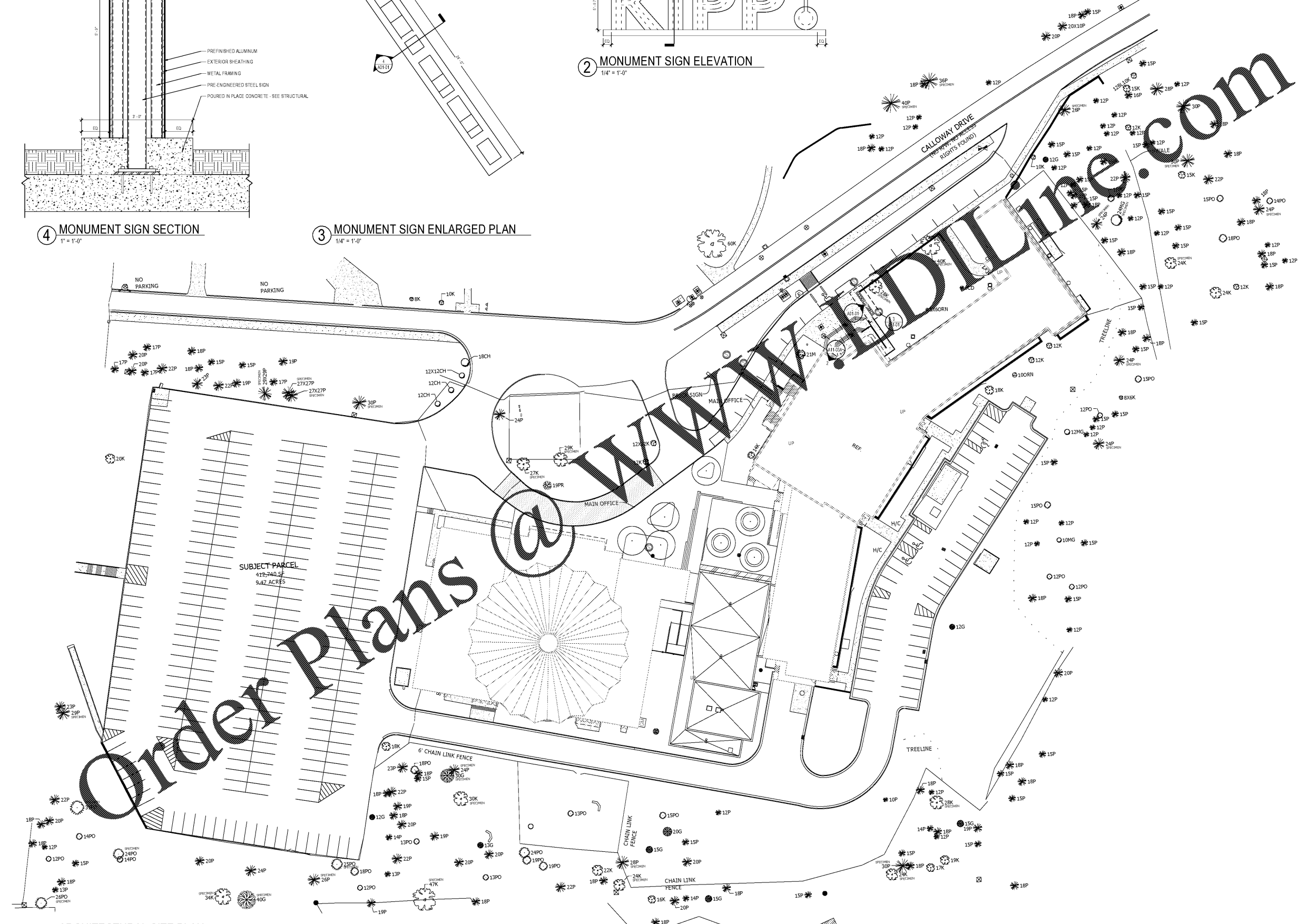

**1 ARCHITECTURAL SITE PLAN**  
1/32" = 1'-0"