

① LEVEL 02 - OCCUPANCY
1" = 20'-0"

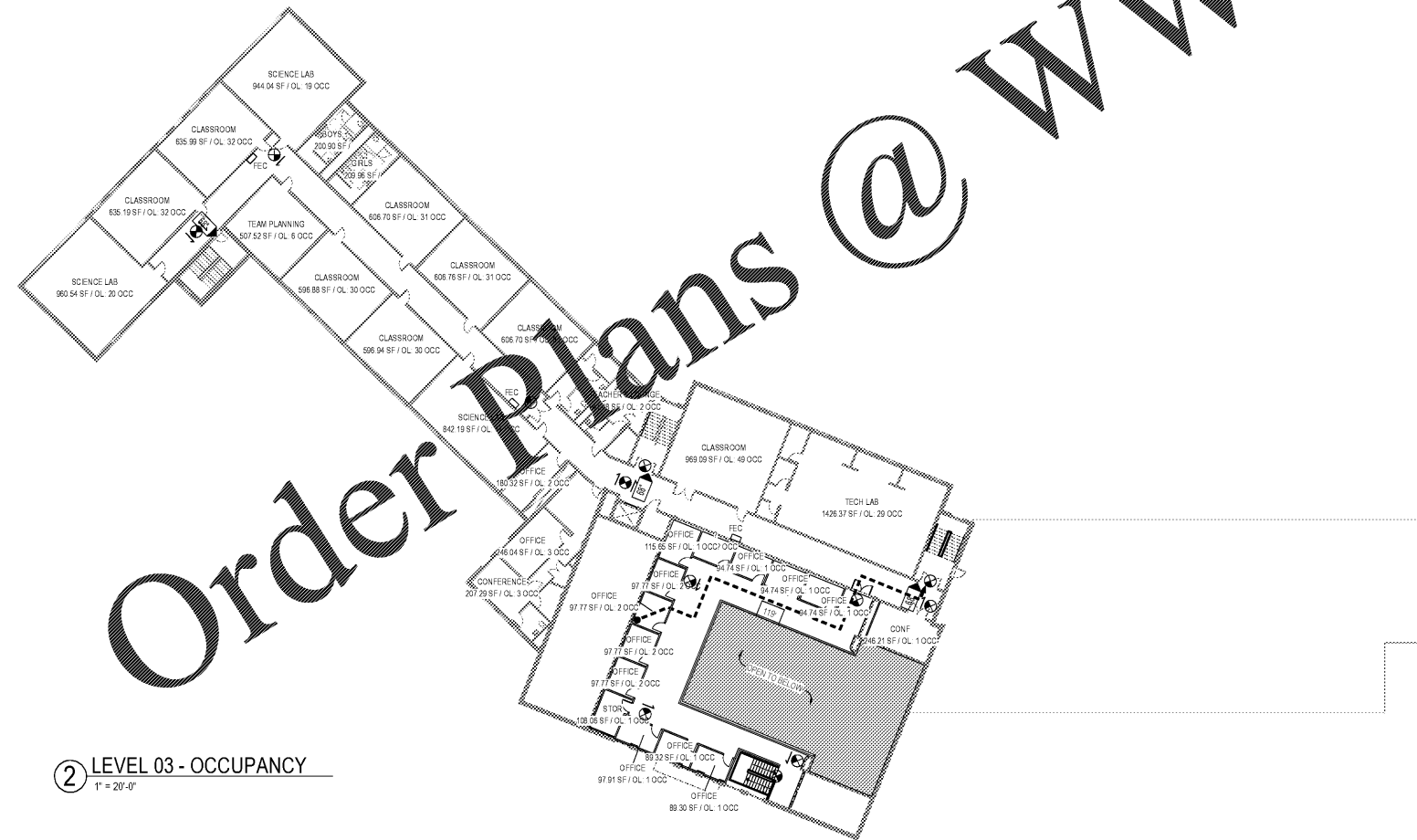

② LEVEL 03 - OCCUPANCY
1" = 20'-0"

FIRE SAFETY LEGEND

WALL KEY
WALL RATINGS DENOTED IN COLOR. CODE COMPLIANCE SHEETS TO BE PRINTED IN COLOR.
SEE SHT. A41-01 FOR UL ASSEMBLIES FOR EACH PARTITION TYPE.

DOORKEY
45 MIN FIRE RATED DOOR AND FRAME ASSEMBLY
60 MIN FIRE RATED DOOR AND FRAME ASSEMBLY
90 MIN FIRE RATED DOOR AND FRAME ASSEMBLY

PLAN SYMBOLS
EXIT WIDTH / EXIT ACCESS WIDTH
BRACKET MOUNTED FIRE EXTINGUISHER (SEE A-11 SERIES PLANS FOR EXACT LOCATION)
EXISTING FIRE EXTINGUISHER CABINET (SEE A-11 SERIES PLANS FOR EXACT LOCATION)
NEW FIRE EXTINGUISHER CABINET (SEE A-11 SERIES PLANS FOR EXACT LOCATION)
EXIT LIGHT WITH ARROW DIR.

FIRE RESISTANCE RATING REQUIREMENTS

- ALL STAR ENCLOSURES, ELEVATOR ENCLOSURES, AND SHAFTS SHALL BE RATED ONE HOUR WHEN CONNECTING THREE OR FEWER STORIES AND RATED TWO HOURS WHEN CONNECTING FOUR STORIES BUT SHALL NOT BE RATED LESS THAN THE REQUIRED RATING OF THE FLOOR BEING PENETRATED.
- FIRE WALLS, FIRE BARRIERS, FIRE PARTITIONS, SMOKE BARRIERS AND SMOKE PARTITIONS OR ANY OTHER WALL REQUIRED TO TIME, PROTECT OR PENETRATE SHALL BE EFFECTUALLY AND PERMANENTLY IDENTIFIED WITH SIGNS OR STENCILING. SUCH IDENTIFICATION SHALL:
 - BE LOCATED IN ACCESSIBLE CONCEALED FLOOR, FLOOR CEILING OR ATTIC SPACE.
 - BE LOCATED WITHIN 15 FEET (4572MM) OF THE END OF EACH WALL AT INTERVALS NOT EXCEEDING 30 FEET (9144MM) MEASURED HORIZONTALLY ALONG THE WALL OR PARTITION, AND
 - INCLUDE LETTERING NOT LESS THAN 3 INCHES (76MM) IN HEIGHT WITH A MINIMUM SPACING OF 1/8 INCH (3MM) BETWEEN CHARACTERS IN A CONTRASTING COLOR OR INCORPORATING THE SUGGESTED WORKING "FIRE AND/OR SMOKE BARRIER - PROTECT ALL OPENING" OR OTHER WORKING.

OCCUPANT LOAD CALCULATIONS FOR LEVEL 02

OCCUPANCY	SQ. FTG.	CODE	OCC. LOAD FACTOR	OCC. LOAD	REQ. EXIT WIDTH/OCC.	TOTAL REQ. EXIT WIDTH	TOTAL WIDTH PROVIDED
BUSINESS	6010	NFPA 100 SF/OCC	64	0.2'	12.8'		
EDUCATION - CLASS	9771	NFPA 20 SF/OCC	497	0.2'	100'		
EDUCATION - LAB	4161	NFPA 50 SF/OCC	85	0.2'	17'		
ASSEMBLY	5710	NFPA 15 SF/OCC	381	0.2'	77'		
STORAGE	1233	NFPA 500 SF/OCC	3	0.2'	0.5'		
TOTAL	26,681		1030		207.5'	374'	

EXIT NUMBER AND ARRANGEMENT FOR LEVEL 02

GREATEST TRAVEL DISTANCE TO AN EXIT (FROM ANY POINT IN A ROOM)
X SHOWN - 200'-0" ALLOWED

GREATEST TRAVEL DISTANCE TO AN EXIT (FROM AN EXIT ACCESS DOOR)
X SHOWN - 150'-0" ALLOWED

MINIMUM NUMBER OF EXITS REQUIRED
X PROVIDED - 2 REQUIRED

MAXIMUM DEAD END LENGTH
X SHOWN - 20' MAXIMUM

OCCUPANT LOAD CALCULATIONS FOR LEVEL 03

OCCUPANCY	SQ. FTG.	CODE	OCC. LOAD FACTOR	OCC. LOAD	REQ. EXIT WIDTH/OCC.	TOTAL REQ. EXIT WIDTH	TOTAL WIDTH PROVIDED
BUSINESS	1996	NFPA 100 SF/OCC	20	0.2'	4'		
EDUCATION - CLASS	5761	NFPA 20 SF/OCC	281	0.2'	56.2'		
EDUCATION - LAB	3874	NFPA 50 SF/OCC	78	0.2'	15.6'		
STORAGE	401	NFPA 500 SF/OCC	2	0.2'	0.4'		
TOTAL	12632		381		76.2'	204'	

EXIT NUMBER AND ARRANGEMENT FOR LEVEL 03

GREATEST TRAVEL DISTANCE TO AN EXIT (FROM ANY POINT IN A ROOM)
X SHOWN - 200'-0" ALLOWED

GREATEST TRAVEL DISTANCE TO AN EXIT (FROM AN EXIT ACCESS DOOR)
X SHOWN - 150'-0" ALLOWED

MINIMUM NUMBER OF EXITS REQUIRED
X PROVIDED - 2 REQUIRED

MAXIMUM DEAD END LENGTH
X SHOWN - 20' MAXIMUM

PERKINS + WILL

1315 Peachtree St NE
Atlanta, GA 30309
T 404.873.2600
F 404.873.2622
www.perkinswill.com

CONSULTANTS

CIVIL
Broadview Land Planning
15 Simpson St NW, Atlanta, GA 30308

STRUCTURAL
Lizaj+Cass
1230 Peachtree St NE, Suite 2500, Atlanta, GA 30309

MESHON EAL & ASSOCIATES
11285 Elkins Rd., Suite F3, Roswell, GA 30076

LANDSCAPING
Perkins+WILL
1315 Peachtree St NE, Atlanta, GA 30309

CARCHO
3103 Medlock Bridge Road, Norcross, GA 30071

OWNER
KIPP Metro Atlanta Schools
1445 Maynard Road NW, Atlanta, GA 30331

PROJECT

CONTRACTOR

RELEASED FOR CONSTRUCTION 06/07/2019

KIPP ATLANTA COLLEGIATE - Addition and Renovations
98 Anderson Ave NW
Atlanta GA 30314



KEYPLAN



ISSUE CHART

DATE	DESCRIPTION	BY
07/20/19	ISSUE	801660.000
	Drawn	Author
	Checked	Checker
	Approved	Approver

TITLE

LIFE SAFETY PLAN - LEVELS 02 & 03

SHEET NUMBER

G00-05

Copyright © 2019 Perkins+Will

Order Plans @ www.LDILine.com