

FIRE SAFETY LEGEND

WALL KEY
WALL RATINGS DENOTED IN COLOR. CODE COMPLIANCE SHEETS TO BE PRINTED IN COLOR.
SEE SHT. A4-01 FOR UL ASSEMBLIES FOR EACH PARTITION TYPE

DOORKEY
46 45 MIN FIRE RATED DOOR AND FRAME ASSEMBLY
60 60 MIN FIRE RATED DOOR AND FRAME ASSEMBLY
90 90 MIN FIRE RATED DOOR AND FRAME ASSEMBLY

PLAN SYMBOLS
EXIT WIDTH / EXIT ACCESS WIDTH
BRACKET MOUNTED FIRE EXTINGUISHER (SEE A-11 SERIES PLANS FOR EXACT LOCATION)
EXISTING FIRE EXTINGUISHER CABINET (SEE A-11 SERIES PLANS FOR EXACT LOCATION)
NEW FIRE EXTINGUISHER CABINET (SEE A-11 SERIES PLANS FOR EXACT LOCATION)
EXIT LIGHT WITH ARROW DIR

FIRE RESISTANCE RATING REQUIREMENTS

- ALL STAR ENCLOSURES, ELEVATOR ENCLOSURES, AND SHAFTS SHALL BE RATED ONE HOUR WHEN CONNECTING THREE OR FEWER STORIES AND RATED TWO HOURS WHEN CONNECTING FOUR STORIES BUT SHALL NOT BE RATED LESS THAN THE REQUIRED RATING OF THE FLOOR BEING PENETRATED.
- FIRE WALLS, FIRE BARRIERS, FIRE PARTITIONS, SMOKE BARRIERS AND SMOKE PARTITIONS OR ANY OTHER WALL REQUIRED TO BE PROVIDED TO SEPARATE OR PENETRATE SHALL BE EFFECTIVELY AND PERMANENTLY IDENTIFIED WITH SIGNS OR STENCILING. SUCH IDENTIFICATION SHALL:
 - BE LOCATED IN ACCESSIBLE CONCEALED FLOOR, FLOOR CEILING OR ATTIC SPACE.
 - BE LOCATED WITHIN 15 FEET (4572 MM) OF THE END-OF-WALL AT INTERVALS NOT EXCEEDING 30 FEET (9144 MM) MEASURED HORIZONTALLY ALONG THE WALL OR PARTITION, AND
 - INCLUDE LETTERING NOT LESS THAN 3 INCHES (76MM) IN HEIGHT WITH A MINIMUM SPACING OF 1/8 INCH (3MM) BETWEEN CHARACTERS.

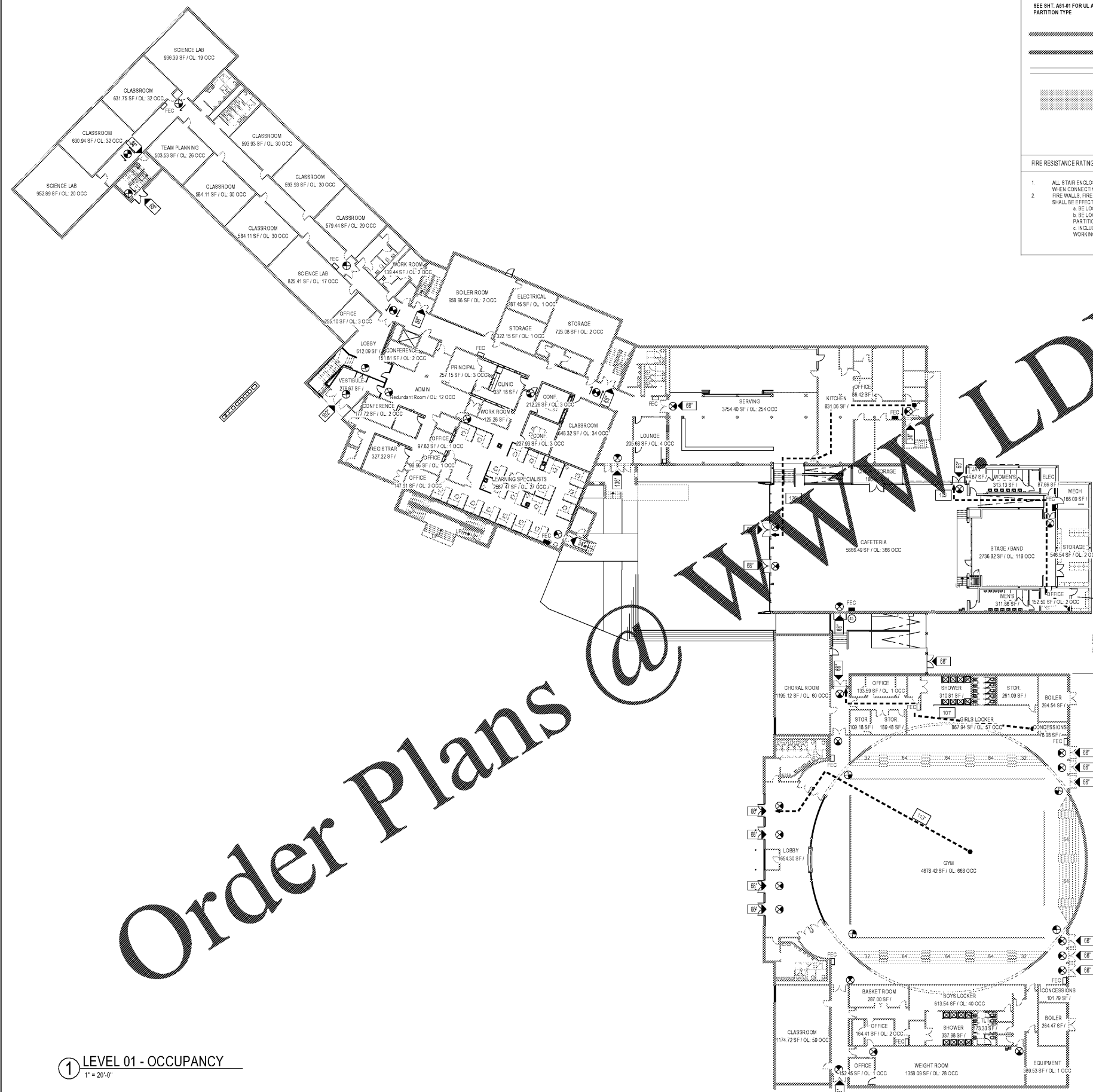

**BUILDING 1
OCCUPANT LOAD
CALCULATIONS FOR LEVEL 01**

OCCUPANCY	SQ. FTG.	CODE	OCC. LOAD FACTOR	OCC. LOAD	REQ. EXIT WIDTH/OCC.	TOTAL REQ. EXIT WIDTH	TOTAL WIDTH PROVIDED
BUSINESS	4652	NFPA 100 SF/OCC	50	0.2"	10"		
STORAGE	4251	NFPA 500 SF/OCC	9	0.2"	18"		
ASSEMBLY	11200	NFPA 15 SF/OCC	745	0.2"	140.3"		
EDUCATION - CLASS	4850	NFPA 20 SF/OCC	241	0.2"	48.5"		
EDUCATION - LAB	3716	NFPA 50 SF/OCC	55	0.2"	11"		
TOTAL				1,100		220.6"	748"

**BUILDING 2
OCCUPANT LOAD
CALCULATIONS FOR LEVEL 01**

OCCUPANCY	SQ. FTG.	CODE	OCC. LOAD FACTOR	OCC. LOAD	REQ. EXIT WIDTH/OCC.	TOTAL REQ. EXIT WIDTH	TOTAL WIDTH PROVIDED
BUSINESS				43	0.2"	8.6"	
STORAGE				27	0.2"	5.4"	
ASSEMBLY				690	0.2"	138"	
EDUCATION				467	0.2"	93.4"	
TOTAL				1,227		245.4"	1,020"

**BUILDING 1
EXIT NUMBER AND
ARRANGEMENT FOR LEVEL 01**

GREATEST TRAVEL DISTANCE TO AN EXIT: (FROM ANY POINT IN A ROOM)
X SHOWN - 200'-0" ALLOWED

GREATEST TRAVEL DISTANCE TO AN EXIT: (FROM AN EXIT ACCESS DOOR)
X SHOWN - 150'-0" ALLOWED

MINIMUM NUMBER OF EXITS REQUIRED:
X PROVIDED - 2 REQUIRED

MAXIMUM DEAD END LENGTH:
X SHOWN - 20' MAXIMUM

**BUILDING 2
EXIT NUMBER AND
ARRANGEMENT FOR LEVEL 01**

GREATEST TRAVEL DISTANCE TO AN EXIT: (FROM ANY POINT IN A ROOM)
X SHOWN - 200'-0" ALLOWED

GREATEST TRAVEL DISTANCE TO AN EXIT: (FROM AN EXIT ACCESS DOOR)
X SHOWN - 150'-0" ALLOWED

MINIMUM NUMBER OF EXITS REQUIRED:
X PROVIDED - 2 REQUIRED

MAXIMUM DEAD END LENGTH:
X SHOWN - 20' MAXIMUM

Order Plans @ www.LDILine.com

1 LEVEL 01 - OCCUPANCY
1" = 20'-0"