



JOB NAME: BEACH HIGH SCHOOL AUDITORIUM
 3001 Higgins Street
 Savannah, Georgia 31405
 Chatham County Public School System

SHEET NAME: FIRE PROTECTION PLANS

THIS DRAWING IS THE PROPERTY OF THE ARCHITECT AND MAY BE REPRODUCED OR TRANSMITTED IN ANY FORM OR BY ANY MEANS WITHOUT THE WRITTEN PERMISSION OF THE ARCHITECT.

J. W. ROBINSON & ASSOCIATES, INC.
 ARCHITECTS • INTERIOR DESIGNERS • URBAN PLANNERS •
 1020 RALPH DAVID ABERNATHY BLVD., S.W., ATLANTA, GEORGIA 30310
 PHONE: (404) 753-4129 FAX: (404) 753-4435



JOB NO.	201801
DATE	SEPT. 4, 2018
100% SCHEMATIC DESIGN	
DATE	SEPT. 4, 2018
100% DESIGN DEVELOPMENT	
DATE	SEPT. 4, 2018
80% CONST. DOCUMENTS	
DATE	APRIL 5, 2019
100% CONST. DOCUMENTS	
DATE	MAY 17, 2019

In Association With

ARCHITECTS
 301 W. Broughton St. #301
 Savannah, GA. 30401
 Ph: 912-232-5561

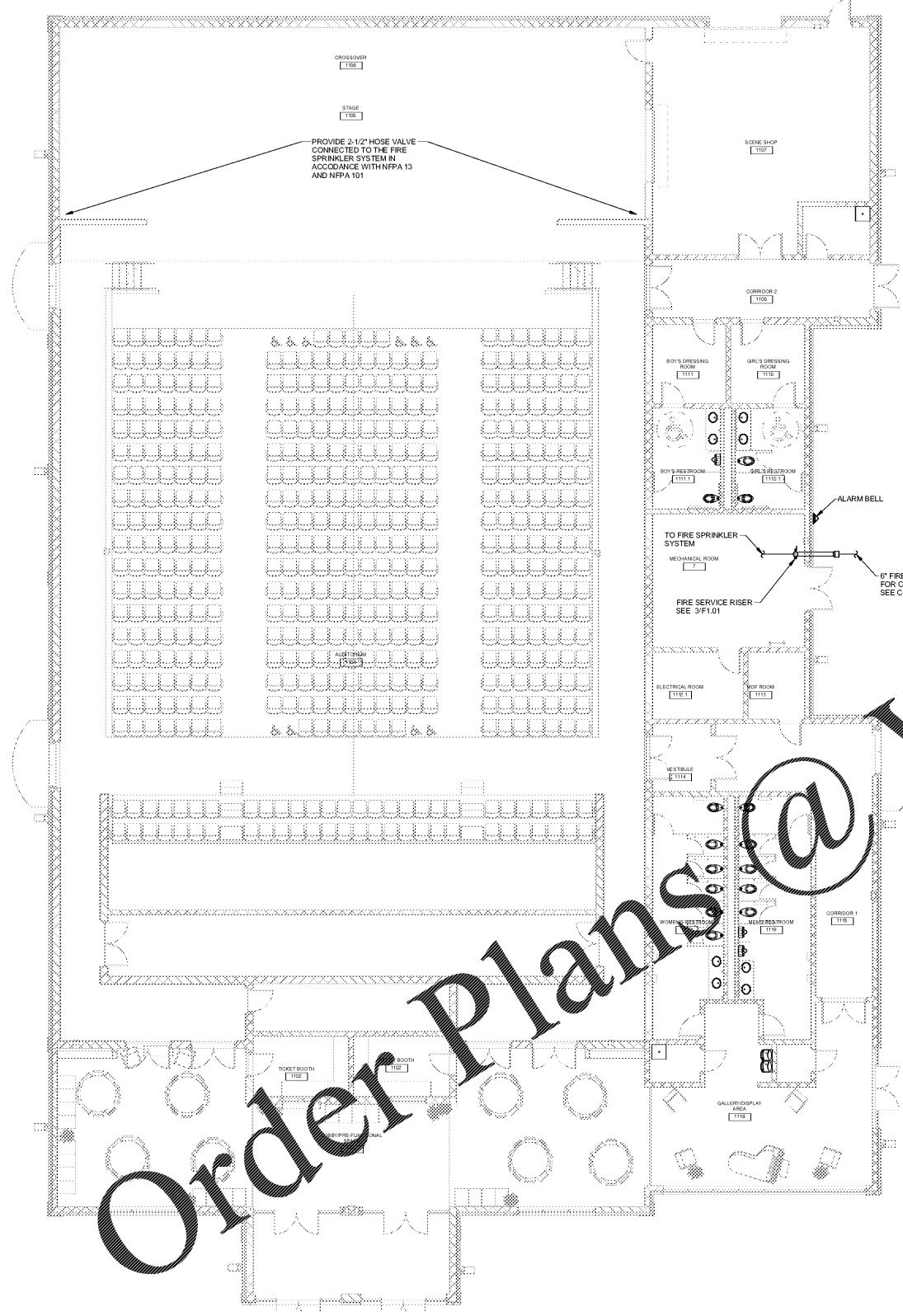

1 FIRE PROTECTION PLAN-FIRST FLOOR
 F1.01 SCALE: 1/8" = 1'-0"

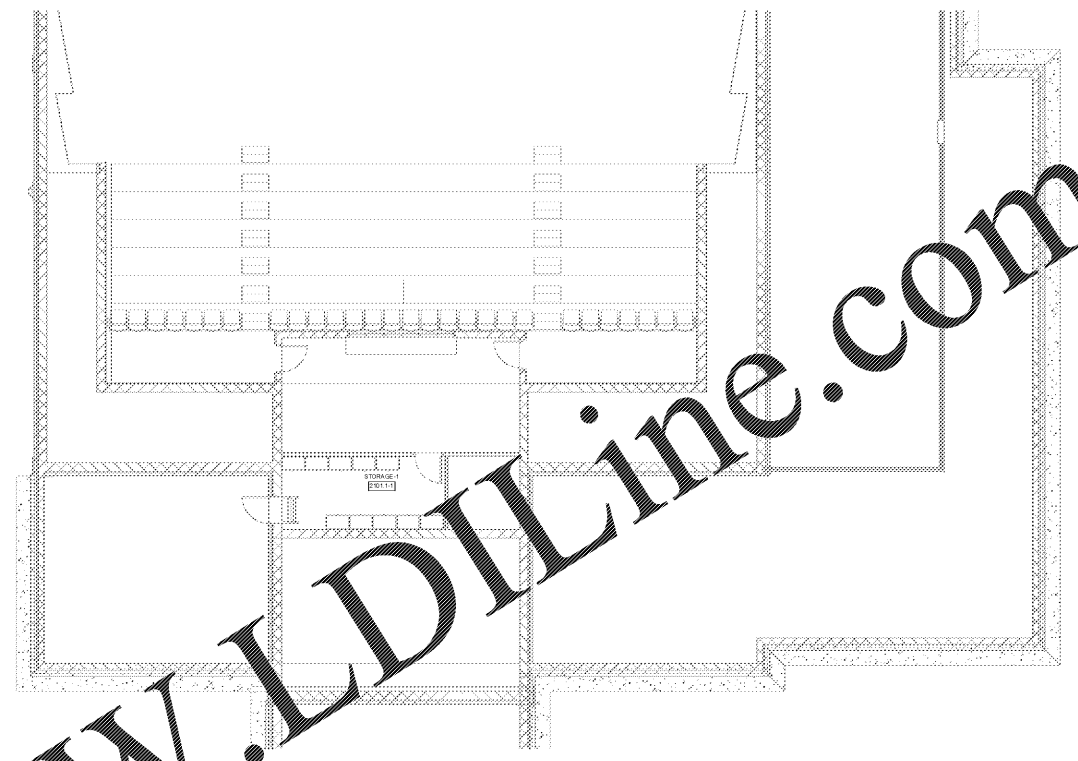

2 FIRE PROTECTION PLAN-SECOND FLOOR
 F2.01 SCALE: 1/8" = 1'-0"

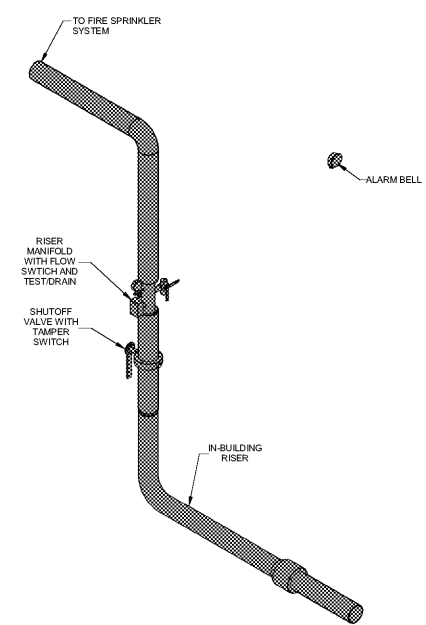

3 FIRE SPRINKLER SERVICE RISER
 F3.01 NOT TO SCALE

WET PIPE SPRINKLER SYSTEM
 THE SPRINKLER SYSTEM WILL BE PROVIDED FOR THE ENTIRE BUILDING. THE SPRINKLER SYSTEM SHALL BE DESIGNED AND INSTALLED IN ACCORDANCE WITH NFPA 13 AND THE DESIGN DATA BELOW. THE CONTRACTOR SHALL SUBMIT DESIGN CALCULATIONS AND PLANS TO THE AUTHORITY HAVING JURISDICTION FOR REVIEW AND APPROVAL. SPRINKLERS IN CEILINGS SHALL BE SEMI-RECESSED PENDANT HEADS UNLESS NOTED OTHERWISE. 2-1/2" HOSE VALVES WILL BE PROVIDED AT EACH SIDE OF THE STAGE.

HAZARD CLASSIFICATIONS AND DESIGN REQUIREMENTS
 HAZARD CLASSIFICATIONS FOR THIS BUILDING ARE LISTED BELOW IN THE SPRINKLER HAZARD CLASSIFICATIONS SCHEDULE.

HAZARD CATEGORY	DENSITY	AREA
LIGHT HAZARD	10 GPM/SQ. FT.	1500 SQ. FT.
ORDINARY GROUP 1	15 GPM/SQ. FT.	1500 SQ. FT.
ORDINARY GROUP 2	20 GPM/SQ. FT.	1500 SQ. FT.

THE CONTRACTOR SHALL LOCATE THE SYSTEM WITHIN THE INSULATED ENVELOPE OF THE BUILDING.
 THE EXTERIOR HOSE STREAM REQUIREMENT IS 250 GPM.

FIRE FLOW DATA
 FIRE FLOW DATA FOR THIS SITE: STATIC: TBD RESIDUAL: TBD FLOW RATE: TBD

SPRINKLER HAZARD CLASSIFICATIONS	
ROOM OR AREA	HAZARD CATEGORY
ALL AREAS EXCEPT AS NOTED BELOW	LIGHT HAZARD
MECHANICAL, ELECTRICAL, JANITOR, DATA, STORAGE ROOMS	ORDINARY HAZARD 1
STAGE, SCENE SHOP	ORDINARY HAZARD 2