



A NEW LOCATION FOR  
**CAPTAIN D'S**  
 1236 W. FLOYD BAKER BLVD  
 GATFNEY, SC 29342  
**STAR CHAIN, INC.**  
 11375 POINTE PLACE,  
 ROSWELL, GA 30076



Job Number:  
 68F-0071  
 Revisions:

JANUARY 16, 2019  
**A-8.2**  
 INTERIOR ELEVATIONS  
 CONVERSION

WWW.LDILine.com

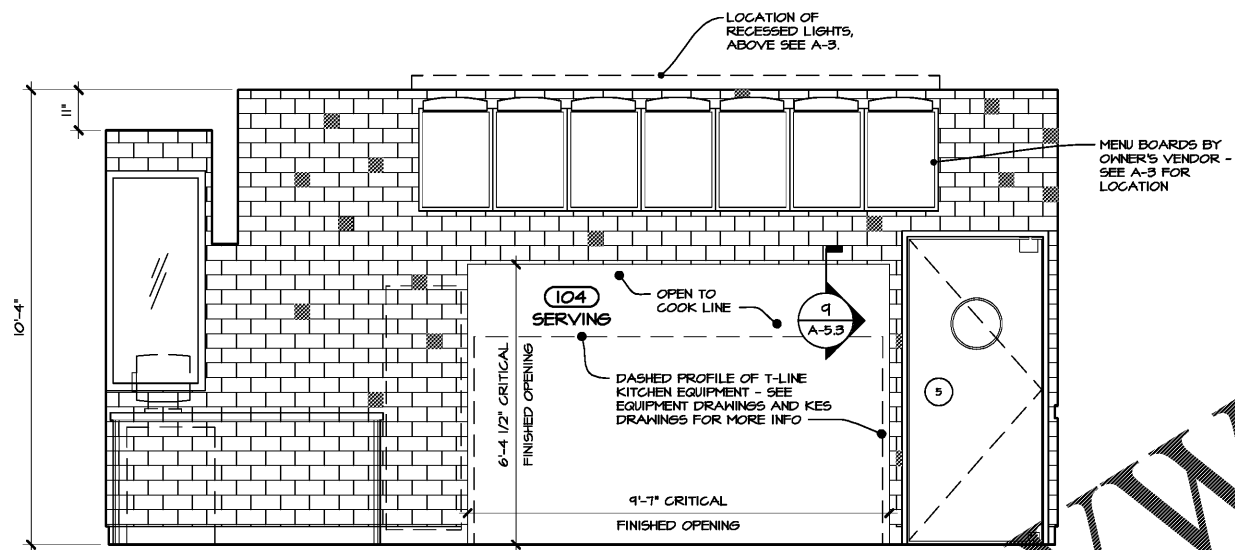

1 VESTIBULE AND SERVICE COUNTER - MENU BOARD PLACEMENT  
 A-8.2 SCALE 1/2" = 1'-0"

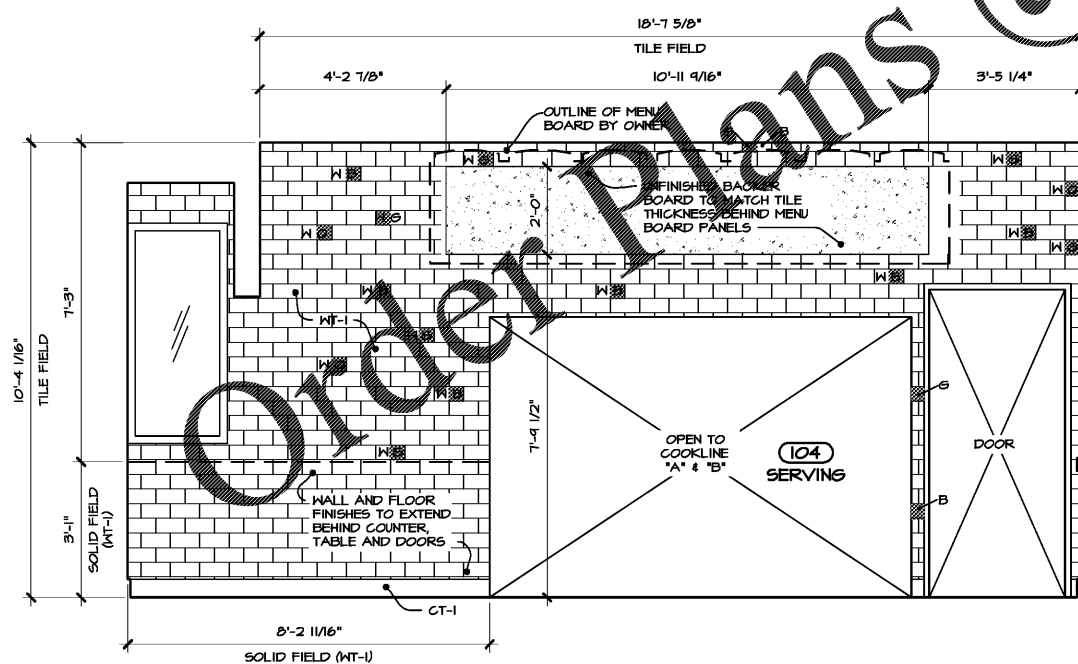

2 SERVICE COUNTER - TILE LAYOUT  
 A-8.2 SCALE 1/2" = 1'-0"

TILE LEGEND - SEE FINISH LISTING ON A-7

B	WT-3
W	WT-4
S	WT-5
O	WT-6
	WT-1

GENERAL NOTES

- REFER TO 7/A-5.3 FOR INSIDE CORNER TRIM DETAIL AT ALL WP-1 LOCATIONS.
- REFER TO 8/A-5.3 FOR OUTSIDE CORNER TRIM DETAIL AT ALL WP-1 LOCATIONS.
- VERIFY LOCATION OF ALL LIGHTS, CEILING FIXTURES, AND CEILING FINISHES WITH REFLECTED CEILING PLAN.
- ALL FURNITURE IS TO BE PROVIDED BY OWNER UNLESS OTHERWISE NOTED, REFER TO A-7.1 FOR FURNITURE DESIGNATIONS AND LOCATIONS.

WALL DECOR LEGEND AND SIZING

ART-1	18"x24", PHOTOGRAPH
ART-2	30"x30", PHOTOGRAPH
ART-3	30"x42", BULLETIN BOARD
CHKBD-1	36"x40", CHALKBOARD
CHKBD-2	NOT USED
SFBD-1	1x3 SOLID WOOD FRAME WITH NATURAL FINISH. FURNISHED AND INSTALLED BY G.C.
	BLUE AND GREEN SURFBOARD BY MIKE SUNSHINE FURNISHED AND INSTALLED BY G.C.

- NOTES:
- REFER TO 2/A-4.1 FOR ARTWORK FRAME DETAIL.
  - COORDINATE FINAL PLACEMENT OF ARTWORK, CHALKBOARDS AND SURFBOARD WITH CAPTAIN D'S PROJECT MANAGER.