

Order Plans @ WWW.DIline.com

FURNITURE LEGEND (44-FD)		
CODE	ITEM AND DESCRIPTION	QUANTITY
BELOW ITEMS BY COMMERCIAL LAMINATIONS		
TR-1	TRASH ENCLOSURE	1
B65-1	BEVERAGE STATION	1
CD5-1	CONDIMENT STATION	1
TB-1	2 TOP VINYL EDGE TABLE TOP; NEVAMAR WZ0045 VALIDATE WE DO	8
TB-2	4 TOP VINYL EDGE TABLE TOP; NEVAMAR WZ0045 VALIDATE WE DO (26" X 44") -- 2 HC TABLES	4
BTH-1	SINGLE BOOTH WITH FINISHED BACK; 3'-8" LENGTH	2
BTH-2	DOUBLE BOOTH; 3'-8" LENGTH	1
SET-1	BANQUETTE SEAT WITH FINISHED BACK; 17'-2" LENGTH	1
BELOW ITEMS BY AC FURNITURE		
CH-1	CHAIR; AC FURNITURE #1946; FORMICA 86992-58 HARD ROCK MAPLE / 18" SEAT HEIGHT	30
HC	HIGH CHAIRS: AREA ON PLAN IS DESIGNATED FOR HIGH CHAIR STORAGE - HIGH CHAIRS PROVIDED BY VENDOR - COORDINATE FINAL AMOUNT WITH OWNER	LOT

VERIFY ALL QUANTITIES WITH OWNER

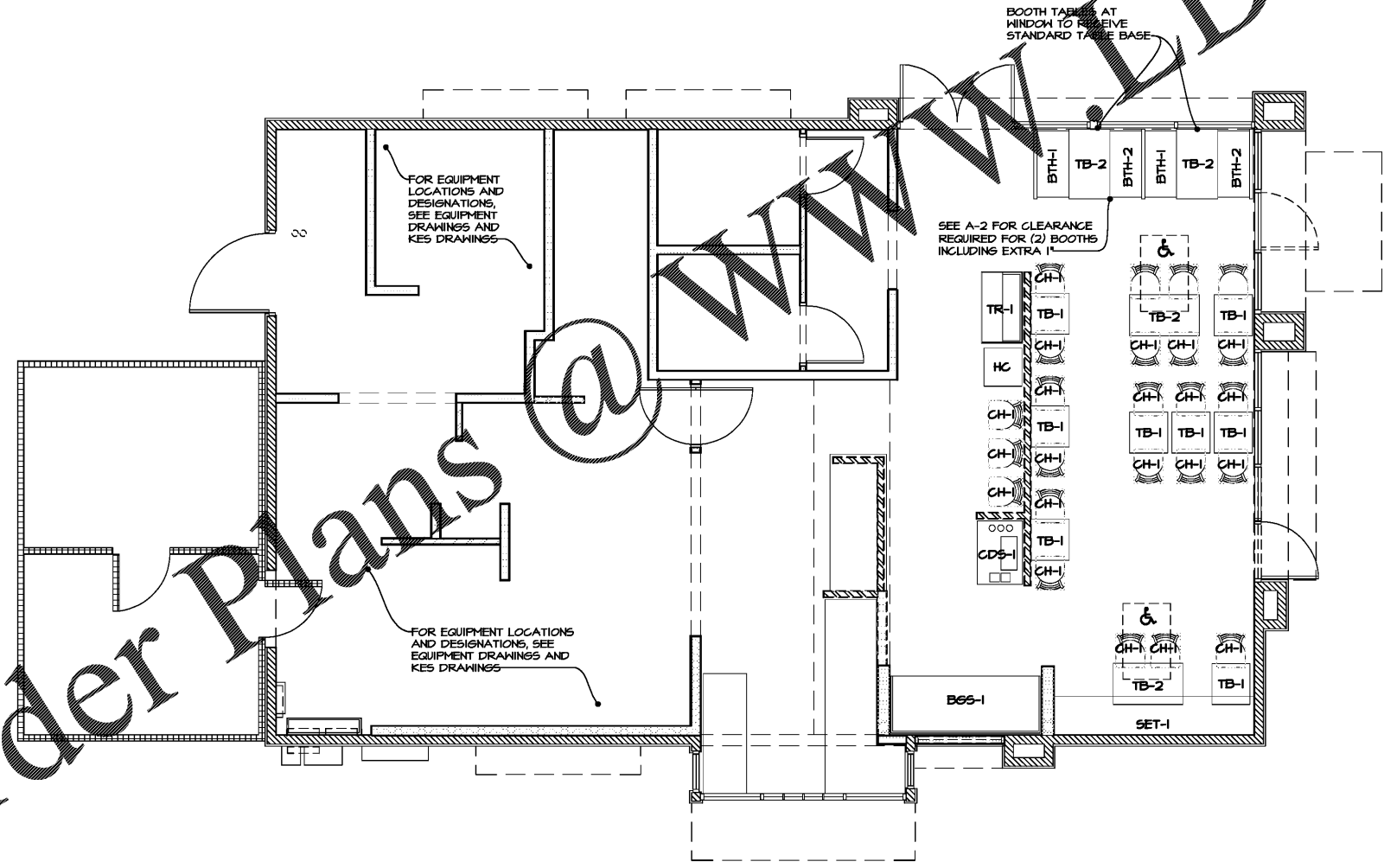

**D** **DESIGN**  
and  
**E** **ENGINEERING**  
INC ARCHITECTS  
STRUCTURAL AND CIVIL ENGINEERS  
1645 Westgate Circle  
Brentwood, Tennessee 37027  
615-370-1779 fax: 370-9108  
www.dandoinc.us



A NEW LOCATION FOR  
**CAPTAIN D'S**  
1236 W. FLOYD BAKER BLVD  
GAFFNEY, SC 29342  
**STAR CHAIN, INC.**  
11375 POINTE PLACE,  
ROSWELL, GA 30076

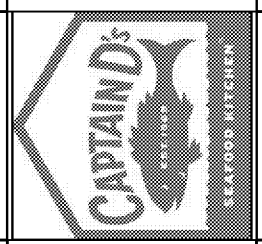

Job Number:  
68F-0071  
Revisions:

JANUARY 16, 2019  
**A-7.1**  
FURNITURE PLAN  
CONVERSION