

**ENLARGED RESTROOM TRENCH DRAIN DIMENSIONS**  
 SCALE: 1/2" = 1'-0"

### FLOOR LEGEND

	QUARRY TILE - SEE FINISH SCHEDULE D.C.O.F. > 0.42 *SLOPED TO DRAIN AS IDENTIFIED
	QUARRY TILE - SEE FINISH SCHEDULE D.C.O.F. > 0.42 *FLAT FLOOR AREA- DO NOT SLOPE
	CERAMIC TILE SEE FINISH SCHEDULE D.C.O.F. > 0.42 *FLAT FLOOR AREA- DO NOT SLOPE
	CERAMIC TILE SEE FINISH SCHEDULE D.C.O.F. > 0.42 *SLOPE TO DRAIN AS IDENTIFIED
	SEALED CONCRETE *REFER TO CIVIL DRAWINGS FOR ADDITIONAL INFORMATION, TYP.
	PRE-MANUFACTURED FLOORING - BY COOLER/ FREEZER MFG.
	TD FLOOR DRAIN/ TRENCH DRAIN
	FD FLOOR DRAIN
	HD HUB DRAIN
	FS FLOOR SINK

### FINISH MATERIALS SCHEDULE

CODE	MATERIALS	MANUFACTURER	DESCRIPTION			NOTES
			PROD.	COLOR	SIZE	
CT-1	CERAMIC TILE	LOUISVILLE TILE	MOUNTAIN SERIES	APPALACHIAN GRIP	6"x6" PLANK	GROUT: TEC; #125 SABLE
QT-1	QUARRY TILE	AMERICAN OLEAN	QUARRY NATURALS	DESERT	6"x6"x1/2"	EPOXY GROUT; TEC; #15 LIGHT SMOKE
QTB-1	QUARRY TILE BASE	AMERICAN OLEAN	QUARRY NATURALS	MATCH COLOR OF ADJACENT FLR. FINISH	5"x6" COVE BASE	GROUT: MATCH ADJACENT
NT-1	CERAMIC HALL TILE	DALTILE	SEMI-GLOSS TILE	ARCTIC WHITE OHO	4 1/4"x6 1/2"x5/16"	GROUT: GBP; #11 SNOW WHITE
NT-2	CERAMIC HALL TILE	DALTILE	SEMI-GLOSS TILE	AQUA GLOM OHT	5"x6"x5/16"	GROUT: GBP; #11 SNOW WHITE
NT-3	CERAMIC HALL TILE	DALTILE	SEMI-GLOSS TILE	AQUA GLOM OHT	4 1/4"x4 1/4"x5/16"	GROUT: GBP; #11 SNOW WHITE
NT-4	CERAMIC HALL TILE	DALTILE	SEMI-GLOSS TILE	ARCTIC WHITE OHO	4 1/4"x4 1/4"x5/16"	GROUT: GBP; #11 SNOW WHITE
NT-5	CERAMIC HALL TILE	DALTILE	SEMI-GLOSS TILE	KEY LINE GO98	4 1/4"x4 1/4"x5/16"	GROUT: GBP; #11 SNOW WHITE
NT-6	CERAMIC HALL TILE	DALTILE	SEMI-GLOSS TILE	GRANSE BURST GO4T	4 1/4"x4 1/4"x5/16"	GROUT: GBP; #11 SNOW WHITE
STL	STAINLESS STEEL WALL PROTECTION	---	---	---	---	---
FRP-1	FIBERGLASS REINFORCED PANEL	GRANE COMPOSITS	GLASBORD	WHITE 85	4'x8'x3/8" THICK.	---
FRP-2	FIBERGLASS REINFORCED PANEL	GRANE COMPOSITS	VARIETEX BEAD-BOARD	WHITE 180	4'x8'x3/8" THICK.	---
P-1	PAINT	SHERWIN WILLIAMS	---	SKYROOT CEILING BRIGHT WHITE	---	---
P-2	---	---	---	---	---	---
P-3	PAINT	SHERWIN WILLIAMS	---	SH6103 FROLIC	---	---
P-4	PAINT	SHERWIN WILLIAMS	---	SH6628 ROBERT GRANGE	---	---
P-5	PAINT	SHERWIN WILLIAMS	---	SH6715 BRINT	---	---
FL-1	PLASTIC LAMINATE	FORMICA	---	T162-58 DUNE WOOD	---	---
SS-1	SOLID SURFACE	LIVINGSTONE	---	FLAX	---	---
T-1	COVE TRANSITION	SCHLUTER	DILEX- HKS	ANNODIZED ALUM.	---	---
CL-1	LAY-IN GLS. TILE & GRID	ARMSTRONG	1728	WHITE	2'x2'x5/8"	SQUARE EDGE
CL-2	LAY-IN GLS. TILE & GRID	USG	56091	WHITE	2'x4'x5/8"	GRID PROFILE "A"
CL-3	LAY-IN GLS. TILE & GRID	USG	56091	WHITE	2'x2'x5/8"	GRID PROFILE "A"
CONC-1	SEALED CONCRETE	---	---	---	---	REFER TO CIVIL

- ### GENERAL NOTES
- G.C. SHALL REVIEW ALL SPECIFICATION SECTIONS PRIOR TO BEGINNING OF WORK.
  - REFER TO REFLECTED CEILING PLANS FOR COORDINATION OF CEILING MATERIAL AND FINISHES.
  - ALL FLOOR MATERIAL CHANGES SHALL OCCUR AT THE CENTERLINE OF THE DOOR UNLESS OTHERWISE NOTED.
  - COORDINATE FINISH MATERIALS INDICATED IN THE SCHEDULE WITH MATERIALS INDICATED ON THE DRAWINGS. NOTIFY ARCHITECT OF ANY DISCREPANCIES AND OBTAIN CLARIFICATION PRIOR TO PROCEEDING WITH WORK IN QUESTION.
  - FINISH COLOR OF ANY ACCESS PANELS ARE TO MATCH ADJACENT SURFACE FINISH UNLESS NOTED OTHERWISE.
  - ALL INTERIOR FINISHES TO MEET CLASS 'C' FINISH REQUIREMENTS.
  - ALL BULK HEADS/SOFFITS ARE TO BE PAINTED TO MATCH ADJACENT WALL UNLESS NOTED OTHERWISE.
  - SEE SHEETS A-8.0, A-8.1 AND A-8.2 FOR INTERIOR ELEVATIONS AND WALL FINISH LOCATIONS.
  - CAULK ALL DOOR FRAMES, WINDOW FRAMES AND WINDOW FRAMES AFTER PAINTING IS COMPLETE. COLOR OF CAULK TO MATCH ADJACENT FINISH.
  - SEE DOOR SCHEDULE ON SHEET A-11 FOR DOOR FINISHES.
  - SEE EXTERIOR ELEVATIONS AND NOTES ON SHEETS A-4 AND A-4.1 FOR EXTERIOR FINISHES.
  - BRAND COMPOSITES BEAD BOARD WALL PROTECTION AND WOOD TRIM TO REFER TO DETAILS 415/A-5.3 FOR ADDITIONAL INFORMATION. PROVIDE PAINT GRADE 3/4" L" SHAPE CORNER MOLDING TRIM AT ALL 1/5 AND 0/5 CORNERS, TYP.
  - STAINLESS STEEL WALL PROTECTION SHALL BE INSTALLED WITHIN 24" OF HOODS.

- ### KEYED NOTES
- CERAMIC TILE GROUT JOINT SHALL BE 3/16".
  - COORDINATE SELECTION OF FLOORING WITH TRENCH DRAIN SPECIFICATION.
  - EXISTING COOLER & FREEZER FLOOR TO REMAIN. G.C. TO VERIFY CONDITION PRIOR TO INSTALLATION OF EQUIPMENT AND COORDINATE REFINISHING FLOOR WITH CAPTAIN D'S CONSTRUCTION MANAGER.
  - DINING WINDOWS SHALL RECEIVE INTERIOR MOUNTED SOLAR SHADES: NORDIG SCREEN BASKET WEAVE; 44-0102 WHITE/LINEN 3/8 (MS THILL WHITE LINEN), CORDLESS CLUTCH CONTROL OPERATION.
  - SEE INTERIOR ELEVATIONS ON SHEET A-10 FOR WALL FINISH LOCATIONS AT RESTROOMS AND VESTIBULE.
  - CT-1 TO BE RAN HORIZONTALLY AND USED AS BASE MATERIAL.
  - TRANSITION (T-1) TO BE USED AT HORIZONTAL JOINT BETWEEN HALL TILE (NT-1) AND FLOOR TILE (CT-1), TYP.
  - LOCATION OF UNDERGROUND CONDUIT FOR EQUIPMENT SPECIFIC ELECTRIC PANEL - REFER TO ELECTRICAL DRAWINGS FOR ADDITIONAL INFORMATION.

### FINISH LEGEND

BASE FINISH	CTB-1 #1	FINISH KEY NOTE
FLOOR FINISH	CT-1 #2	

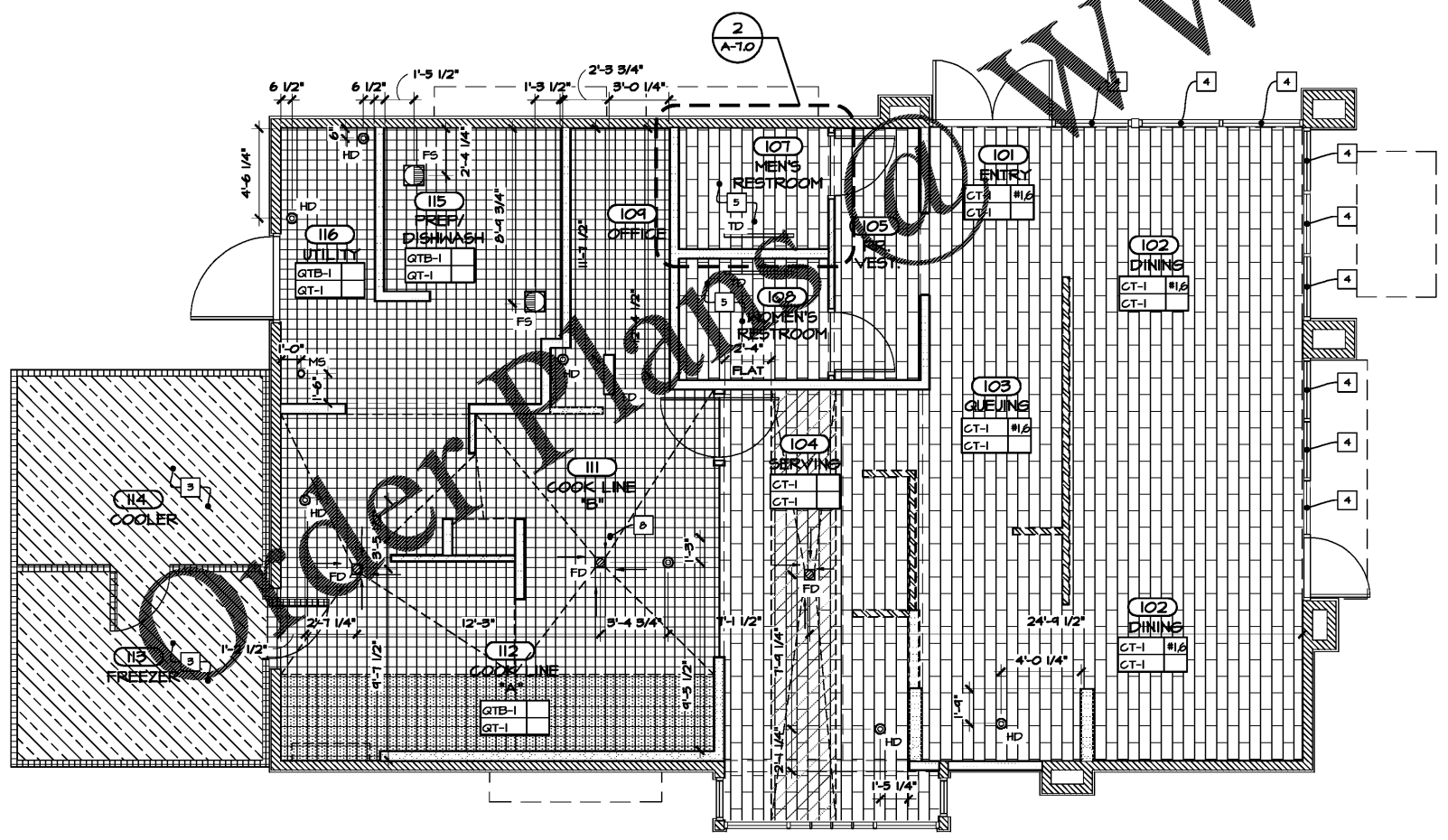

**FINISH FLOOR PLAN**  
 SCALE: 1/4" = 1'-0"

**DESIGN and ENGINEERING**  
 INC ARCHITECTS  
 STRUCTURAL AND CIVIL ENGINEERS  
 1645 Westgate Circle  
 Brentwood, Tennessee 37027  
 615-370-1779 fax: 370-9108  
 www.dandoinc.us

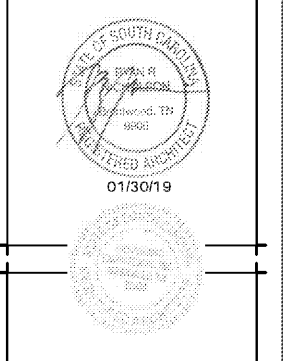

A NEW LOCATION FOR  
**CAPTAIN D'S**  
 1236 W. FLOYD BAKER BLVD  
 GAFFNEY, SC 29342  
**STAR CHAIN, INC.**  
 11375 POINTE PLACE,  
 ROSWELL, GA 30076

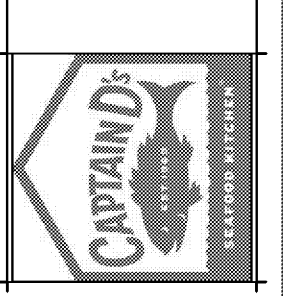

Job Number:  
 68F-0071  
 Revisions:

JANUARY 16, 2019  
**A-7.0**  
 FINISH PLN. & SCHED.  
 CONVERSION