

2 CHASE DTL. @ QUEUING (103)  
SCALE: 1/2" = 1'-0"

- ### KEYED NOTES
- KITCHEN HOOD REFER TO A-3 AND MECHANICAL DRAWINGS FOR ADDITIONAL INFORMATION
  - 6" CONCRETE CURB FOR SWITCHGEAR - SEE 1/A4.1 FOR ADDITIONAL INFORMATION
  - NEW METAL WALL FRAMING AND NONCOMBUSTIBLE SHEATHING BEHIND NEW EXHAUST HOODS.

### WALL LEGEND

	WALK-IN FREEZER/COOLER WALL
	EXISTING EXTERIOR WOOD-FRAMED WALLS TO REMAIN
	2X4 STUD WALL
	2X6 STUD WALL
	2X8 STUD WALL
	6" METAL STUD WALL
	PARTIAL HEIGHT WALL - REFER TO ABOVE HATCH PATTERNS FOR FRAMING DIMENSIONS AND A-2 FOR WALL HEIGHTS

NOTES:

- ALL INTERIOR WALLS SURROUNDING/ ADJACENT TO SERVING LINE (104), RESTROOMS (107 & 108), OFFICE (104), DISHWASH/PREP (115), COOK LINE "A" (112), COOK LINE "B" (111), AND UTILITY (116) TO RECEIVE DOUBLE COMPOSITE BASE PLATES OF APPROPRIATE WIDTH. HOLD SHEATHING OFF CONCRETE SLAB A MIN. OF 1-1/2", ALIGN AND EDGE NAIL SHEATHING TO UPPER PLATES.
- ALL INTERIOR WALLS SEPARATING SERVING LINE (104), RESTROOMS (107 & 108), & ENTRY (101) FROM DINING AREAS TO RECEIVE SOUND BATT INSULATION, TYP.

- ### GENERAL NOTES
- REFER TO STRUCTURAL DRAWINGS FOR FRAMING, LUMBER SIZE AND SPACING REQUIREMENTS AT ALL EXTERIOR WALLS. INFORMATION INDICATED ON THE STRUCTURAL DRAWINGS SHALL TAKE PRECEDENT OVER THE ARCHITECTURAL DRAWINGS.
  - INTERIOR HOOD STUDS SHALL BE 2X4'S, 2X6'S, OR 2X8'S AS DIMENSIONED ON FLOOR PLAN. INTERIOR STEEL STUDS SHALL BE 6" IS GA. AS DIMENSIONED ON FLOOR PLAN OR AS DETAILED. - SEE STRUCTURAL DRAWINGS FOR ADDITIONAL WALL CONSTRUCTION DETAILS.
  - REFER TO WALL SECTIONS FOR ADDITIONAL CONSTRUCTION DETAILS.
  - G.C. TO COORDINATE AND VERIFY ALL BLOCKING & WALL BRACING LOCATIONS WITH EQUIPMENT DRAWINGS.
  - REFER TO EXTERIOR ELEVATIONS FOR REQUIRED EXTERIOR FINISHES.
  - REFER TO INTERIOR ELEVATIONS AND FINISH MATERIAL SCHEDULE FOR REQUIRED FINISHES.
  - INTERIOR WALLS SHALL EXTEND A MINIMUM OF 6" ABOVE ADJACENT FINISHED CEILING. EXTEND GYP BOARD OR SCHEDULED SHEATHING TO TOP OF WALL (6" ABOVE ADJACENT FINISHED CEILING). BRACE STUD WALLS TO STRUCTURE ABOVE FOR SOUND STABLE INSTALLATION. REFER TO STRUCTURAL DRAWINGS FOR REQUIRED BRACING DETAIL.
  - PROVIDE 1X FIRE STOP BLOCKING IN CONCEALED SPACES OF ALL STUD WALLS AT CEILING LEVEL AND AT 10'-0" INTERVALS AND OTHERWISE REQUIRED BY CODE.
  - REFER TO 1/A-4 FOR BLOCKING REQUIREMENTS FOR EXTERIOR WOOD CONNECTION.
  - DIMENSIONS INDICATED ON THE FLOOR PLAN ARE FROM FACE OF STUD TO FACE OF STUD UNLESS SPECIFICALLY NOTED OTHERWISE.
  - REFERENCE SHEETS A-11 FOR DOOR AND WINDOW SCHEDULE AND A-11.1 FOR FRAMING DETAILS.
  - ALL FRAMING, SUBSTRATE, AND FINISHES WITHIN 24" OF KITCHEN HOODS TO BE NON-COMBUSTIBLE.
  - FINISHED DIMENSIONS ARE 3" SHORTER THAN CRITICAL FRAMING DIMENSIONS IDENTIFIED - G.C. TO FIELD VERIFY.

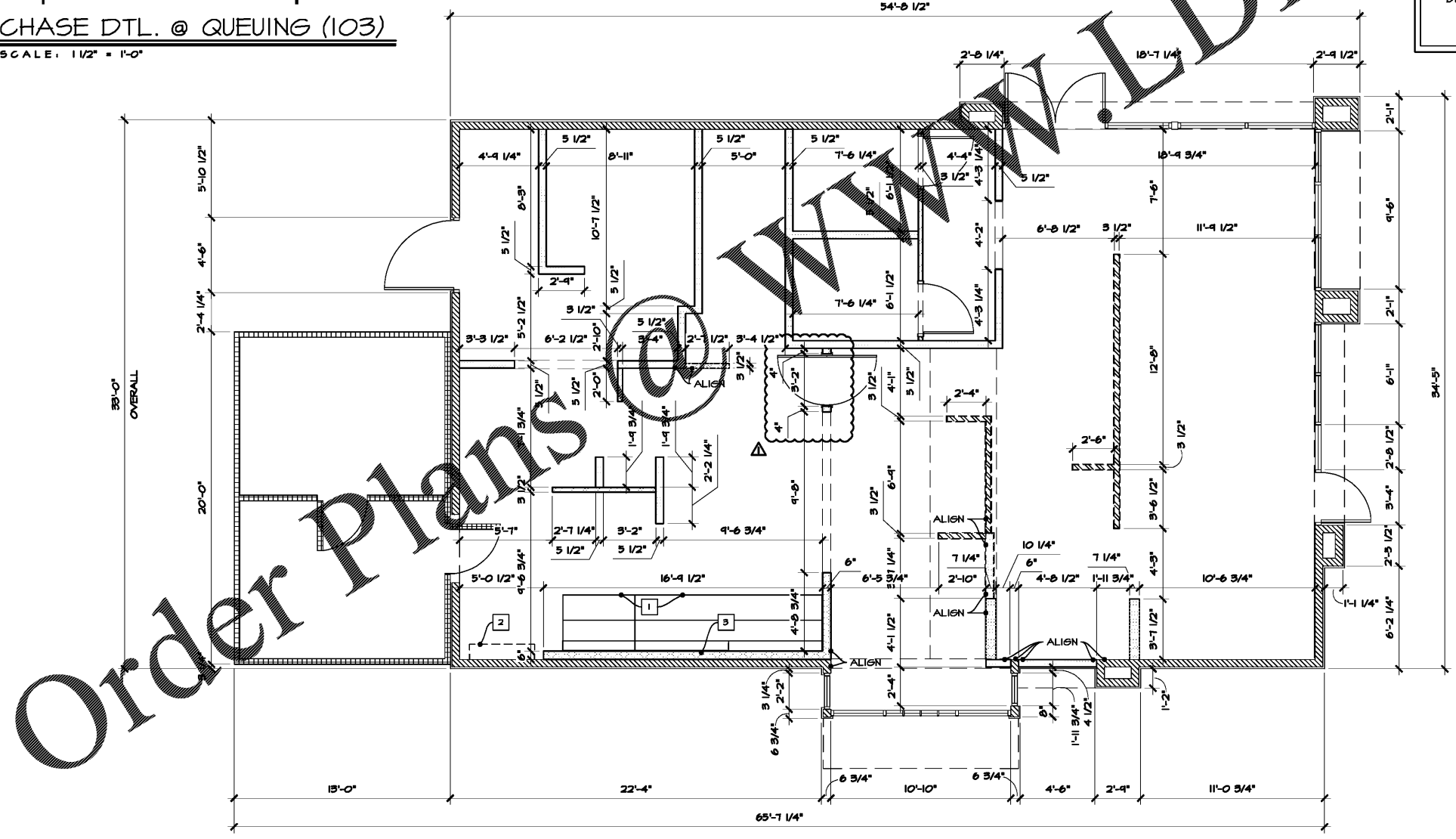

1 DIMENSIONED FLOOR PLAN  
SCALE: 1/4" = 1'-0"

**DESIGN and ENGINEERING**  
INC ARCHITECTS  
STRUCTURAL AND CIVIL ENGINEERS  
1645 Westgate Circle  
Brentwood, Tennessee 37027  
615-370-1779 fax: 370-9108  
www.dandinc.us

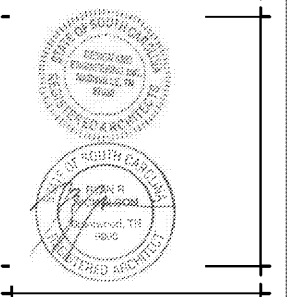

A NEW LOCATION FOR  
**CAPTAIN D'S**  
1236 W. FLOYD BAKER BLVD  
GAFFNEY, SC 29342

**STAR CHAIN, INC.**  
11375 POINTE PLACE,  
ROSWELL, GA 30076

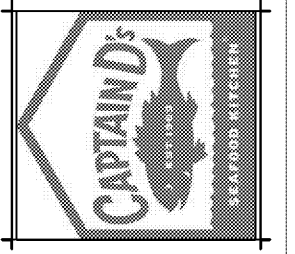

Job Number:  
68F-0071  
Revisions:  
5/1/19 - CODE COMMENTS

JANUARY 16, 2019  
**A-2**  
DIMENSIONED  
FLOOR PLAN  
CONVERSION