

Revisions		
#	Date	Description

Project Number	18021
Issued for	CONSTRUCTION
Issue Date	2019.05.07

DRAWING TITLE  
**ENLARGED  
FIRST FLOOR  
WATER AND GAS  
PLAN**

SHEET NUMBER

**P.204**

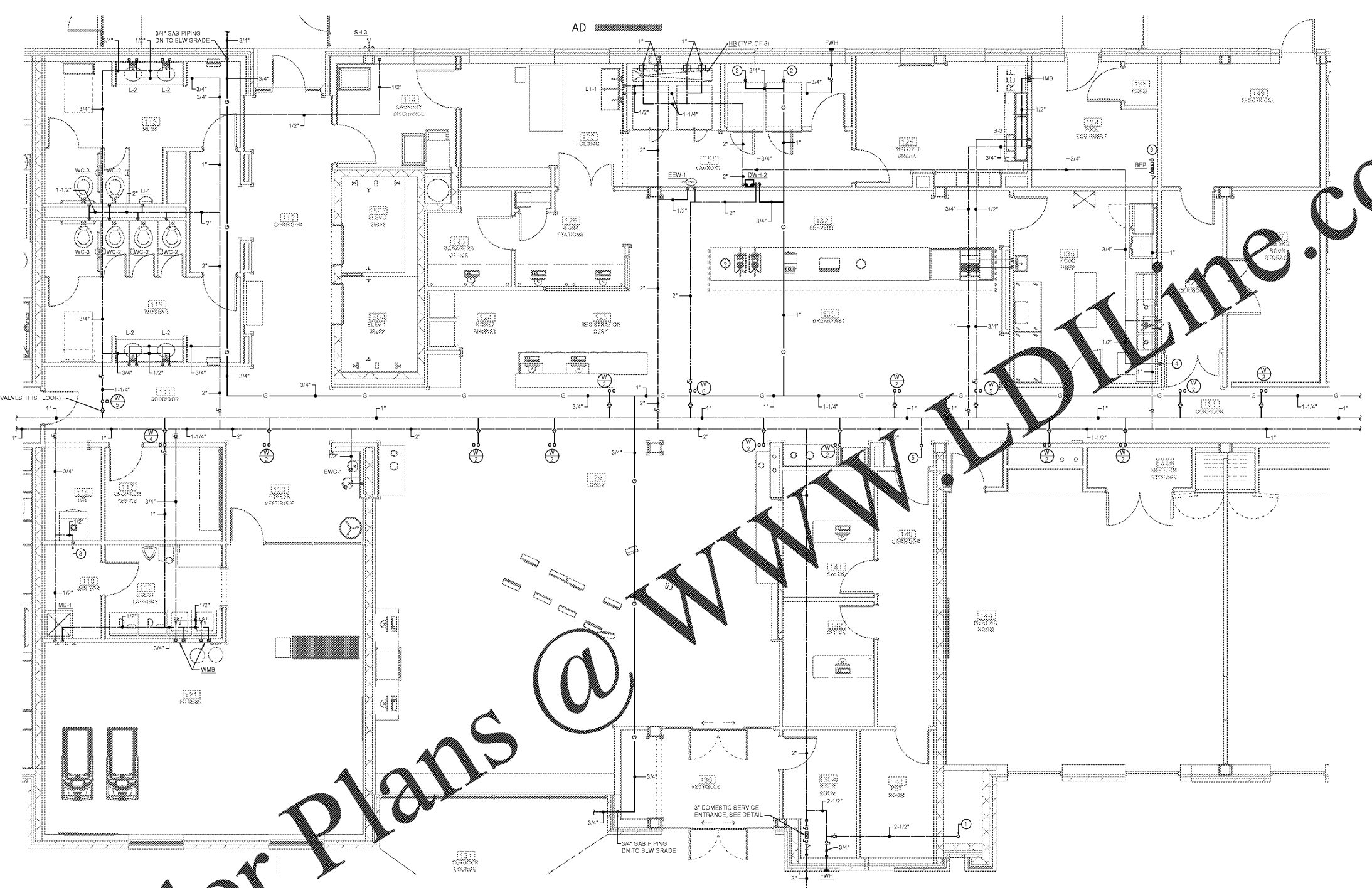

**1 ENLARGED FIRST FLOOR WATER & GAS PLAN**  
P.204 SCALE: 1/8" = 1'-0"

**KEYED NOTES THIS SHEET**

- 1 EXTEND 2-1/2" CW PIPING UP.
- 2 CONNECT GAS PIPING TO DRYER, 225 MBH INPUT. COORDINATE SIZE AND LOCATION OF CONNECTION, AND ALL CONNECTION REQUIREMENTS WITH EQUIPMENT SUPPLIER.
- 3 CONNECT 1/2" CW TO ICE MACHINE WITH BALL VALVE AND WATTS SERIES LF7 DUAL CHECK VALVE. VERIFY EXACT LOCATION AND SIZE OF CONNECTION WITH EQUIPMENT SUPPLIER.
- 4 CONNECT 1/2" HW TO DISHWASHER. PROVIDE BALL VALVE AND WATER HAMMER ARRESTER AT CONNECTION, AND PROVIDE WATTS SERIES LF7 DUAL CHECK VALVE, UNLESS DISHWASHER HAS AN INTEGRAL BACKFLOW PREVENTER. VERIFY EXACT LOCATION AND SIZE OF CONNECTION WITH EQUIPMENT SUPPLIER.
- 5 1" HWR PIPING UP.
- 6 PROVIDE CW CONNECTION FOR POOL EQUIPMENT. COORDINATE EXACT LOCATION AND SIZE OF CONNECTION AND ALL CONNECTION REQUIREMENTS WITH POOL EQUIPMENT CONTRACTOR.

Order Plans @ WWW.LDILLINE.COM