

Revisions		
#	Date	Description

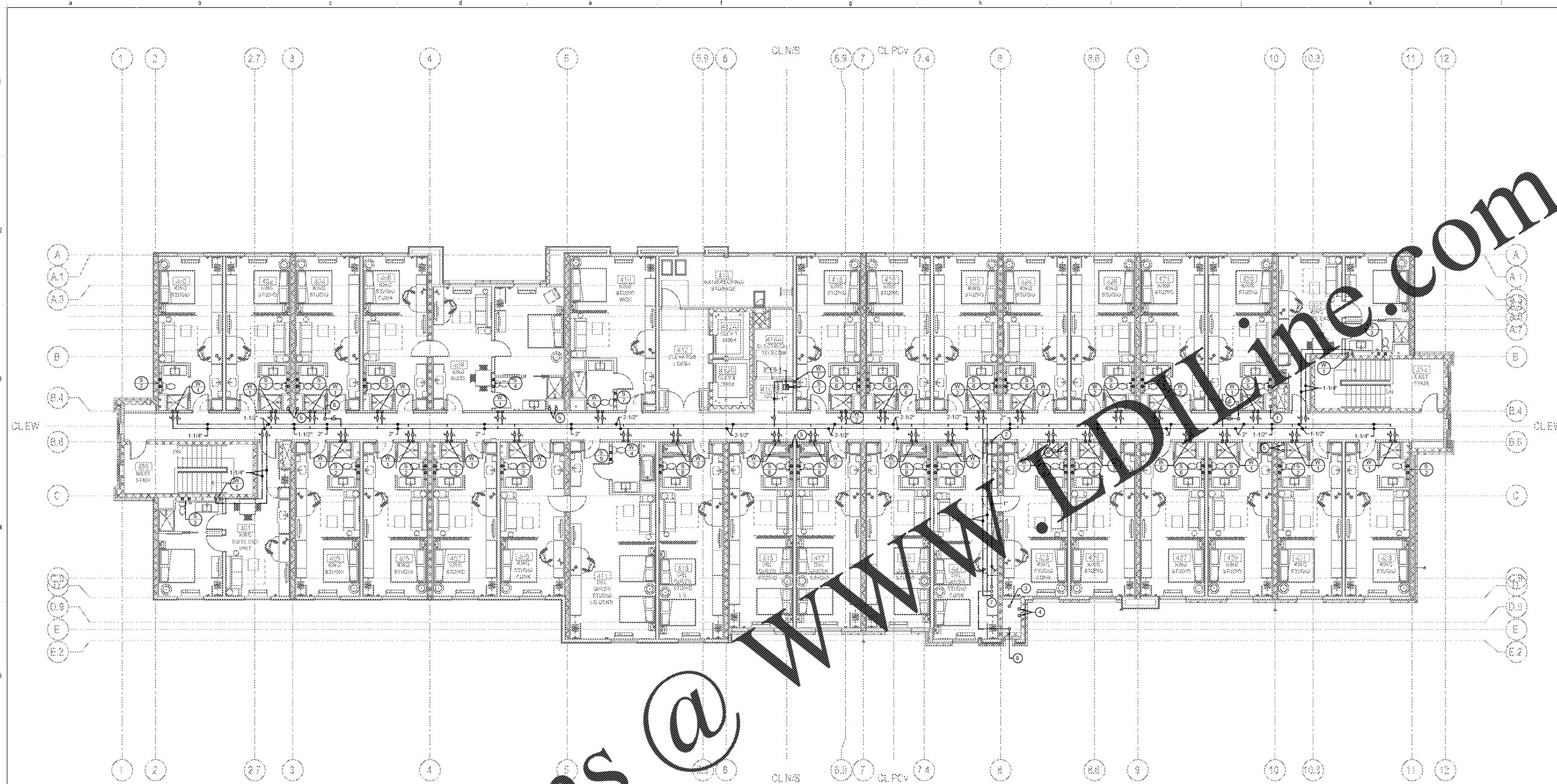

Order Plans @

FOURTH FLOOR PLUMBING PLAN
P.104 SCALE: 1/8" = 1'-0"

KEYED NOTES THIS SHEET

- ① 1-1/2" GAS PIPING FROM BELOW AND UP THROUGH ROOF.
- ② 1" HWR FROM BELOW.
- ③ 4" WASTE FROM ABOVE AND DOWN.
- ④ 4" RWC FROM ABOVE AND DOWN.
- ⑤ 6" RWC DOWN.
- ⑥ 3/4" CW CONNECTION TO FRH ABOVE.
- ⑦ 1" HWR, 2-1/2" CW AND 2-1/2" HW UP TO PENTHOUSE.
- ⑧ 2-1/2" CW PIPING UP FROM BLW.

GENERAL NOTES THIS SHEET

1. SEE ENLARGED TYPICAL GUEST ROOM PLANS ON SHEETS P.201 AND P.202 FOR PIPING IN GUEST ROOMS.
2. SEE FIXTURE SCHEDULE ON SHEET P.002 FOR SIZES OF DOMESTIC WATER AND SANITARY WASTE AND VENT CONNECTIONS TO INDIVIDUAL FIXTURES.
3. SEE RISER DIAGRAMS ON SHEETS P.301 TO P.303 FOR PIPE SIZES AND ADDITIONAL INFORMATION.
4. ALL DOMESTIC WATER PIPING AND ALL NATURAL GAS PIPING SHOWN ON THIS SHEET SHALL BE RUN ABOVE CEILING IN AREAS WITH CEILING AND SHALL BE RUN AS HIGH AS POSSIBLE IN AREAS WITHOUT CEILING, UNLESS OTHERWISE NOTED.
5. ALL SANITARY VENT PIPING SHOWN ON THIS SHEET SHALL BE RUN ABOVE CEILING IN AREAS WITH CEILING AND SHALL BE RUN AS HIGH AS POSSIBLE IN AREAS WITHOUT CEILING, UNLESS OTHERWISE NOTED. ALL SANITARY WASTE PIPING AND ALL STORM DRAIN PIPING SHOWN ON THIS SHEET SHALL BE RUN BELOW FLOORS, UNLESS OTHERWISE NOTED.