

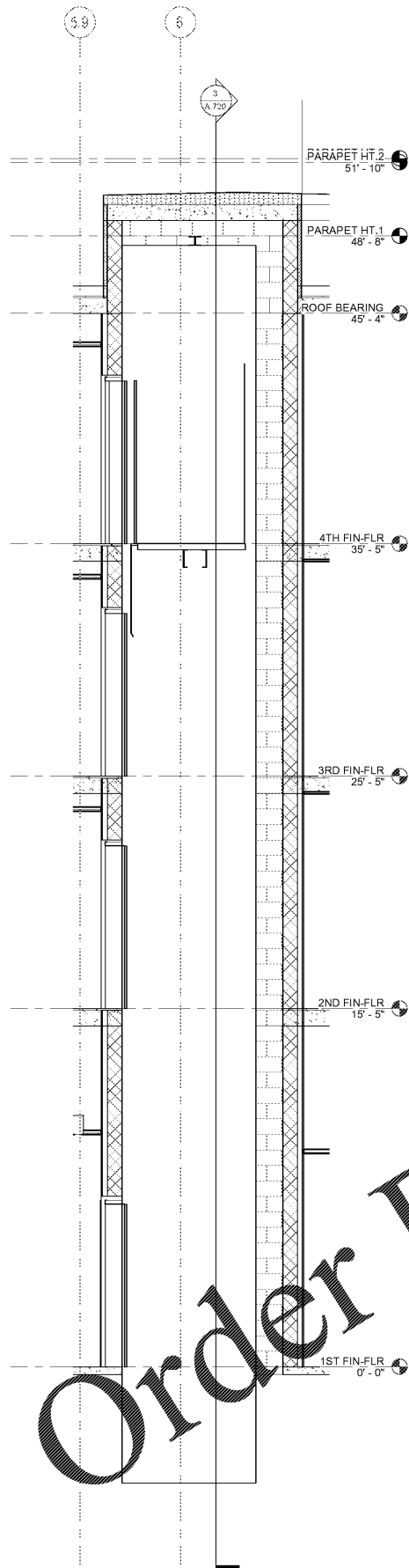

Revisions		
#	Date	Description

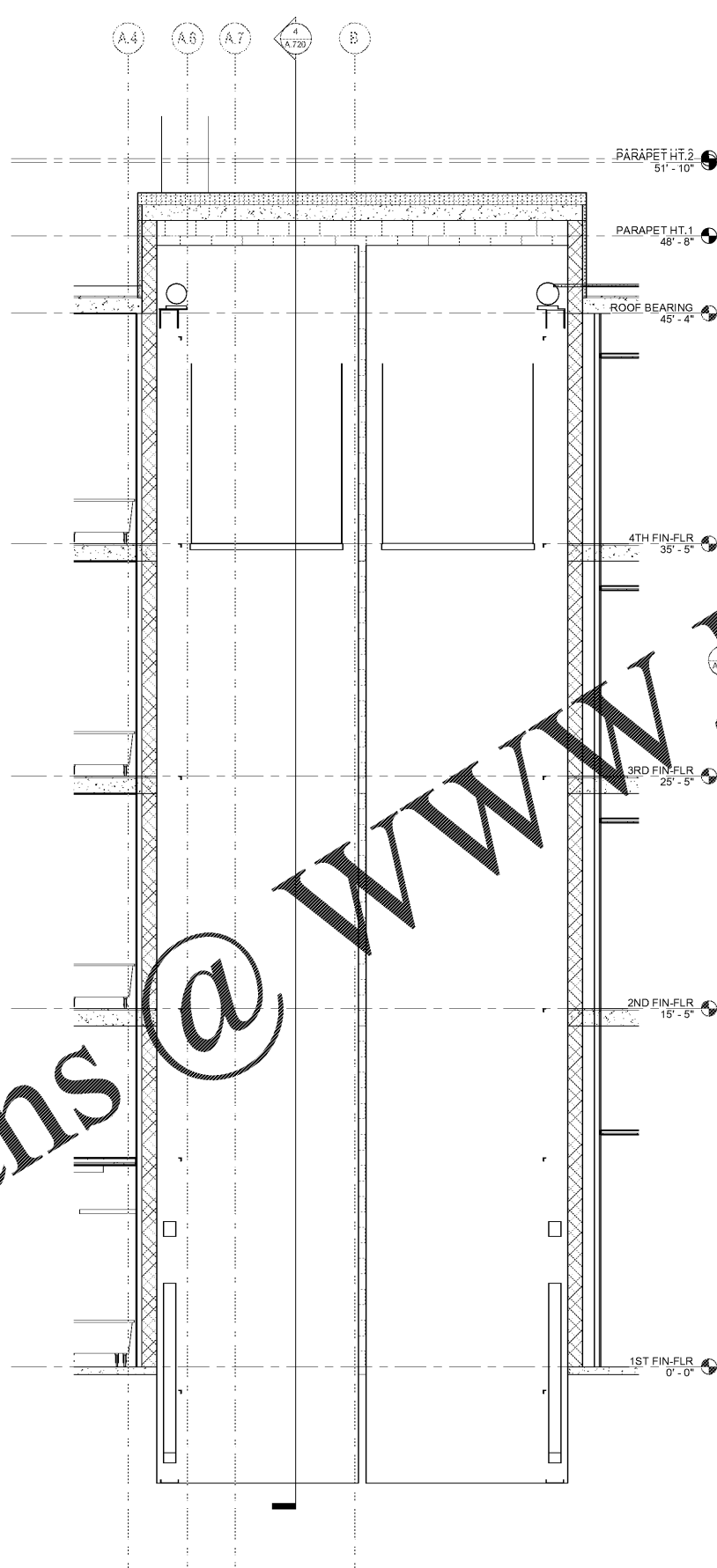

**4 DS ELEVATOR - CROSS SECTION**  
SCALE: 3/8" = 1'-0"



**3 DS ELEVATOR - SECTION 1**  
SCALE: 3/8" = 1'-0"

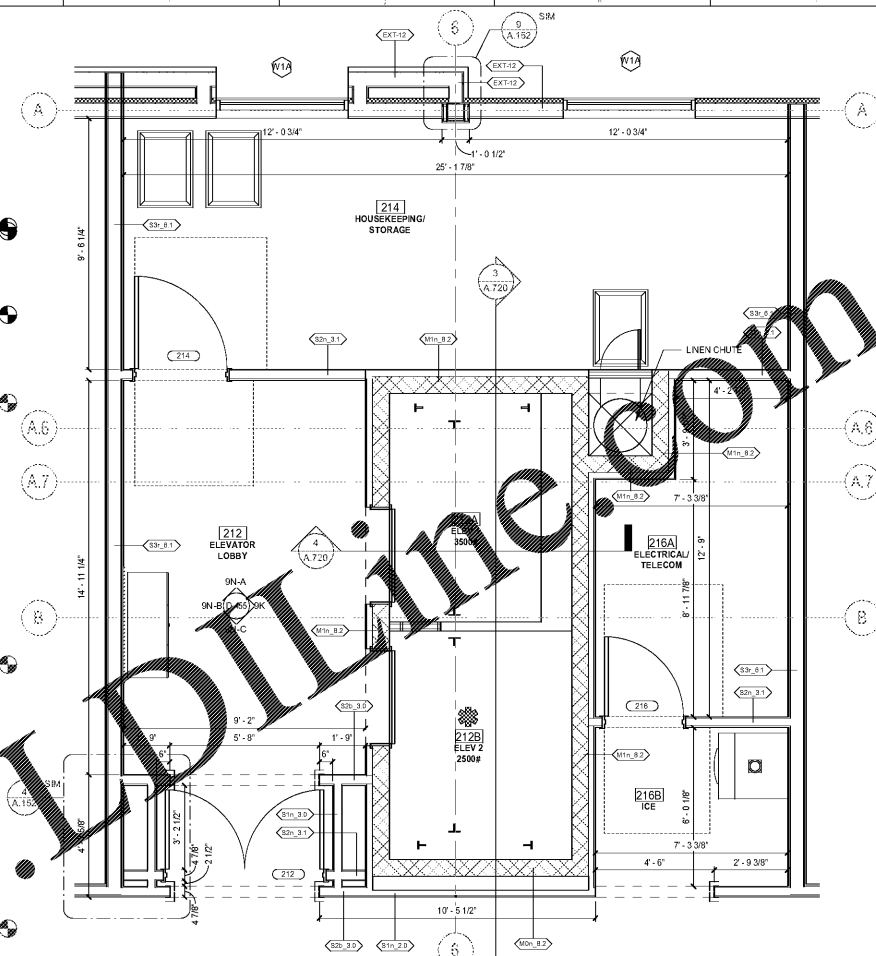

**ENLARGED PLAN - ELEVATOR LOBBY 2ND  
2 THROUGH 4TH FLOOR**  
SCALE: 3/8" = 1'-0"

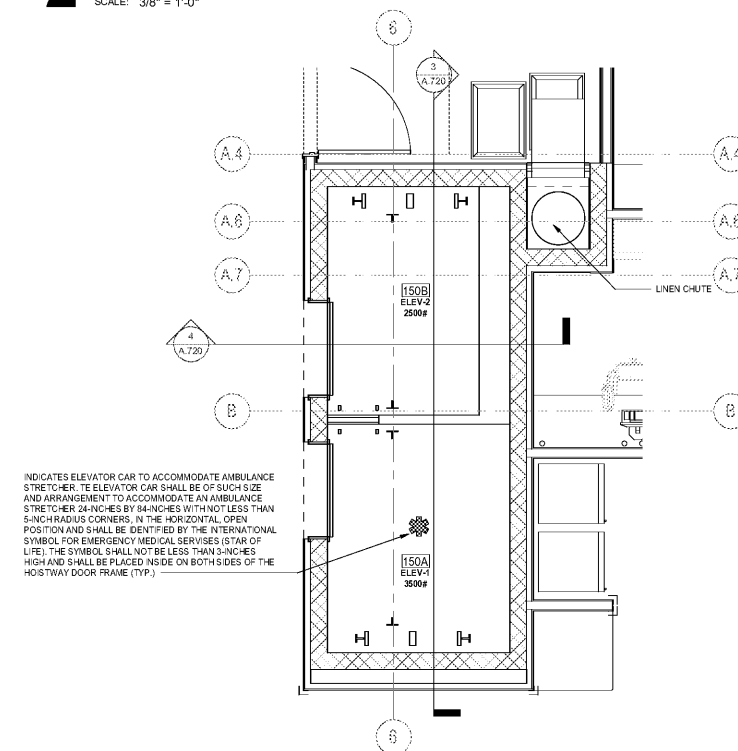

INDICATES ELEVATOR CAR TO ACCOMMODATE AMBULANCE STRETCHER. THE ELEVATOR CAR SHALL BE OF SUCH SIZE AND ARRANGEMENT TO ACCOMMODATE AN AMBULANCE STRETCHER 34-INCHES BY 84-INCHES WITH NOT LESS THAN 5-INCH RADIUS CORNERS. IN THE HORIZONTAL OPEN POSITION AND SHALL BE IDENTIFIED BY THE INTERNATIONAL SYMBOL FOR EMERGENCY MEDICAL SERVICES (STAR OF LIFE). THE SYMBOL SHALL NOT BE LESS THAN 3-INCHES HIGH AND SHALL BE PLACED INSIDE ON BOTH SIDES OF THE HOISTWAY DOOR FRAME (TYP.)

**ENLARGED PLAN - ELEVATOR LOBBY 1ST  
1 FLOOR**  
SCALE: 3/8" = 1'-0"

Order Plans @ [WWW.LDOnline.com](http://WWW.LDOnline.com)