

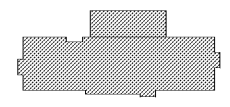

HOME 2 SUITES BELMONT

HAWLEY AVE
BELMONT, NC 28012

KEY PLAN



Revisions		
#	Date	Description

Project Number: 18021
Issued for: CONSTRUCTION
Issue Date: 2019-06-07

DRAWING TITLE
TYPICAL INTERIOR WALL SECTIONS

SHEET NUMBER
A.431

- LINEN CHUTE NOTES:**
- 2 HR FIRE RATED SHAFT ASSEMBLY TO BE CONTINUOUS THROUGH INTERMEDIATE FLOOR/CEILING ASSEMBLIES FROM SLAB ON GRADE TO UNDERSIDE OF ROOF DECK.
 - LINEN CHUTE TO BE PROTECTED BY AUTOMATIC SPRINKLER SYSTEM IN ACCORDANCE WITH APPLICABLE CODES.
 - PROVIDE POWER AT EACH CHUTE ACCESS DOOR FOR INTERCONNECTED LOCKING SAFETY SYSTEM.
 - COORDINATE 2" IPS DRAIN FLANGE WITH PLUMBING.

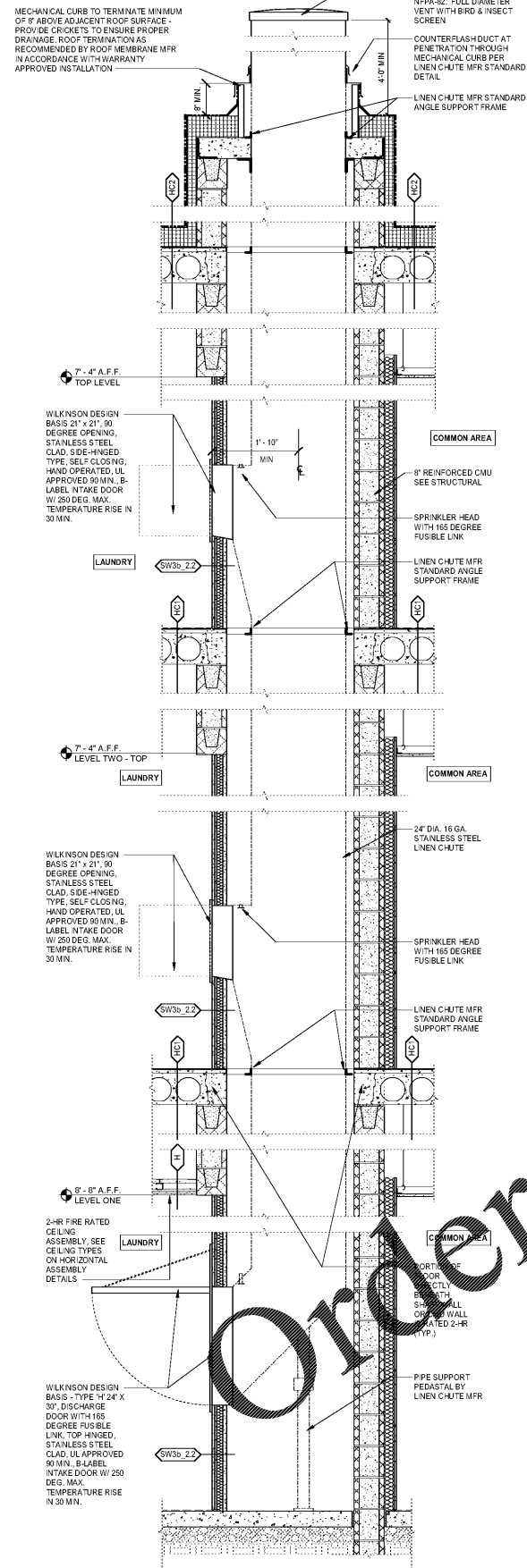

1 TYP. 2 HR LAUNDRY CHUTE CHASE
SCALE: 3/4" = 1'-0"