

SYMBOLS FOR EROSION & SEDIMENT CONTROL PRACTICES	
TEMPORARY PRACTICES	VEGETATIVE PRACTICES
CHECK DAM	MULCHING
CONSTRUCTION ENTRAPMENT/EOT	PERMANENT SEEDING
CONSTRUCTION ROAD STABILIZATION	SODDING
DIVERSION	SURFACE ROUGHENING
DUST CONTROL	TEMPORARY SEEDING
SEDIMENT BASIN	TOPSOILING
SILT FENCE	TREES, SHRUBS, VINES & GROUND COVERS
STORM DRAIN INLET PROTECTION (SILT FENCE)	COMPOSITE PRACTICES
STRAW BALE BARRIER	RIPRAP
BUFFER ZONE	HOUSE-KEEPING PRACTICES
PERMANENT PRACTICES	PORTABLE TOILETS
DETENTION BASIN	PROPOSED DUMPSTERS
DIVERSION	PROPOSED HAZARDOUS MATERIAL STORAGE AREA
PAVED FLUME	
ROCK OUTLET PROTECTION	

GENERAL NOTES:

1. EROSION CONTROL MEASURES WILL BE MAINTAINED AT ALL TIMES. IF FULL IMPLEMENTATION OF THE APPROVED PLAN DOES NOT PROVIDE FOR EFFECTIVE EROSION CONTROL, ADDITIONAL EROSION AND SEDIMENT CONTROL MEASURES SHALL BE IMPLEMENTED TO CONTROL OR TREAT THE SEDIMENT SOURCE. ALL COSTS TO IMPLEMENT ADDITIONAL EROSION CONTROL MEASURES SHALL BE THE RESPONSIBILITY OF THE CONTRACTOR. ALL COSTS SHALL BE INCLUDED IN THE CONTRACTOR'S BID.
2. THE ESCAPE OF SEDIMENT FROM THE SITE SHALL BE PREVENTED BY THE INSTALLATION OF EROSION AND SEDIMENT CONTROL MEASURES AND PRACTICES PRIOR TO OR CONCURRENT WITH LAND DISTURBING ACTIVITIES.
3. ANY DISTURBED AREA LEFT EXPOSED FOR A PERIOD GREATER THAN 14 DAYS SHALL BE STABILIZED WITH MULCH OR TEMPORARY SEEDING.
4. THIS PLAN IS FOR EROSION AND SEDIMENT CONTROL ONLY. DO NOT USE THIS PLAN FOR GRADING OR SITE LAYOUT.
5. ALL 2:1 SLOPES MUST BE STABILIZED WITH MATTING, MULCH AND/OR PLANT MATERIAL TO ENSURE THAT RUNOFF AND SILT DOES NOT LEAVE THE SITE.
6. THE INSTALLATION OF EROSION AND SEDIMENTATION CONTROL MEASURES AND PRACTICES SHALL OCCUR PRIOR TO OR CONCURRENT WITH LAND DISTURBING ACTIVITIES.
7. THE TEMPORARY SEDIMENT BASIN SHALL BE CONSTRUCTED IN CONJUNCTION WITH CLEARING AND PRIOR TO ANY OTHER SITEWORK.
8. ACCESS MUST BE PROVIDED AND MAINTAINED TO EACH TEMPORARY SEDIMENT BASIN DURING CONSTRUCTION SO THAT SEDIMENT MAY BE REMOVED FROM BASIN WHEN NEEDED.
9. ALL SLOPES THAT EXCEED A HEIGHT OF 8' SHALL RECEIVE AN EROSION CONTROL BLANKET OF TYPE #575 BY AMERICAN GREEN OR APPROVED EQUAL.
10. WASTE MATERIALS MAY NOT BE DISCHARGED FROM THE SITE DURING OR AFTER CONSTRUCTION EXCEPT AS AUTHORIZED BY A SECTION 404 PERMIT.
11. THIS EROSION, SEDIMENT, & POLLUTION CONTROL PLAN IS IN COMPLIANCE WITH ALL WASTE DISPOSAL, SANITARY SEWER, AND SEPTIC TANK REGULATIONS.
12. ANY DISTURBED AREA NOT RECEIVING A PERMANENT GROUND COVER (PAVING, BUILDING, LANDSCAPE SOD, ETC.) SHALL BE STABILIZED WITH TEMPORARY SEEDINGS AND PERMANENT VEGETATION PER THE SEEDING SCHEDULE ON THE DETAIL SHEETS.
13. COORDINATE TEMPORARY SEEDING AND MULCHING INSTALLATION WITH LANDSCAPING PLAN TO MINIMIZE DISTURBANCE ON SITE.
14. STANDARD AND SPECIFICATIONS: ALL DESIGNS WILL CONFORM TO AND ALL WORK WILL BE PERFORMED IN ACCORDANCE WITH THE STANDARDS AND SPECIFICATIONS OF THE MISSISSIPPI PUBLICATION ENTITLED "PLANNING & DESIGN MANUAL FOR THE CONTROL OF EROSION, SEDIMENT & STORMWATER".
15. IF THE ASPHALT BINDER COURSE HAS BEEN PLACED PRIOR TO TARGET BUILDING PAD TURNOVER AND TARGET BUILDING CONTRACTOR STAGING AREA ACCEPTANCE, THE TEMPORARY ALL-WEATHER SURFACE IS NOT REQUIRED. THE TEMPORARY ACCESS ROAD, TARGET BUILDING RING ROAD, AND TARGET BUILDING CONTRACTOR STAGING AREA REQUIRE AN ALL-WEATHER SURFACE CONSISTING OF A MINIMUM OF THE SECTION SHOWN IN THE DETAIL SHEETS OR THE ASPHALT BINDER COURSE.
16. ALL-WEATHER ACCESS ROAD IN RETAIL TRACT TO BE 20' WIDE. ALL-WEATHER ACCESS ROAD WITHIN TARGET, KOL'S, AND JOPPENNEY TRACT TO BE 25' WIDE.
17. EXTREME PRECAUTION MUST BE MADE BY THE CONTRACTOR WITH THE USE OF EROSION CONTROL BMPs TO ENSURE THAT NO SEDIMENT OR TRASH ENTERS THE WETLANDS OR RIVER. SUPPLEMENTAL BMPs, IN ADDITION TO WHAT IS CALLED OUT ON THIS PLAN, MAY BE NECESSARY TO CONTROL THE CHANGING ON-SITE CONDITIONS AS CONSTRUCTION OCCURS.

ALL UTILITIES SHOWN ON THIS PLAN ARE BASED ON THE TOPOGRAPHIC/UTILITY SURVEY PERFORMED BY PATRICK M. MARTINO DATED 5/23/19 AND THE UTILITY LOCATIONS PER THE ORIGINAL SITE DESIGN CIVIL DRAWINGS. THE CONTRACTOR SHALL VERIFY THE LOCATION OF ALL UTILITIES PRIOR TO CONSTRUCTION AND NOTIFY THE ARCHITECT AND CIVIL ENGINEER OF ANY DISCREPANCIES.

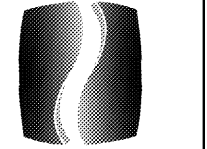

PHILLIPS
architects + engineers

770.394.1616

CONSULTANT



SEAL



5/30/19

ISSUE & REVISION RECORD

#	DATE	DESCRIPTION
1	05/30/2019	PERMIT SUBMITTAL

TENANT

PROJECT

THE PROMENADE

D'IBERVILLE, MS.

CLIENT

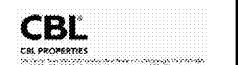

PHILLIPS JOB NUMBER 1925401

ISSUE DATE 05/30/2019

DRAWN BY/CHECKED BY

DRAWING TITLE

EROSION CONTROL PLAN

SHEET NUMBER

C-4.0

THE PALISADES
5901 PEACHTREE DUNWOODY RD
BUILDING A, SUITE -50
ATLANTA, GEORGIA 30328

HGA JOB No. 2019-049

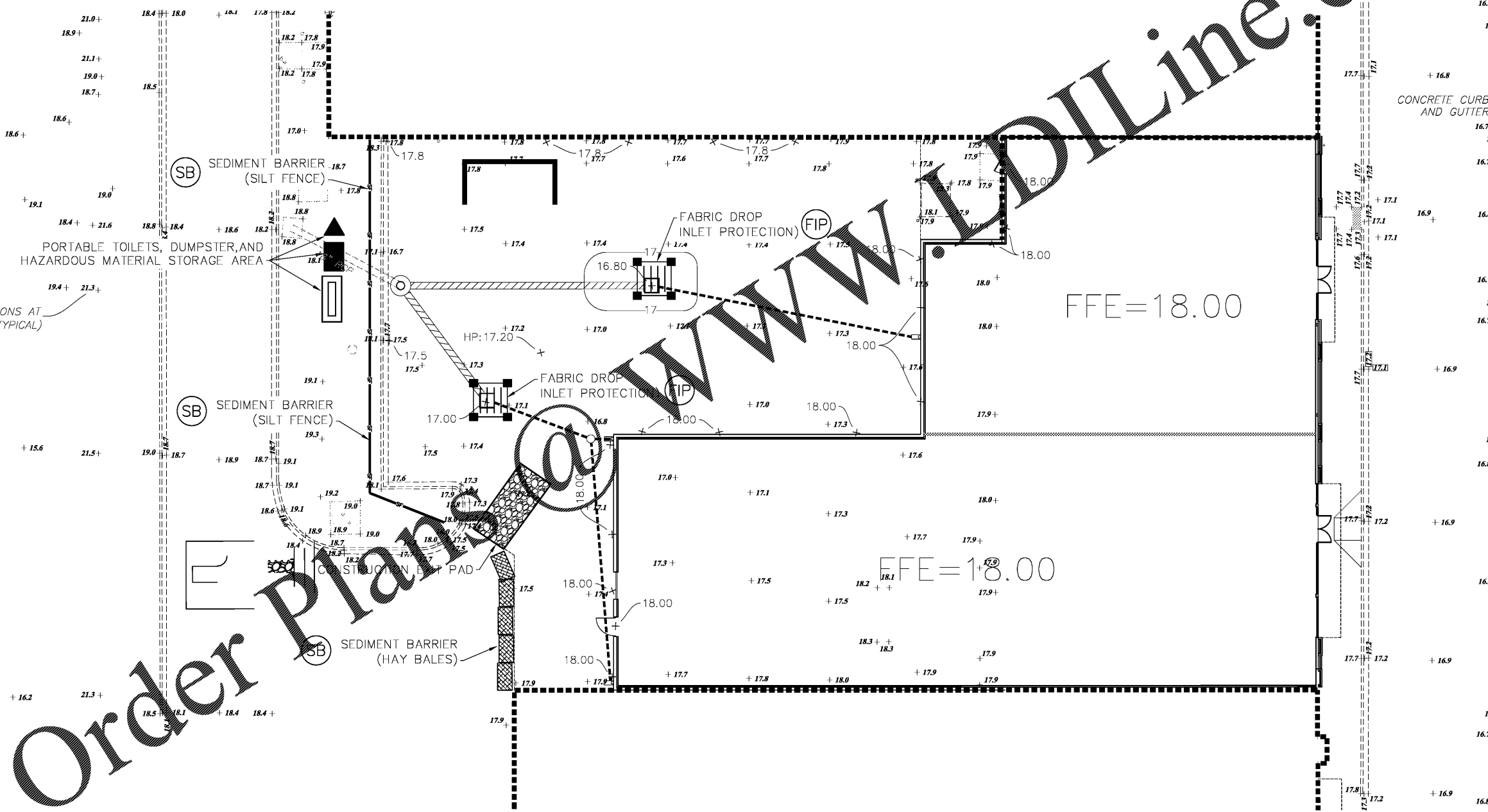

DENOTES ELEVATIONS AT TIME OF SURVEY (TYPICAL)

Order Plans

EROSION CONTROL PLAN

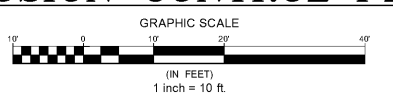

CAUTION-NOTE TO CONTRACTOR
THE CONTRACTOR IS SPECIFICALLY CAUTIONED THAT THE LOCATION AND/OR ELEVATION OF EXISTING UTILITIES AS SHOWN ON THESE PLANS IS BASED ON RECORDS OF THE VARIOUS UTILITIES COMPANIES AND, WHERE POSSIBLE, ADEQUATELY MARKED IN THE FIELD. IF INFORMATION IS NOT TO BE RELIED ON AS BEING EXACT OR COMPLETE, CALL 811 BEFORE THE CONTRACTOR BEGINS ANY EXCAVATION OR OTHER WORK. UTILITIES, IT SHALL BE THE RESPONSIBILITY OF THE CONTRACTOR TO COORDINATE THE RECORDING OF ALL UTILITIES BEFORE COMMENCING ANY EXCAVATION OR OTHER WORK IMPROVEMENTS SHOWN ON THESE PLANS.