

**GENERAL NOTES:**

1. ALL CONSTRUCTION MUST COMPLY WITH THE CONCLUSIONS AND RECOMMENDATIONS INCLUDED IN THE GEOTECHNICAL REPORT FOR THIS SITE PREPARED BY CONTOUR ENGINEERING, L.L.C. DATED MAY 14, 2008, INCLUDING ALL ADDENDUMS.
2. GRADING SHALL BE DONE IN ACCORDANCE WITH THE LINES AND GRADES DRAWN ON THE APPROVED GRADING PLAN.
3. THE GRADES SHOWN ON THIS PLAN REPRESENT FINISH GRADE. THE CONTRACTOR SHALL ALLOW FOR THE THICKNESS OF THE PAVEMENT AND FLOOR SLABS WHEN FINISH GRADING THE SITE.
4. REQUIRED EROSION AND SEDIMENT CONTROL MEASURES AND STORMWATER DRAINAGE FACILITIES ARE TO BE INSTALLED IN ACCORDANCE WITH THE APPROVED PLANS AS DEVELOPMENT PROGRESSES.
5. CUT OR FILL SLOPES SHOULD NOT BE STEEPER THAN 2:01 : 1.0V.
6. ALL 2:1 SLOPES MUST BE STABILIZED WITH MATING, MULCH AND/OR PLANT MATERIAL TO ENSURE THAT RUNOFF AND SLT DOES NOT LEAVE THE SITE.

ALL CONSTRUCTION ON SITE MUST COMPLY WITH THE CONCLUSIONS AND RECOMMENDATIONS IN THE GEOTECHNICAL REPORT AND ADDITIONAL GEOTECHNICAL INVESTIGATION LETTERS PREPARED SPECIFICALLY FOR THIS SITE.

ALL ROOF DRAIN LEADERS AND ROOF DRAIN COLLECTOR PIPES SHALL BE INSTALLED AT A MINIMUM SLOPE OF 1%.

THE GRADES SHOWN ON THIS PLAN REPRESENT FINISHED GRADE. THE CONTRACTOR SHALL ALLOW FOR THE THICKNESS OF THE PAVEMENTS AND THE FLOOR SLABS WHEN FINISH GRADING THE SITE.

NOTE: CUT OR FILL SLOPES SHOULD NOT BE STEEPER THAN 2:01 : 1.0V.

ALL UTILITIES SHOWN ON THIS PLAN ARE BASED ON THE TOPOGRAPHIC/UTILITY SURVEY PERFORMED BY PATRICK M. MARTINO DATED 5/23/19 AND THE UTILITY LOCATIONS PER THE ORIGINAL SITE DESIGN CIVIL DRAWINGS. THE CONTRACTOR SHALL VERIFY THE LOCATION OF ALL UTILITIES PRIOR TO CONSTRUCTION AND NOTIFY THE ARCHITECT AND CIVIL ENGINEER OF ANY DISCREPANCIES.

**LEGEND**

PROPERTY LINES	---
EXISTING FEATURES	---
EXISTING CONTOUR ELEVATION	(1180)
EXISTING CONTOUR LINE	---
PROPOSED FEATURES	---
PROPOSED BUILDING	---
PROPOSED CONTOUR ELEVATION	740
PROPOSED SPOT ELEVATION	+740.50
PROPOSED DIRECTION OF FLOW	---
PROPOSED STORM SEWER	---
PROPOSED CURB INLET	---
PROPOSED DROP INLET	---
PROPOSED JUNCTION BOX	---
PROPOSED CLEANOUT	---

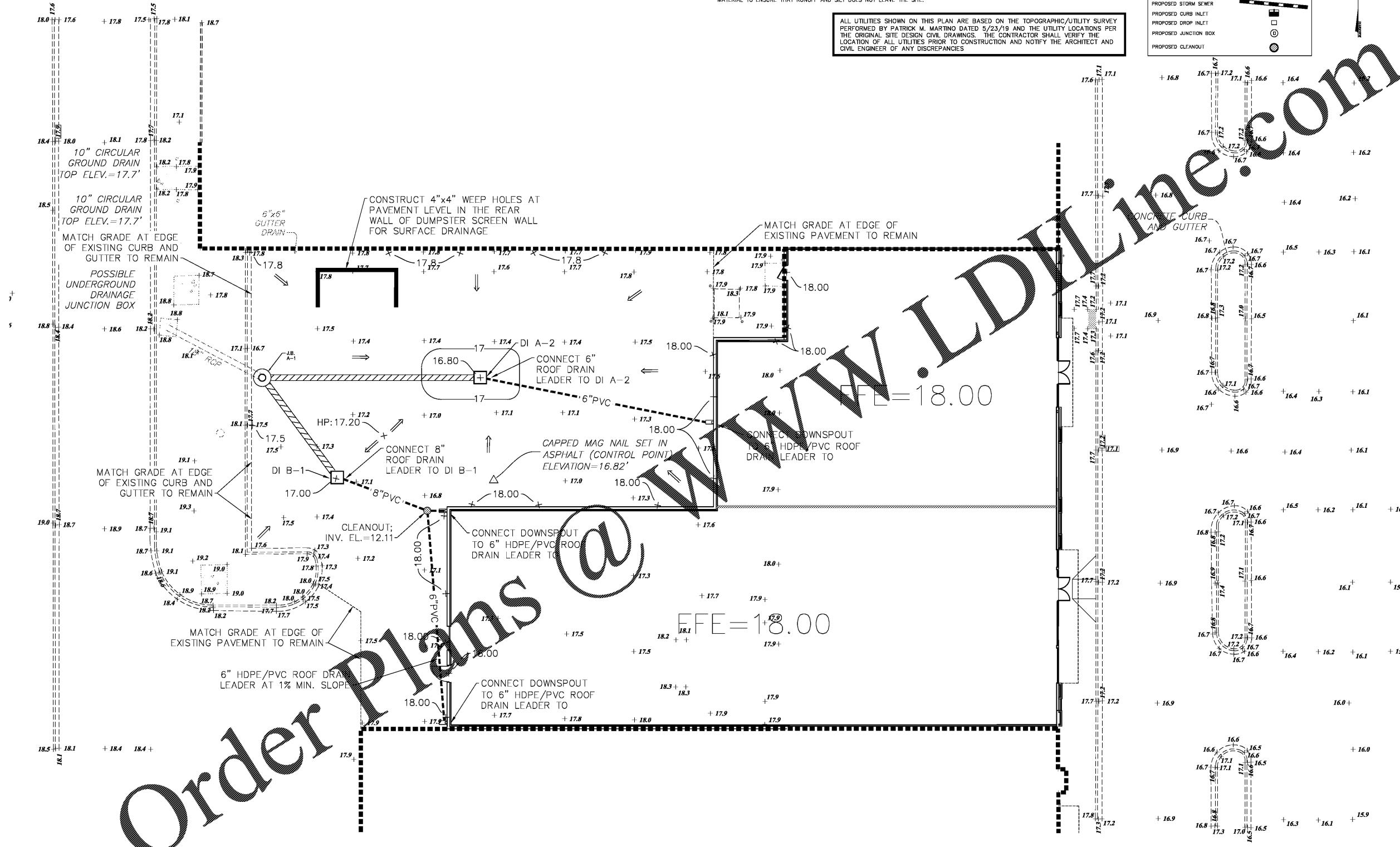

Order Plans @ WWW.LDLINE.COM

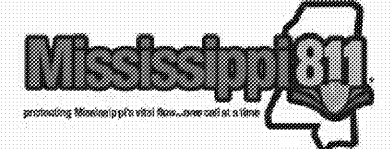

**CAUTION-NOTE TO CONTRACTOR**

THE LOCATION OF ALL UTILITIES SHOWN ON THESE PLANS IS BASED ON THE INFORMATION PROVIDED BY THE UTILITY COMPANIES AND IS NOT TO BE RELIED ON AS A GUARANTEE OF THE LOCATION OF ANY UTILITIES. THE CONTRACTOR SHALL VERIFY THE LOCATION OF ALL UTILITIES PRIOR TO CONSTRUCTION AND NOTIFY THE ARCHITECT AND CIVIL ENGINEER OF ANY DISCREPANCIES.

**GRAPHIC SCALE**

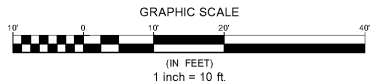

DENOTES ELEV TIME OF SURVEY

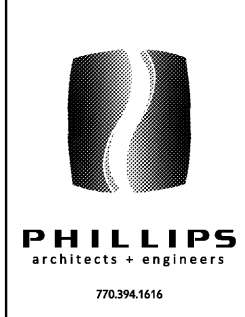

ISSUE & REVISION RECORD

#	DATE	DESCRIPTION
1	05/30/2019	PERMIT SUBMITTAL

TENANT: \_\_\_\_\_

PROJECT: \_\_\_\_\_

CLIENT: \_\_\_\_\_

PHILLIPS JOB NUMBER: 1925401

ISSUE DATE: 05/30/2019

DRAWN BY/CHECKED BY: \_\_\_\_\_

DRAWING TITLE: GRADING PLAN

SHEET NUMBER: C-3.0

THE PALISADES  
5901 PEACHTREE DUNWOODY RD.  
BUILDING A, SUITE -50  
ATLANTA, GEORGIA 30328