

ELECTRICAL FIXTURE SCHEDULE

| DESIGN ID | COUNT | DESCRIPTION | FURNISHED BY | INSTALLED BY | VOLTAGE | LOAD | RATING | COMMENTS |
|-----------|-------|---------------------------------------|--------------|--------------|---------|---------|--------|----------|
| 10179 | 1 | HAND DRYER SURFACE MOUNTED | SB | GC | 120 V | 1000 VA | 20 A | |
| 10179 | 1 | HAND DRYER SURFACE MOUNTED | SB | GC | 120 V | 1000 VA | 20 A | |
| 10312 | 1 | BREWER SOFT HEAT WARMING STAND SINGLE | SB | GC | 120 V | 162 VA | 20 A | |
| 10312 | 1 | BREWER SOFT HEAT WARMING STAND SINGLE | SB | GC | 120 V | 162 VA | 20 A | |
| 12508 | 1 | BLENDER QUIET MODEL | SB | GC | 120 V | 1800 VA | 20 A | |
| 12508 | 1 | BLENDER QUIET MODEL | SB | GC | 120 V | 1800 VA | 20 A | |
| 12618 | 1 | UNDERCOUNTER REFRIGERATOR | SB | GC | 120 V | 500 VA | 20 A | |
| 17564 | 1 | BLENDER PITCHER RINSER WITH SENSOR | SB | GC | 120 V | 180 VA | 20 A | |
| 17773 | 1 | KEG DISPENSER | SB | GC | 120 V | 500 VA | 20 A | |
| 19559 | 1 | NITROGEN GENERATOR | SB | GC | 120 V | 840 VA | 20 A | |

RESPONSIBILITY LEGEND

GC GENERAL CONTRACTOR
 LL LANDLORD
 SB STARBUCKS
NOTE: ALL RESPONSIBILITIES TO BE CONFIRMED WITH STARBUCKS DESIGN MANAGER PRIOR TO ORDERING/CONSTRUCTION

ELECTRICAL DRAWINGS ARE BASED UPON SCOPE OF WORK PROVIDED BY ARCHITECT AND LIMITED INFORMATION GATHERED FROM SITE SURVEY AND PREVIOUS CONSTRUCTION DRAWINGS, AND MAY NOT REFLECT EXACT "AS-BUILT" CONDITIONS. ELECTRICAL CONTRACTOR SHALL VERIFY EXISTING CONDITIONS, SIZES, AND LOCATIONS OF EQUIPMENT PRIOR TO FINAL BID. IF CONDITIONS ARE FOUND TO BE DIFFERENT THAN SHOWN, NOTIFY THE ENGINEER OF RECORD.

SHEET NOTES

- RECEPTACLE FOR FLOOR LAMP. REFER E102 - LIGHTING DESIGN PLAN FOR SCHEDULING INFORMATION.
- JUNCTION BOX FOR HAND DRYER. INSTALL PER MANUFACTURER'S INSTRUCTIONS. REFER TO ARCHITECTURAL DRAWINGS FOR MOUNTING HEIGHTS.
- BANQUETTE SEATING RECEPTACLES. E.C. SHALL PROVIDE 1/2" CONDUIT WITH 2#12 & #12 GROUND FROM RECEPTACLE IN SEATING TO JUNCTION BOX LOCATED IN NEAREST WALL. COORDINATE ALL REQUIREMENTS WITH SEATING VENDOR AND CONSTRUCTION SUPERVISOR PRIOR TO ROUGH-IN."
- PROVIDE TWO QUADRUPLX RECEPTACLES AND TWO 2-DATA CABLE PASS THROUGH WALL PLATE AT 75" AFF CENTERED BEHIND THE MENU BOARDS FOR FUTURE DIGITAL MENU BOARD INSTALLATION. VERIFY LOCATION AND REQUIREMENTS WITH ARCHITECT AND CONSTRUCTION MANAGER.
- EXISTING RESTROOM GFCI RECEPTACLE TO REMAIN.
- CUSTOMER USB CONVENIENCE OUTLETS MOUNTED AT 42" AFF.

ELECTRICAL DESIGN PLAN NOTES

- REFER TO ELECTRICAL DETAIL SHEETS FOR EXACT LOCATIONS AND MOUNTING HEIGHTS OF ELECTRICAL DEVICES.
- THE ELECTRICAL CONTRACTOR IS RESPONSIBLE FOR CONFIRMING ALL VOLTAGE REQUIREMENTS ON ALL EQUIPMENT AND PROVIDING BUCK-BOOST TRANSFORMERS AS MAY BE NEEDED FOR CODE. ALL ARE NOT NECESSARILY INDICATED.
- ELECTRICAL CONTRACTOR SHALL COORDINATE WITH PLUMBING AND HEATING, VENTILATING, AND AIR CONDITIONING (HVAC) CONTRACTORS FOR ANY ADDITIONAL EQUIPMENT NEEDING POWER.
- ANY EQUIPMENT NOTED AS 'FUTURE' SHALL BE PROVIDED WITH APPROPRIATE RECEPTACLE AND WIRING TO ENABLE FUTURE OPERATION.
- GROUND FAULT CIRCUIT INTERRUPTER (GFCI) BREAKERS (NOT RECEPTACLES) SHALL BE UTILIZED WHERE REQUIRED BY CODE AND AT ALL J-BOXES. PROVIDE DEDICATED NEUTRAL WIRE FOR ALL THESE CIRCUITS.
- EQUIPMENT REQUIREMENTS CONNECTED TO THE BUILDING ELECTRICAL SYSTEM. FURNISH AND INSTALL ALL NECESSARY CONDUIT, WIRE, CONNECTIONS, RECEPTACLES AND OVERCURRENT PROTECTION NECESSARY TO ENSURE THE EQUIPMENT FUNCTIONS PROPERLY AND COMPLIES WITH ALL APPLICABLE LOCAL AND NATIONAL CODES. COORDINATE EQUIPMENT REQUIREMENTS WITH MANUFACTURER CUT SHEET PRIOR TO ROUGH-IN.
- ALL FRONT BAR J-BOXES AND OUTLETS SHALL BE SURFACE MOUNTED. PROVIDE CONDUITS AS NEEDED AND ONE (1) ADDITIONAL SPARE CONDUIT BETWEEN ALL J-BOXES FOR FUTURE ELECTRICAL REQUIREMENTS. ALL J-BOXES SHALL BE POSITIONED TO AVOID OBSTRUCTION OF ANY EQUIPMENT SUCH AS REFRIGERATORS AND DISHWASHERS.
- REFERENCE LANDLORD WORK LETTER FOR DIVISION OF ELECTRICAL SCOPE OF WORK AND COORDINATE WITH STARBUCKS CONSTRUCTION MANAGER.



STARBUCKS[®]
 2401 UTAH AVENUE SOUTH
 SEATTLE, WASHINGTON 98134
 (206) 318-1575

THESE DRAWINGS AND THE PROJECT MANUAL ARE CONFIDENTIAL AND SHALL REMAIN THE SOLE PROPERTY OF STARBUCKS CORPORATION, WHICH IS THE OWNER OF THE COPYRIGHT IN THIS WORK. THEY SHALL NOT BE REPRODUCED (IN WHOLE OR IN PART), SHARED WITH THIRD PARTIES OR USED IN ANY MANNER ON OTHER PROJECTS OR EXTENSIONS TO THIS PROJECT WITHOUT THE PRIOR WRITTEN CONSENT OF STARBUCKS CORPORATION. THESE DRAWINGS AND SPECIFICATIONS ARE INTENDED TO EXPRESS DESIGN INTENT FOR A PROTOTYPICAL STARBUCKS STORE (WHICH IS SUBJECT TO CHANGE AT ANY TIME) AND DO NOT REFLECT ACTUAL SITE CONDITIONS. NEITHER PARTY SHALL HAVE ANY OBLIGATION NOR LIABILITY TO THE OTHER (EXCEPT AS STATED ABOVE) UNTIL A WRITTEN AGREEMENT IS FULLY EXECUTED BY BOTH PARTIES.

STARBUCKS TEMPLATE VERSION I2019.01.11

Randall C. Haase
 P.E.

SUITE 5039 479.636.5004
 1855 N. 2ND ST. JOB NO.: 23118
 ROGERS, AR 72756 DESIGNED BY: LES

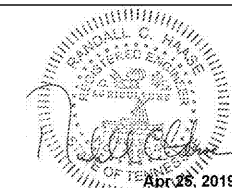

PROJECT NAME:
CUSICK & ALCOA

PROJECT ADDRESS:
 121 CUSICK ROAD
 ALCOA, TN 37701
 BLOUNT COUNTY

STORE #: 11293
 PROJECT #: 36099-035
 ISSUE DATE: 04.26.19
 DESIGN MANAGER: L. MACEDA
 PRODUCTION DESIGNER: LES
 CHECKED BY: WAJ

| Revision Schedule | | | |
|-------------------|------|----|-------------|
| Rev | Date | By | Description |
| | | | |
| | | | |

SHEET TITLE:
ELECTRICAL DESIGN PLAN
 SCALE: AS SHOWN

SHEET NUMBER:
E101

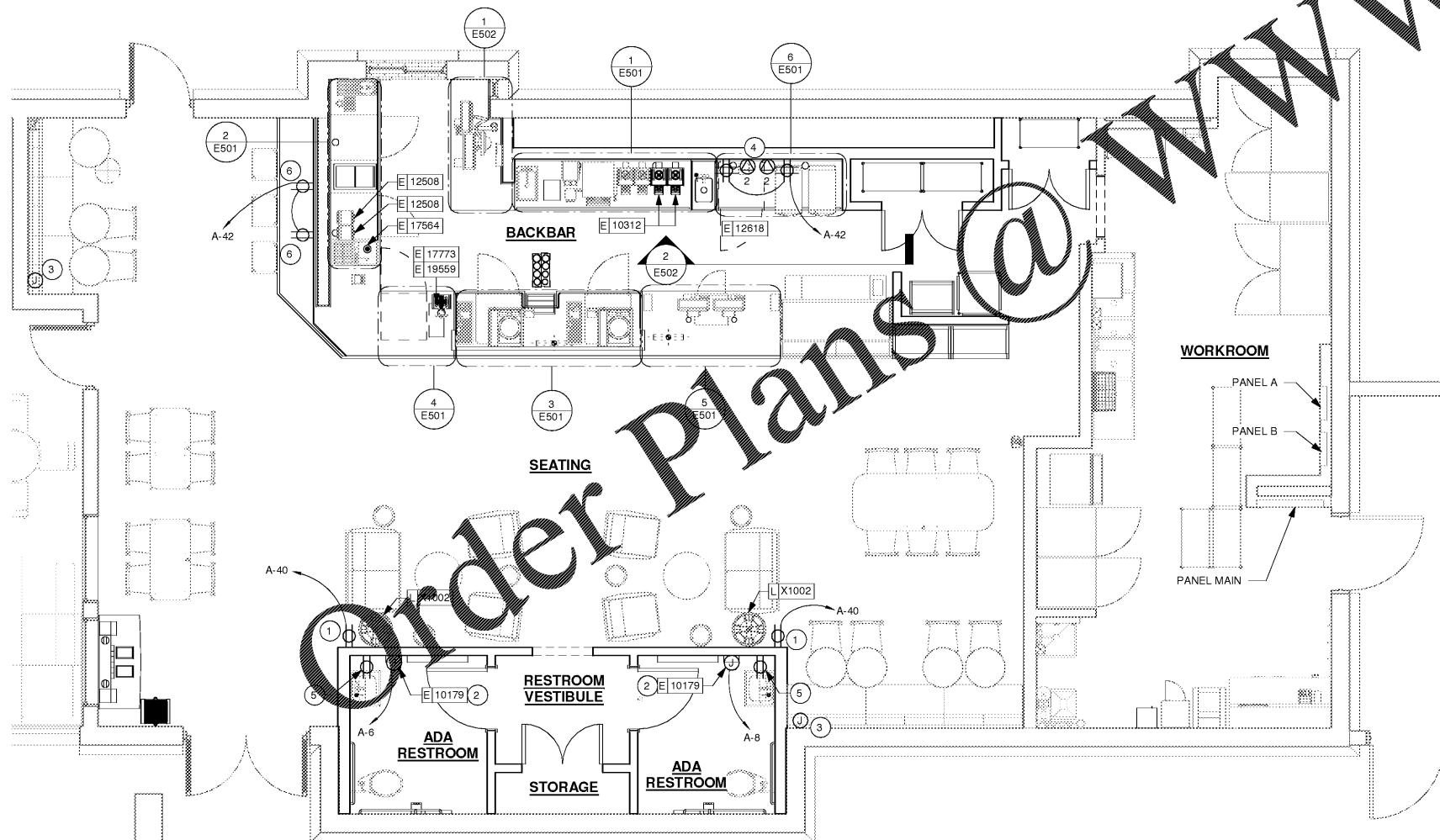

1 ELECTRICAL DESIGN PLAN
 Scale: 1/4" = 1'-0"



www.LDILine.com

Order Plans @

CONSTRUCTION DOCUMENTS - ISSUED FOR CONSTRUCTION USE