

CEILING TREATMENT SCHEDULE - "U"					
DESIGN ID	AREA	DESCRIPTION	FURN. BY	INST. BY	COMMENTS
ACT					
X4001	703 SF	ACT - HAZE - 2X2FT	GC	GC	ARMSTRONG FINE FISSURED IN COLOR: HAZE, PAINT EXISTING ACT GRID SW7022 ALPACA.
VCT					
X4002	102 SF	VCT - WHITE - 2X4FT	GC	GC	ARMSTRONG CLEAN ROOM VL

PAINT SCHEDULE					
COLOR CODE	DESCRIPTION	LRV	FURN. BY	INST. BY	COMMENTS
SW7022	SHERWIN WILLIAMS - SW7022 - ALPACA	57	GC	GC	
SW7048	SHERWIN WILLIAMS - SW7048 - URBANE BRONZE	8	GC	GC	

LEGEND

- ELEVATION DATUM
- TRACK LIGHTING
- RECESSED CAN LIGHT
- TROFFER
- EXIT SECURITY LIGHT
- MUSIC SYSTEM SPEAKER
- WIFI ACCESS POINT (WAP)
- SUPPLY AIR
- RETURN AIR

KEYED NOTES

1. EXISTING TO REMAIN (ETR).
2. GWB SOFFIT WITH SMOOTH FINISH (PAINT AS SCHEDULED).
3. GWB CEILING, PAINT CEILING DIFFUSERS TO MATCH ADJACENT FINISH.
4. WASHABLE CEILING TILE LOCATED IN BACK OF HOUSE AND ABOVE BACKBAR.
5. HEATING, VENTILATING AND AIR CONDITIONING FOR REFERENCE ONLY. SEE MECHANICAL DRAWINGS FOR ADDITIONAL INFORMATION.
6. EXISTING MUSIC SPEAKER TO REMAIN.

GENERAL NOTES

- A. IF REQUIRED BY LOCAL CODE, GENERAL CONTRACTOR TO PROVIDE SEMI-RECESSED SPRINKLER HEADS WITH POLISHED CHROME ESCUTCHEONS CENTERED IN ACOUSTICAL CEILING TILE. IF PENDANT HEADS ARE REQUIRED IN GWB SOFFIT OVER FRONTBAR, CONCEAL SUPPLY PIPING WITHIN SOFFIT. GENERAL CONTRACTOR TO SUBMIT SPRINKLER LAYOUT TO STARBUCKS' CONSTRUCTION MANAGER FOR APPROVAL PRIOR TO INSTALLATION.
- B. LEAVE TEN (10) ADDITIONAL RETAIL CEILING TILES TO MATCH RETAIL CEILING PAINT COLOR ABOVE THE WORKROOM CEILING AT MANAGER'S DESK FOR FUTURE USE.
- C. PROVIDE GROMMET AT ACOUSTIC CEILING PENETRATIONS FOR FIXTURES OF SUPPORT.
- D. HEATING, VENTILATING AND AIR CONDITIONING SHOWN ON THIS PLAN PROVIDED FOR REFERENCE ONLY. SEE MECHANICAL DRAWINGS FOR ADDITIONAL INFORMATION.
- E. DIFFUSERS AND RECESSED ACOUSTICAL CEILING TILE TO BE CENTERED IN TILE AND FINISHED TO MATCH ADJACENT FINISHES (TYP.).
- F. PAINT ALL EXPOSED PRODUCTS, HVAC DIFFUSERS, SHIM RINGS, PIPING, CONDUIT AND JUNCTION BOXES THE SAME COLOR AS SPECIFIED ON SURROUNDING CEILING OR SOFFIT UNLESS OTHERWISE NOTED, TYPICAL THROUGHOUT RETAIL AREA OF STORE.
- G. PAINT SUBSTITUTIONS ARE NOT ALLOWED. USE STARBUCKS' NATIONAL ACCOUNT "COLOR CODE" WHEN ORDERING PAINTS.



STARBUCKS COFFEE COMPANY
 2401 UTAH AVENUE SOUTH
 SEATTLE, WASHINGTON 98134
 (206) 318-1575

THESE DRAWINGS AND SPECIFICATIONS ARE CONFIDENTIAL AND SHALL REMAIN THE SOLE PROPERTY OF STARBUCKS CORPORATION, WHICH IS THE OWNER OF THE COPYRIGHT IN THIS WORK. THEY SHALL NOT BE REPRODUCED IN WHOLE OR IN PART, SHARED WITH THIRD PARTIES OR USED IN ANY MANNER ON OTHER PROJECTS OR EXTENSIONS TO THIS PROJECT WITHOUT THE PRIOR WRITTEN CONSENT OF STARBUCKS CORPORATION. THESE DRAWINGS AND SPECIFICATIONS ARE INTENDED TO EXPRESS DESIGN INTENT FOR A PROTOTYPICAL STARBUCKS STORE (WHICH IS SUBJECT TO CHANGE AT ANYTIME) AND DO NOT REFLECT ACTUAL SITE CONDITIONS. NEITHER PARTY SHALL HAVE ANY OBLIGATION NOR LIABILITY TO THE OTHER (EXCEPT AS STATED ABOVE) UNTIL A WRITTEN AGREEMENT IS FULLY EXECUTED BY BOTH PARTIES.

STARBUCKS TEMPLATE VERSION | 2018.10.16

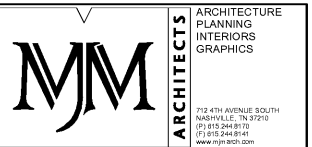

PROJECT NAME:
CUSICK & ALCOA

PROJECT ADDRESS:
121 CUSICK ROAD
ALCOA, TN 37701
BLOUNT COUNTY

STORE #:	11293
PROJECT #:	36099-035
ISSUE DATE:	04.26.19
DESIGN MANAGER:	L. MACEDA
LEED® AP:	N/A
PRODUCTION DESIGNER:	C. POBST
CHECKED BY:	MJM

REVISION SCHEDULE			
REV	DATE	BY	DESCRIPTION

SHEET TITLE:
REFLECTED CEILING PLAN
 SCALE: AS SHOWN

SHEET NUMBER:
1103

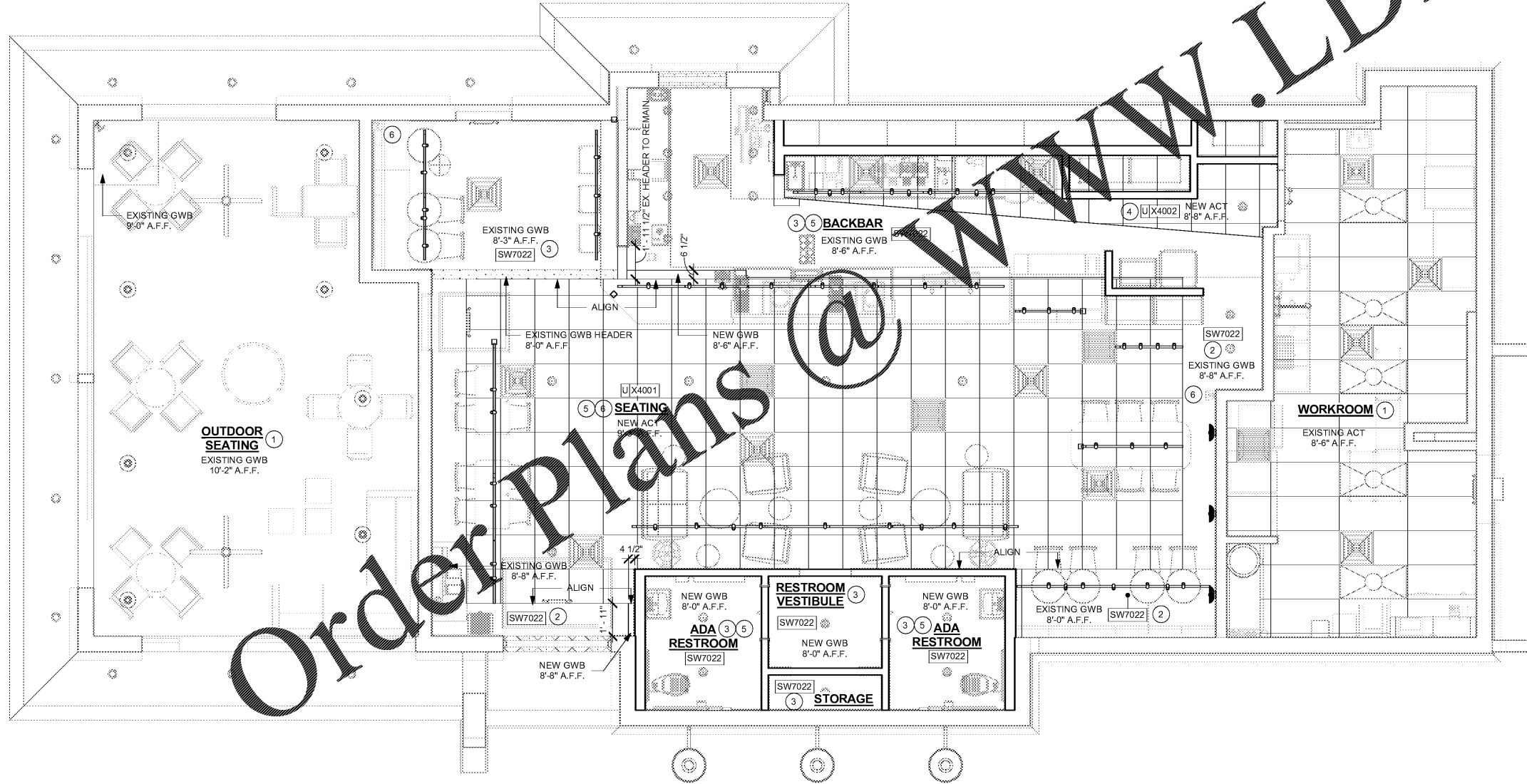

1 REFLECTED CEILING PLAN
 Scale: 1/4" = 1'-0"

