



**STARBUCKS COFFEE COMPANY**  
2401 UTAH AVENUE SOUTH  
SEATTLE, WASHINGTON 98134  
(206) 318-1575

THESE DRAWINGS AND SPECIFICATIONS ARE CONFIDENTIAL AND SHALL REMAIN THE SOLE PROPERTY OF STARBUCKS CORPORATION, WHICH IS THE OWNER OF THE COPYRIGHT IN THIS WORK. THEY SHALL NOT BE REPRODUCED IN WHOLE OR IN PART, SHARED WITH THIRD PARTIES OR USED IN ANY MANNER ON OTHER PROJECTS OR EXTENSIONS TO THIS PROJECT WITHOUT THE PRIOR WRITTEN CONSENT OF STARBUCKS CORPORATION. THESE DRAWINGS AND SPECIFICATIONS ARE INTENDED TO EXPRESS DESIGN INTENT FOR A PROTOTYPICAL STARBUCKS STORE (WHICH IS SUBJECT TO CHANGE AT ANYTIME) AND DO NOT REFLECT ACTUAL SITE CONDITIONS. NEITHER PARTY SHALL HAVE ANY OBLIGATION NOR LIABILITY TO THE OTHER (EXCEPT AS STATED ABOVE) UNTIL A WRITTEN AGREEMENT IS FULLY EXECUTED BY BOTH PARTIES.

STARBUCKS TEMPLATE VERSION: 2018.10.16

**MJM ARCHITECTS**  
ARCHITECTURE  
PLANNING  
INTERIORS  
GRAPHICS

112 4TH AVENUE SOUTH  
NASHVILLE, TN 37203  
615.254.8175  
615.254.8141  
www.mjm-arch.com



PROJECT NAME:  
**CUSICK & ALCOA**

PROJECT ADDRESS:  
121 CUSICK ROAD  
ALCOA, TN 37701  
BLOUNT COUNTY

STORE #: 11293  
PROJECT #: 36099-035

ISSUE DATE: 04.26.19  
DESIGN MANAGER: L. MACEDA  
LEED AP: N/A  
PRODUCTION DESIGNER: C. POBST  
CHECKED BY: MJM

REVISION SCHEDULE			
REV	DATE	BY	DESCRIPTION

SHEET TITLE:  
**BUILDING FLOOR PENETRATION PLAN**  
SCALE: AS SHOWN

SHEET NUMBER:  
**A102**

**KEYED NOTES**

- EXISTING TO REMAIN (ETR).
- IN-SLAB TRENCHING (OUTLINE SHOWN FOR REFERENCE ONLY). GC SHALL COORDINATE FINAL LOCATION OF TRENCHING BASED ON SITE SPECIFIC CONDITIONS.
- ELECTRICAL STUB-UP LOCATION. SEE SHEET E101.
- PLUMBING STUB-UP LOCATION. SEE SHEET P101.
- FLOOR SINK LOCATION. SEE SHEET P101.
- FLOOR DRAIN LOCATION. SEE SHEET E101.
- FLOOR ELECTRICAL OUTLET. SEE SHEET E101.

**GENERAL NOTES**

- ALL STUB-UP DIMENSIONS ARE RELATIVE TO FINISHED WALL LOCATIONS (SHOWN AS OUTLINES ON THIS PLAN). REFER TO FLOOR PLAN FOR WALL PLACEMENT.
- FLOOR SINK: REFER TO CUT SHEETS FOR COMPONENT SPECIFICATIONS AND CUTOUT REQUIREMENTS.
- WASTE LINE PENETRATIONS: REFER TO PLUMBING PLANS FOR INDIVIDUAL LINE LOCATIONS.
- STUB-UP PENETRATIONS: REFER TO ELECTRICAL AND PLUMBING PLANS FOR INDIVIDUAL STUB-UP LOCATIONS.
- TOILET FLOOR PENETRATION: REFER TO CUT SHEETS FOR STUB-UP LOCATION RELATIVE TO FINISHED WALL.
- PENETRATION TO BE LOCATED ON CENTERLINE OF WALL OR AS REQUIRED PER CONDITIONS.
- TRENCHING OUTLINE FOR GUIDELINE USE ONLY. GENERAL CONTRACTOR TO COORDINATE WITH SPECIFIC TRADES AND SITE CONDITIONS TO DETERMINE ACTUAL LAYOUT.
- REFER TO SHEET P101 FOR FLOOR FINISHES.

**LEGEND**

- EXISTING WALL
- CONCRETE LEAVE-OUT
- DATUM POINT

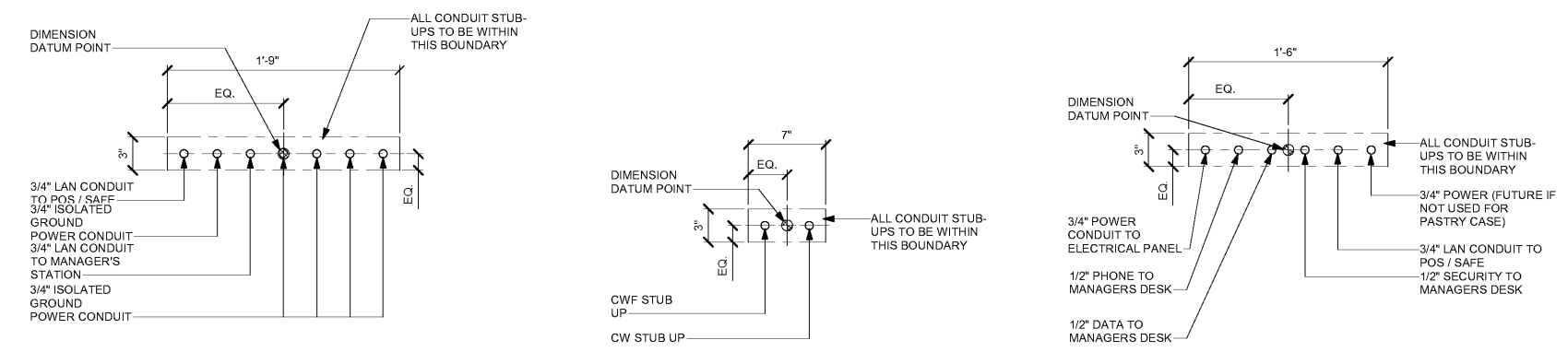

**2 ESPRESSO BAR STUB-UPS** 1-1/2" = 1'-0" PLAN  
**3 ESPRESSO BAR STUB-UPS** 1-1/2" = 1'-0" PLAN  
**4 POS STUB-UPS** 1-1/2" = 1'-0" PLAN

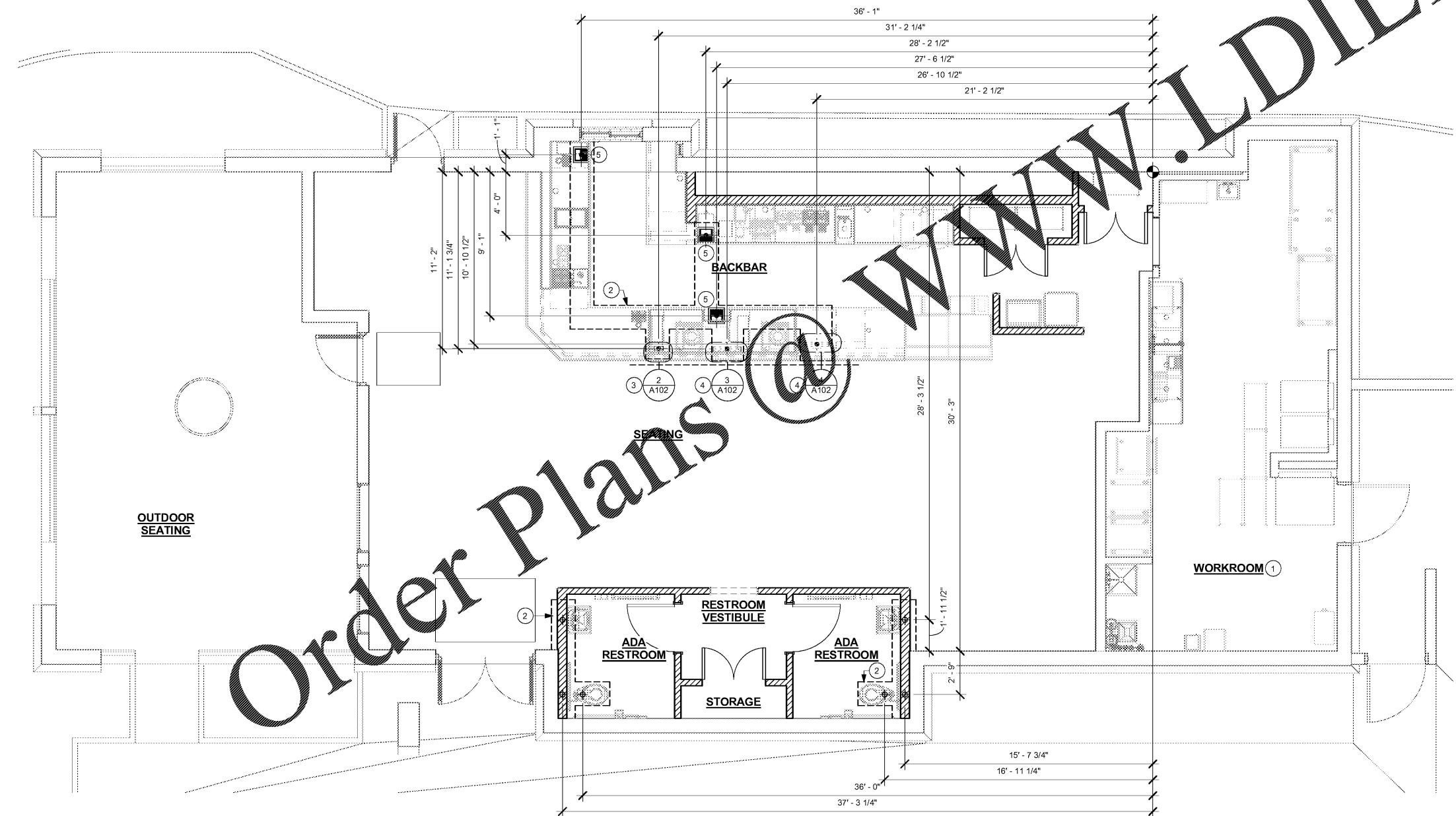

**1 FLOOR PENETRATION PLAN**  
Scale: 1/4" = 1'-0"

4/25/2019 2:41:41 PM Z:\proj\csm\starbucks\coffee\company\alcoa\tn\reno-cusick & alcoa\Drawings\11293\_TN\_Cusick & Alcoa\_Revit Model.rvt

MJM PROJECT