

WALL CONSTRUCTION SCHEDULE	
WALL LABELING KEY: INTERIOR SHEATHING	
WALL STUD	
INTERIOR MODIFIER	
WALL STUD	
1a	1 1/2" 20 GA FURRING (FULL HEIGHT)
1b	1 1/2" 20 GA FURRING (TERMINATE 6" ABOVE CEILING)
4a	3 5/8" 20 GA STUDS AT 16" O.C. (FULL HEIGHT)
4b	3 5/8" 20 GA STUDS AT 16" O.C. (TERMINATE 6" ABOVE CEILING). PROVIDE 45 DEGREE METAL STUD BRACING AT 48" O.C. FROM TOP OF STUD WALL TO STRUCTURE ABOVE.
6a	6" 20 GA STUDS AT 16" O.C. (FULL HEIGHT)
6b	6" 20 GA STUDS AT 16" O.C. (TERMINATE 6" ABOVE CEILING). PROVIDE 45 DEGREE METAL STUD BRACING AT 48" O.C. FROM STUD WALL TO STRUCTURE ABOVE.
INTERIOR SHEATHING	
A	5/8" GYP. WALL BOARD (FULL HEIGHT)
B	5/8" GYP. WALL BOARD (TERMINATE 6" ABOVE CEILING)
C	5/8" CEMENTITIOUS BACKER BOARD (FULL HEIGHT)
D	5/8" CEMENTITIOUS BACKER BOARD (TERMINATE 6" ABOVE CEILING)
E	5/8" CEMENTITIOUS BACKER BOARD TO 48" A.F.F. W/ GYP WALL BOARD ABOVE
F	5/8" PLYWOOD (TERMINATE 6" ABOVE CEILING)
G	(1) LAYER WATER RESISTANT GYP. BOARD
INTERIOR MODIFIERS	
ai	ACOUSTIC INSULATION (FULL HEIGHT)
ti	THERMAL INSULATION (FULL HEIGHT)
93	PARTIAL HEIGHT WALL. 16 GA METAL STUDS AT 16" O.C. W/ RCKW RIGID CONNECTORS AT FLOOR. (MODIFIER = HEIGHT IN INCHES A.F.F.)

WALL BLOCKING KEY

ITEM	WEIGHT	HEIGHT AFF	APPOX. WIDTH	BLOCKING TYPE
A RESTROOM GRAB BARS	200 LBS	2'-6" TO 3'-0"	5'-0" AROUND TOILET	
B RESTROOM HAND SINK	200 LBS	3'-0" TO 3'-4"	2'-6" BEHIND SINK	
C DIAPER CHANGING STATION	300 LBS	2'-3" TO 5'-3"	3'-0" BEHIND TABLE	
D RESTROOM VERTICAL GRAB BAR	200 LBS	3'-3" TO 4'-10"	2'-0" BEHIND GRAB BAR	
E RESTROOM HAND DRYER	200 LBS	3'-0" TO 4'-0"	2'-0" CENTERED BEHIND HAND DRYER	
F DT COMMUNICATIONS	100 LBS	4'-10" TO 9'-1"	3'-0" BEHIND DT POS EQUIP/SHELVING	3/4" FRT PLYWOOD
G SHELVING AT CBE STATION	50 LBS	CENTERED	EXTENTS OF SHELVING	2X10 FRT WOOD STUD
H WOOD WALL CLADDING	300 LBS	EXTENTS OF CLADDING	EXTENTS OF CLADDING	
J ARTWORK	100 LBS	EXTENTS OF ARTWORK	EXTENTS OF ARTWORK	
K COMMUNITY BOARD	100 LBS	SEE ELEVATIONS	SEE PLAN AND ELEVATIONS	
L MENU BOARDS	100 LBS	C.L. OF MENUS	4" BEYOND MENUS (ALL SIDES)	3/4" FRT PLYWOOD
M MERCH BAYS	NONE	T.O. MERCH BAY	32" LONG	1X6 FRT WOOD STUD
N BANQUETTE - CLOSTER	NONE	6" TO 2'-6 1/2"	5'-4" CENTERED ON BANQUETTE	3/4" FRT PLYWOOD

NOTE: PROVIDE 2X6 OR 2X8 FRT WOOD STUD BLOCKING U.O.N. TO SUPPORT ANY WALL ATTACHMENTS.

INTERIOR DOOR SCHEDULE - "D"					
DESIGN ID	COUNT	DESCRIPTION	FURN. BY	INST. BY	COMMENTS
DOOR					
10190	2	DOOR - SINGLE FLUSH - 36IN - TYPE E	GC	GC	DOOR HARDWARE: #6. FRAME FINISH: SW7048. PANEL FINISH: WD0077.
X2001	2	CUSTOM DOUBLE DOORS - 68" X 80" - TYPE F	GC	GC	DOOR HARDWARE: #9. FRAME FINISH: SW7048. PANEL FINISH: WD0077.
X2002	1	CUSTOM DOUBLE DOORS - 68" X 80" - TYPE F	GC	GC	DOOR HARDWARE: #8. FRAME FINISH: SW7048. PANEL FINISH: WD0077.

DOOR HARDWARE SET NO. 6 - For restroom door with lever and privacy lock				
Item	Description	Manufacturer	Finish	
3	Hanging Devices	TA2714/MPB79	McKinney	626
1	Securing Devices	PB5425LN Lock, Shallow Coin Turn, Privacy PB5425LN-693-497 1-3/4	Yale Lock	626
1	Closing Devices	8916 Door Closer 8916 AF89P	Dorma	689
2	Protective Trim Units	K1050 B4E Kickplate 10" x 34" each side	Rockwood	630
3	Accessories	GJ64 Rubber Silencer	Glynn Johnson Gray	
1	Stops and Holders	473 Door Stop w/ Hook	Rockwood	626

DOOR HARDWARE SET NO. 8 - For utility/closet door with lever and keypad lock				
Item	Description	Manufacturer	Finish	
3	Hanging Devices	TA2714/MPB79	McKinney	626
1	Securing Devices	B-PB5405LNIC Lever Storeroom LC B-PB5405LN-693-497 1-3/4	Yale Lock	626
1	Securing Devices	C607 7-Pin Core Combined "A" Keyway	Falcon Lock	626
1	Closing Devices	8916 Door Closer 8916 AF89P	Dorma	689
1	Protective Trim Units	K1050 B4E Kickplate 10" x 34"	Rockwood	630
3	Accessories	GJ64 Rubber Silencer	Glynn Johnson Gray	
1	Stops and Holders	473 Door Stop w/ Hook	Rockwood	626

DOOR HARDWARE SET NO. 9 - For utility/closet door with lever passage and no lock				
Item	Description	Manufacturer	Finish	
3	Hanging Devices	TA2714/MPB79	McKinney	626
1	Securing Devices	PB5401LN Lever Passage PB5401LN-693-497...	Yale Lock	626
1	Closing Devices	8916 Door Closer 8916 AF89P	Dorma	689
1	Protective Trim Units	K1050 B4E Kickplate 10" x 34"	Rockwood	630
3	Accessories	GJ64 Rubber Silencer	Glynn Johnson Gray	
1	Stops and Holders	473 Door Stop w/ Hook	Rockwood	626

GENERAL NOTES

- GENERAL CONTRACTOR TO VERIFY ALL DIMENSIONS AND NOTIFY STARBUCKS CONSTRUCTION MANAGER OF ANY DISCREPANCIES PRIOR TO CONSTRUCTION. ALL DIMENSIONS TO BE TAKEN FROM DESIGNATED DATUM POINT.
- GENERAL CONTRACTOR TO PROVIDE FIRE TREATED WOOD STUD BLOCKING, OR EQUIVALENT TO SUPPORT ANY WALL ATTACHMENT AND/OR SIGNAGE.
- IF EXISTING EXTERIOR ENTRANCE THRESHOLD EXCEEDS MINIMUM BARRIER FREE PROVISION OF THE CODE, REMOVE AND REPLACE WITH ACCESSIBLE THRESHOLD. RAISED THRESHOLDS AND FLOOR LEVEL CHANGES AT ACCESSIBLE DOORWAYS TO BE BEVELLED WITH A SLOPE NO GREATER THAN 1:12.
- ALL DIMENSIONS ARE TO FINISHED FACE UNLESS SHOWN OR NOTED OTHERWISE.
- INSTALL MOISTURE RESISTANT GYP. BOARD ON BACKBAR WALL PER PROJECT MANUAL.
- ALL DOORS SHALL BE 20 (800MM) MINIMUM CLEAR OPENING WHEN OPENED TO THE GREEN POSITION UNLESS OTHERWISE NOTED.
- STARBUCKS VENDOR TO PROVIDE DOOR HARDWARE COMMENTS AND GUIDANCE INSTALL.
- VERIFY ALL EXISTING DOORS, HARDWARE AND FRAMES MEET STARBUCKS AND/OR CODE REQUIREMENTS.
- EGRESS SHALL NOT PASS THROUGH KITCHENS, STORAGE ROOMS, CLOSETS, OR SIMILAR SPACES.
- PROVIDE FIRE EXTINGUISHERS AS NOTED ON THE APPROVED PLANS FROM THE CITY.
- SEE STRUCTURAL FOR KNEE WALL BRACING.
- SEE SHEET A501 FOR BUILDING DETAILS.
- REFER TO SHEET I104 FOR FLOOR FINISHES.

KEYED NOTES

- EXISTING TO REMAIN (ETR).
- INSTALL NEW DOORS AS INDICATED. SEE SHEET A601 FOR DOOR AND HARDWARE TYPE.
- ELECTRICAL PANEL LOCATIONS. MAINTAIN MINIMUM CLEARANCE AS REQUIRED BY CODE.

LEGEND

- NEW FULL HEIGHT WALL
- EXISTING WALL
- WALL BLOCKING CALL OUT

INTERIOR DOOR LEGEND

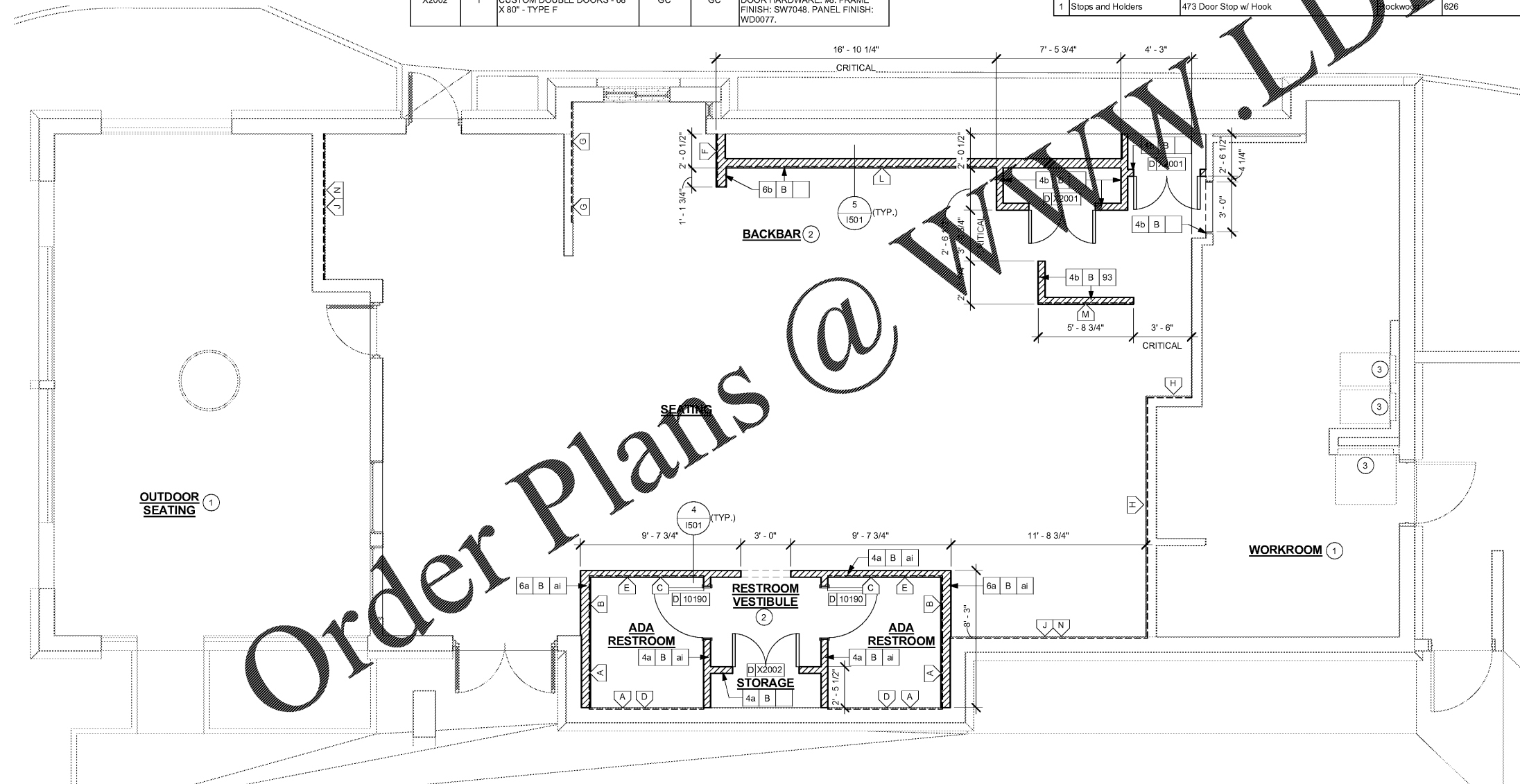
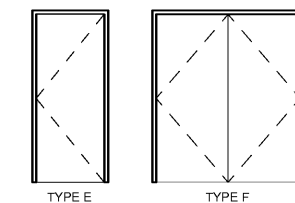

1 FLOOR PLAN

Scale: 1/4" = 1'-0"



STARBUCKS COFFEE COMPANY
2401 UTAH AVENUE SOUTH
SEATTLE, WASHINGTON 98134
(206) 318-1575

THESE DRAWINGS AND SPECIFICATIONS ARE CONFIDENTIAL AND SHALL REMAIN THE SOLE PROPERTY OF STARBUCKS CORPORATION, WHICH IS THE OWNER OF THE COPYRIGHT IN THIS WORK. THEY SHALL NOT BE REPRODUCED IN WHOLE OR IN PART, SHARED WITH THIRD PARTIES OR USED IN ANY MANNER ON OTHER PROJECTS OR EXTENSIONS TO THIS PROJECT WITHOUT THE PRIOR WRITTEN CONSENT OF STARBUCKS CORPORATION. THESE DRAWINGS AND SPECIFICATIONS ARE INTENDED TO EXPRESS DESIGN INTENT FOR A PROTOTYPICAL STARBUCKS STORE (WHICH IS SUBJECT TO CHANGE AT ANY TIME) AND DO NOT REFLECT ACTUAL SITE CONDITIONS. NEITHER PARTY SHALL HAVE ANY OBLIGATION NOR LIABILITY TO THE OTHER (EXCEPT AS STATED ABOVE) UNTIL A WRITTEN AGREEMENT IS FULLY EXECUTED BY BOTH PARTIES.

STARBUCKS TEMPLATE VERSION: 12018.10.16

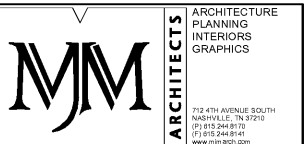

PROJECT NAME:
CUSICK & ALCOA

PROJECT ADDRESS:
**121 CUSICK ROAD
ALCOA, TN 37701
BLOUNT COUNTY**

STORE #:	11293
PROJECT #:	36099-035
ISSUE DATE:	04.26.19
DESIGN MANAGER:	L. MACEDA
LEED AP:	N/A
PRODUCTION DESIGNER:	C. POBST
CHECKED BY:	MJM

REVISION SCHEDULE			
REV	DATE	BY	DESCRIPTION

SHEET TITLE:
BUILDING FLOOR PLAN

SCALE: AS SHOWN

SHEET NUMBER:

A101