

T:\2019\19431_Hampton Inn_Ashland City TN\19431 E201 - E208.dwg, 5/31/2019 9:42:45 AM, hrcj

Order Plans @ www.djline.com

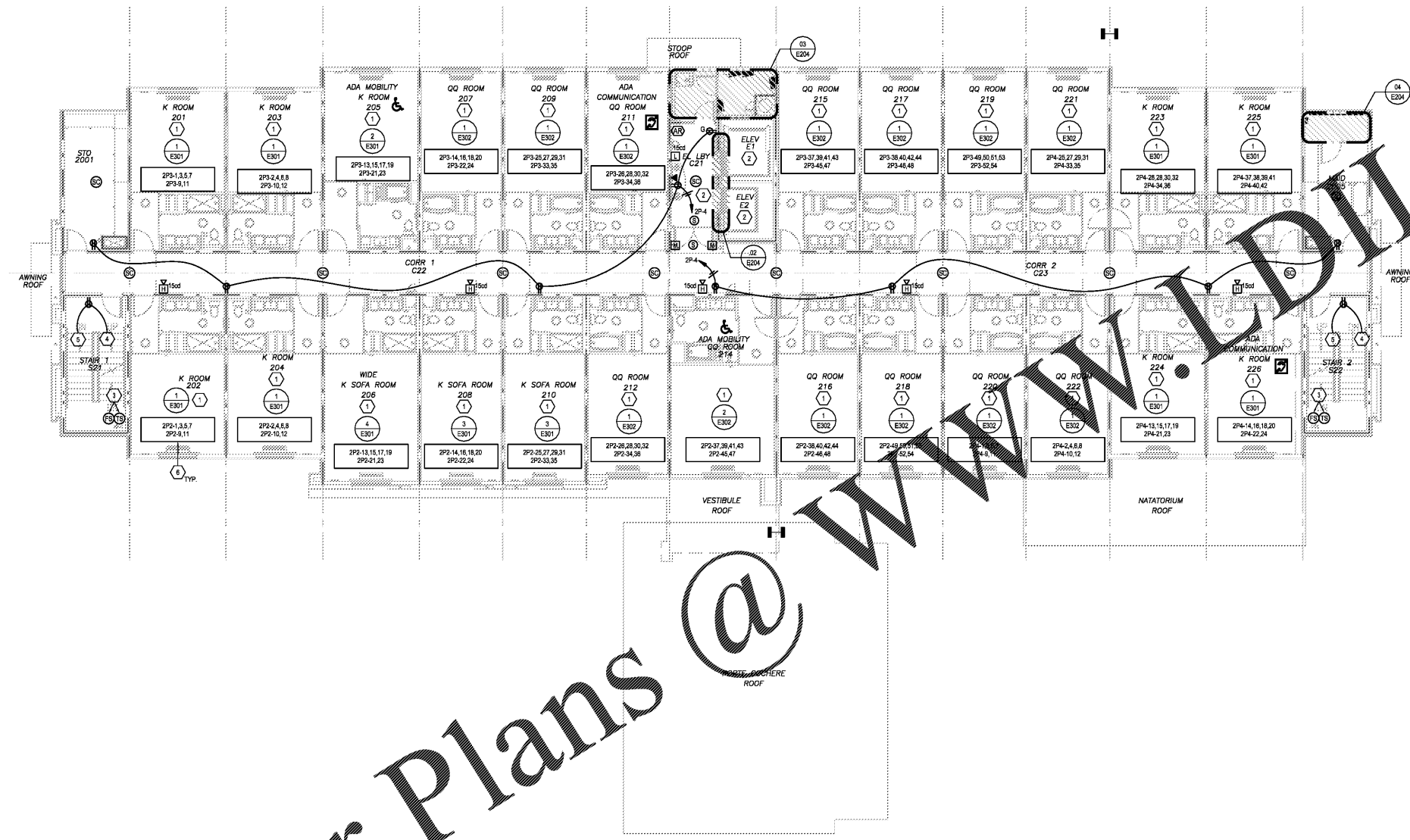

FIRE/SMOKE DAMPERS

1. THE CONTRACTOR IS TO FIELD COORDINATE THE LOCATION OF ALL FIRE/SMOKE DAMPERS WITH THE MECHANICAL CONTRACTOR PRIOR TO DOING ANY WORK. PROVIDE A 120V POWER CONNECTION & FIRE ALARM CONNECTION AT EACH DAMPER. WIRE ON CIRCUITS AS FOLLOWS:

1ST FLOOR: P-7 - APPROX. 21 DAMPERS
 2ND FLOOR: 2P-10 - APPROX. 16 DAMPERS
 3RD FLOOR: 3P-11 - APPROX. 16 DAMPERS
 4TH FLOOR: 4P-10 - APPROX. 18 DAMPERS

WIRELESS ACCESS POINTS

1. THE CONTRACTOR IS TO FIELD COORDINATE THE LOCATION OF ALL WIRELESS ACCESS POINTS WITH THE OWNER PRIOR TO DOING ANY WORK. PROVIDE A 120V POWER CONNECTION & DATA CONNECTION AT EACH LOCATION. WIRE ON CIRCUITS AS FOLLOWS:

1ST FLOOR: P-9
 2ND FLOOR: 2P-12
 3RD FLOOR: 3P-12
 4TH FLOOR: 4P-12

GENERAL PLAN NOTES

1. ALL DIMENSIONS TO FACE UNLESS NOTED OTHERWISE.
 2. ANY EXPOSED CONDUIT FOR POWER & LIGHTING SHALL RUN TIGHT TO CORNERS AND HUG STAIRWAYS AS TO BE VISUALLY MINIMIZED.

ELECTRICAL KEYED NOTES

1 REFER TO SHEETS E301 & E302 FOR GUESTROOM LARGE SCALE ELECTRICAL PLANS.
 2 SEE ELEVATOR FIRE ALARM RISER ON E302 FOR DEVICES REQUIRED IN THIS AREA.
 3 PROVIDE TAMPER AND FLOW SWITCHES AT FLOOR SHUT OFF VALVES AT SPRINKLER STAND PIPE. FIELD VERIFY LOCATION OF VALVES WITH SPRINKLER CONTRACTOR.
 4 RUN CIRCUIT UP FROM RECEPTACLE AT FIRST FLOOR LEVEL. SEE SHEET E201.
 5 RUN CIRCUIT UP TO RECEPTACLE AT THIRD FLOOR LEVEL. SEE SHEET E203.
 6 THIS BOX REPRESENTS CIRCUITS TO BE USED FOR EACH GUESTROOM. SEE LARGE SCALE PLANS ON SHEETS E301 & E302.

1 HOUR FIRE RATED PARTITION
 2 HOUR FIRE RATED PARTITION

March Adams & Associates
 370 Danks Ave.
 Chattanooga, Tennessee 37404
 P: (423) 698-4675
 F: (423) 698-4675

**HAMPTON INN
 NEW HOTEL**
 ASHLAND CITY, TENNESSEE
 WWW.DAVIDRCARTER.NET
DAVID R. CARTER AND ASSOCIATES



ISSUE DATE 05-30-19
 REVISION LOG

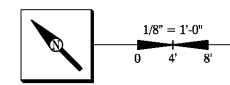

LEVEL 2 POWER PLAN E202