

02 | DUMPSTER ENCLOSURE / STORAGE

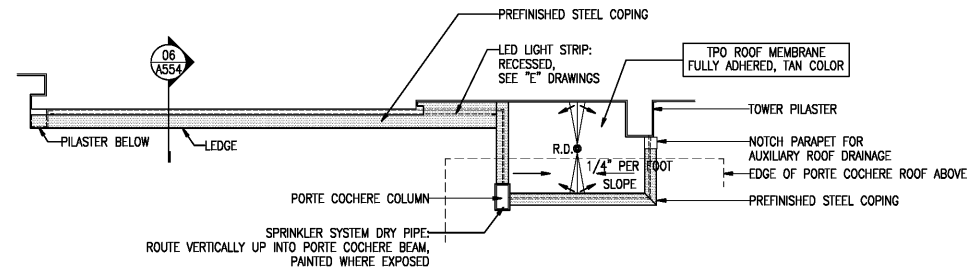

03 | VESTIBULE ROOF UNDER PORTE COCHERE

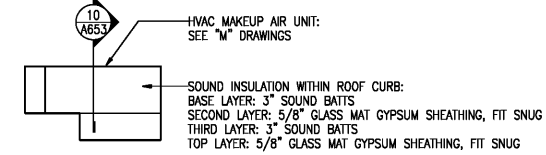

04 | RTU SOUND INSULATION

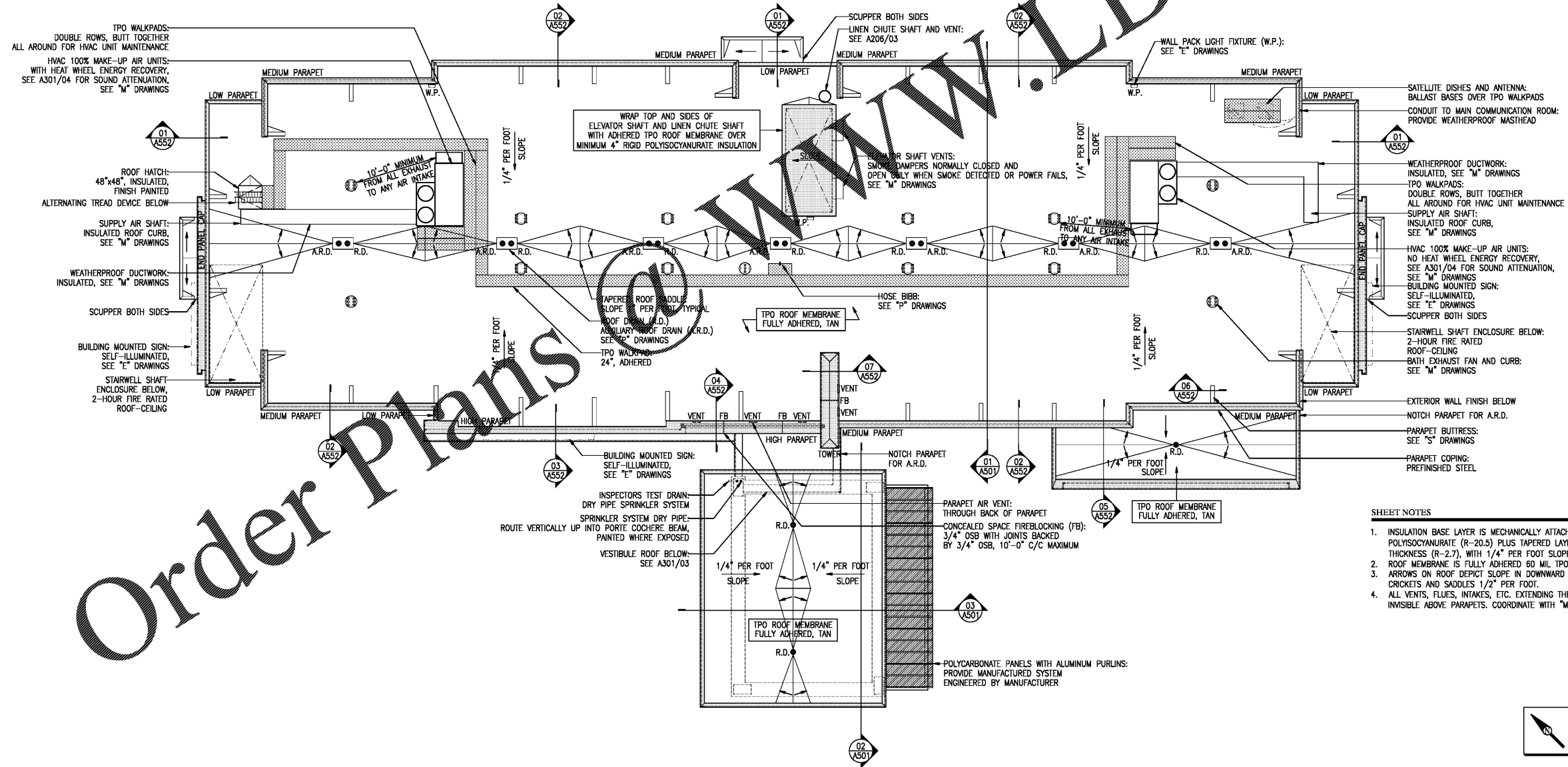

- SHEET NOTES**
- INSULATION BASE LAYER IS MECHANICALLY ATTACHED 3.5" POLYISOCYANURATE (R-20.5) PLUS TAPERED LAYER, 1/2" MINIMUM THICKNESS (R-2.7), WITH 1/4" PER FOOT SLOPE. SEE DETAIL A602/26.
 - ROOF MEMBRANE IS FULLY ADHERED 60 MIL TPO, TAN COLOR.
 - ARROWS ON ROOF DEPICT SLOPE IN DOWNWARD DIRECTION. SLOPE ALL CRICKETS AND SADDLES 1/2" PER FOOT.
 - ALL VENTS, FLUES, INTAKES, ETC. EXTENDING THROUGH ROOF, SHALL BE INVISIBLE ABOVE PARAPETS. COORDINATE WITH "M" AND "P" DRAWINGS.

HAMPTON INN
NEW HOTEL
ASHLAND CITY, TENNESSEE
WWW.DAVIDRCARTER.NET
DAVID R. CARTER AND ASSOCIATES



ISSUE DATE 05-30-19
REVISION LOG

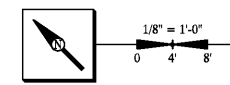

PROJECT 00755

ROOF PLAN A301

30 x 42

01 | MAIN BUILDING / PORTE COCHERE