

01 | BREAKFAST AREA

02 | UPPER FLOOR ELEVATOR AREA

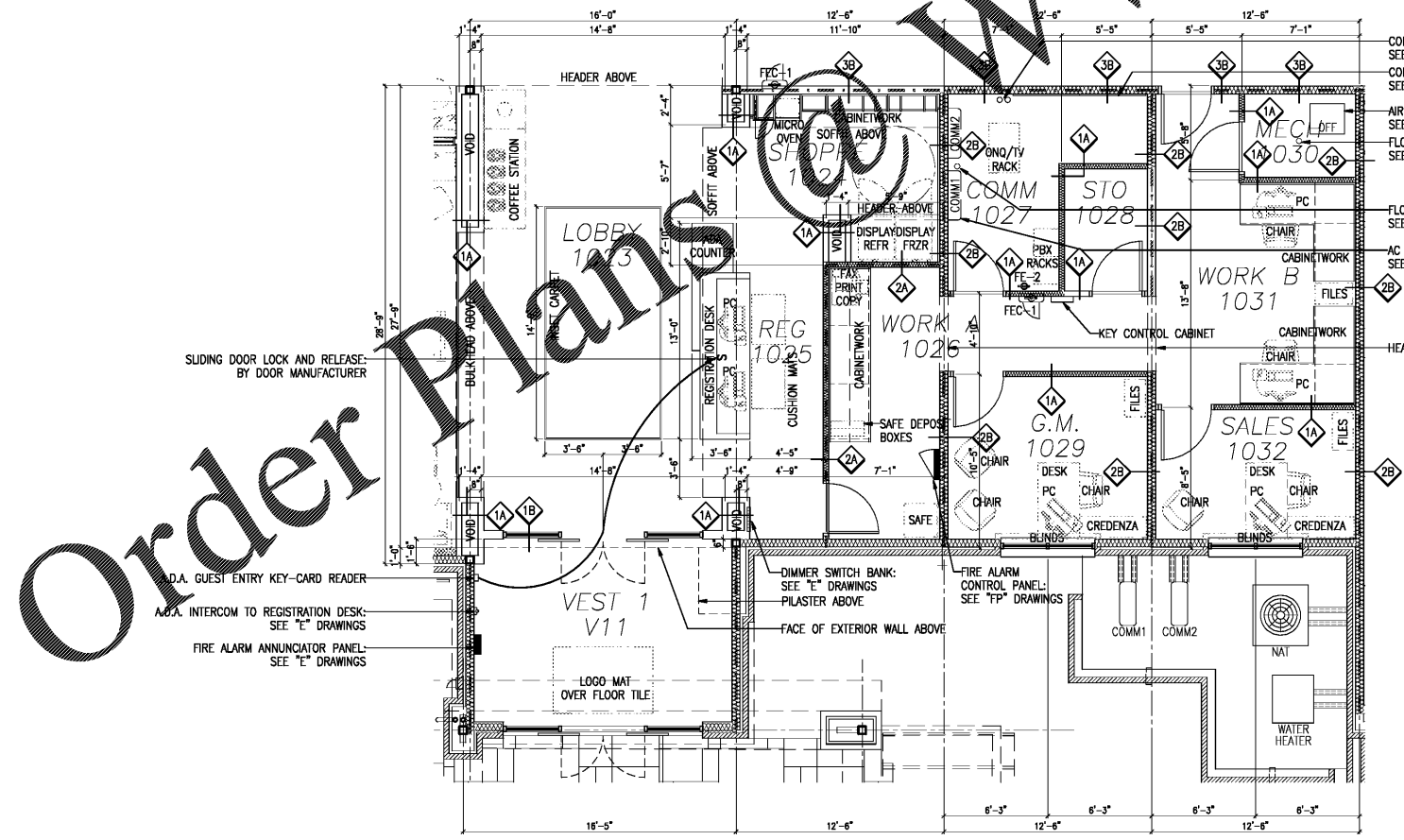

- CONDUITS FOR COMMUNICATIONS WIRES: SEE "E" DRAWINGS
- COMMUNICATIONS BACKBOARD: SEE "E" DRAWINGS
- AIR HANDLER UNIT: SEE "M" DRAWINGS
- FLOOR DRAIN FOR CONDENSATE: SEE "P" DRAWINGS
- FLOOR DRAIN FOR CONDENSATE: SEE "P" DRAWINGS
- AC AIR HANDLER UNITS: SEE "M" DRAWINGS
- HEADER ABOVE

- FIRE RESISTANCE RATED CONSTRUCTION**
- 1-HOUR FIRE-RATED ASSEMBLY
 - A. FIRE BARRIERS: SEE A603/07
 - B. FIRE PARTITIONS: SEE A603/06
 - C. STRUCTURAL PROTECTION
 - 2-HOUR FIRE-RATED ASSEMBLY
 - A. FIRE BARRIERS
- FOR ENTIRE SCHEDULE, SEE SHEET A101

- SHEET NOTES**
1. FOR ITEMS LOCATED ON EXTERIOR OF BUILDING, SEE SHEET A101-103 AND A131-133.
 2. FOR INTERIOR ELEVATION TAGS, SEE SHEET A131-133.
 3. FOR ASSEMBLY TYPE TAGS NOT SHOWN HERE, SEE SHEET A101-103.
 4. FOR FURNITURE, SEE "ID" DRAWINGS (BY OTHERS).

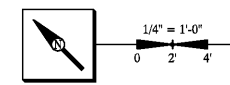

HAMPTON INN
NEW HOTEL
ASHLAND CITY, TENNESSEE
WWW.DAVIDRCARTER.NET
DAVID R. CARTER AND ASSOCIATES



ISSUE DATE 05-30-19
REVISION LOG

CORE AREA PLANS- ENLARGED A201

30 x 42

03 | LOBBY / OFFICE AREA