

02 DUMPSTER SCREEN / STORAGE

SOUND BATT INSULATION SCHEDULE

SOUND BATT LOCATIONS

- ALL CORRIDOR STUD WALLS
- ALL GUEST UNIT SEPARATION STUD WALLS
- ALL PUBLIC AND EMPLOYEE RESTROOM STUD WALLS
- ALL OFFICE STUD WALLS
- ALL MEETING ROOM STUD WALLS

WRAP ALL PVC SANITARY AND ROOF DRAIN PIPES ABOVE LOBBY, REGISTRATION, BREAKFAST AND MEETING AREA CEILINGS TO BE SOUND PROOF EQUAL TO CAST IRON

- GYPSON BOARD AND FIBERGLASS BATTS OF SOUND WALLS SHALL EXTEND FROM FLOOR TO STRUCTURAL DECK ABOVE ON ALL WALLS SURROUNDING ROOM OR SPACE. BATTS SHALL COMPLETELY FILL ALL CAVITIES.
- AT MEETING ROOM WALLS AND GUEST UNIT SEPARATION WALLS, SEAL ALL SOUND WALL PERIMETERS AND SOUND WALL PENETRATIONS INCLUDING ELECTRICAL DEVICE BACKBOXES WITH ACOUSTICAL SEALANT TO BE SOUND TIGHT.

TYPICAL WALL ASSEMBLY SCHEDULE

TYPE	TYPICAL LOCATION
1A	TYPICAL INTERIOR STUD WALLS, NOT-FIRE-RATED
2A	TYPICAL INTERIOR STUD WALLS, ONE-HOUR FIRE-RATED
3B	TYPICAL CORRIDOR STUD WALLS, ONE-HOUR FIRE-AND-SOUND-RATED
3B	TYPICAL GUEST UNIT SEPARATION STUD WALLS, ONE-HOUR FIRE-AND-SOUND-RATED

• FOR ASSEMBLY TYPE DETAILS, SEE SHEET A601-604.
• ALL FURR-DOWNS ARE STUDS AT 16" C/C WITH 5/8" GYPSUM BOARD ONE SIDE.

2012 IBC CODE NOTES

A. STRUCTURAL PROTECTION (2012 IBC SECTION 704)

- WHEN WALLS ARE FIRE PROTECTED ONLY FOR STRUCTURAL REASONS AND ARE NOT ALSO FIRE BARRIERS, FIRE PARTITIONS, SHAFT WALLS, FIRE WALLS OR OTHER SEPARATION ELEMENT, OPENINGS AND PENETRATIONS ARE NOT REQUIRED TO BE PROTECTED.

B. FIRE BARRIERS (2012 IBC SECTION 707)

- CONTINUITY: FIRE BARRIERS SHALL EXTEND FROM THE TOP OF THE FOUNDATION OR FLOOR/CEILING ASSEMBLY BELOW TO THE UNDERSIDE OF THE FLOOR OR ROOF SHEATHING, SLAB OR DECK ABOVE AND SHALL BE SECURELY ATTACHED THERETO. SUCH FIRE BARRIERS SHALL BE CONTINUOUS THROUGH CONCEALED SPACES, SUCH AS THE SPACE ABOVE SUSPENDED CEILINGS.
- SUPPORT, OPENINGS, PENETRATIONS, JOINTS AND DUCT OPENINGS SHALL COMPLY WITH IBC REQUIREMENTS.

C. FIRE PARTITIONS (2012 IBC SECTION 708)

- CONTINUITY: FIRE PARTITIONS SHALL EXTEND FROM THE TOP OF THE FOUNDATION OR FLOOR/CEILING ASSEMBLY BELOW TO THE UNDERSIDE OF THE FLOOR OR ROOF SHEATHING, SLAB OR DECK ABOVE OR TO THE FIRE-RESISTANCE-RATED FLOOR/CEILING OR ROOF/CEILING ASSEMBLY ABOVE, AND SHALL BE SECURELY ATTACHED THERETO. IF THE PARTITIONS ARE NOT CONTINUOUS TO THE SHEATHING, DECK OR SLAB, AND WHERE CONSTRUCTED OF COMBUSTIBLE CONSTRUCTION, THE SPACE BETWEEN THE CEILING AND THE SHEATHING, DECK OR SLAB ABOVE SHALL BE FIREBLOCKED OR DRAFTSTOPPED IN ACCORDANCE WITH THE IBC.
- SUPPORT, OPENINGS, PENETRATIONS, JOINTS AND DUCT OPENINGS SHALL COMPLY WITH IBC REQUIREMENTS.

FIRE RESISTANCE RATED CONSTRUCTION

SECTION	DESCRIPTION
0501.1.0001.1.0001	1-HOUR FIRE-RATED ASSEMBLY
A	FIRE BARRIERS: SEE A603/07
	• STORAGE ROOM OCCUPANCY SEPARATION
	• LAUNDRY ROOMS
	• LAUNDRY CHUTE ACCESS ROOMS
	• FIRE PUMP ROOM (SPRINKLER REDUCTION)
B	FIRE PARTITIONS: SEE A603/06
	• WALLS SEPARATING GUEST UNITS, UNLESS COINCIDING WITH A FIRE BARRIER
	• CORRIDOR WALLS, UNLESS COINCIDING WITH A FIRE BARRIER
C	STRUCTURAL PROTECTION:
	• PRIMARY STRUCTURAL FRAME
	• LOAD BEARING EXTERIOR WALLS
	• LOAD BEARING INTERIOR WALLS
	• FLOOR CONSTRUCTION
	• ROOF CONSTRUCTION
0501.1.0001.2.0001	2-HOUR FIRE-RATED ASSEMBLY
A	FIRE BARRIERS:
	• STAIR ENCLOSURE
	• EXISTING STAIR ENCLOSURE
	• LAUNDRY CHUTE TERMINATION ROOM
0501.1.0001.3.0001	1-HOUR FIRE-RATED ASSEMBLY NOT USED THIS PROJECT
0501.1.0001.4.0001	4-HOUR FIRE-RATED ASSEMBLY NOT USED THIS PROJECT

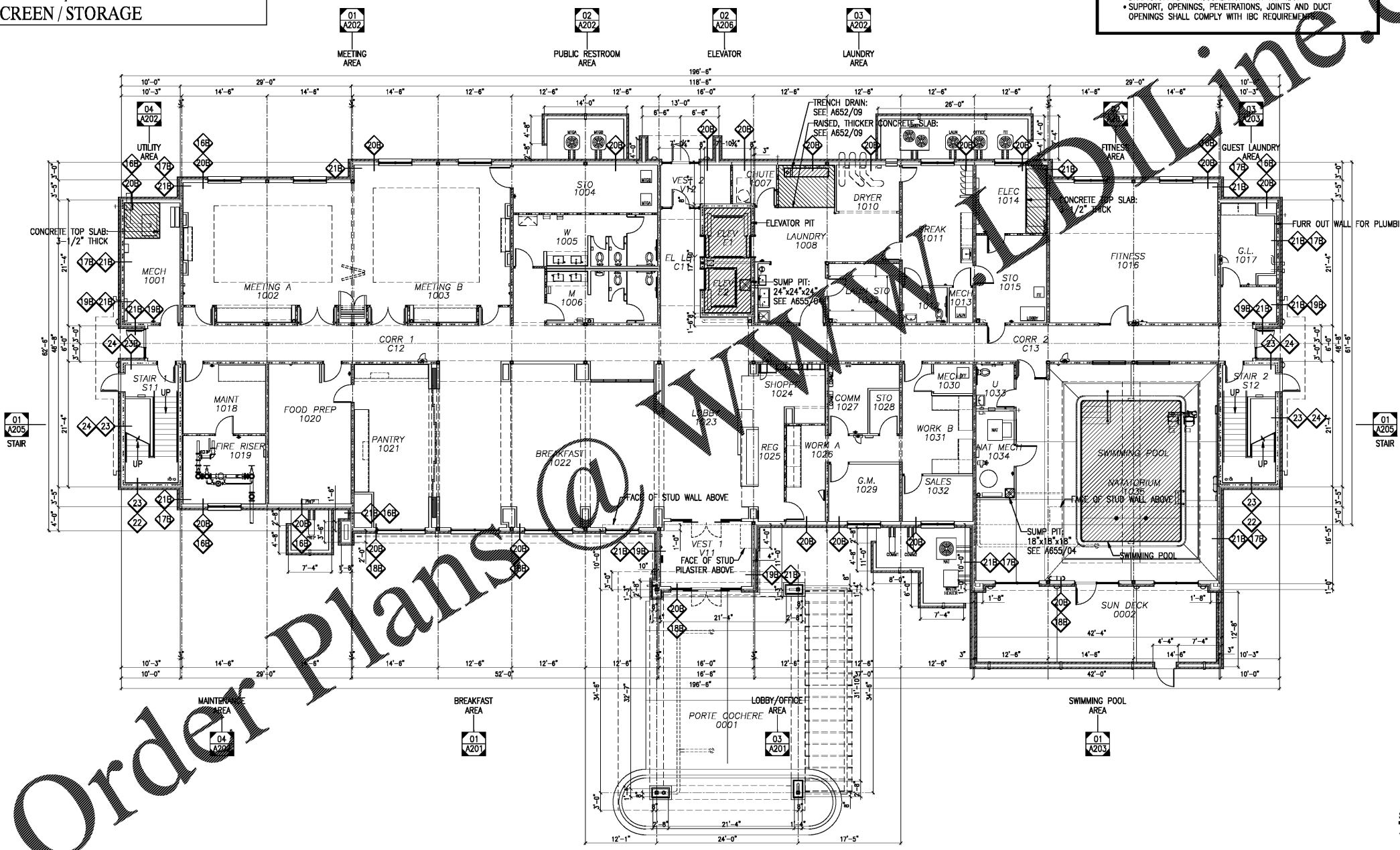

Order Plans @ www.davidrcarter.com

HAMPTON INN
NEW HOTEL
ASHLAND CITY, TENNESSEE
WWW.DAVIDRCARTER.NET
DAVID R. CARTER AND ASSOCIATES



SHEET NOTES

1. FOR ALL LOAD BEARING WALLS, SEE "S" DRAWINGS.

ISSUE DATE 05-30-19
REVISION LOG

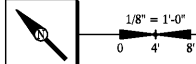

LEVEL 1 FLOOR PLAN- DIMENSIONED A101

30 x 42
01 LEVEL 1