

CONSTRUCTION PLANS FOR HAMPTON INN CHEATHAM CO., TENNESSEE

Order Plans @ www.ldilines.com

PERMIT SET - NOT FOR BIDDING OR CONSTRUCTION

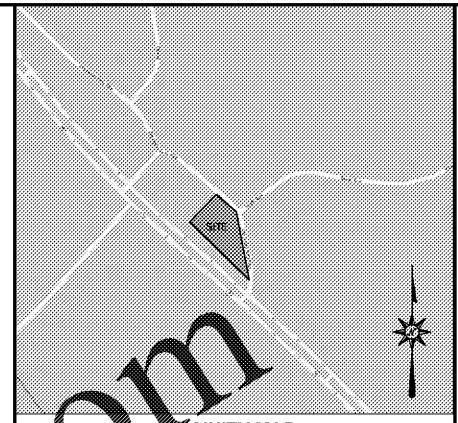

VICINITY MAP
(NOT TO SCALE)

DBS & Associates Engineering
 330 North 2nd Street
 P.O. Box 949
 Clarksville, TN 37041-0949
 P: (931) 647-6959 • F: (931) 647-7135
 visit us online: www.dbseng.com
 Engineers • Surveyors • Planners

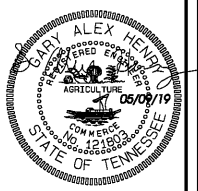

HAMPTON INN
TITLE
 TN HWY 12, ASHLAND CITY
 CHEATHAM COUNTY, TENNESSEE

NO.	ISSUED	DATE
1	PERMIT SET-TOEC	05/03/19
2	PERMIT SET-ASHLAND CITY	05/08/19

- INDEX OF SHEETS:**
 TITLE SHEET
 TOPOGRAPHIC SURVEY
 C 1.00 GENERAL SITE NOTES
 C 2.00 DEMOLITION PLAN
 C 3.00 SITE LAYOUT & SURFACE MATERIALS
 C 3.01 SITE LAYOUT & STAKING PLAN
 C 4.00 GRADING & DRAINAGE PLAN
 C 5.00 EROSION CONTROL PLAN PHASE I
 C 5.01 EROSION CONTROL PLAN PHASE II
 C 6.00 UTILITY LAYOUT
 C 7.00-7.08 GENERAL SITE DETAILS
 SEPTIC TANK INSTALLATION 1
 SEPTIC TANK INSTALLATION 2
 SEPTIC TANK INSTALLATION 3

THIS DRAWING IS THE PROPERTY OF DBS & ASSOCIATES ENGINEERING, INC. AND IS NOT TO BE REPRODUCED OR COPIED IN WHOLE OR IN PART WITHOUT AUTHORIZATION FROM DBS & ASSOCIATES ENGINEERING, INC. IT IS TO BE USED FOR THE PROJECT AND SITE SPECIFICALLY IDENTIFIED HEREIN AND IS NOT TO BE USED ON ANY OTHER PROJECT. IT IS TO BE RETURNED UPON REQUEST. DO NOT SCALE DRAWINGS. PRINT TO DIMENSIONS AND PROCEEDINGS. ALL DRAWINGS AND DESIGNS SHOWN ON THESE DRAWINGS ARE THE PROPERTY OF DBS & ASSOCIATES ENGINEERING, INC.

DRAWN BY: D. THARPE
 CHECKED BY: A. HENRY

TITLE	
PROJECT NO.	CC 66780
PROJECT DATE	11/02/18

© 1978 CC HAMPTON INN ASHLAND CITY TECHPROPLAN/HAMPTON INN ASHLAND CITY 05/08/19 05/08/19