

02 | DUMPSTER SCREEN / STORAGE

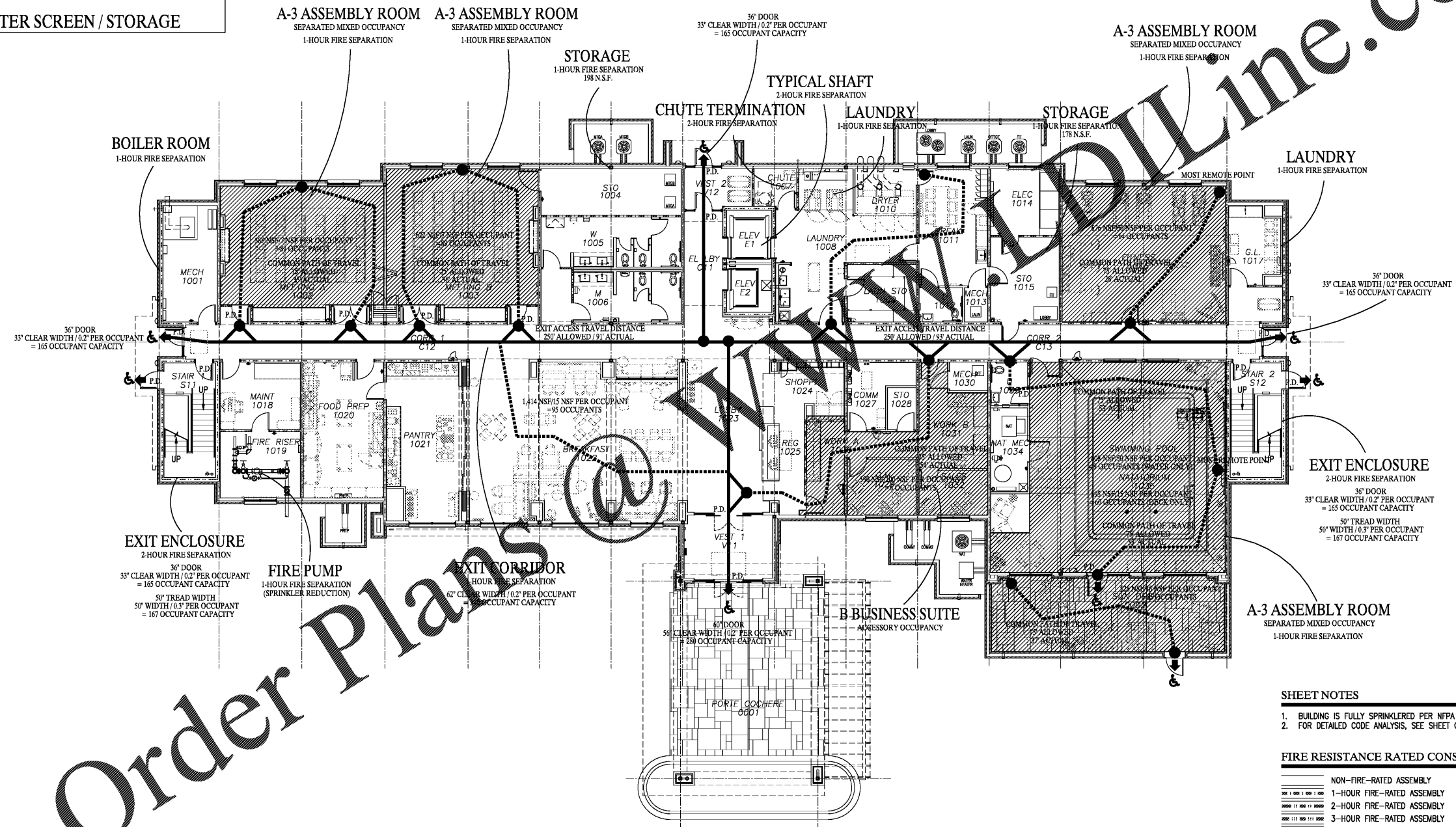

Order Plans @ [www.ArchLine.com](http://www.ArchLine.com)

www.ArchLine.com

HAMPTON INN  
 NEW HOTEL  
 ASHLAND CITY, TENNESSEE  
 WWW.DAVIDRCARTER.NET  
 DAVID R. CARTER AND ASSOCIATES

- SHEET NOTES**
- BUILDING IS FULLY SPRINKLERED PER NFPA 13R.
  - FOR DETAILED CODE ANALYSIS, SEE SHEET G101

**FIRE RESISTANCE RATED CONSTRUCTION**

---	NON-FIRE-RATED ASSEMBLY
----	1-HOUR FIRE-RATED ASSEMBLY
-----	2-HOUR FIRE-RATED ASSEMBLY
-----	3-HOUR FIRE-RATED ASSEMBLY
-----	4-HOUR FIRE-RATED ASSEMBLY
-----	SMOKE-TIGHT ASSEMBLY
.....	EXIT COMMON PATH OF TRAVEL
---	EXIT PASSAGEWAY
---	EXIT DISCHARGE
-----	SEPARATED MIXED OCCUPANCY
P.D.	PANIC DEVICE
♿	ACCESSIBLE

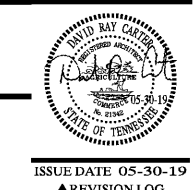

ISSUE DATE 05-30-19  
 REVISION LOG

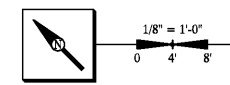

PROJECT 00755

GROUP R-1 AND ACCESSORY USES: 37 OCCUPANTS  
 GROUP A-3 MEETING ROOM (CHAIRS OR STANDING): 173 OCCUPANTS  
 GROUP A-3 NATATORIUM (DECK AND WATER): 69 OCCUPANTS  
 GROUP A-3 FITNESS ROOM: 14 OCCUPANTS  
 GROUP B OFFICE AREA: 6 OCCUPANTS  
 299 TOTAL OCCUPANTS ACTUAL  
 2 EXITS REQUIRED / 4 EXITS PROVIDED WITH ACTUAL TOTAL OF 775 OCCUPANT EXIT CAPACITY

LEVEL 1 FLOOR PLAN- LIFE SAFETY G104

30 x 42