

Order Plans @ www.LDILine.com

**HVAC GENERAL DEMO NOTES**

1. REMOVE ALL EXISTING MECHANICAL EQUIPMENT, DUCTWORK, HANGERS, SUPPORTS, PIPING, AND ACCESSORIES SERVING ONLY THIS SPACE AND NOT INDICATED TO REMAIN.
2. OWNER RETAINS RIGHTS OF SALVAGE FOR EQUIPMENT AND FIXTURES TO BE REMOVED. COORDINATE WITH OWNER THE EQUIPMENT AND FIXTURES TO BE SALVAGED AND THE LOCATION FOR STORAGE. AVOID DAMAGE TO SALVAGED EQUIPMENT, FIXTURES AND DEVICES DURING DEMOLITION WORK AND DURING TRANSPORT TO OWNER'S DESIGNATED STORAGE LOCATION.
3. PRIOR TO SUBMITTING BID, VISIT THE JOB SITE AND BECOME FULLY ACQUAINTED WITH THE EXISTING CONDITIONS OF THE PROJECT. REVIEW GENERAL NOTES, SPECIFICATIONS AND OTHER DRAWINGS FOR ADDITIONAL REQUIREMENTS THAT MAY NOT BE SPECIFICALLY CALLED OUT IN THIS PORTION OF THE CONSTRUCTION DOCUMENTS. NOTIFY ARCHITECT, ENGINEER OR OWNER, AS DEFINED IN BID DOCUMENTS, OF CONFLICTS OR DISCREPANCIES PRIOR TO SUBMISSION OF BID.
4. REMOVE ITEMS SHOWN HEAVY-LINED DASHED, AND/OR NOTED TO BE REMOVED.
5. AVOID DAMAGING EXISTING SURFACES AND EQUIPMENT TO REMAIN FOR NEW INSTALLATION. REPAIR DAMAGE CAUSED DURING WORK AT NO EXTRA COST TO THE OWNER.
6. SEAL PENETRATIONS THROUGH FLOORS, WALLS, CEILING AND ROOF WHERE MECHANICAL COMPONENTS ARE REMOVED AND WHERE THE EXISTING PENETRATION IS NOT USED FOR THE NEW INSTALLATION. REPAIR DAMAGED SURFACES TO MATCH ADJACENT AREAS OR AS INDICATED ON THE ARCHITECTURAL DRAWINGS.
7. INSTALL PERMANENT CAPS WHERE DUCTWORK AND PIPING IS REMOVED AND THE EXISTING TAPS ARE NOT USED FOR THE NEW INSTALLATION. WHERE DUCTWORK AND PIPING ARE REMOVED AND THE EXISTING TAPS WILL BE USED FOR THE NEW INSTALLATION, INSTALL TEMPORARY CAPS TO PROTECT THE INTERIOR SURFACES UNTIL NEW DUCTWORK AND PIPING ARE INSTALLED.
8. REMOVAL, RECOVERY, RECYCLING, AND DISPOSAL OF REFRIGERANT, CONTAINED IN ANY EQUIPMENT TO BE REMOVED, SHALL BE PERFORMED IN STRICT ACCORDANCE WITH CURRENT EPA GUIDELINES.

**MECHANICAL ROOF DEMOLITION NOTES**

- ① DEMO EXISTING RTU AND CURB. PATCH ROOF AS REQUIRED AFTER INSTALLATION OF NEW CURB AT SAME LOCATION.
- ② DEMO ALL ASSOCIATED DUCTWORK AND AIR DEVICES.
- ③ DEMO EXISTING RESTROOM EXHAUST SYSTEMS AND ALL ASSOCIATED DUCTWORK AND AIR DEVICES. PATCH RESTROOM EXHAUST ROOF PENETRATION.
- ④ DEMO EXISTING RESTROOM EXHAUST SYSTEMS AND ALL ASSOCIATED DUCTWORK AND AIR DEVICES. ROOF CURB EXISTING TO REMAIN.

**PLUMBING ROOF DEMOLITION NOTES**

- ① EXISTING GAS METER TO REMAIN.
- ② EXISTING GAS PIPING ON ROOF TO REMAIN. FIELD VERIFY EXISTING CONDITIONS.
- ③ REMOVE EXISTING GAS PIPING AND ACCESSORIES AS REQUIRED TO ALLOW DEMOLITION OF EXISTING ROOF TOP UNITS.
- ④ EXISTING PLUMBING VENT THROUGH ROOF TO REMAIN.

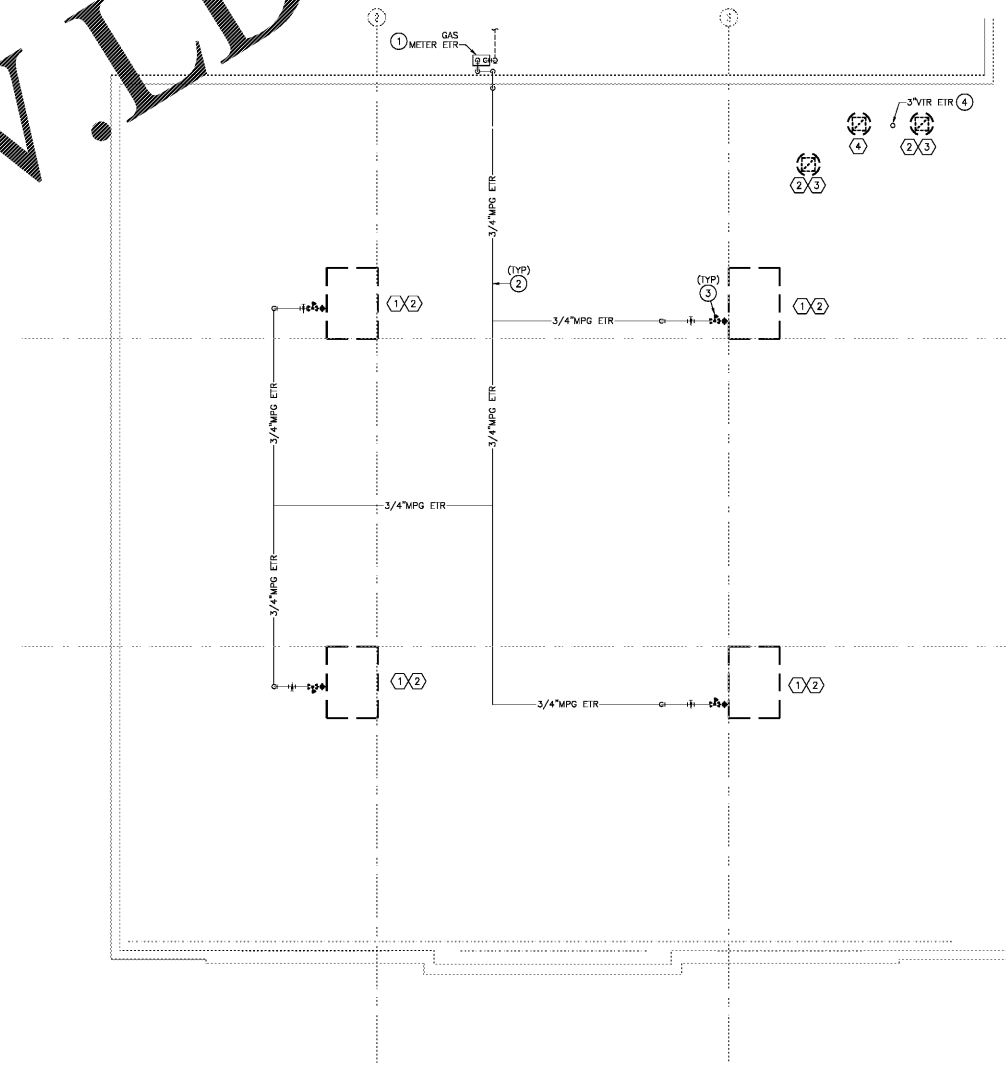

**RGLA**  
 rglasolutions, inc.  
 5100 River Road, Ste 125  
 Schiller Park, IL 60176  
 P: 847.871.7442  
 F: 847.871.4200  
 www.rgla.com

REVISION	DATE
LL & ULTA REVIEW	06/03/2019
BID ISSUE	06/03/2019
PERMIT ISSUE	06/04/2019

**robert g. lyon + associates, inc.**  
 114 N. W. 11th St.  
 5100 River Road, Ste 125  
 Schiller Park, IL 60176  
 P: 847.871.7442  
 F: 847.871.4200  
 www.rgla.com

SEAL:  
 THE ABOVE DRAWINGS AND SPECIFICATIONS AND ALL DIMENSIONS AND DIMENSIONS REPRESENTED THEREIN ARE AND SHALL REMAIN THE PROPERTY OF THIS OFFICE, AND NO PART THEREOF SHALL BE COPIED, REPRODUCED, OR TRANSMITTED IN ANY FORM OR BY ANY MEANS, WITHOUT THE WRITTEN CONSENT OF HENDERSON ENGINEERS. CONTRACTORS SHALL VERIFY AND BE RESPONSIBLE FOR ALL DIMENSIONS AND CONDITIONS BEFORE CONSTRUCTION. CONDITIONS SHOWN IN THESE DRAWINGS SHALL BE DEEMED TO BE SUBJECT TO THE FIELD OF THE CONTRACTOR. HENDERSON ENGINEERS SHALL NOT BE RESPONSIBLE FOR ANY ERRORS OR OMISSIONS IN THESE DRAWINGS OR FOR ANY DAMAGE TO PERSONS OR PROPERTY CAUSED BY THE USE OF THESE DRAWINGS. HENDERSON ENGINEERS SHALL NOT BE RESPONSIBLE FOR ANY DAMAGE TO PERSONS OR PROPERTY CAUSED BY THE USE OF THESE DRAWINGS.

**ULTA BEAUTY**  
 ULTA #613  
 SHOPPES OF MADISON  
 8201 HIGHWAY 72 WEST  
 SUITE C  
 MADISON, AL 35758

**MECHANICAL & PLUMBING DEMOLITION PLAN**

DESIGNED BY	SAK
CHECKED BY	RCB
JOB NUMBER	19047
SHEET NAME	MD-1

**HENDERSON ENGINEERS**  
 8345 LENOVA DRIVE, SUITE 300  
 135104, MS 8914  
 TEL 913.742.5000 FAX 913.742.5001  
 WWW.HENDERSONENGINEERS.COM  
 1850001765  
 AL. CORPORATE TELENUMBER: CA-2185-E  
 EXPRESS 01/01/20

**1 MECHANICAL & PLUMBING DEMOLITION PLAN**  
 SCALE: 1/8"=1'-0"