

REVISIONS	DATE
LL & ULTA REVIEW	09/03/2019
BID ISSUE	09/03/2019
PERMIT ISSUE	09/04/2019

robert g. lyon + associates, inc.  
 1111 S. W. 11th St., Suite 110  
 6100 River Road, Ste 125  
 Schiller Park, IL 60176  
 P: 847.671.4200  
 F: 847.671.4200  
 www.rgla.com

THE ABOVE DRAWINGS AND SPECIFICATIONS ARE THE PROPERTY OF RGLA SOLUTIONS, INC. AND NO PART THEREOF SHALL BE REPRODUCED, COPIED, OR TRANSMITTED IN ANY FORM OR BY ANY MEANS, WITHOUT THE WRITTEN CONSENT OF RGLA SOLUTIONS, INC. VISUAL CONTACT WITH THESE DRAWINGS OR SPECIFICATIONS SHALL CONSTITUTE CONCLUSIVE EVIDENCE OF ACCEPTANCE OF THESE SPECIFICATIONS.

ULTA BEAUTY

ULTA #18'3  
 SHOPS OF MADISON  
 8201 HIGHWAY 72 WEST  
 SUITE C  
 MADISON, AL 35758

WALL FIXTURE  
 DETAILS

DRAWN BY  
 IA  
 CHECKED BY  
 PK  
 JOB NUMBER  
 19047  
 SHEET NAME  
 F1.1B

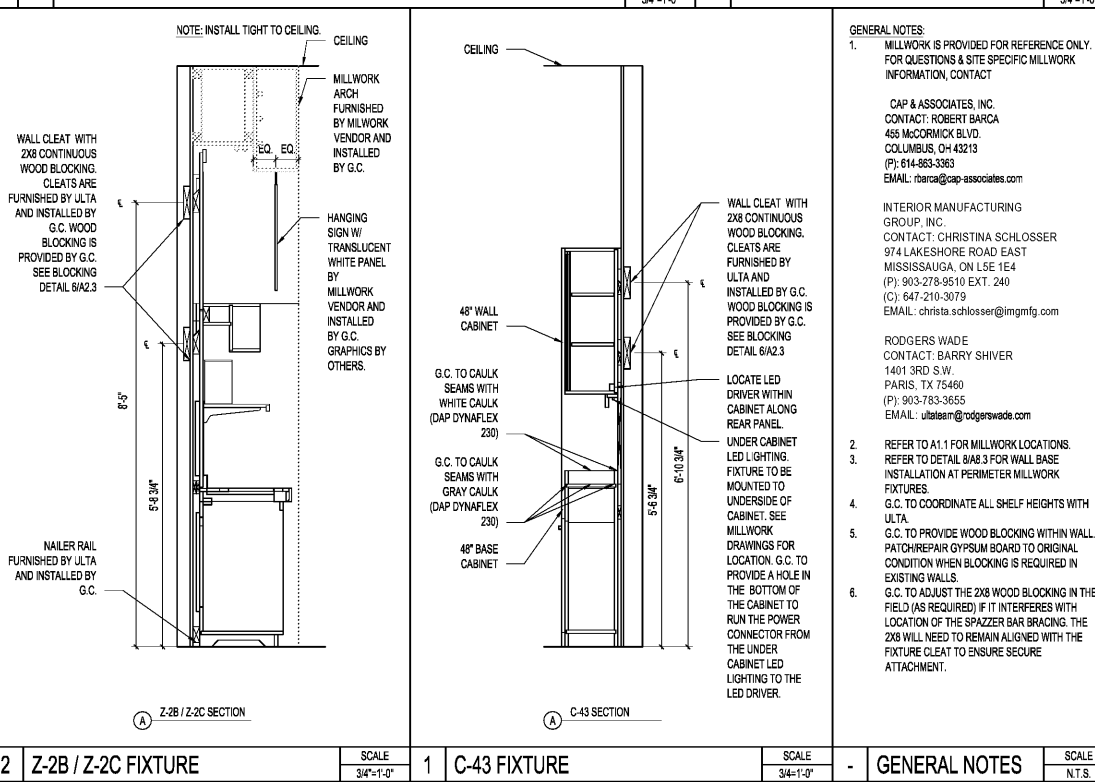
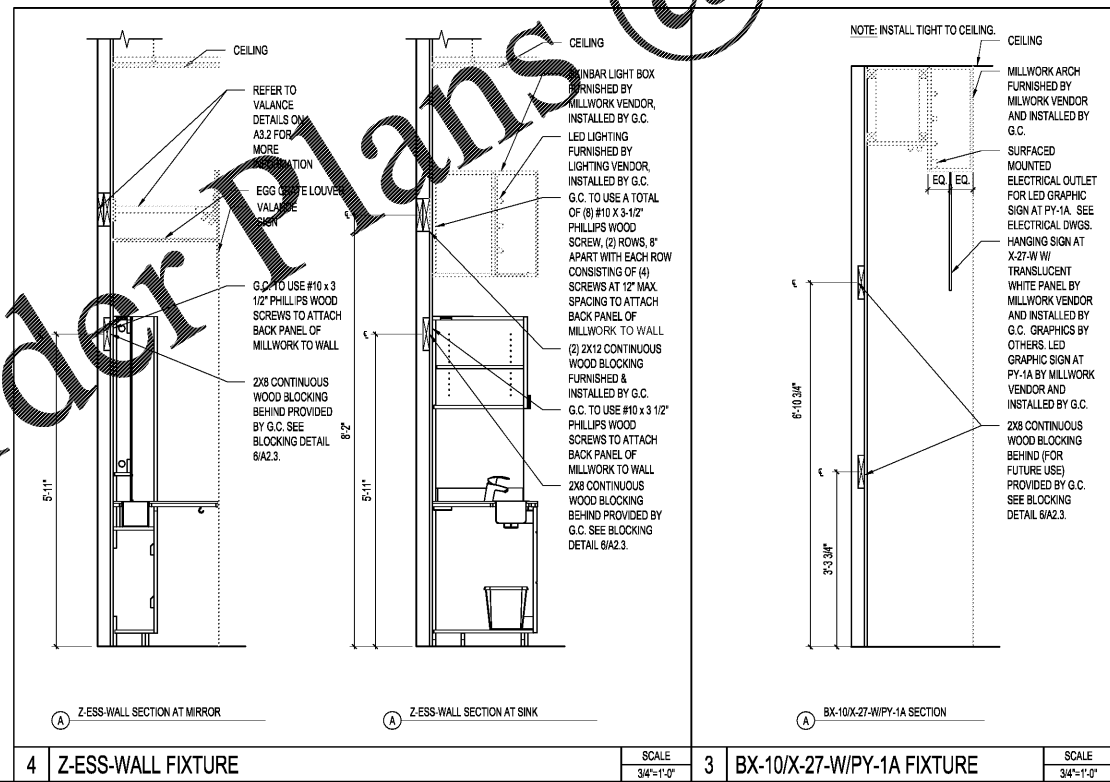

- GENERAL NOTES**
- MILLWORK IS PROVIDED FOR REFERENCE ONLY. FOR QUESTIONS & SITE SPECIFIC MILLWORK INFORMATION, CONTACT  
 CAP & ASSOCIATES, INC.  
 CONTACT: ROBERT BARCA  
 455 MCCORMICK BLVD.  
 COLUMBUS, OH 43218  
 (P) 614-853-3363  
 EMAIL: rbarca@cap-associates.com
  - INTERIOR MANUFACTURING GROUP, INC.  
 CONTACT: CHRISTINA SCHLOSSER  
 974 LAKESHORE ROAD EAST  
 MISSISSAUGA, ON L5E 1E4  
 (P) 905-278-9510 EXT. 240  
 (C) 647-210-3079  
 EMAIL: christina.schlosser@imgmfg.com
  - RODGERS WADE  
 CONTACT: BARRY SHIVER  
 1401 3RD S.W.  
 PARIS, TX 75460  
 (P) 903-783-3655  
 EMAIL: ubatsem@rogerswade.com
  - REFER TO A1.1 FOR MILLWORK LOCATIONS. REFER TO DETAIL 8A8.3 FOR WALL BASE INSTALLATION AT PERIMETER MILLWORK FIXTURES.
  - G.C. TO COORDINATE ALL SHELF HEIGHTS WITH ULTA.
  - G.C. TO PROVIDE WOOD BLOCKING WITHIN WALL PATCH/REPAIR GYPSUM BOARD TO ORIGINAL CONDITION WHEN BLOCKING IS REQUIRED IN EXISTING WALLS.
  - G.C. TO ADJUST THE 2X8 WOOD BLOCKING IN THE FIELD (AS REQUIRED) IF IT INTERFERES WITH LOCATION OF THE SPACER BAR BRACING. THE 2X8 WILL NEED TO REMAIN ALIGNED WITH THE FIXTURE CLEAT TO ENSURE SECURE ATTACHMENT.

WWW.WOODLINE.COM

Order Plans @