

GENERAL NOTES:

- REFER TO FINISH SCHEDULE FOR FLOOR COVERING AND FINISH CODES AND SPECIFICATIONS.
- TILE IS SHOWN FOR FIELD RUN AND PATTERN ONLY. REFER TO COLOR AND FINISH SCHEDULE FOR MATERIAL SPECIFICATIONS.
- PROVIDE WB-1 AT WALLS AND COLUMN ENCLOSURES.
- ALL PAINTED AND WALL COVERING SURFACES SHALL BE PRIMED. SEE ARCHITECT'S SPECIFICATION SHEET AND PAINT MANUFACTURER SPECIFICATIONS.
- PAINT ALL SURFACES FLOOR TO CEILING, INCLUDING PRIMING VALANCE PANELS BEFORE WALL COVERING INSTALLATION.
- ALL METAL SURFACES TO BE PAINTED WITH LOW GLOSS OIL BASE PRIMER AND O.P. BASE FINISH COATS IN COLOR INDICATED ON DRAWING.
- PAINT ON ALL GYPSUM BOARD SURFACES TO BE APPLIED WITH A HEAVY KNAP ROLLER.
- GROUT TO BE SEALED PER MANUFACTURER'S RECOMMENDATIONS. CLEAN SEALER OFF THE ADJACENT FLOOR FINISHES.
- ENSURE PROPER ENVIRONMENTAL CONDITIONS ARE MET FOR THE INSTALLATION OF ALL INTERIOR FINISHES.
- SEE DETAIL 9A-8.2 FOR INSTALLATION AT CONCRETE CONTROL JOINTS. FOR TILE CONTROL JOINTS, FOLLOW TILE MANUFACTURER'S RECOMMENDATIONS.
- FLOOR FINISHES TO CONTINUE UNDER GYPSUM BOARD. GYPSUM BOARD TO BE HELD UP FROM FLOOR SLAB. SEE DETAIL 8A/2. IF GYPSUM BOARD DOES NOT ALLOW FINISH UNDERNEATH, HOLD FLOOR FINISH AS TIGHT AS POSSIBLE TO GYPSUM BOARD.
- TRANSITION STRIPS TO BE MITERED AT INTERSECTIONS.
- CUT PORCELAIN TILE WITH A WATER JET. DO NOT CUT PORCELAIN TILE ON SITE.
- G.C. TO TOUCH UP PAINT PRIOR TO STORE OPENING.
- G.C. TO PROVIDE TWO LAYERS OF CRAFT PAPER OVER ALL TILE AND GROUT ON FLOORS. TAPE DOWN AND STAGGER SEAMS BY HALF THE PAPER WIDTH ON THE SECOND LAYER.
- FLOOR COVERINGS ARE TO BE SLIP RESISTANT THROUGHOUT THE MEANS OF EGRESS.
- G.C. TO INSPECT CONDITION OF EXISTING FLOOR SLAB AND PATCH/REPAIR SURFACE IMPERFECTIONS. IF FLOOR LEVELING IS REQUIRED, ARDEX MUST BE USED AND IT MUST BE INSTALLED BY AN ARDEX LEVEL MASTER ELITE OR ARDEX CHOICE CONTRACTOR INSTALLER. SEE VENDOR CONTACT INFORMATION ON SHEET CS3.0. G.C. TO PROVIDE WARRANTY LETTER ON ARDEX CORPORATE LETTERHEAD. A MINIMUM OF A 5 YEAR WARRANTY MUST BE PRESENTED.
- SEE SHEET CS3.0 FOR CONCRETE SLAB MOISTURE TEST REQUIREMENTS. TESTING PERFORMED BY FLOORING INSTALLATION CONTRACTOR WILL NOT BE ACCEPTED.

MARK	ROOM	FLOOR		WALLS				CEILING		REMARKS
		FINISH	BASE	NORTH	EAST	SOUTH	WEST	FINISH	HEIGHT	
101	SALES	PT-8/VT-3	WB-1	WC-5WC-6	WC-5WC-6	P-1	WC-5WC-6	GYP. BD. P-1 ACT-1	11'-0" / 11'-0"	ALIGN WALL COVERING AT BACKING MATERIAL CHANGES, CORNERS, AND WHERE SOFFIT/VALANCE ABUTS ADJACENT WALL/FILLER PANELS
102	STAGING	VT-8	WB-2	P-1	P-1	P-1	P-1	ACT-2	13'-0"	
103	OFFICE	VT-8	WB-2	P-1	P-1	P-1	P-1	GYP. BD. P-1	8'-0"	
104	SHAMPOODRYING	VT-3	WB-1	WC-5	WC-5	WC-5	WC-5	ACT-1	10'-0"	ALIGN WALL COVERING AT BACKING MATERIAL CHANGES, CORNERS, AND WHERE SOFFIT/VALANCE ABUTS ADJACENT WALL/FILLER PANELS
105	WASHER/DRYER	VT-3	WB-2	P-1	P-1	P-1	P-1	ACT-2	11'-0"	
106	COAT CLOSET	VT-3	WB-2	P-1	P-1	P-1	P-1	ACT-2	9'-0"	
107	CORRIDOR	VT-3	WB-1	WC-5	WC-5	WC-5	WC-5	ACT-1	9'-0"	
108	WOMEN	PT-2	PT-2	WC-5PT-2, PT-7	WC-5PT-2, PT-7	WC-5PT-2, PT-7	WC-5PT-2, PT-7	GYP. BD. P-1	9'-0"	
109	MEN	PT-2	PT-2	WC-5PT-2, PT-7	WC-5PT-2, PT-7	WC-5PT-2, PT-7	WC-5PT-2, PT-7	GYP. BD. P-1	9'-0"	
110	CORRIDOR	VT-3	WB-1	WC-5	WC-5	WC-5	WC-5	ACT-1	9'-0"	
111	SALON	PT-12	WB-1	WC-5	WC-5	WC-5	WC-5	ACT-1	11'-0"	ALIGN WALL COVERING AT BACKING MATERIAL CHANGES, CORNERS, AND WHERE SOFFIT/VALANCE ABUTS ADJACENT WALL/FILLER PANELS

X-1 SPECIFICATION (SEE FINISH SPECS ON A4.1)
 FINISH MATERIAL: PT - PORCELAIN TILE, WD - WOOD, ACT - ACOUSTICAL CLG TILE, WB - WALL BASE, PL - PLASTIC LAMINATE, WC - WALL COVERING, P - PAINT, VT - VINYL TILE

2 ROOM FINISH SCHEDULE

KEY	MATERIAL DESCRIPTION	MFG.	SPECIFICATIONS	FLAME SPREAD AND SMOKE DEVELOPMENT	NOTES	REMARKS
ACT-1	ACOUSTIC TILE	ARMSTRONG	DUNE - SECOND LOOK - #2712 - 24" X 48" X 3/4" 15/16" ANGLED TEGULAR WITH PRELUDE 15/16"	CLASS A 25 AND 50	SEE VENDOR INFO ON CS3.0 FOR ULTA NATIONAL ACCOUNT	
ACT-2	ACOUSTIC TILE	ARMSTRONG	CORTEGA-#789-24" X 48" X 3/8" WITH PRELUDE XL 15/16" EXPOSED TEE SYSTEM (WHITE)	CLASS A 25 AND 50	SEE VENDOR INFO ON CS3.0 FOR ULTA NATIONAL ACCOUNT	
P-1	PAINT	BENJAMIN MOORE	REGAL SELECT - PEARL 650 FINISH READY MIX. COLOR: WHITE TEL: 773-597-8686. CONTACT: JASON WALKER	N/A	FINISH GYPSUM BOARD WITH PRIMER AND PAINT TO FLOOR PEARL 650 FINISH ON WALLS & FLAT 847 FINISH ON SOFFITS & CEILINGS (BLOBS 847) ON DOOR FRAME & TRIM. SEE DOOR SCHEDULE.	ALTERNATE PAINT: PPG PANTS COLOR: PPG1011 PACIFIC PEARL PRIMER (1:40) SEAL GRP. METAL PRIMER (80:12) 2710 PRIMER FINISH (18:1) 5181 PEG CAT EPOXY EGGSHELL TEL: (314) 383-7807. CONTACT SHANE GLASSCOCK
P-6	PAINT	BENJAMIN MOORE	ULTRA SPEC SCUFF-X METAL MIX. COLOR: WHITE EGG SHELL FINISH	N/A	APPLY TO COLUMN ENCLOSURES, STAGING DOOR AND FRAME. APPLY BENJAMIN MOORE ULTRA SPEC PRIMER FOR ANY METAL SUBSTRATE. USE DTM PRIMER. AFTER PRIMER HAS DRIED, APPLY 2 COATS OF P-6 PRIOR TO INSTALLATION OF WB-1. SEE VENDOR CONTACT INFO ON SHEET CS3.0.	ALTERNATE PAINT: PPG PANTS COLOR: PPG1011 PACIFIC PEARL PRIMER (1:40) SEAL GRP. METAL PRIMER (80:12) 2710 PRIMER FINISH (18:1) 5181 PEG CAT EPOXY EGGSHELL TEL: (314) 383-7807. CONTACT SHANE GLASSCOCK
P-7	PAINT	SHERWIN WILLIAMS	SW 7071 GRAY SCREEN, SEMI-GLOSS FINISH	N/A	SEE DOOR TYPES ON DETAIL 2/A2.4 FOR LOCATIONS.	ALTERNATE PAINT: PPG PANTS COLOR: PPG1011 PACIFIC PEARL PRIMER (1:40) SEAL GRP. METAL PRIMER (80:12) 2710 PRIMER FINISH (18:1) 5181 PEG CAT EPOXY EGGSHELL TEL: (314) 383-7807. CONTACT SHANE GLASSCOCK
PT-2	PORCELAIN TILE	GRANITI FIANORE	860539 PEZZATO BIANCO (MATTE) SETTING MATERIAL: ARDEX X5, GROUT COLOR: MAPEI 27 SILVER 12" X 12" X 3/8" NOMINAL, 30 CM X 30 CM TEL: 312-342-4889 CONTACT: NOREEN SCHERTLER	N/A	1/8" GROUT JOINT G.C. TO USE TEXSPAR PLUS TILE CLEANER IN THEIR FINAL CLEANING OF THE TILE. SEE VENDOR CONTACT INFORMATION ON SHEET CS3.0.	TILE FURNISHED BY ULTA, INSTALLED BY G.C., SETTING MATERIALS AND GROUT PROVIDED BY G.C., ALSO SEE SPECIFICATION SHEETS.
PT-6	PORCELAIN TILE	GRANITI FIANORE	860539 PEZZATO BIANCO (MATTE) SETTING MATERIAL: ARDEX X5, GROUT COLOR: MAPEI 27 SILVER 24" X 24" X 3/8" NOMINAL, 60 CM X 60 CM TEL: 312-342-4889 CONTACT: NOREEN SCHERTLER	N/A	1/8" GROUT JOINT G.C. TO USE TEXSPAR PLUS TILE CLEANER IN THEIR FINAL CLEANING OF THE TILE. SEE VENDOR CONTACT INFORMATION ON SHEET CS3.0.	TILE FURNISHED BY ULTA, INSTALLED BY G.C., SETTING MATERIALS AND GROUT PROVIDED BY G.C., ALSO SEE SPECIFICATION SHEETS.
PT-7	PORCELAIN TILE	GRANITI FIANORE	861999 PEZZATO BIANCO (MATTE) SETTING MATERIAL: ARDEX X5, GROUT COLOR: MAPEI 27 SILVER 3" X 12" X 3/8" TEL: 312-342-4889 CONTACT: NOREEN SCHERTLER	N/A	1/8" GROUT JOINT G.C. TO USE TEXSPAR PLUS TILE CLEANER IN THEIR FINAL CLEANING OF THE TILE. SEE VENDOR CONTACT INFORMATION ON SHEET CS3.0. TO USE PERI PERACALLA (COLOR: SILVER) TO TOP OF BALUNES WHERE IT MEETS THE WALLPAPER.	TILE FURNISHED BY ULTA, INSTALLED BY G.C., SETTING MATERIALS AND GROUT PROVIDED BY G.C., ALSO SEE SPECIFICATION SHEETS.
PT-12	PORCELAIN TILE	DAL TILE	STYLE #EX024341P (EXHIBITION 06 TWILL) SETTING MATERIAL: ARDEX X5, GROUT COLOR: MAPEI 47 CHARCOAL 24" X 24" X 3/8" NOMINAL, 59.50 CM X 59.50 CM TEL: 830-306-1550 CONTACT: LYNN MILLS	N/A	1/8" GROUT JOINT G.C. TO USE TEXSPAR PLUS TILE CLEANER IN THEIR FINAL CLEANING OF THE TILE. SEE VENDOR CONTACT INFORMATION ON SHEET CS3.0. TO USE PERI PERACALLA (COLOR: SILVER) TO TOP OF BALUNES WHERE IT MEETS THE WALLPAPER.	TILE FURNISHED BY ULTA, INSTALLED BY G.C., SETTING MATERIALS AND GROUT PROVIDED BY G.C., ALSO SEE SPECIFICATION SHEETS.
VT-3	VINYL FLOOR TILE	AMTICO	SPACIA LINED WOOD NATURAL SSSW2549 4.5" X 36" X 2.5MM	CLASS 1 - 450		VINYL TILE AND ADHESIVE FURNISHED BY ULTA, INSTALLED BY G.C.
VT-8	VINYL FLOOR TILE	MANNINGTON	MANNINGTON GROOVE C120 STERLING GRAY - 12" X 12" X .08"	CLASS 1 - 450		VINYL TILE AND ADHESIVE FURNISHED BY ULTA, INSTALLED BY G.C.
VT-8	VINYL FLOOR TILE	MANNINGTON	MANNINGTON GROOVE C103 POPPY RED - 12" X 12" X .08"	CLASS 1 - 450		VINYL TILE AND ADHESIVE FURNISHED BY ULTA, INSTALLED BY G.C.
WB-1	WINDOW SHADE	ROLL-A-SHADE INC.	CHAIN LIFTION ROLL UP SHADE, PER SHEER, STYLE 400, 3% OPEN WEAVE, COLOR: BALK WHITE WITH WHITE MECHANICALLY FINISHED FAS.		SEE VENDOR INFO ON CS3.0 FOR ULTA NATIONAL ACCOUNT	ULTA TO PROVIDE ON ALL STOREFRONT EXCEPT TRANSOM AND VESTIBULE
WB-1	RUBBER BASE	MANNINGTON	PREMIUM EDGE TYPE TP, 4" WALL COVE MOLDING, NUMBER 242GR, COLOR: SILVER METALLIC	CLASS 1 - 450	G.C. TO SCRIBE THE 4" BASE TO FIT UNDER THE PERIMETER SALES AREA FIXTURES. USE CONTINUOUS ROLLED PRODUCTS.	WALL BASE FURNISHED BY ULTA, INSTALLED BY G.C. ADHESIVE PROVIDED BY G.C. INSTALLATION TO BE COMPLETED BY PROFESSIONAL RUBBER BASE INSTALLER. SEE PERIMETER FIXTURE BASE DETAIL 8A/2.
WB-2	RUBBER BASE	MANNINGTON	PREMIUM EDGE TYPE TP, 4" WALL COVE MOLDING, NUMBER 242GR, COLOR: BEDROCK	CLASS 1 - 450	USE CONTINUOUS ROLLED PRODUCTS.	WALL BASE FURNISHED BY ULTA, INSTALLED BY G.C. ADHESIVE PROVIDED BY G.C. INSTALLATION TO BE COMPLETED BY PROFESSIONAL RUBBER BASE INSTALLER.
WC-5	VINYL WALL COVERING	DESIGN TEX	CUSTOM PRODUCT 'SILVER VINYL WALLCOVERING' PRODUCT#439-20152 PROJECT #439/201595	CLASS A - 20 AND 60	SEE VENDOR INFO ON CS3.0 FOR ULTA NATIONAL ACCOUNT	FURNISHED BY ULTA, INSTALLED BY G.C.
WC-6	VINYL WALL COVERING	DESIGN TEX	CUSTOM PRODUCT 'WHITE VINYL WALLCOVERING' PRODUCT#439-20157 PROJECT #439/201595	CLASS A - 20 AND 60	SEE VENDOR INFO ON CS3.0 FOR ULTA NATIONAL ACCOUNT	FURNISHED BY ULTA, INSTALLED BY G.C.
WF-2	WINDOW FILM	3M COMMERCIAL GRAPHICS DIVISION	FASARA - OPAQUE WHITE - SH2MAOW			WINDOW FILM TO BE APPLIED TO WINDOWS ON THE INTERIOR SURFACE OF GLASS. PRIOR TO INTERIOR ADJACENT WALL CONSTRUCTION, WHEN APPLICABLE, PROVIDE A SAMPLE OF WINDOW FILM TO LANDLORD REPRESENTATIVE FOR APPROVAL PRIOR TO INSTALLATION. SEE EXTERIOR ELEVATIONS.

1 FINISH SPECIFICATIONS

PLAN KEY NOTES:

- START TILE AT CENTER OF CIRCLE.
- CUT PORCELAIN TILE WITH A WATERJET. DO NOT CUT PORCELAIN TILE ON SITE.
- DETAIL AT PERIMETER/ INTERIOR WALL. SEE DETAIL 8A/AB.2.
- DETAIL AT PERIMETER/ INTERIOR WALL. SEE DETAIL 8B/AB.2.
- CONTROL JOINT. SEE DETAIL 9A/AB.2.
- CONTROL JOINT. SEE DETAIL 9B/AB.2.
- G.C. TO MARK AND PORCELAIN TILE 4'-0" UP ALL RESTROOM WALLS. SEE INTERIOR ELEVATIONS.
- G.C. TO PATCH VINYL TILE FLOORING PAST THE ARCH TOWER RESTROOM SO THERE IS NO EXPOSED UNFINISHED CONCRETE SLAB.
- DASHED LINE INDICATES LIMITS OF SALON ARCH.
- SHORT FULL TILE AT 1/2 OF THE AREA.
- 1/2 OF TILE AREA CLEANED WITH 1/2 OF SALON ARCH.

NOTE: THESE FIGURES ARE FOR ULTA REFERENCE ONLY AND ARE APPROXIMATES. G.C. TO PERFORM TAKE OFFS AND SUBMIT TO ULTA

ROOM	ROOM NAME	FLOOR FINISH	AREA
101	SALES	VT-3	7,354 SQ. FT.
101	SALES	PT-8	369 SQ. FT. (115 TILES)
102	STAGING	VT-8	542 SQ. FT.
102	STAGING	VT-8	63 SQ. FT.
103	OFFICE	VT-8	56 SQ. FT.
104	SHAMPOO/ DRYING	VT-3	286 SQ. FT.
105	WASHER/ DRYER	VT-3	18 SQ. FT.
106	COAT CLOSET	VT-3	9 SQ. FT.
107	CORRIDOR	VT-3	25 SQ. FT.
108	WOMEN (FLOOR & WALLS)	PT-2	194 SQ. FT.
109	MEN (FLOOR & WALLS)	PT-2	196 SQ. FT.
108 & 109	RESTROOM WALL BORDER TILE	PT-7	22 SQ. FT.
110	CORRIDOR	VT-3	98 SQ. FT.
111	SALON	PT-12	388 SQ. FT. (137 TILES)

A FINISH PLAN AND ESTIMATED TILE AREAS

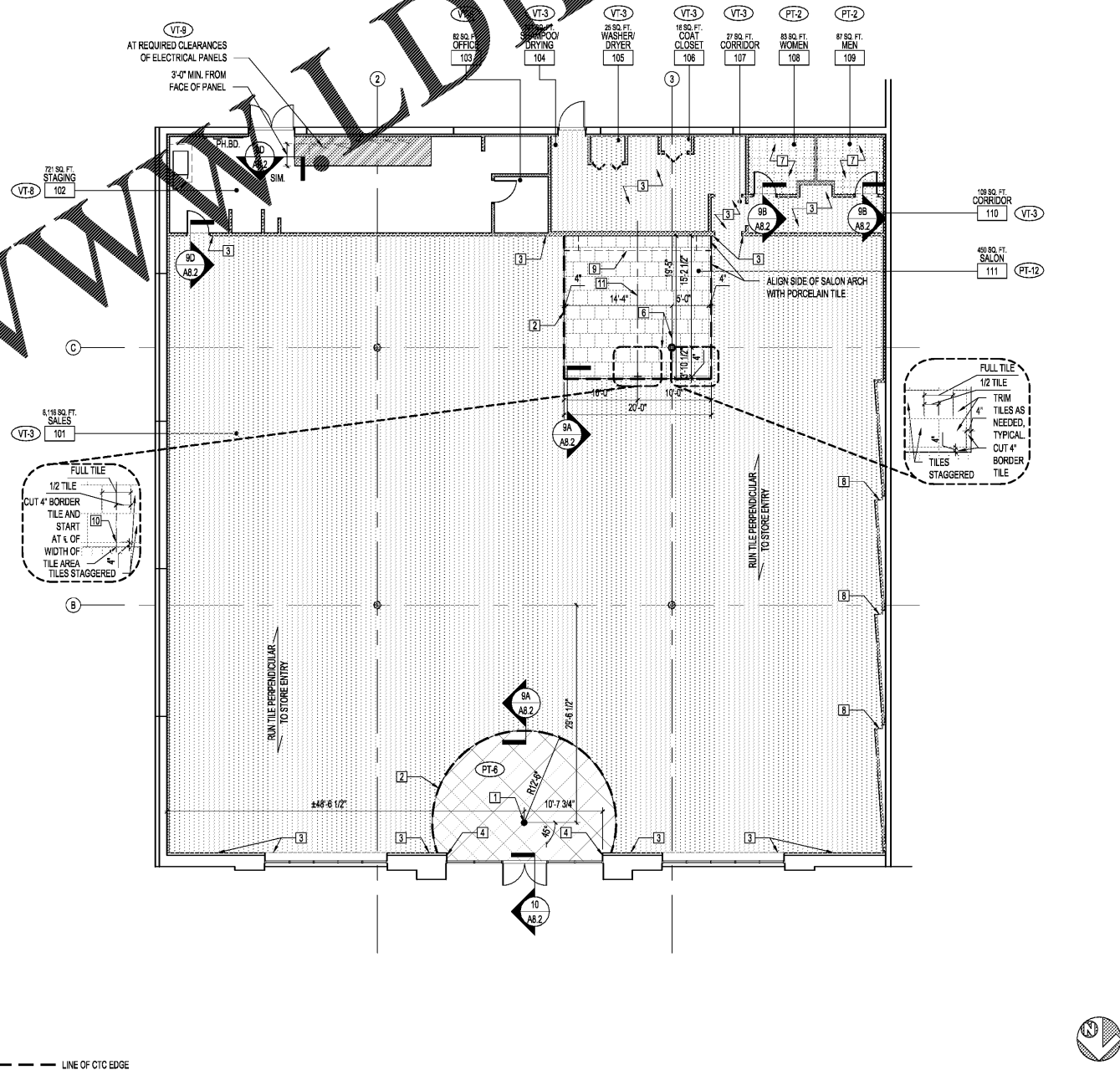

RGLA
 rgl solutions, inc.
 8100 River Road, Ste 125
 Schiller Park, IL 60176
 P: 847.671.4420
 F: 847.671.4200
 www.rgla.com

REVISION	DATE
LL & ULTA REVIEW	09/03/2019
3D ISSUE	09/03/2019
PERMIT ISSUE	09/04/2019

robert g. lyon + associates, inc.
 1115 N. W. 11th St., Suite 110
 5100 River Road, Ste 125
 Schiller Park, IL 60176
 P: 847.671.4200
 www.rgla.com

ULTA BEAUTY

ULTA #1613
 SHOPS OF MADISON
 8201 HIGHWAY 72 WEST
 SUITE C
 MADISON, AL 35758

FLOOR FINISH
 PLAN, FINISH
 SCHEDULE AND
 SPECIFICATIONS

DESIGNED BY: IA
 CHECKED BY: PK
 JOB NUMBER: 19047
 SHEET NAME: A4.1