

Professional Seal

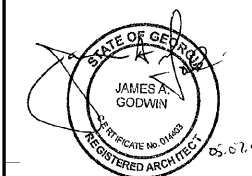

Professional Seal

Revisions

NO.	DATE	DESCRIPTION
1.	05.07.19	OWNER REVIEW COMMENTS

**SPECIAL NOTICE:**  
In the event the client consents to, allows, authorizes or approves of changes to any plans, specifications or other construction documents, and these changes are not approved in writing by the design professional, the client recognizes that such changes and the results thereof are not the responsibility of the design professional. Therefore, the client agrees to release the design professional from any liability arising from the construction, use or result of such changes. In addition, the client agrees to the fullest extent permitted by law, to indemnify and hold the design professional harmless from any damage, liability or cost (including reasonable attorney's fees and costs of defense) arising from such changes.

Copyright © 2019 by GODWIN + ASSOCIATES. All rights reserved. No part of this drawing may be reproduced by photocopy or by any other means, or stored, processed, or transmitted in or by any computer or other systems without the prior written permission of GODWIN + ASSOCIATES.

Project Number: 49034

Drawn By: PMM

Reviewed By: JAG

Date: 04.10.19

**True Rest Float Spa**

2995 Cobb Parkway Southeast  
Cobb County, GA 30339

**Life Safety and Egress Plan**

CONSTRUCTION DOCUMENTS

Sheet Number

**LS1.1**

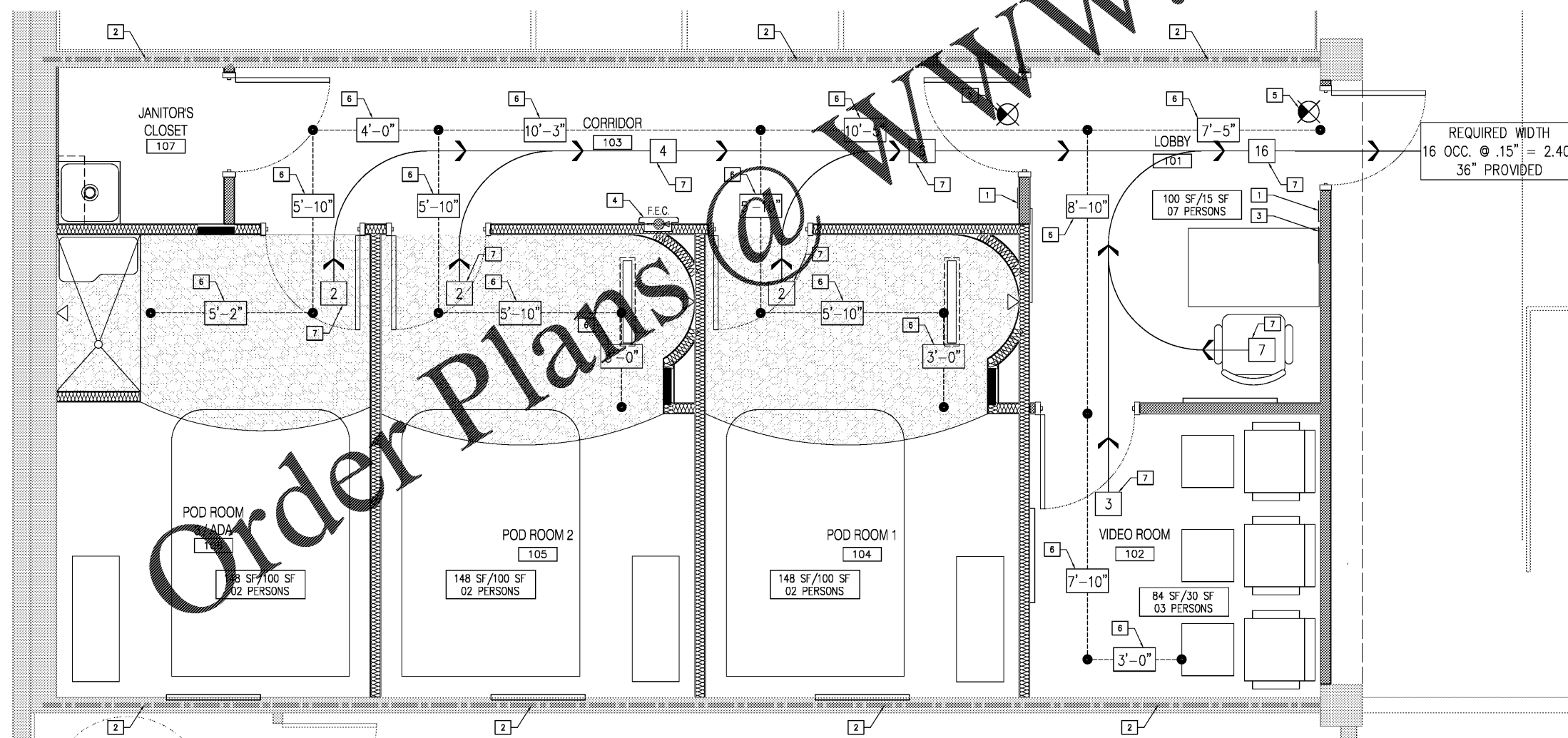

**KEY NOTES: LIFE SAFETY**

- 1 TACTILE EXIT SIGN - SEE NOTES ON SHEET A2.2
- 2 1-HOUR DEMISING WALL
- 3 MAXIMUM OCCUPANT LOAD SIGN POSTING OF 16 PEOPLE. SEE NOTES ON SHEET A0.0 AND A2.2.
- 4 FIRE EXTINGUISHER CABINET LOCATION - SIMILAR TO MODEL NUMBER 2409-SR WITH MP3 EXTINGUISHER AS MANUFACTURED BY LARSENS MANUFACTURING COMPANY, MINNEAPOLIS, MN. (800) 527-7357.
- 5 EXIT SIGN - SEE ELECTRICAL DRAWINGS
- 6 EXITING PATH / TRAVEL DISTANCE BETWEEN NODES
- 7 OCCUPANT LOAD PER ROOM / CUMULATIVE OCCUPANT LOAD

**LIFE SAFETY AND EGRESS PLAN**

Scale: 1/2" = 1'-0"

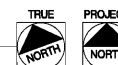

WWW.LDILine.com

Order Plans