

ROOM NUMBER	ROOM NAME	FLOOR	BASE	WALLS	CEILING	CEILING HEIGHT	REMARKS
101	RECEPTION	LVT-1/CPT	B1		C1	10'-2"	
102	MEN'S RESTROOM	LVT-1	B2	ACROVYN/PT#3	C1	10'-2"	2.
103	BUSINESS OFFICE	CPT	B1		C1	10'-2"	1.
104	HALLWAY	CPT	B1	PT#4	C1	10'-2"	
105	INTRA-ORAL X-RAY/SCAN	LVT-2	B1		C1	10'-2"	
106	PANORAMIC X-RAY	LVT-2	B1		C1	10'-2"	
107	HALLWAY	LVT-2	B1	PT#4	C1	10'-2"	1.
108	INTERIOR WAITING	CPT	B1	PT#3	C1	10'-2"	
109	CONSULTATION	CPT	B1	PT#1	C1	10'-2"	
110	MANAGER/DOCTOR OFFICE	CPT	B1	PT#2	C1	10'-2"	
111	LAB	LVT-2	B1	PT#5	C1	10'-2"	4.
112	TR. #1	LVT-2	B1		C1	10'-2"	
113	HALLWAY	LVT-2	B1	PT#4	C1	10'-2"	1.
114	TR. #2	LVT-2	B1		C1	10'-2"	
115	WOMEN'S RESTROOM	LVT-1	B2	ACROVYN/PT#3	C1	10'-2"	2.
116	MECHANICAL ROOM	CONC	B1	FRP#1/PT#5	C1	10'-2"	3.
117	BREAK ROOM	LVT-2	B1	PT#2	C1	10'-2"	
118	HALLWAY	LVT-2	B1		C1	10'-2"	1.
119	TR. #7	LVT-2	B1		C1	10'-2"	1.
120	TR. #6	LVT-2	B1		C1	10'-2"	1.
121	STERILIZATION	LVT-2	B1	PT#1	C1	10'-2"	
122	TR. #5	LVT-2	B1		C1	10'-2"	
123	TR. #4	LVT-2	B1		C1	10'-2"	1.
124	TR. #3	LVT-2	B1		C1	10'-2"	1.
125	STORAGE	LVT-2	B1	PT#1	C1	10'-2"	
126	STORAGE	LVT-2	B1	PT#1	C1	10'-2"	
127	TR. #8	LVT-2	B1		C1	10'-2"	1.

**ROOM FINISH REMARKS:**

- SEE FINISH PLAN FOR WALL FINISHES IN THIS ROOM
- (ACROVYN) PROVIDE SARATOGA SERIES (#372 CLASSIC MAPLE FINISH) ACROVYN WALL SYSTEM TO 42" A.F.F. INCLUDE 4" BASE, 2 VERTICAL SEAMS/CORNERS & 2" TOP CAP. REMAINDER OF WALL TO BE PAINTED PT#3. GRAIN TO BE INSTALLED VERTICALLY.
- (FRP#1) PROVIDE FRP TO 42" AFF ON ALL WALLS & PAINT THE REMAINDER OF WALL ABOVE PT#5. FRP SPECIFICATION: CRANE COMPOSITES GLASBORD WHITE OR EQUAL
- (FRP#2) PROVIDE FRP FROM FLOOR TO CEILING - SEE PLAN FOR LOCATION FRP SPECIFICATION: CRANE COMPOSITES GLASBORD WHITE OR EQUAL

**FLOORING**

**ASPEN DENTAL WILL DIRECT PURCHASE ALL FLOORING THROUGH A NATIONAL ACCOUNT. (CARPET, WALK-OFF, LVT, VCT, COVE BASE, TRANSITIONS, GLUES) FOR THE JOB. TO RELEASE FLOORING PRODUCT, PLEASE CONTACT CARPET WHOLESALE INC. MR. PAUL KRAWCZYK AT (315) 422-1489 OR E-MAIL [aspendental@sposatoflooring.com](mailto:aspendental@sposatoflooring.com)**

**-SEE CONTRACT SCHEDULE FOR REQUIRED MATERIAL ORDER DATES**

**-SEE ASPEN DENTAL'S CONSTRUCTION CLEAN SPEC. FOR FLOOR CARE OF RECEPTION + OFFICE (LVT) AREAS.**

**RECEPTION AND OFFICE AREAS:**

CPT CARPET TILE  
MANNINGTON CANOPY II  
24"x24" TILE  
COLOR: 43240 WILDE (ASHLAR PATTERN)

WOC WALK OFF CARPET  
MANNINGTON TRAVERSE WALK-OFF TILE  
COLOR: 8407 OCHRE OWL  
STRAIGHT PATTERN (ALL ARROWS SAME DIRECTION)

LVT-1 VINYL TILE  
ARMSTRONG LVT LINE  
18"x18" NATURAL CREATIONS - QUARTER TURN INSTALL  
MYSTIX\_TP782 JET NATURAL

LVT-2 VINYL TILE  
ARMSTRONG LVT LINE  
16"x16" NATURAL CREATIONS  
EARTH CUTS\_TP520 DURANGO GOLDEN HARVEST - LINEAR INSTALL

B1 BASE  
ROPPE  
4" HIGH RUBBER BASE  
#193 BLACK/BROWN

B2 BASE  
4" ACROVYN BASE

CONC SEALED CONCRETE  
3 COATS  
NOTE: LEAVE ALL EXTRA TILES IN MECHANICAL ROOM AT END OF JOB

**NOTE:** BEFORE THE FLOORING INSTALLATION TAKES PLACE THE FOLLOWING MOISTURE LIMITS MUST BE ACHIEVED:  
LVT AREAS 95% RH OR 8 LBS. MVER. CARPET TILE AREAS 85% RH OR 8 LBS MVER. THESE TESTS SHOULD BE CONDUCTED IN STRICT ACCORDANCE WITH THE LATEST EDITION OS ASTM F-2010 & ASTM F-1869.

**CEILING**

C1 MATERIAL: 24"x24" ACOUSTICAL PANEL CEILING  
MANUF: ARMSTRONG  
ITEM: DUNE #1774

\* ALL CEILING HEIGHTS ARE AS STATED OR 2" ABOVE WINDOWS

\* ALL CEILING HEIGHTS TO BE VERIFIED TO ALLOW REQ'D CLEARANCES FOR ALL MECHANICAL HOLD CEILINGS AS TIGHT AS POSSIBLE. CONTACT EXCEL ENGINEERING IF ISSUES OCCUR WITH CEILING HEIGHTS.  
\* ANY CEILING TILE ALTERNATES TO BE SUBMITTED TO ASPEN FOR APPROVAL.  
\* CEILING GRID TO BE 15/16" PRELUDE XL. COLOR: WHITE 300 SERIES.  
\* GRID TO BE CENTERED IN ALL ROOMS.

**HOLLOW METAL DOOR & FRAME PAINT:**

DOOR & WINDOW FRAME  
SHERWIN WILLIAMS DTM ACRYLIC DEEP BASE  
1 GAL MIX

(2) COATS SEMI-GLOSS

BAC COLORANT	OZ	32	64	128
B1-BLACK	-	56	1	1
N1-RAW UMBER	-	7	-	-
R2-MAROON	-	11	-	-
Y3-DEEP GOLD	-	52	1	1

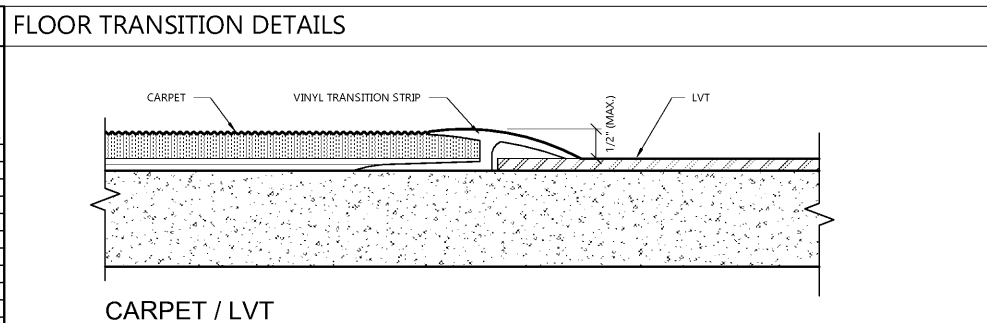

**WALL COVERINGS**

SHERWIN WILLIAMS - SHERWIN WILLIAMS PRO-MAR 200 PAINT IN EGGSHELL FINISH.  
-ALL WALLS TO HAVE (1) COAT PRIMER & (2) COATS PAINT (MIN.)  
WALL COVERINGS BY EYKON. PREP WALLS AS REQ'D BY MANUF. INSTRUCTIONS

PT#1 -SW6381 ANJOU PEAR  
PT#2 -SW7033 BRAINSTORM BRONZE  
PT#3 -SW6439 GREENFIELD  
PT#4 -SW6150 UNIVERSAL KHAKI  
PT#5 -SW7001 MARSHMALLOW  
PT#6 -SW6163 GRASSLAND

\*UNDERSIDE OF ALL HEADERS TO MATCH COLOR OF ADJACENT WALL UNLESS NOTED OTHERWISE

**DOOR COLOR:**

MOHAWK DOOR COMPANY  
TYPE: VENER 5. ROTARY BIRCH SELECT WHITE  
COLOR: CLEAR COAT  
DOORS TO BE FACTORY PRE-FINISHED

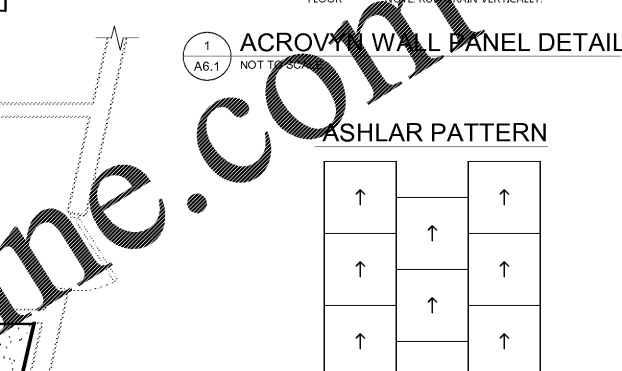
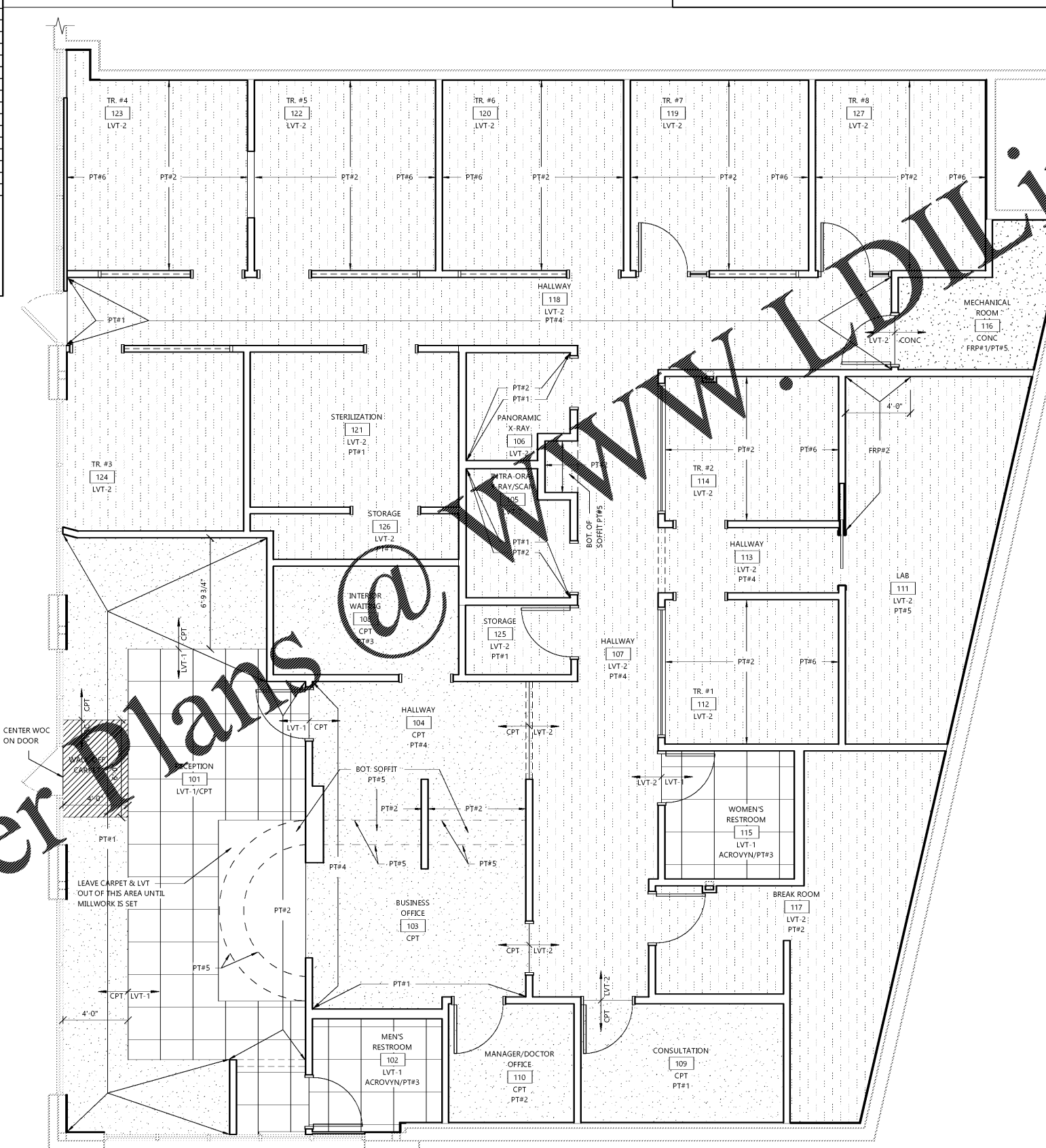
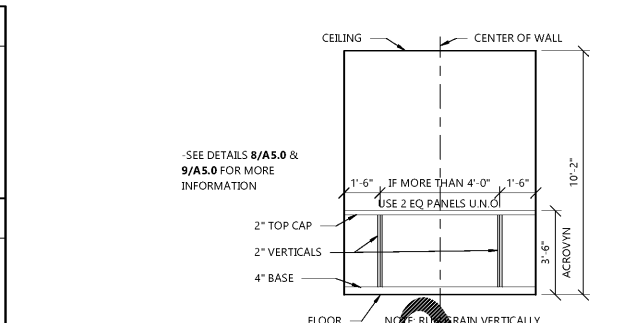

WWW.IDLINE.com

Order Plans @

**EXCEL**  
ARCHITECTS • ENGINEERS • SURVEYORS  
Always a Better Plan  
100 Camelot Drive  
Fond Du Lac, WI 54935  
Phone: (920) 926-9800  
www.EXCELENGINEER.com

COLLABORATION

AspenDental

**PROJECT INFORMATION**

TENANT BUILD-OUT FOR:  
**ASPEN DENTAL**  
660 W. LINTON BLVD., STE. 380 • DELRAY BEACH, FL 33444

PROFESSIONAL SEAL

**SHEET DATES**

SHEET ISSUE MAY 29, 2019

REVISIONS

**JOB NUMBER**  
1931400

**SHEET NUMBER**  
**A6.1**