

OFFICE ELEVATION - ELECTRICAL & DATA
 SCALE: 1/8" = 1'-0"

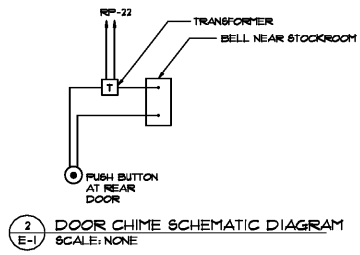

SPECIAL NOTE:
 CONTRACTOR SHALL REFER TO THE TEMPERATURE SENSOR MOUNTING DETAIL ON SHEET EMT-3 FOR PLACEMENT AND INSTALLATION INSTRUCTIONS PRIOR TO INSTALLING.

POWER/WIRING INFORMATION FOR COOLER/FREEZER EQUIPMENT

DEVICE*	DISCONNECT SIZE	CONDUIT/WIRE SIZE	FEEDER PANEL	FEEDER BREAKER(S)
(C1)	JUNCTION BOX # 100" AFF W/10' WHIP	1/2" (3,712 & (1) 1/2 GND.**	LP	11,9
(C2)	8"x8"x6" JB # 120" AFF W/20' COILED WIRE	1/2" (2,712 & (1) 1/2 GND.	LP	21
(F1)	JUNCTION BOX # 100" AFF W/10' WHIP	1/2" (3,712 & (1) 1/2 GND.**	LP	23,29
(F2)	JUNCTION BOX # 100" AFF W/10' WHIP	3/4" (3,712 & (1) 1/2 GND. **	LP	21,29
(F3)	8"x8"x6" JB # 120" AFF W/20' COILED WIRE	1/2" (2,712 & (1) 1/2 GND.	LP	31,33
(F4)	8"x8"x6" JB # 120" AFF W/20' COILED WIRE	1/2" (2,712 & (1) 1/2 GND.	LP	35
(S2C)	JB ABOVE CEILING W/20' COILED WIRE	1/2" (2,712 & (1) 1/2 GND.	LP	31
(S2C)	JB ABOVE CEILING W/20' COILED WIRE	1/2" (2,712 & (1) 1/2 GND.	LP	39
(S2F)	JB ABOVE CEILING W/20' COILED WIRE	1/2" (2,712 & (1) 1/2 GND.	LP	41

* FOR WALK-IN COOLER/FREEZER LIGHTS
 NOTE: ALL DIMENSIONS ARE TO THE TOP OF THE ASSOCIATED DEVICE. FINAL TERMINATIONS TO COOLER & FREEZER EQUIPMENT IS BY THE EQUIPMENT INSTALLER.
 ** INCLUDES: (2) HOT, (1) NEUTRAL, & (1) GROUND

POWER/WIRING INFORMATION FOR HYAC EQUIPMENT

HYAC*	DISCONNECT SIZE	CONDUIT/WIRE SIZE	FEEDER PANEL	FEEDER BREAKER(S)
RTU-1	EXISTING TO REMAIN	3/4" (3,712 & (1) 1/2 GND.	MP	15,21,23
RTU-2	PROVIDED WITH UNIT	3/4" (3,712 & (1) 1/2 GND.	MP	25,21,29
RTU-3	PROVIDED WITH UNIT	3/4" (3,712 & (1) 1/2 GND.	MP	31,33,35
RTU-4	PROVIDED WITH UNIT	3/4" (3,712 & (1) 1/2 GND.	MP	26,28,30

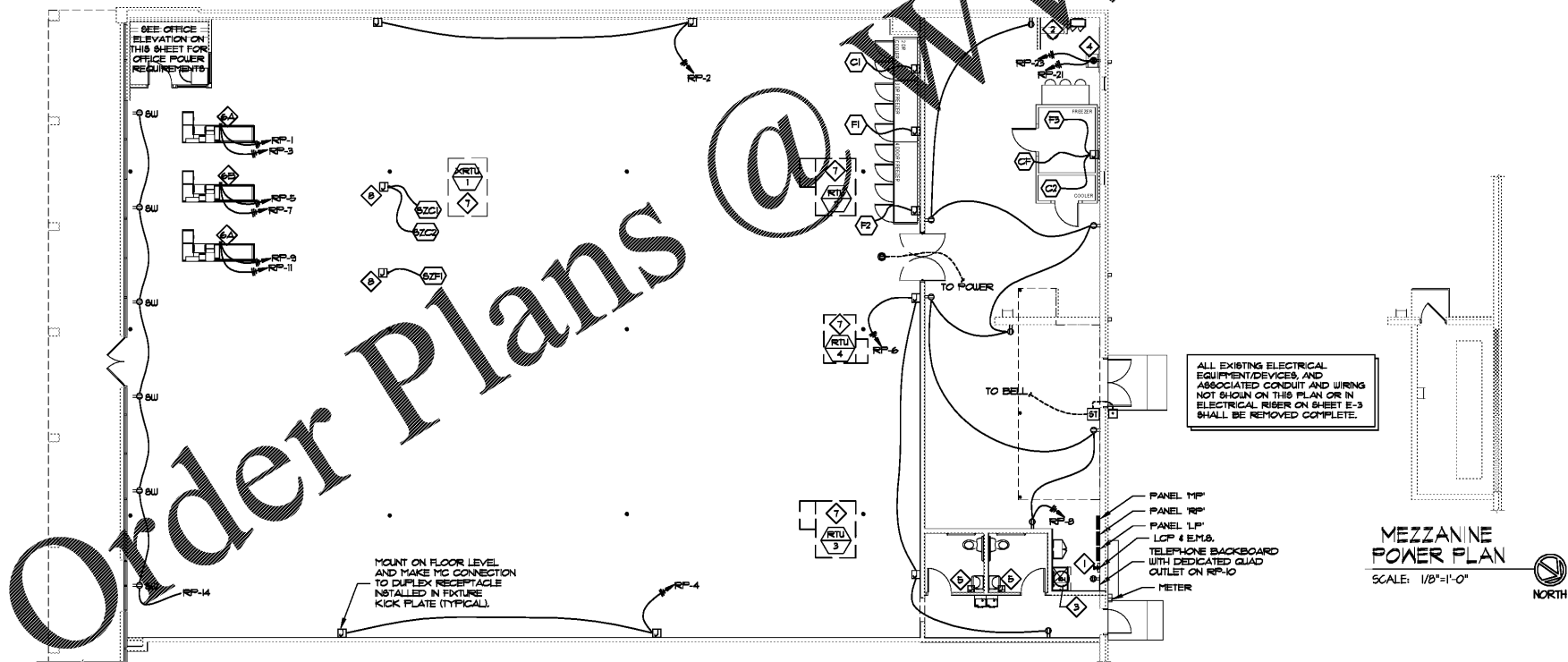

POWER PLAN
 SCALE: 1/8" = 1'-0"
 NORTH

ELECTRICAL LEGEND

- EMIS ENERGY MANAGEMENT SYSTEM
- ⊖ CEILING RECEPTACLE, 120V, 20A
- ⊖ DUPLEX RECEPTACLE, 120V, 20A
- ⊖ DUPLEX RECEPTACLE, 20A, 25 VOLT, WITH ISOLATED GROUND, HUBBLE 76-5182
- ⊖ DUPLEX RECEPTACLE, 120V, 20A, GROUND FAULT INTERRUPT CIRCUIT
- ⊖ DUPLEX RECEPTACLE, 120V, 20A, GROUND FAULT INTERRUPT CIRCUIT WITH WEATHERPROOF COVER
- ⊖ DUPLEX RECEPTACLE, 120V, 20A, ABOVE WINDOW IN WALL OR IN CEILING, BUT WITHIN 8" OF TOP OF WINDOW
- ⊖ JUNCTION BOX
- ⊖ PUSHBUTTON MOUNT 42" AFF UNLESS OTHERWISE NOTED.
- ⊖ SIGNAL TRANSFORMER MOUNT 9'-0" AFF IN STOCKROOM
- ⊖ TELEPHONE OUTLET; PROVIDE AND INSTALL ALL NECESSARY CONDUIT, CABLE, DEVICE BOXES AND PLATES RUN TO BACKBOARD. CONNECTION BY TENANT'S CONTRACTOR. COORDINATE LOCATION WITH TENANT.
- ⊖ QUADRAPLEX RECEPTACLE
- ⊖ HOPE RUN APPROXIMATE - NUMBER OF APPROXIMATE INDICATES NUMBER OF CIRCUITS.
- ⊖ TURN-LOCK FLUSH RECEPTACLE: 20A, 25 VOLT, MOUNT 42" AFF.
- ⊖ BELL, 4" DIAMETER SINGLE HARMONY VIBRATING TYPE 24 VAC, 30 VA EDWARDS *10-468, MOUNT ABOVE CEILING.

POWER PLAN NOTES:

- ⊖ CONTRACTOR SHALL REFER TO EMB SHEETS FOR INSTRUCTION AND RESPONSIBILITIES FOR INSTALLING TENANT SUPPLIED ENERGY MANAGEMENT SYSTEM PRIOR TO BIDDING AND INSTALLATION.
- ⊖ FOR EMPLOYEE DESK AREA, PROVIDE AND INSTALL 36" LONG PLUG-HOLD WITH (2) 20V, 20A CIRCUIT AND A MINIMUM OF FIVE RECEPTACLES. CENTER THE PLUG-HOLD, MOUNT AT 3'-2" AFF, AND CONNECT TO CIRCUIT RP-25. PROVIDE AND INSTALL (1) SINGLE-GANG DATA BOX MOUNTED IN HORIZONTAL CONFIGURATION WITH 3/4" STUB-UP. MOUNT DATA DEVICE AT 3'-5" AFF.
- ⊖ WATER HEATER - UNIT IS 120V, 2000W, WITH 1/2" C, (2) 1/2" & (1) 3/4" GROUND TO PANEL. RP-10 CIRCUIT 30. PROVIDE LOCKING CIRCUIT BREAKER. COORDINATE ACTUAL LOCATION WITH FUTURE DATA BOX MOUNTED IN HORIZONTAL CONFIGURATION WITH 3/4" STUB-UP. MOUNT DATA DEVICE AT 3'-5" AFF.
- ⊖ THE QUAD RECEPTACLE SHOWN IS ACTUALLY ONE (1) UP & ONE (1) DOWN DUPLEX RECEPTACLE WITH THE TWO CIRCUITS TO THE QUAD RECEPTACLE AT 18" AFF. LOCATE OUTLET NEXT TO LOCKER. COORDINATE LOCATION WITH FUTURE DATA BOX.
- ⊖ THE ELECTRIC HAND DRIVERS IN WHICH TOOLS ARE PROVIDED BY TENANT AS PART OF THE RECEPTION BOX PACKAGE AND ARE TO BE ROUGHED IN WITH WALL HANGER KIT AND CONNECTED BY THE ELECTRICAL CONTRACTOR VIA CIRCUITS RP-18 & RP-20.
- ⊖ POWER POLES ARE PROVIDED BY TENANT FOR INSTALLATION BY ELECTRICAL CONTRACTOR AND SHALL INCLUDE EITHER AN "A" OR "B" TYPE AS SHOWN ON THE PLANS. A "C" ISOLATED DEDICATED CIRCUIT, ONE STANDARD RECEPTACLE CIRCUIT, & ONE TELEPHONE CIRCUIT & ONE ISOLATED DEDICATED CIRCUIT & ONE STANDARD RECEPTACLE CIRCUIT.
- ⊖ INSTALLATION FOR CONNECT UP/PGFCI RECEPTACLE AT HVAC UNIT IS REQUIRED. CONNECT TO CIRCUIT RP-18. UNIT MAY BE SUPPLIED WITH UN-WIRED RECEPTACLE BUILT-IN.
- ⊖ JUNCTION BOX ABOVE CEILING FEEDING POWER POLE (POLE SUPPLIED BY TENANT) FOR SNACK ZONE COOLERS & ICE CREAM FREEZER. COORDINATE LOCATION WITH FUTURE PLAN BEFORE ROUGH-IN.

Order Plans

WWW.LDILLINGHAM.COM

351 Hickory Blvd
 Tallahassee, TN 37788
 Office: 813-454-6940
 2805 Elm Hill Pike #211C
 Nashville, TN 37214
 Office: 615-676-6022
 olgengineering.com

Oliver • Little • Gipson
OLG
 ENGINEERING, INC.

description
 by
 date
 mark
 revisions

5/1/2019	03/19	DWB	DWB	ADG
date	project	designed	drawn	checked

RRMM
 ARCHITECTS, PC
 Robert S. Berz, Jr., Architect
 Duane M. Harver, Architect

1317 Executive Blvd, Suite 200
 Chesapeake, VA 23320
 (757) 622-2828 / fax (757) 622-6883

DOLLAR TREE
 ROCKDALE PLAZA - DEAL # 11733
 CONYERS, GA
 POWER PLAN

project
 drawing
 sheet

E-1