

REGAL RIVER CIRCLE
CROWN POINTE COVE
PLAT BOOK 88, PAGE 149
50' PRIVATE ROADWAY

SIGNAGE NOTES:

1. ALL PAVEMENT MARKINGS AND SIGNAGE SHALL BE IN ACCORDANCE WITH THE "MANUAL ON UNIFORM TRAFFIC CONTROL DEVICES FOR STREETS AND HIGHWAYS," LATEST EDITION; AND LOCAL LAND DEVELOPMENT CODE.
2. FREE STANDING SIGNAGE SHOWN ONLY FOR REPRESENTATIONAL PURPOSES, AND SHALL BE PERMITTED SEPARATELY. CONTRACTOR TO COORDINATE WITH SIGN VENDOR FOR PERMITTED LOCATION AND SIZE.

LEGEND:

- PROPERTY LINE
- ▭ PROPOSED BUILDING
- ▭ PROPOSED ASPHALT PAVEMENT
- ▭ PROPOSED HEAVY DUTY ASPHALT PAVEMENT
- ▭ PROPOSED CONCRETE PAVEMENT
- ⊙ PROPOSED PARKING SPACE COUNT
- PROPOSED SIGN
- PROPOSED PAVEMENT MARKING
- PROPOSED TYPE 1" CURB

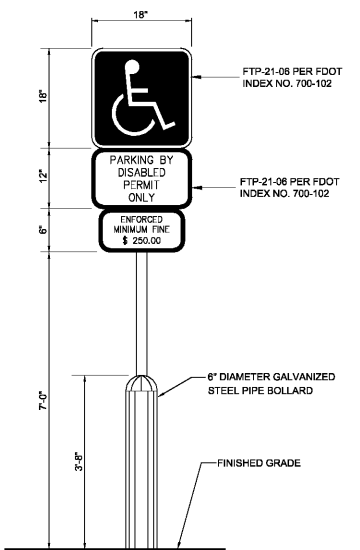
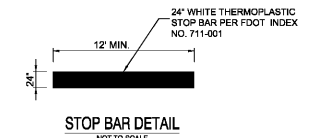
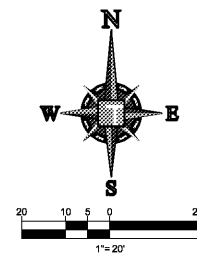

NOTES
1. HANDICAPPED SIGN WILL BE OF A D.O.T. (BLUE) COLOR PAVEMENT BORDER LINES (ONE ON EACH SIDE OF THE HANDICAPPED SPACE WILL BE OF A BLUE COLOR OF A QUALITY EQUIVALENT TO SUPER STRIPE TRAFFIC PAINT SOLD BY FOX VALLEY SYSTEMS INC. OF CARY ILLINOIS. PHONE 1-800-323-4770 SHALL BE STRIPED ON THE WEARING SURFACE OF EACH SPACE DESIGNED FOR THE HANDICAPPED SPACE.

ACCESSIBLE PARKING SIGN DETAIL
NOT TO SCALE

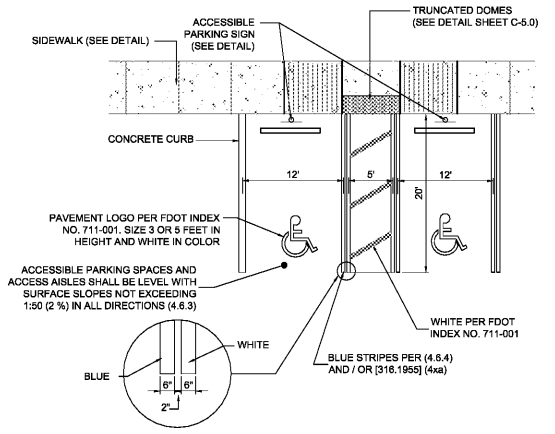

LEGEND

R1-1	STOP SIGN (30" x 30")
R5-1	DO NOT ENTER SIGN (30" x 30")
FTP 21-06	ACCESSIBLE PARKING
W11-2	PEDESTRIAN CROSSING
DY	DOUBLE YELLOW
W	WHITE
Y	YELLOW
T	THERMOPLASTIC

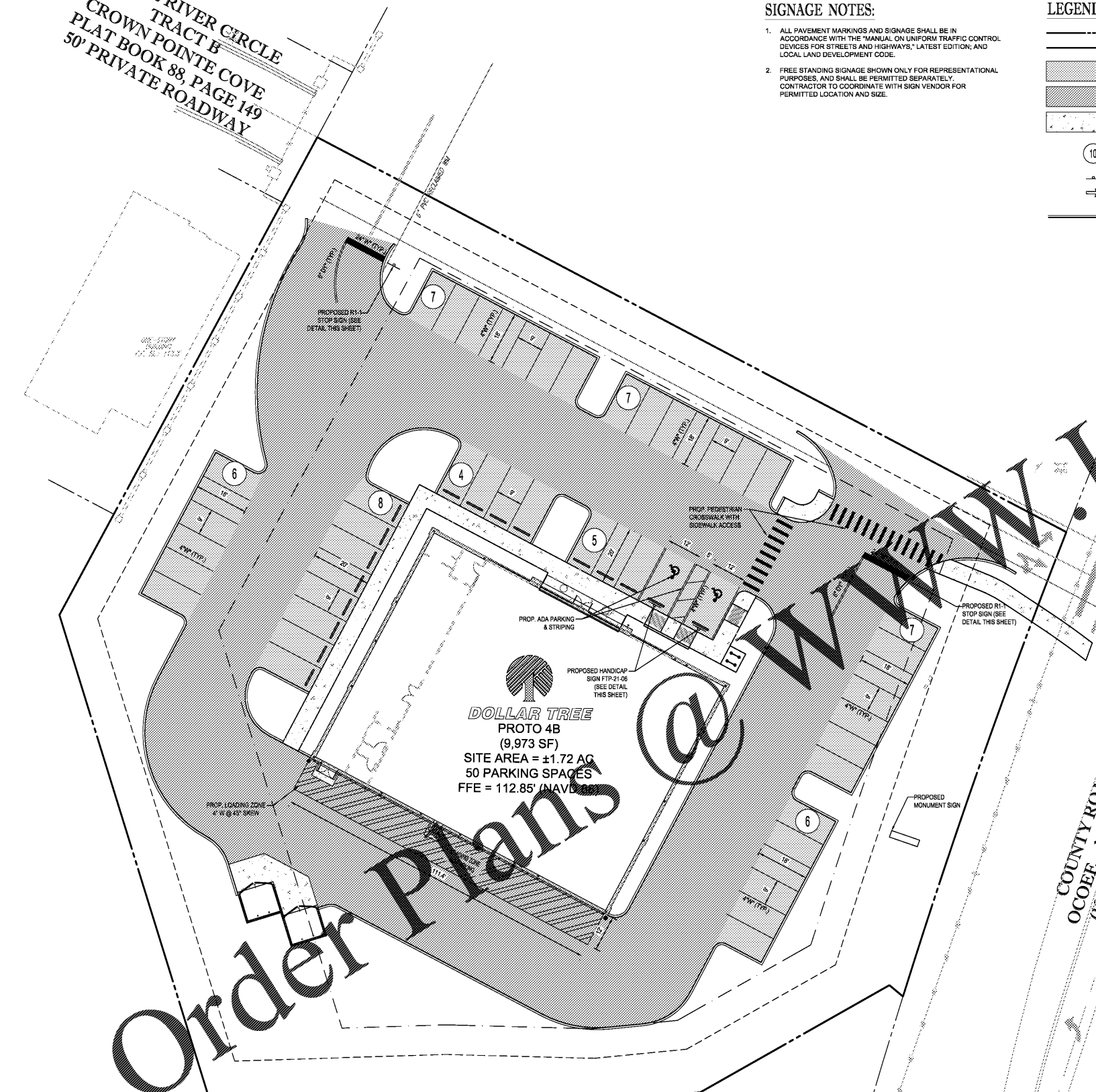

DOLLAR TREE
PROTO 4B
(9,973 SF)
SITE AREA = ±1.72 AC
50 PARKING SPACES
FFE = 112.85' (NAVD 2011)

Order Plans @

COUNTY ROAD 437
OCOEE - APOPKA ROAD
(120' R/W WIDTH PER PLAT)



THOMAS
4950 W. KENNEDY BLVD, SUITE 600
TAMPA, FLORIDA 33609
Phone: (813) 378-4100
Fax: (813) 378-4040
ThomasEngineeringGroup.com

REV.	DATE	DRN	CHK	DESCRIPTION
05/15/2019	CTD	CTD		PER CITY OF OCOEE COMMENTS 5/13/19
01/17/2019	AG	CTD		PER CITY OF OCOEE COMMENTS 3/29/19
				DOCUMENT CONTROL

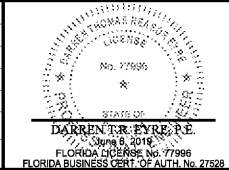

DOLLAR TREE

OCOEE, FL

PAVEMENT MARKING & SIGNAGE PLAN

PROJ. NO. FT180066 DWG. NO. C-12.0