

1) PLEASE NOTE - MAXIMUM FOOTAGE PER POWER SUPPLY SHOULD NOT EXCEED 60' (SPLIT INTO TWO PARALLEL RUNS OF 30' EACH)

2) JACKETED CABLE ESTIMATED ASSUMES MAXIMUM RUN LENGTH OF 10'.

3) TOTAL WATTAGE REQUIRED FOR THIS JOB = 2830

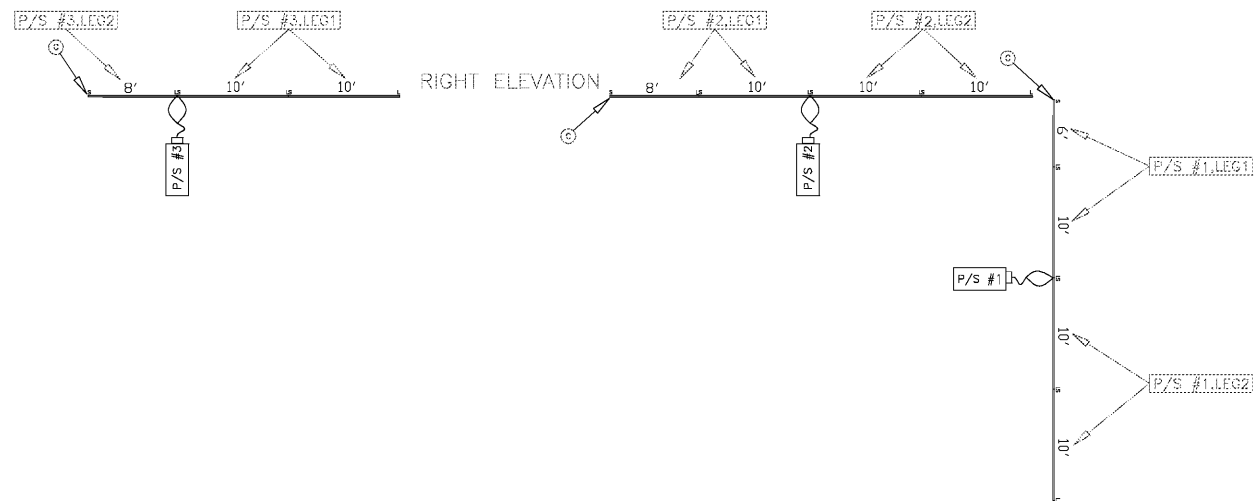

LAYOUT SHOWS P/S FOR ONE ROW
REPEAT SAME PATTERN FOR REMAINING 2 ROWS

FRONT ELEVATION



1 LED LAYOUT (3) HORIZONTAL ROWS.
N-2 SCALE=NTS

PRODUCT TOTALS FOR ALL 5 ROWS

- (16) Each 701189-10H - 10' Red LEDStripe Lengths (Actual length 121 3/8")
- (3) Each 701189-8H - 8' Red LEDStripe Lengths (Actual length 97 3/8")
- (2) Each 701189-6H - 6' Red LEDStripe Lengths (Actual length 73 3/8")
- (16) Each 701189A-B-10D - 10' Blue LEDStripe Lengths (Actual length 121 3/8")
- (3) Each 701189A-B-8D - 8' Blue LEDStripe Lengths (Actual length 97 3/8")
- (2) Each 701189A-B-6D - 6' Blue LEDStripe Lengths (Actual length 73 3/8")
- (16) Each 701189E-W-10 - 10' White LEDStripe Lengths (Actual length 121 3/8")
- (3) Each 701189E-W-8 - 8' White LEDStripe Lengths (Actual length 97 3/8")
- (2) Each 701189E-W-6 - 6' White LEDStripe Lengths (Actual length 73 3/8")
- (18) Each 701895-24C - 100 Watt Power Supply
- (30) Each 701158-120 - 10' Hook-up Cable
- (10) Each 701385 - Jumper Kits
- (3) Each 701160-3 - "Y" Connectors
- (20) Each 400828-FC -Frosted Acrylic Endcap (Included)

WARNING:
CUT THE END WITH THE
SMALL CONNECTOR ONLY.

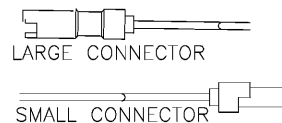

Key:

- △ = Jumper Kit
- = Cut Here
- Y = Y Connector

LED Installation Guide

1. On the face of the trim board, snap a chalk line 1/4" of an inch in from the inside edge of the trim board.
2. Using the LED layout, measure and mark mounting button locations on the chalk line. IMPORTANT: Mounting buttons must be no more than 24" on center and within 1 1/2" to 3" from each ends of each unit.
3. Using #8 x 1 1/4" pan head sheet metal screws, attach mounting buttons to the trim board. Do not over tighten.
4. Starting with the end of the unit on the chalk line, slide all full-length units onto mounting buttons leaving a 1/4" expansion gap between each unit and secure in place using the 90 clip at the center of each unit.
5. Take measurements for cut units. From where measurements are taken will vary. Some will be between units, some will be from chalk line to the unit and some will be from chalk line to chalk line.
6. Subtract the thickness of the replacement end cap and the 1/4" expansion gap from your measurements. Depending on where the measurement was taken, this will vary. Measurements taken between units will subtract the end cap plus 1/2". Those taken from chalk line to the unit will subtract the end cap plus 1/4". And, those taken from chalk line to chalk line will subtract the end cap only.
7. Measuring from the end of the unit with the "large" connector, mark where the unit is to be cut. Note: It does not have to be cut on the black line.
8. Using a chop or miter saw and following the Sloan LEDStripe Installation Guide, cut units and glue on replacement end caps.
9. Following the LED layout, making sure the "large" connector is pointing in the correct direction, install the cut units. Secure each unit to the trim board.
10. Again, following the layout, connect units, jumpers and run leads to power supplies locations inside the copulas (doghouses). IMPORTANT: (1) All electrical penetrations are to be just above the top LED units. (2) Any leads or runs over 15 feet must use 14-gauge. (3) Wiring should be hidden as much as possible. Securing the wire to the top of the units or snaking the wires between the buttons or a combination of both, then securing with white zip ties, will help accomplish this.
11. Follow the Sloan LEDStripe Installation Guide manual; install and wire LED power supplies.
12. Test each power supply/LED for proper illumination.
13. Silicone seal electrical penetrations and install corner and straight LED covers. Note: Straight covers should be custom cut to match the angles on the peak.
14. Pick-up and properly dispose of all insulation debris.

ELECTRICAL REQUIREMENTS:

- (3) HORIZONTAL ROWS OF LED, 6 AMPS PER ROW, TOTAL 18 AMPS.
- (2) 120 VOLT - 20 AMP CIRCUITS REQUIRED FOR ALL (3) ROWS.

GC TO PROVIDE PRIMARY WIRING AND CONNECT.

ENDS CUT TO LENGTH IN THE FIELD (AS REQUIRED)
AFTER CUTTING LEDSTRIFE:

1. ENDCAP(PN701129-C) IS CEMENTED INTO PLACE
2. PREP AND APPLY ACRYLIC END CAP PER SLOAN FIELD SUT INSTRUCTIONS INCLUDED IN SLOAN LED PACKAGE. ALSO AVAILABLE ON sloanled.com

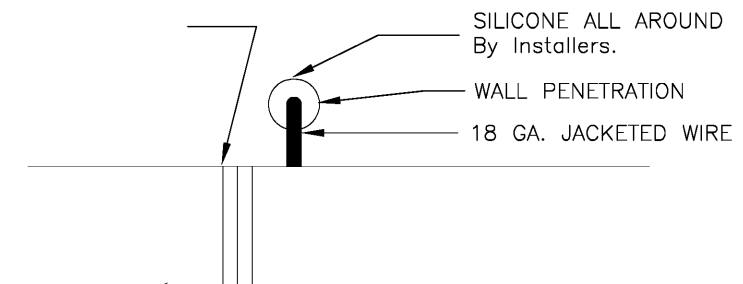

2 SECTION DETAIL
N-2 SCALE=NTS

LED STRIPE (TYP.)

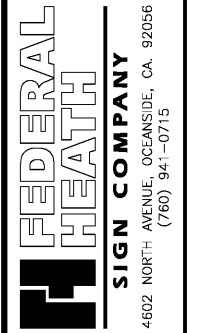

This original drawing is provided as part of a planned project and is not to be exhibited, copied or reproduced without the permission of Federal Heath Sign Company or its authorized agent.



PERMIT/BID SET
EAST FRANKLIN BOULEVARD & ARMSTRONG PARK ROAD
GASTONIA, NC

NO.	REVISIONS	DATE	BY

DESIGN NO:	N-010801
PROJECT MGR:	S. MAESER
DRAWN BY:	SM
DATE:	5/3/19
APPROVED BY:	
SCALE:	AS NOTED
JOB NO:	