

222 cloister
court chapel
hill, nc 27514
919.401.8586
www.cra-ae.com

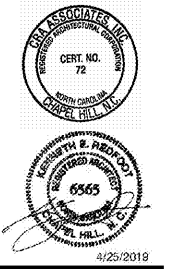

Cedar Ridge High School
Classroom Addition
Orange County Schools
1125 New Grady Brown School Road
Hillsborough, North Carolina

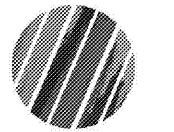

no. revisions

The use of these plans and specifications shall be restricted to the original site for which they were prepared and published. Any reuse, reproduction, or publication by any means, in any form, without the written consent of the architect is prohibited. It is to be returned upon request to the architect. Metal sections with these plans and specifications shall constitute part of the contract. Metal sections with these plans and specifications shall constitute part of the contract.

drawn checked
date Wall
Sections

sheet
A5.1

project no. 1716

date 4/25/19

Construction Document Bid Set

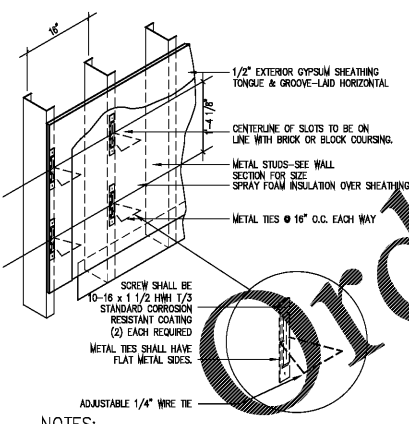
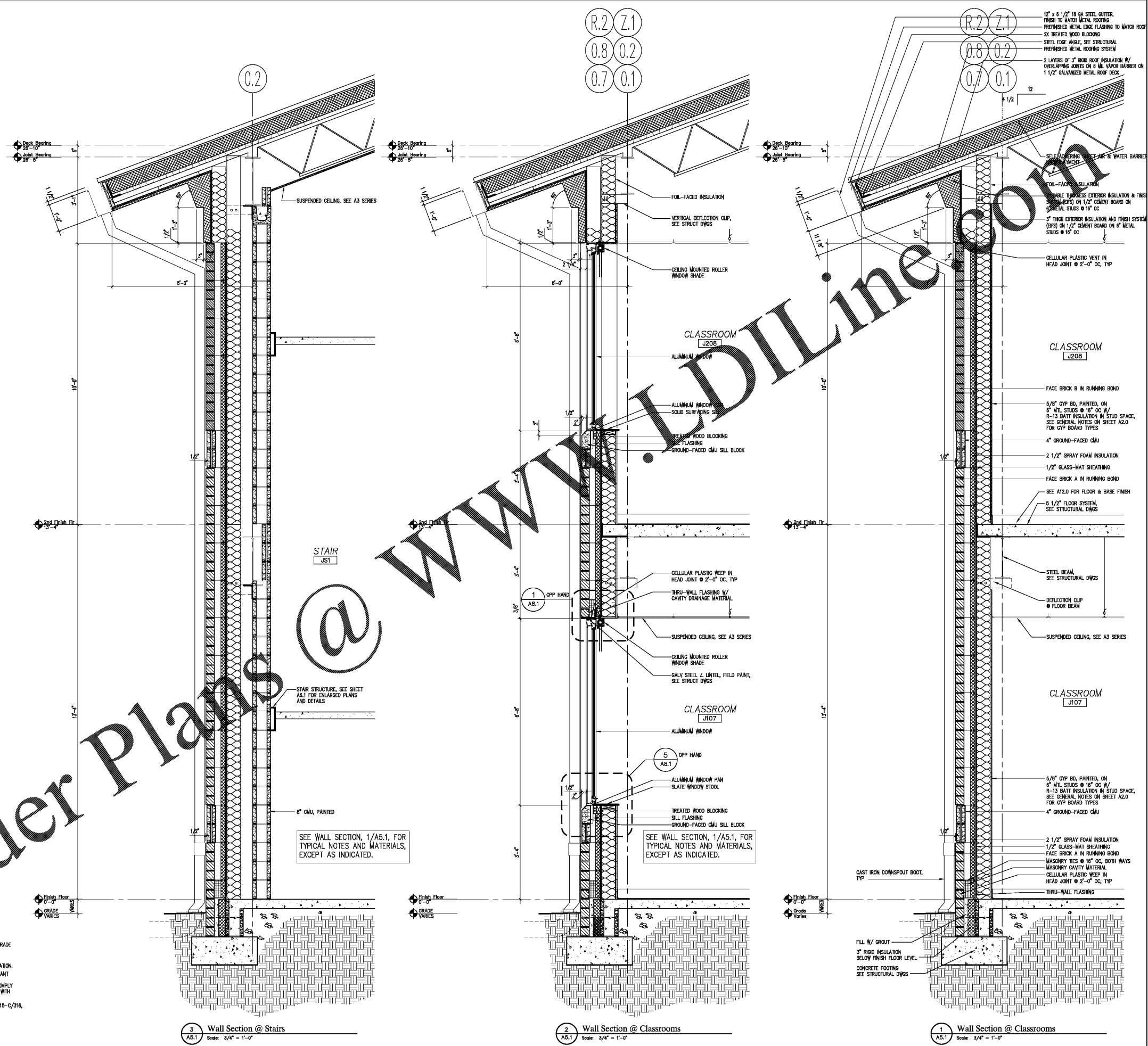

- NOTES:
- METAL STUDS SHALL BE SIZED NOT TO EXCEED L/800.
 - PROVIDE FLASHING AT LINTELS, SHELF ANGLES, WINDOWS & DOOR HEADS & SILLS, AT GRADE LEVEL & AT WALL CAP.
 - CELLULAR PLASTIC WEEPS SHALL BE INSERTED IN HEAD JOINTS @ 24" OC.
 - PROVIDE 1" MIN. AIRSPACE BETWEEN BACK OF BRICK & EXTERIOR FACE OF FOAM INSULATION.
 - METAL TIES SHALL BE NOT LESS THAN 14 GAUGE, 3/16" DIA. WIRE, CORROSION RESISTANT COATING FOR TIES ANCHORS & FASTENERS SHALL COMPLY TO ASTM A163, HOT DIPPED GALVANIZED AFTER FABRICATION, CLASS 18-3 (1.6 OUNCES PER FOOT). TIES SHALL COMPLY TO ASTM A62 FOR COLD DRAWN STEEL WIRE. SCREW FASTENED ANCHORS SHALL BE MADE WITH BACKPLATE TO UNIFORMLY DISTRIBUTE POSITIVE TIE LOADS TO SHEATHING & STUDS.
 - SUGGESTED MANUFACTURERS AS FOLLOWS: HORMANN & BARNARD DW-10, HECKMAN 315-C/316, AA WIRE AA400/401-C

4 Brick Veneer w/ Stud Back Up
A5.1 Scale: 3/4" = 1'-0"

3 Wall Section @ Stairs
A5.1 Scale: 3/4" = 1'-0"

2 Wall Section @ Classrooms
A5.1 Scale: 3/4" = 1'-0"

1 Wall Section @ Classrooms
A5.1 Scale: 3/4" = 1'-0"

SEE WALL SECTION, 1/A5.1, FOR TYPICAL NOTES AND MATERIALS, EXCEPT AS INDICATED.

SEE WALL SECTION, 1/A5.1, FOR TYPICAL NOTES AND MATERIALS, EXCEPT AS INDICATED.