

222 cloister
court chapel
hill, nc 27514
919.401.8586
www.cra-ae.com

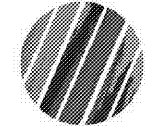

Cedar Ridge High School
Classroom Addition
Orange County Schools
1125 New Grady Brown School Road
Hillsborough, North Carolina



no. revisions

The use of these plans and specifications shall be restricted to the original site for which they were prepared and publication thereof is expressly limited to such use. No use, reproduction, or publication by any means, in whole or in part, is prohibited. Title to the plans and specifications remain in the original owner. No part of the original specifications shall constitute any part of the contract unless the original specifications are specifically referred to in the contract documents. The contractor shall coordinate with these plans and specifications and shall provide the same evidence of the acceptance of these conditions.

drawn: [blank] checked: [blank]
ker

Second Floor
Reflected
Ceiling Plan

sheet
A3.2

project no. 1716

date 4/25/19

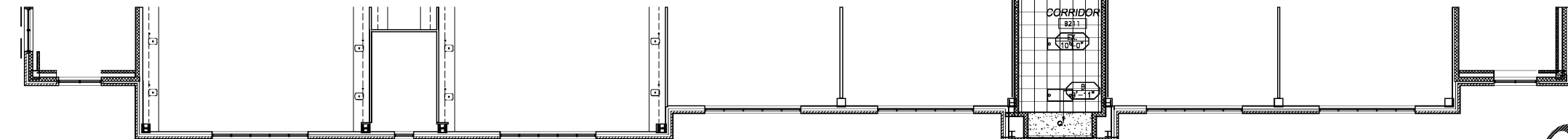

CEILING SYMBOL LEGEND

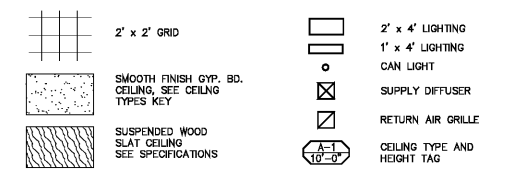

CEILING MATERIAL KEY

TYPE	DESCRIPTION
A-1	SUSPENDED 2' x 2', WHITE CORTEGA ANGLED REGULAR EDGE, LAY-IN ACOUSTICAL PANELS
B	SUSPENDED 5/8" GYP. BD., PAINTED
C	SUSPENDED WOOD SLAT CEILING
E	EXPOSED STRUCTURE AND W/E/P/FP SYSTEMS, PAINTED
S	EXTERIOR INSULATION AND FINISH SYSTEM, SEE SPECS

- NOTES:
- REFER TO SPECIFICATIONS FOR COMPLETE CEILING DESCRIPTIONS.
 - THE CONTRACTOR SHALL PROVIDE COORDINATION WITH OTHER TRADES TO INSURE ADHERENCE TO CEILING HEIGHTS INDICATED. PROPER CLEARANCES SHALL BE PROVIDED BETWEEN MECHANICAL, ELECTRICAL, PLUMBING AND FIRE PROTECTION ITEMS ABOVE CEILING. THE CONSTRUCTION MANAGER SHALL CONDUCT A PRE-INSTALLATION COORDINATION MEETING WITH AUTHORIZED REPRESENTATIVES OF ALL TRADES PRIOR TO THE INSTALLATION OF ABOVE CEILING ITEMS.
 - THE CONTRACTOR SHALL COORDINATE LOCATIONS OF LIGHT FIXTURES, MECH. SUPPLY DIFFUSERS AND RETURN AIR GRILLES WITH CEILING GRID INSTALLATION. SEE ELECTRICAL DRAWINGS FOR LIGHT FIXTURES. SEE MECHANICAL DRAWINGS FOR SUPPLY DIFFUSERS, RETURN AIR GRILLES, ETC.

